

SECTION THRU INTEGRAL ABUTMENT
(Horiz. dim. @ Rt. L's)

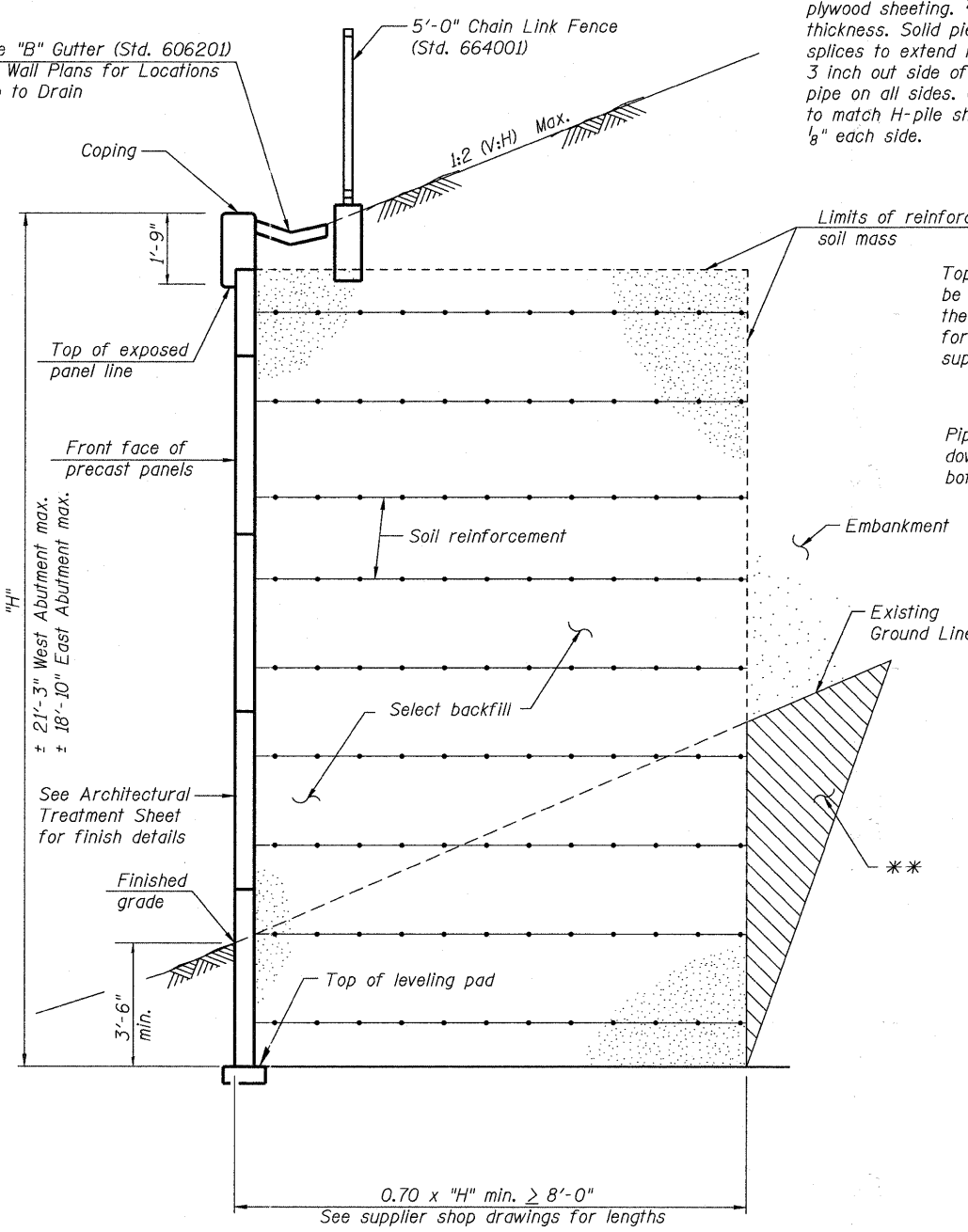

SECTION THRU MSE WALL

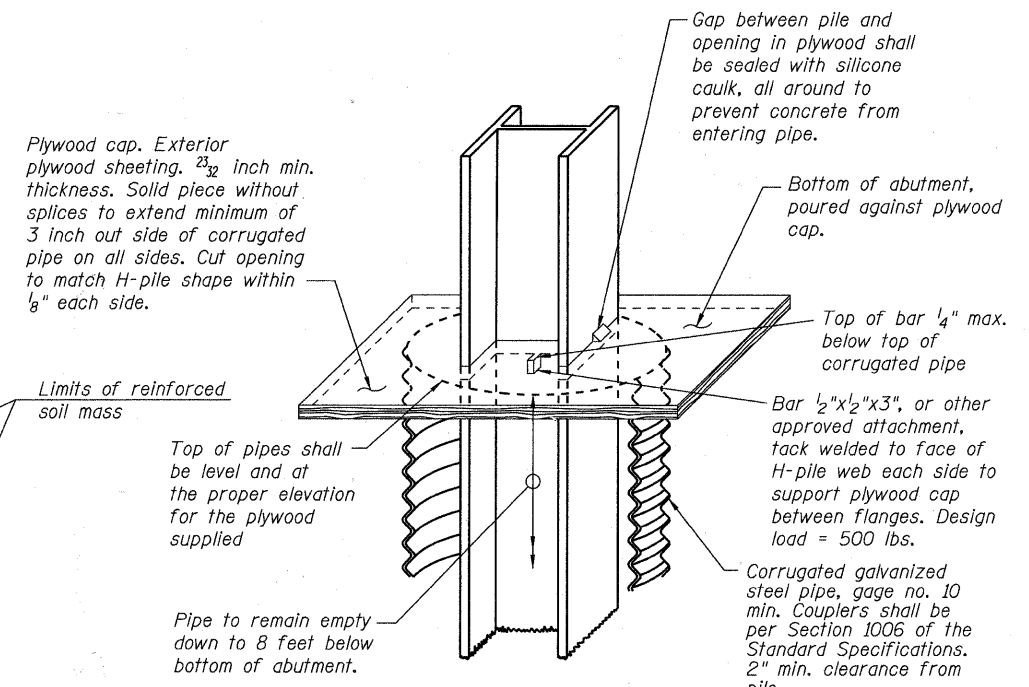

DETAIL A

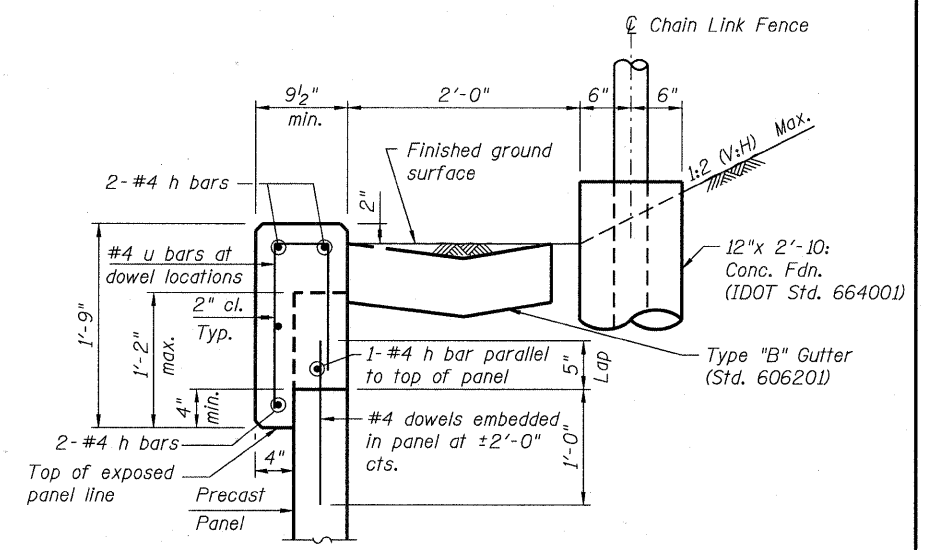

SECTION THRU MSE WALL

* Piles shall be driven prior to placement of reinforced select fill and after installation of corrugated, galvanized steel pipe shown in Detail A. Cost of corrugated, galvanized steel pipe and all labor and materials necessary to comply with detail shall be included in the "Furnishing Piles" pay items.

** Overexcavation beyond the limits of Structure excavation. This area not measured for payment. Backfill overexcavation with same material as used for select fill.

Bollinger, Lach & Associates, Inc.
ITASCA, ILLINOIS

USER NAME =	DESIGNED SRT	REVISED -
PLOT SCALE =	CHECKED JJI	REVISED -
PLOT DATE =	DRAWN GM	REVISED -
	CHECKED JJI	REVISED -

STATE OF ILLINOIS
GREAT WESTERN TRAIL
ST. CHARLES ROAD

MSE WALL DETAILS
STRUCTURE NUMBER 022-3120
SHEET NO. 24 OF 29 SHEETS

F.A. RTE.	SECTION	COUNTY	TOTAL SHEETS	SHEET NO.
	06-00151-00-BR	DuPAGE	201	141
			CONTRACT NO. 63568	
ILLINOIS FED. AID PROJECT				