

LEFT EDGE OF APPROACH PAVEMENT

Location	Station	Offset Lt.	Theoretical Grade Elevations
A	50+54.04	22.42	701.32
B	50+64.04	22.42	701.20
C	50+74.04	22.42	701.08
D	50+84.04	22.42	700.98

LEFT EDGE OF TRAFFIC LANE

Location	Station	Offset Lt.	Theoretical Grade Elevations
A	50+49.18	12.00	701.59
B	50+59.18	12.00	701.47
C	50+69.18	12.00	701.36
D	50+79.18	12.00	701.25

CENTERLINE

Location	Station	Offset	Theoretical Grade Elevations
A	50+43.58	0.00	701.84
B	50+53.58	0.00	701.72
C	50+63.58	0.00	701.60
D	50+73.58	0.00	701.49

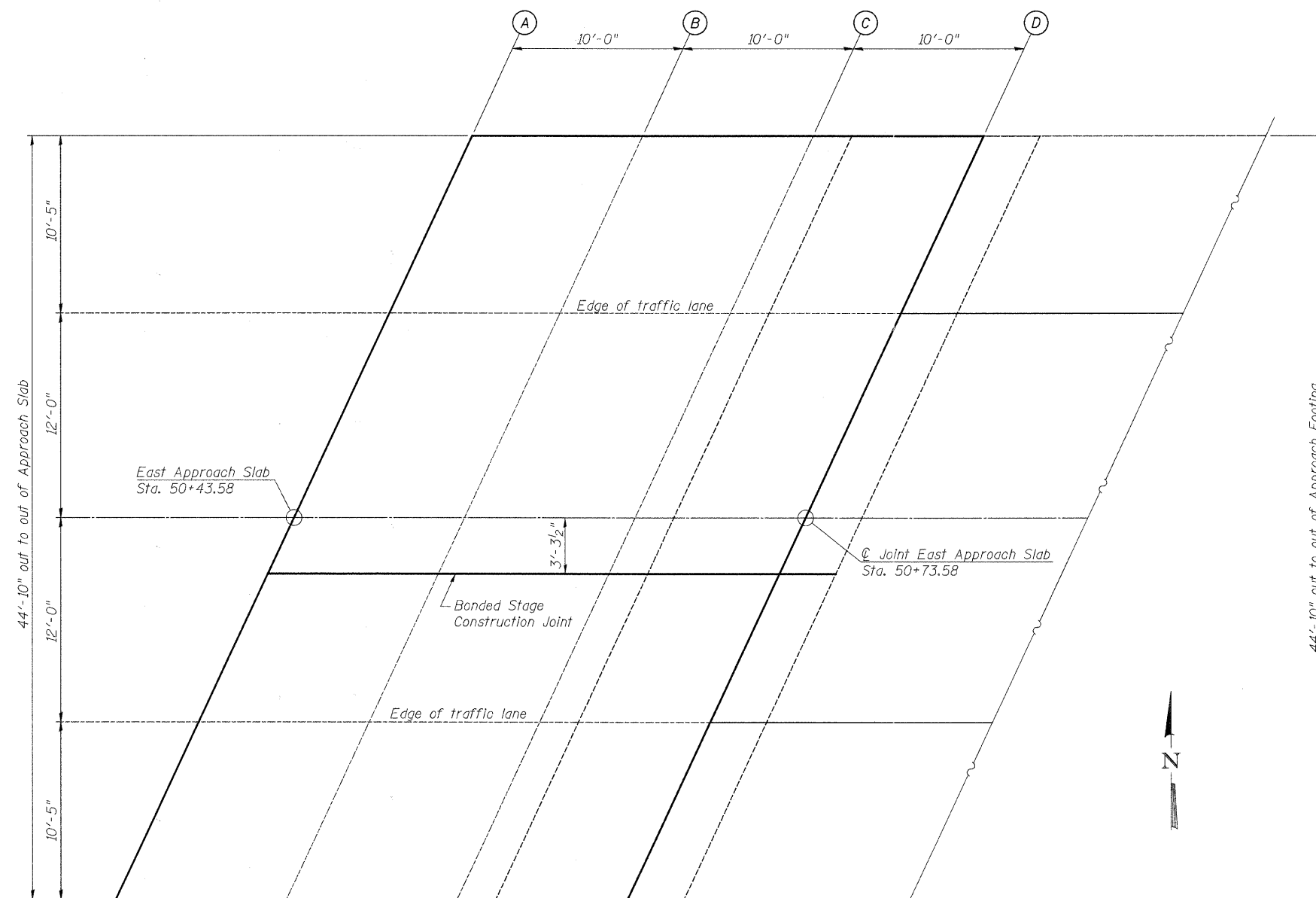

PLAN

BONDED STAGE CONSTRUCTION JOINT

Location	Station	Offset Rt.	Theoretical Grade Elevations
A	50+42.04	3.29	701.81
B	50+52.04	3.29	701.69
C	50+62.04	3.29	701.57
D	50+72.04	3.29	701.45

RIGHT EDGE OF TRAFFIC LANE

Location	Station	Offset Rt.	Theoretical Grade Elevations
A	50+37.99	12.00	701.73
B	50+47.99	12.00	701.60
C	50+57.99	12.00	701.48
D	50+67.99	12.00	701.37

RIGHT EDGE OF APPROACH PAVEMENT

Location	Station	Offset Rt.	Theoretical Grade Elevations
A	50+33.13	22.42	701.57
B	50+43.13	22.42	701.45
C	50+53.13	22.42	701.32
D	50+63.13	22.42	701.21

FILE = S:\Struct\1033004-Indiana Avenue\Design\Structural Drawings\10330041 Top of East Approach Slab Elevations.dgn

REVISION	DATE	BY	REMARKS

ILLINOIS DEPARTMENT OF TRANSPORTATION
BRIDGE REPLACEMENT
INDIANA AVENUE (CH 24) OVER TRIM CREEK

WILLET HOFMANN & ASSOCIATES, INC.
 ENGINEERING, ARCHITECTURE, LAND SURVEYING
 809 EAST 2ND STREET, DIXON, IL 61021-0267
 T: 815-284-3381 FAX: 815-284-3381

WILL COUNTY

TOP OF EAST APPROACH SLAB ELEVATIONS
STRUCTURE NO. 099-3378
STRUCTURAL SHEET NO. 7 OF 19 SHEETS

SECTION	COUNTY	TOTAL SHEETS	SHEET NO.
01-00042-07-BR	WILL	58	20
STA. 47+00	STA. 53+50		
WHA #: 1033004	DATE: 6/9/2011		

CONTRACT NO. 63617