

MACTHLINE STA 96+60
SEE SHEET 11 FOR CONTINUATION

MACTHLINE STA 105+50
SEE SHEET 12 FOR CONTINUATION

PAVEMENT MARKING LEGEND			
①	THERMOPLASTIC PAVEMENT MARKING, LETTERS AND SYMBOLS	④	THERMOPLASTIC PAVEMENT MARKING, 24" SOLID WHITE
②	THERMOPLASTIC PAVEMENT MARKING, 6" SOLID WHITE LINE	⑤	THERMOPLASTIC PAVEMENT MARKING, 4" WHITE SKIP-DASH (10' DASH, 30' SKIP)
③	THERMOPLASTIC PAVEMENT MARKING, 6" WHITE SKIP-DASH (2' DASH, 6' SKIP)	⑥	THERMOPLASTIC PAVEMENT MARKING, 12" SOLID WHITE DIAGONAL (10' C-C)

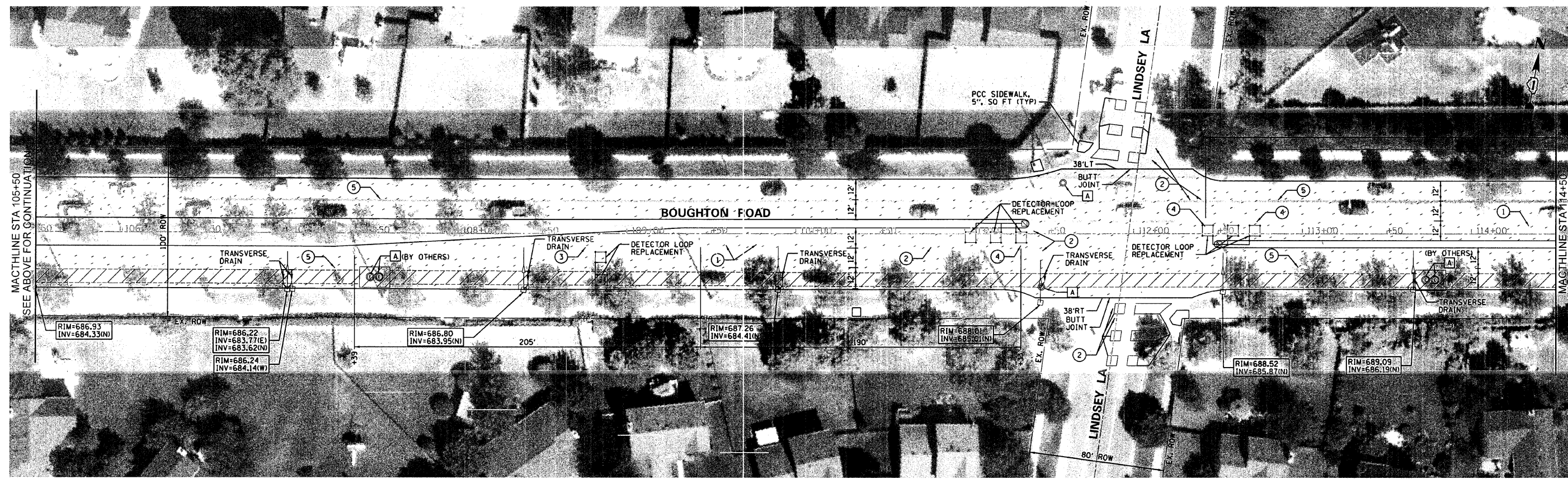

MACTHLINE STA 105+50
SEE ABOVE FOR CONTINUATION

MACTHLINE STA 114+50
SEE SHEET 13 FOR CONTINUATION

FILE NAME =	USER NAME = .USER.	DESIGNED - J.W	REVISED -	STATE OF ILLINOIS DEPARTMENT OF TRANSPORTATION	BOUGHTON ROAD RESURFACING PLAN	F.A.U. RTE.	SECTION	COUNTY	TOTAL SHEETS	SHEET NO.
ns\dgn\bb\bb04boughton\resurfacing\sheet\BB04Plan04.dgn		DRAWN - G.R	REVISED -			3586	11-00056-00-RS	WILL	35	12
PLOT SCALE = 30.00 ft / IN.		CHECKED - E.J / D.R.	REVISED -			CONTRACT NO. 63621				
PLOT DATE = 7/20/2011		DATE -	REVISED -			ILLINOIS FED. AID PROJECT				

SCALE: 1"=30' SHEET NO. 12 OF 35 SHEETS STA. 96+60 TO STA. 114+50