

PRE-STAGE

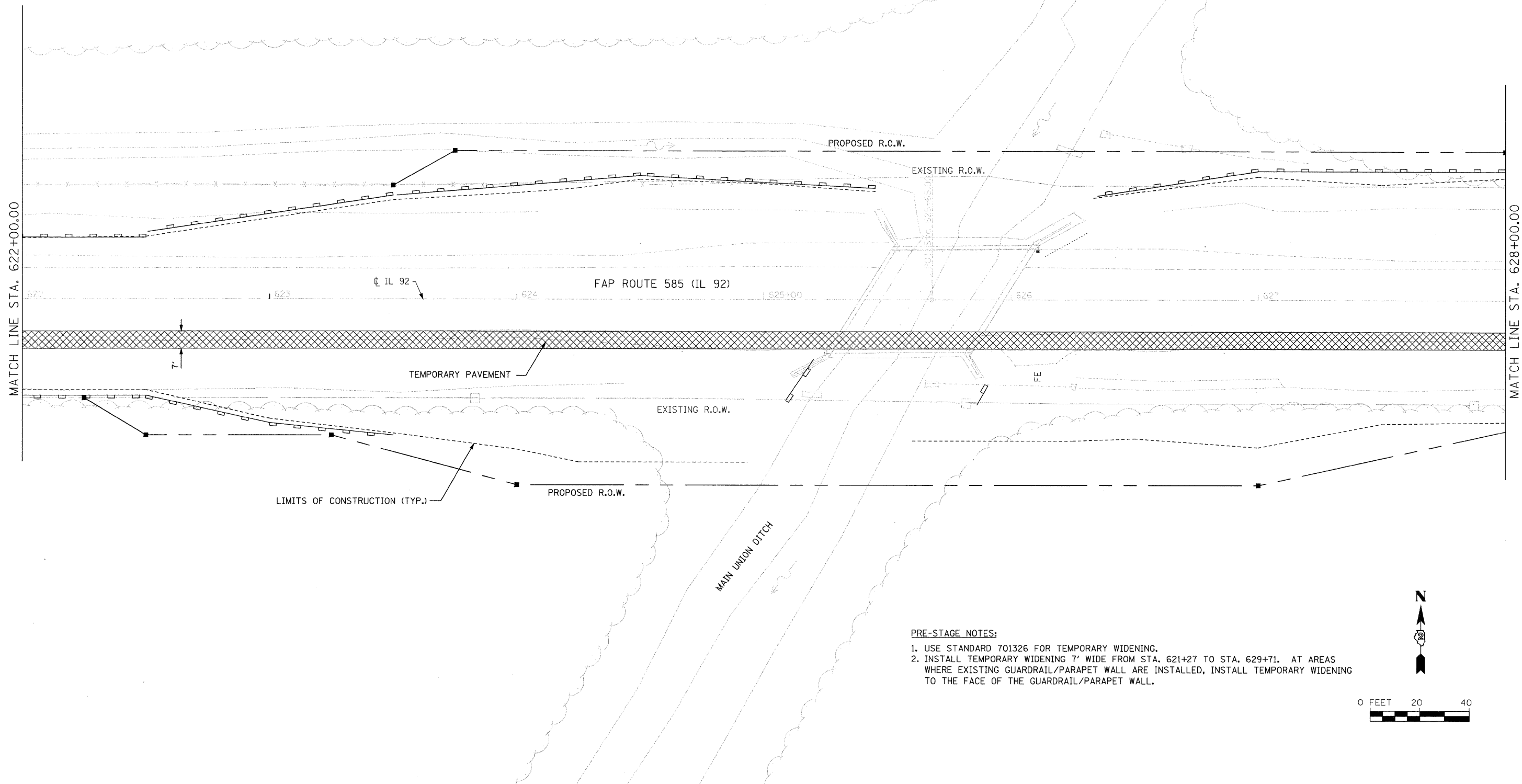

PRE-STAGE NOTES:

1. USE STANDARD 701326 FOR TEMPORARY WIDENING.
2. INSTALL TEMPORARY WIDENING 7' WIDE FROM STA. 621+27 TO STA. 629+71. AT AREAS WHERE EXISTING GUARDRAIL/PARAPET WALL ARE INSTALLED, INSTALL TEMPORARY WIDENING TO THE FACE OF THE GUARDRAIL/PARAPET WALL.

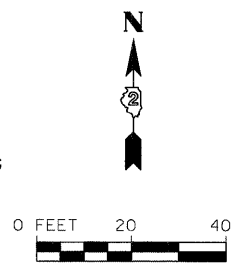

FILE NAME = s:\p\16300-6395\6346\027\mcras\hht\hht-2.dgn

STRAND ASSOCIATES, INC.
ENGINEERS

1170 SOUTH HOUBOLT ROAD
JOLIET, ILLINOIS 60431
(815) 744-4200

USER NAME = brianf	DESIGNED -	REVISED -
PLOT SCALE = 20.0000' / IN.	DRAWN -	REVISED -
PLOT DATE = 7/21/2011	CHECKED -	REVISED -
	DATE -	REVISED -

**STATE OF ILLINOIS
DEPARTMENT OF TRANSPORTATION**

SUGGESTED MAINTENANCE OF TRAFFIC			
SCALE: AS SHOWN	SHEET NO.	OF	SHEETS
			STA. 622+00 TO STA. 628+00

F.A.P. RTE. 585	SECTION 128 BR	COUNTY HENRY	TOTAL SHEETS 106	SHEET NO. 28
CONTRACT NO. 64C20				
FED. ROAD DIST. NO. 2 ILLINOIS FED. AID PROJECT				