

DATE	
BY	
SURVEYED	
PLOTTED	
NOTE BOOK	
AREAS CHECKED	

DATE	
BY	
SURVEYED	
PLOTTED	
NOTE BOOK	
AREAS CHECKED	

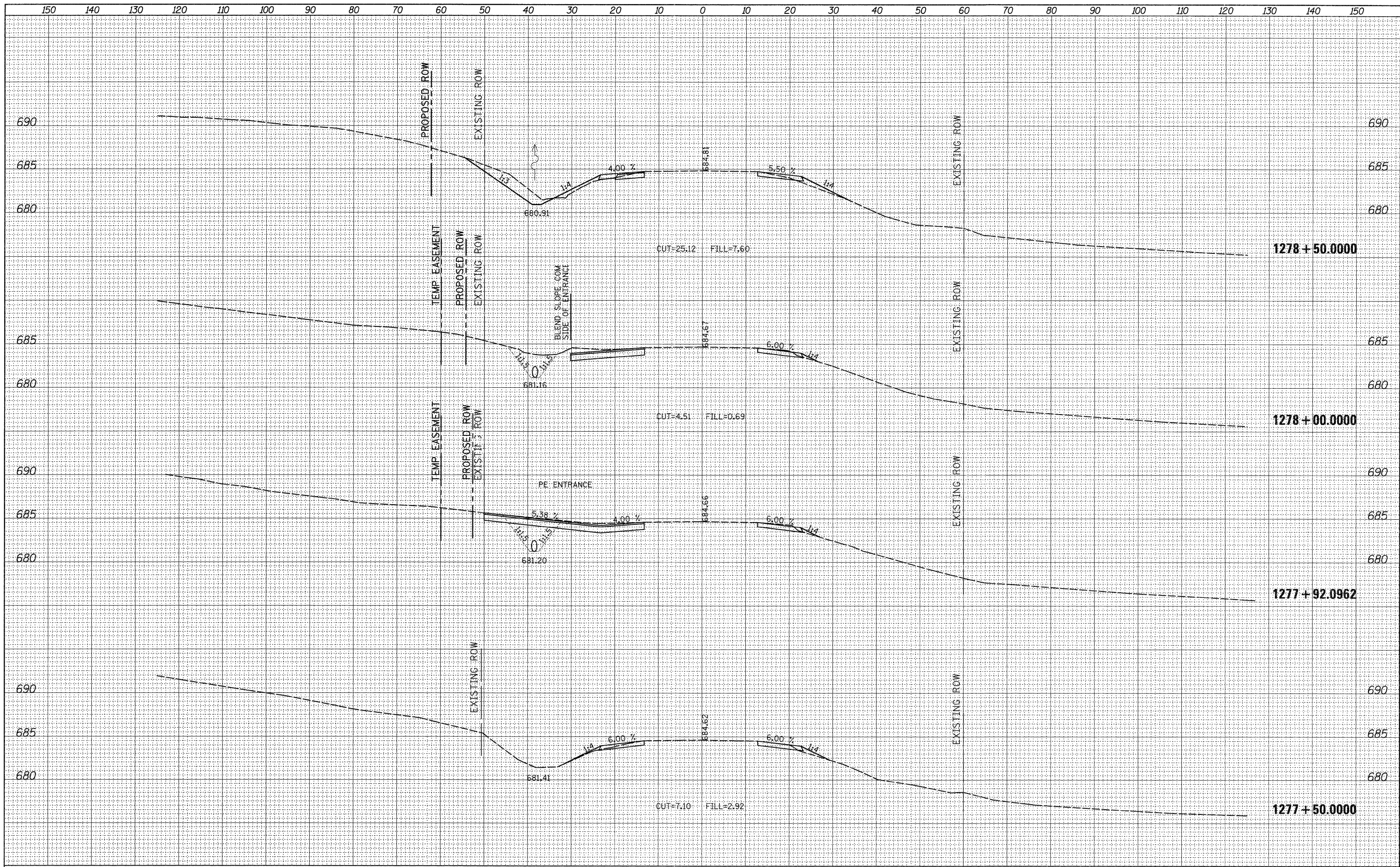

FILE NAME =	USER NAME = henssonke	DESIGNED -	REVISED -	STATE OF ILLINOIS DEPARTMENT OF TRANSPORTATION	US 30 MAINLINE CROSS SECTIONS	F.A.P. RTE. 309	SECTION 1ST-1	COUNTY WHITESIDE	TOTAL SHEETS 74	SHEET NO. 62	
ci:\pw_work\pwwid\henssonke\0133247\0206609-xsp.mxd	PLLOT SCALE = 10.0000' / in.	DRAWN -	REVISED -			SCALE:	SHEET NO.	OF	SHEETS	STA. 1277+50.0000 TO STA. 1278+50.0000	ILLINOIS FED. AID PROJECT
	PLLOT DATE = Fri Jun 24 07:45:46 2011	CHECKED -	REVISED -								CONTRACT NO. 64F23
		DATE -	REVISED -								