

DATE	
BY	
SURVEYED	
PLOTTED	
TEMPLATE	
NOTE BOOK	
AREAS CHECKED	
NO.	

DATE	
BY	
SURVEYED	
PLOTTED	
TEMPLATE	
NOTE BOOK	
AREAS CHECKED	
NO.	

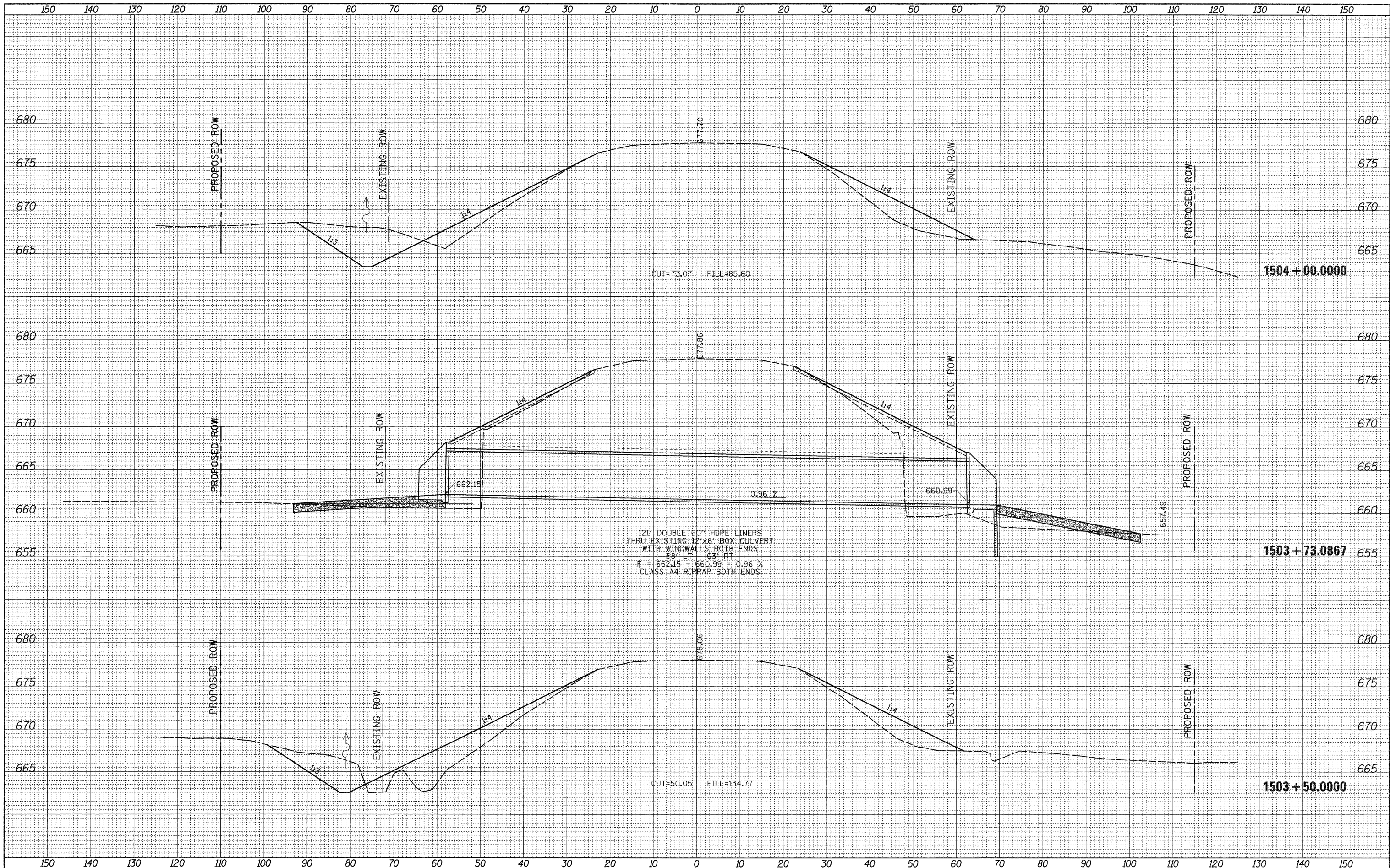

FILE NAME =	USER NAME = hansonke	DESIGNED -	REVISED -	STATE OF ILLINOIS DEPARTMENT OF TRANSPORTATION	US 30 MAINLINE CROSS SECTIONS			F.A.P. RTE. 309	SECTION 15T-1	COUNTY WHITESIDE	TOTAL SHEETS 74	SHEET NO. 72
ca:\pw_work\p\idat\hansonke\d0133247\0208609-xse.mxd		DRAWN -	REVISED -		SCALE:	SHEET NO.	OF	SHEETS	STA. 1503+50.0000 TO STA. 1504+00.0000	ILLINOIS FED. AID PROJECT		
		CHECKED -	REVISED -							CONTRACT NO. 64F23		
		DATE = Fri Jun 24 07:45:27 2011	REVISED -									