

NOTE: INSTALL DETECTION 1000 FT FROM STOP BAR

# EAST APPROACH

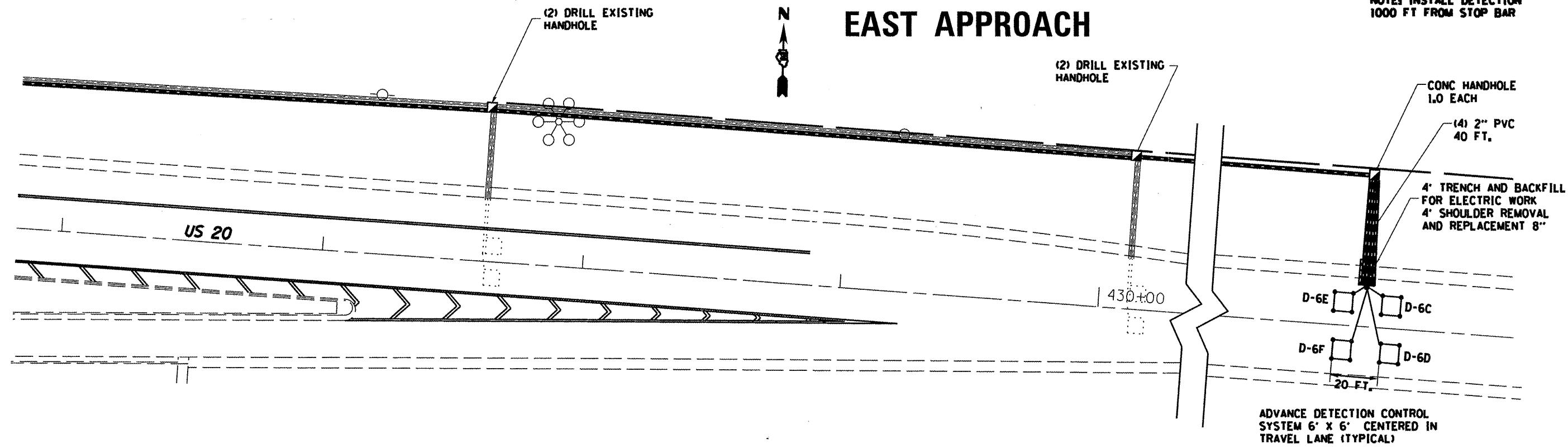

ADVANCE DETECTION CONTROL SYSTEM 6' x 6' CENTERED IN TRAVEL LANE (TYPICAL)

ADVANCE DETECTION CONTROL SYSTEM 6' x 6' CENTERED IN TRAVEL LANE (TYPICAL)

# WEST APPROACH

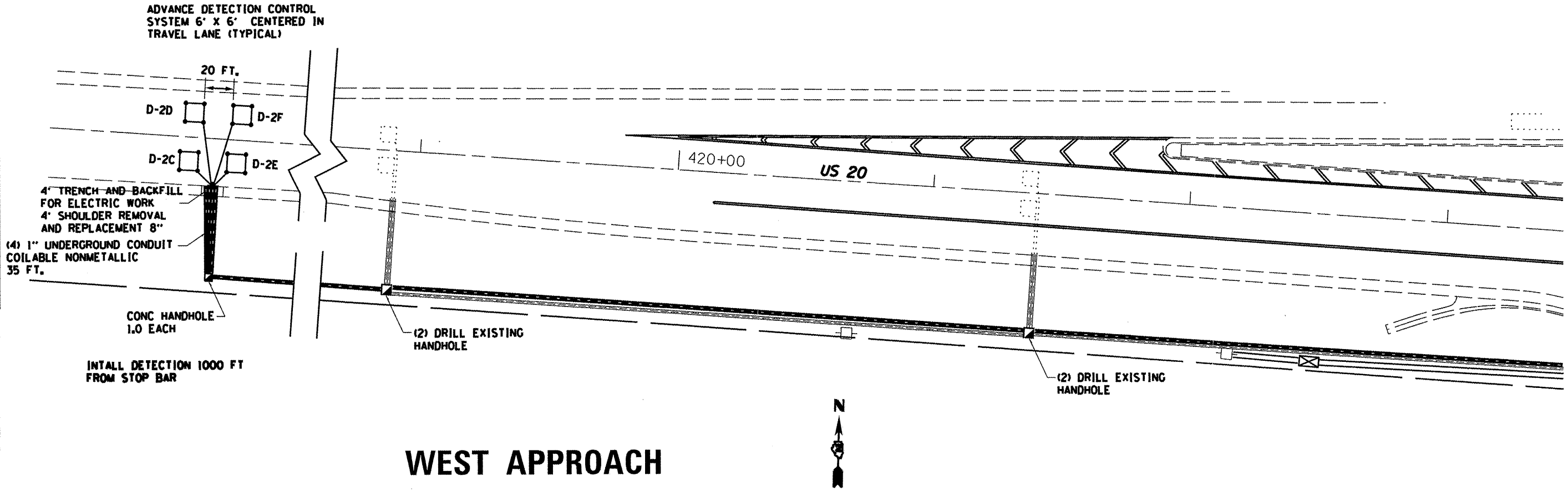

INSTALL DETECTION 1000 FT FROM STOP BAR

FILE NAME = P:\Projects\us 20 pec and winn 2011\64H	USER NAME = hllk	DESIGNED =	REVISED =
		DRAWN =	REVISED =
	PLOT SCALE = 41,009' / in.	CHECKED =	REVISED =
	PLOT DATE = Fri Jun 24 13:19:46 2011	DATE =	REVISED =

STATE OF ILLINOIS  
DEPARTMENT OF TRANSPORTATION

US 20 AT WINNEBAGO RD CABLE	
DETAIL PLAN SHEET	
SCALE: _____	SHEET NO. ____ OF ____ SHEETS STA. _____ TO STA. _____

F.A.B. RTE. 301	SECTION 07, 40M-3	COUNTY WINNEBAGO, ILL.	TOTAL SHEETS 17	SHEET NO. 10
CONTRACT NO. 64H15			ILLINOIS FED. AID PROJECT	