

- X - TREE REMOVAL
- A - ADJUST
- AN - ADJUST WITH NEW FRAME & LID
- R - REMOVE
- RM - REMOVE TO MAINTAIN FLOW

BEGIN CONSTRUCTION
STA. 129+63.51

END CONSTRUCTION
STA. 130+38.17

STA. 61+26.08 (IL 23) =
STA. 130+00 (ROOSEVELT STREET)

BENCHMARK #404:
CHIS "X" TOP NW BOLT F.H. IN
NW QUAD IL 23 & ROOSEVELT ST.
EL.=890.27

BENCHMARK #403:
RR SPIKE IN PP
@ HSE 626
EL.=884.61

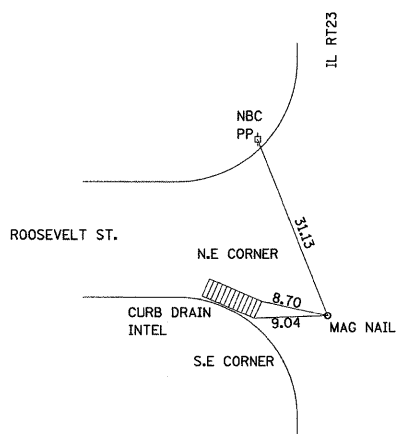

CP 23519 - STA.61+39.28 - 28.1308' RT

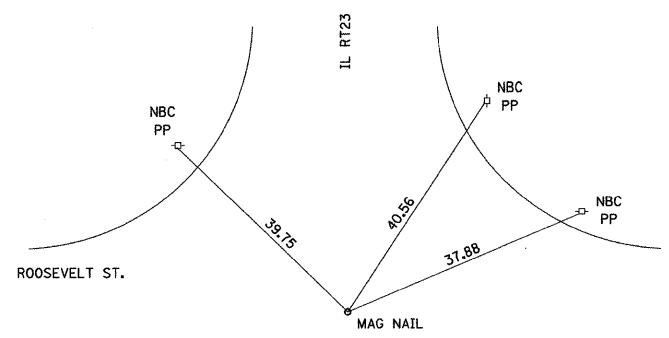

STA. 61+26.08 RT23
130+00.00 ROOSEVELT

FILE NAME =	0366983-SHT-PLAN-58-64.DGN
USER NAME =	---
PLOT SCALE =	1"=20'
PLOT DATE =	01/11

DESIGNED -	DJD
DRAWN -	NV
CHECKED -	DJD
DATE -	01/11

REVISED -	---
REVISED -	---
REVISED -	---
REVISED -	---

**STATE OF ILLINOIS
DEPARTMENT OF TRANSPORTATION**

PLAN - IL 23

SCALE: 1"=20' SHEET NO. ___ OF ___ SHEETS STA. 58+00 TO STA. 64+00

F.A.P. RTE.	SECTION	COUNTY	TOTAL SHEETS	SHEET NO.
68	(28)N, TS & I	DEKALB	120	23
CONTRACT NO. 66983				
FED. ROAD DIST. NO. - ILLINOIS FED. AID PROJECT				