

EXIST. CURVE 23S38-1  
 PI STA. = 66+60.37  
 $\Delta = 22^\circ 08' 35''$  (LT)  
 $D = 28^\circ 38' 52''$   
 $R = 200.00'$   
 $T = 39.14'$   
 $L = 77.29'$   
 $E = 3.79'$   
 P.C. STA. = 66+21.23  
 P.T. STA. = 66+98.53

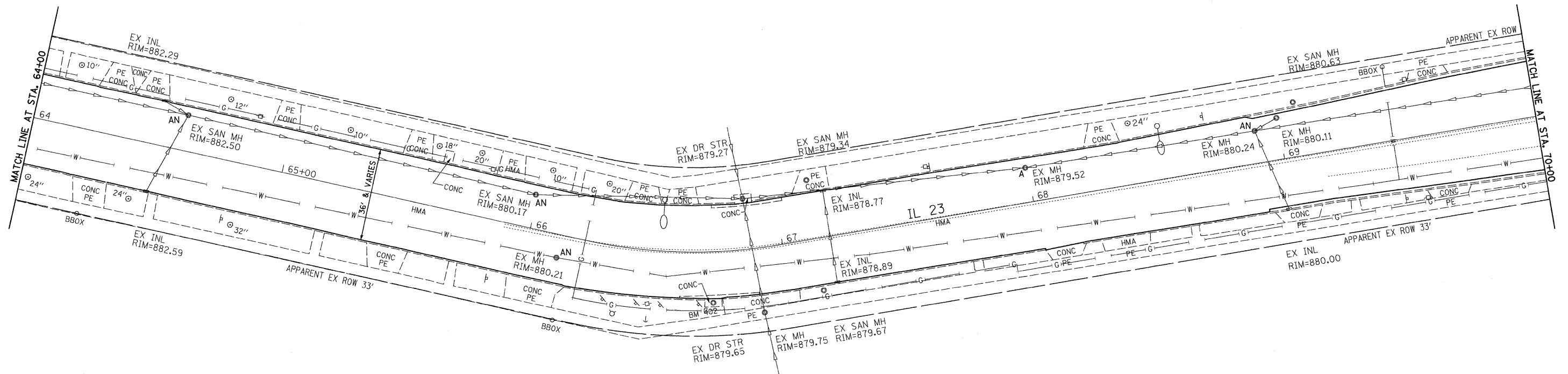

BENCHMARK #402:  
 CHIS "X" ON E EDGE MH FRAME  
 ACROSS IL RT 23 FROM HSE 712  
 EL. = 879.65

- X - TREE REMOVAL
- A - ADJUST
- AN - ADJUST WITH NEW FRAME & LID
- R - REMOVE
- RM - REMOVE TO MAINTAIN FLOW

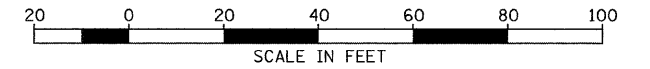
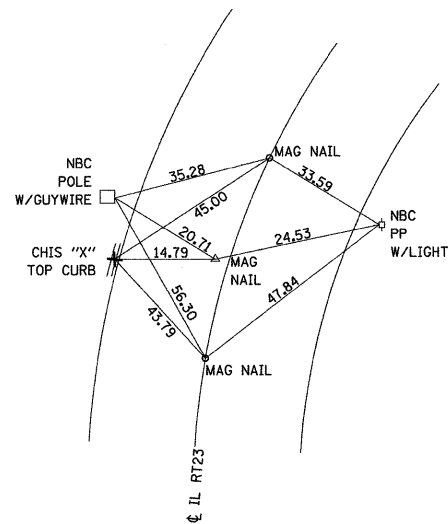

PC 66+21.23  
 PI 66+60.37  
 PT 66+98.53

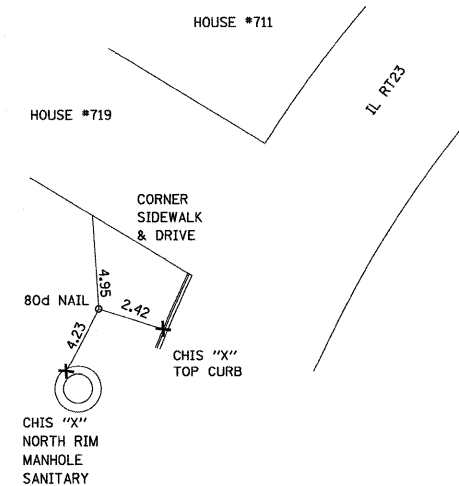

CP 23520 - STA.67+07.90 -20.9480' RT

FILE NAME =  
 0366983-SHT-PLAN-64-78.DGN

USER NAME = ---

DESIGNED - DJD  
 DRAWN - NV

REVISED - ---  
 REVISED - ---

PLOT SCALE = 1"=20'  
 PLOT DATE = 01/11

CHECKED - DJD  
 DATE - 01/11

REVISED - ---  
 REVISED - ---

STATE OF ILLINOIS  
 DEPARTMENT OF TRANSPORTATION

PLAN - IL 23

SCALE: 1"=20'

SHEET NO. \_\_\_ OF \_\_\_ SHEETS

STA. 64+00 TO STA. 70+00

F.A.P. RTE.	SECTION	COUNTY	TOTAL SHEETS	SHEET NO.
68	(28)N, TS & I	DEKALB	120	24
CONTRACT NO. 66983				
FED. ROAD DIST. NO. _ ILLINOIS FED. AID PROJECT				