

STA. 140+00 (TAYLOR STREET) =
 STA. 71+19.40 (IL 23 BK) =
 STA. 10+15.00 (IL 23 AH)

BEGIN CONSTRUCTION
 STA. 136+93.50

END CONSTRUCTION
 STA. 142+96.28

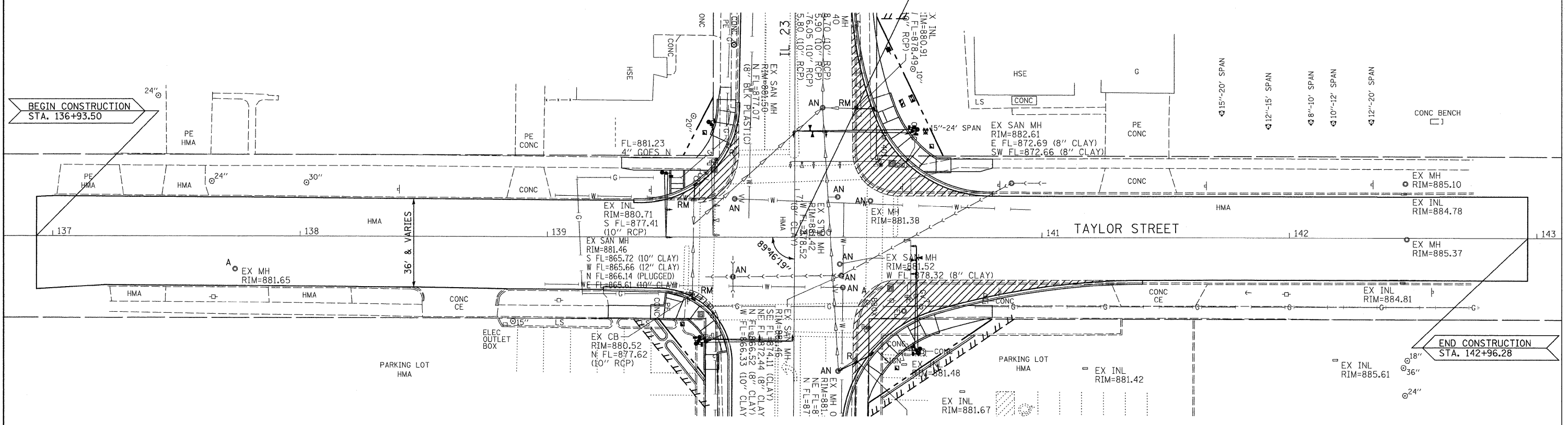

PAVEMENT WIDENING

BENCHMARK #401:
 CHIS "X" TOP NE EDGE MAST ARM
 FDN IN NE QUAD IL 23 & TAYLOR ST.
 EL.=882.08

- X - TREE REMOVAL
- A - ADJUST
- AN - ADJUST WITH NEW FRAME & LID
- R - REMOVE
- RM - REMOVE TO MAINTAIN FLOW

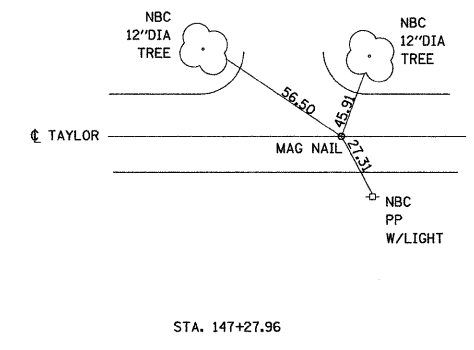
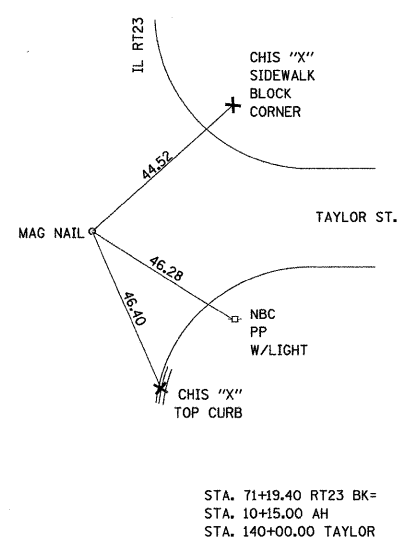
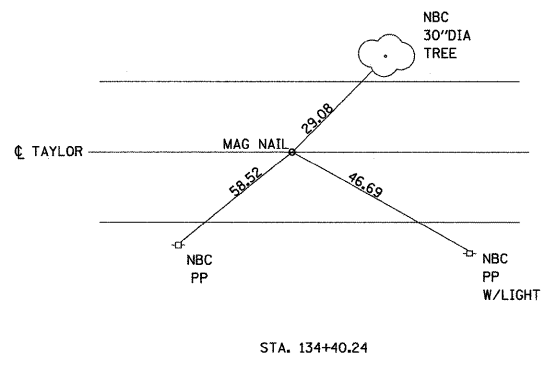

FILE NAME =
 D366983-SHT-PLAN-TAYLOR.DGN

USER NAME = ---
 DESIGNED - DJD
 DRAWN - NV
 CHECKED - DJD
 DATE - 11/10

REVISED - ---
 REVISED - ---
 REVISED - ---
 REVISED - ---

**STATE OF ILLINOIS
 DEPARTMENT OF TRANSPORTATION**

PLAN - TAYLOR STREET

SCALE: 1"=20'
 SHEET NO. ___ OF ___ SHEETS
 STA. 137+00 TO STA. 143+00

F.A.P. RTE. 68	SECTION (28N, TS & I)	COUNTY DEKALB	TOTAL SHEETS 120	SHEET NO. 27
CONTRACT NO. 66983				
FED. ROAD DIST. NO. _ ILLINOIS FED. AID PROJECT				