

EXIST. CURVE 23N38-1
 PI STA. = 25+81.10
 $\Delta = 21^\circ 34' 32''$ (RT)
 $D = 35^\circ 59' 31''$
 $R = 159.19'$
 $T = 30.33'$
 $L = 59.95'$
 $E = 2.86'$
 P.C. STA. = 25+50.77
 P.T. STA. = 26+10.71

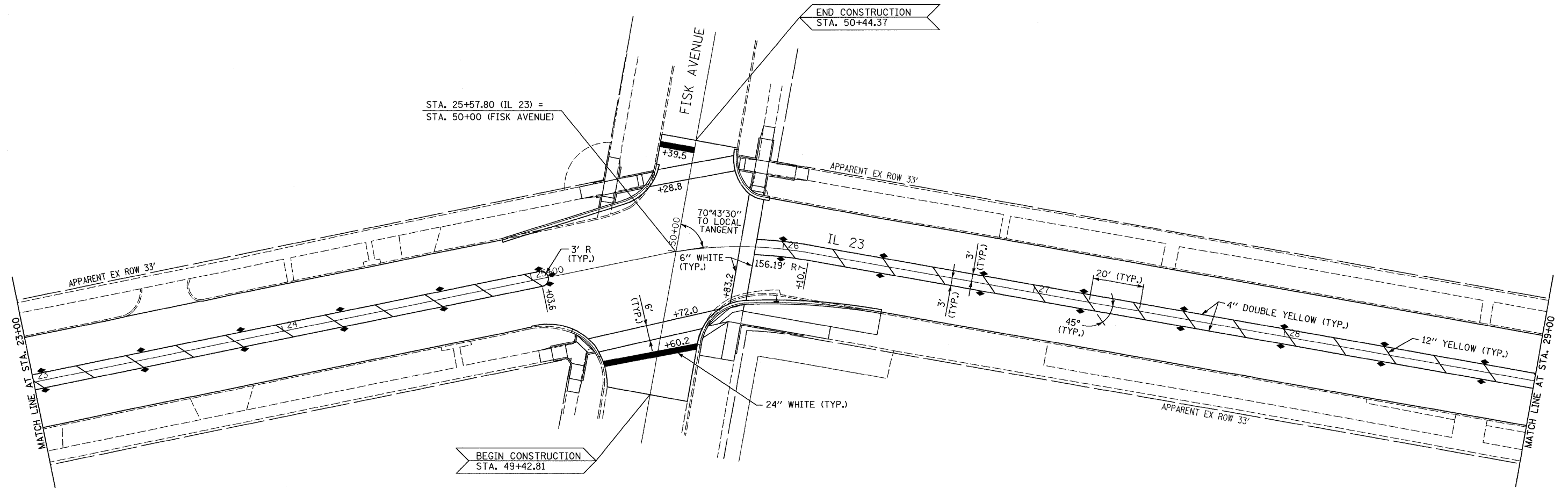
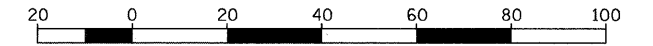

LEGEND

- ▶ ONE-WAY AMBER MARKER
 - ▷ ONE-WAY CRYSTAL MARKER
 - ◆ TWO-WAY AMBER MARKER
- SEE HIGHWAY STANDARD 781001

FILE NAME = 0366983-SHT-PMK-23-29.DGN	USER NAME = ---	DESIGNED - DJD	REVISED - ---	STATE OF ILLINOIS DEPARTMENT OF TRANSPORTATION	PAVEMENT MARKING & SIGNING - IL 23	F.A.P. RTE. 68	SECTION (28)N, TS & I	COUNTY DEKALB	TOTAL SHEETS 120	SHEET NO. 33
PLOT SCALE = 1"=20'		CHECKED - DJD	REVISED - ---	SCALE: 1"=20' SHEET NO. ___ OF ___ SHEETS STA. 23+00 TO STA. 29+00		CONTRACT NO. 66983				
PLOT DATE = 01/11		DATE - 01/11	REVISED - ---	FED. ROAD DIST. NO. - ILLINOIS FED. AID PROJECT						