

STA. 11+59.00 (LINCOLN HWY / IL 38) =
STA. 41+42.40 (IL 23)

END CONSTRUCTION
STA. 15+16.27

STA. 11+60.54 (LINCOLN HWY / IL 38) =
STA. 41+42.40 (IL 23)

LEGEND

- ▶ ONE-WAY AMBER MARKER
- ▷ ONE-WAY CRYSTAL MARKER
- ◆ TWO-WAY AMBER MARKER

SEE HIGHWAY STANDARD 781001

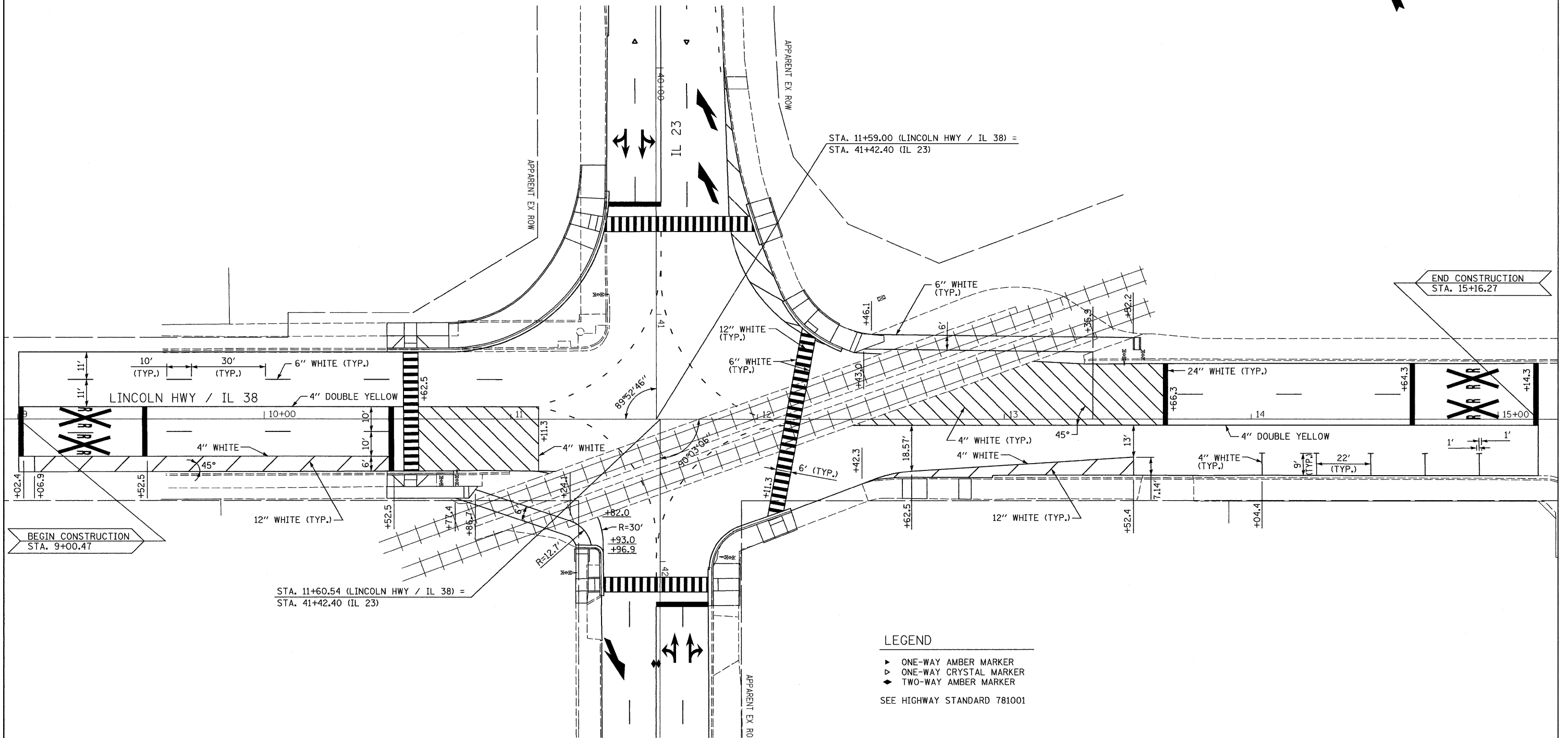

FILE NAME =
0366983-SHT-PMK-LINCOLN.DGN

USER NAME = ---
DESIGNED - DJD
DRAWN - NV
CHECKED - DJD
PLOT SCALE = 1"=20'
PLOT DATE = 01/11

REVISI...
REVISI...
REVISI...
REVISI...

DATE - 01/11
REVISI...

**STATE OF ILLINOIS
DEPARTMENT OF TRANSPORTATION**

PAVEMENT MARKING & SIGNING - LINCOLN HIGHWAY /IL 38

SCALE: 1"=20' SHEET NO. ___ OF ___ SHEETS STA. 40+00 TO STA. 46+00

F.A.P. RTE. 68	SECTION (28)N, TS & I	COUNTY DEKALB	TOTAL SHEETS 120	SHEET NO. 42
CONTRACT NO. 66983				
FED. ROAD DIST. NO. _ ILLINOIS FED. AID PROJECT				