

CONSTRUCTION NOTES:

1. NEW AND EXISTING HANDHOLES SHALL BE USED AS SHOWN.

SCHEDULE OF QUANTITIES

ITEM NO.	DESCRIPTION	UNIT	TOTAL QUANTITY
81012600	CONDUIT IN TRENCH, 2" DIA., PVC	FOOT	210
81021330	CONDUIT PUSHED, 2" DIA., PVC	FOOT	118
81900200	TRENCH AND BACKFILL FOR ELECTRICAL WORK	FOOT	316
86400100	TRANSCIEVER-FIBER OPTIC	EACH	1
87100160	FIBER OPTIC CABLE IN CONDUIT 62.5/125 24F	FOOT	817
*3002214	ELECTRIC CABLE IN CONDUIT, TRACER, NO. 14 1C	FOOT	817

• QUANTITY INCLUDED WITH TRAFFIC SIGNAL PLANS

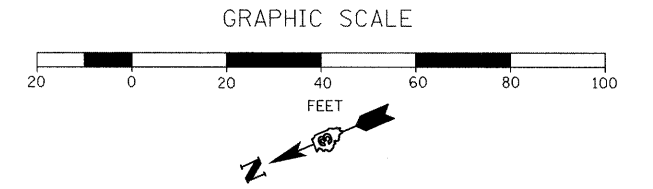

NOTE:
SEE INTERSECTION PLAN SHEETS FOR CONDUIT LENGTHS AND DESCRIPTIONS NOT SHOWN.

• RE-USE EXISTING CONDUIT

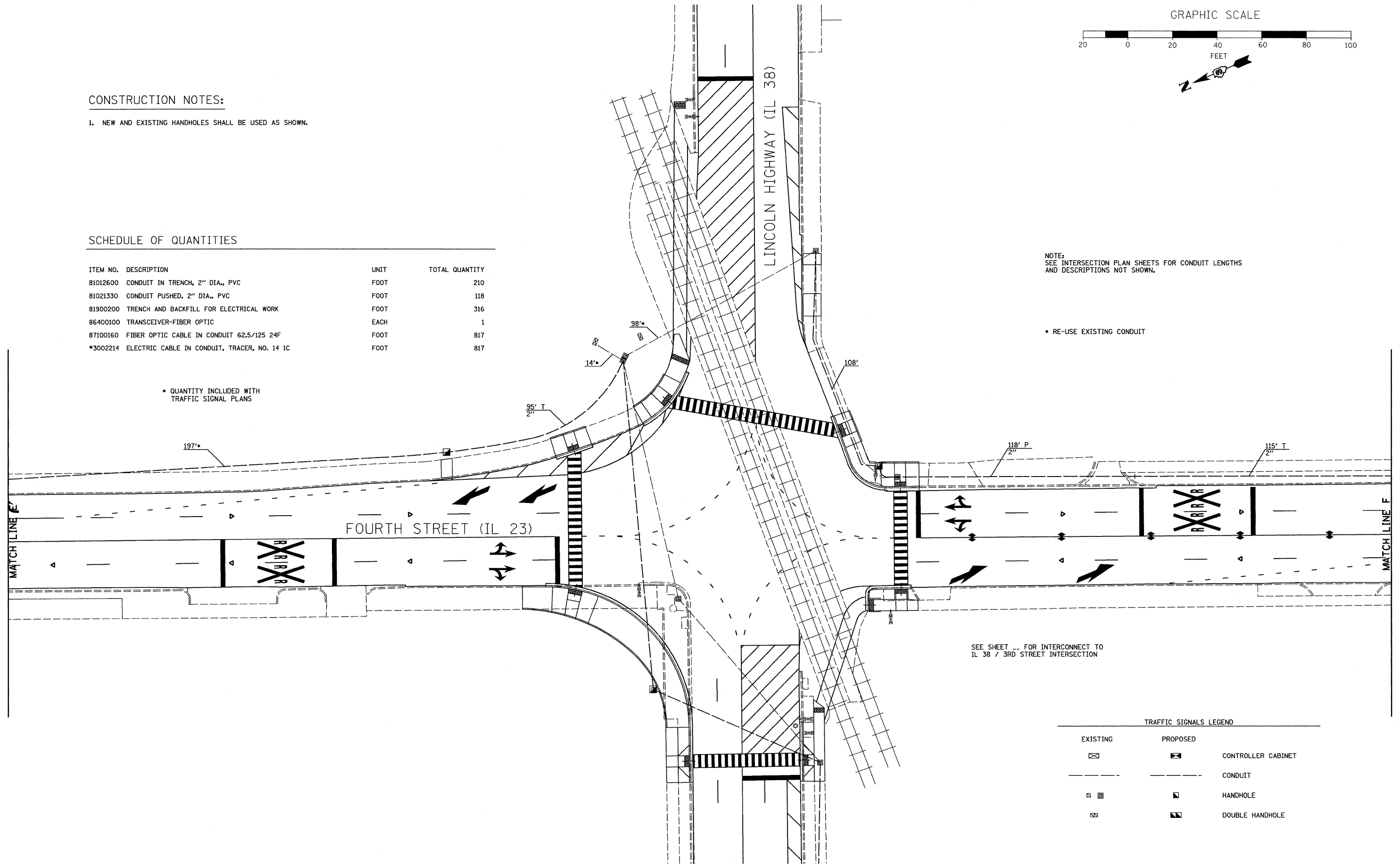

SEE SHEET ... FOR INTERCONNECT TO IL 38 / 3RD STREET INTERSECTION

TRAFFIC SIGNALS LEGEND

EXISTING	PROPOSED	
		CONTROLLER CABINET
		CONDUIT
		HANDHOLE
		DOUBLE HANDHOLE

FILE NAME = 0366983-SHT-TS-INTERCONNECT.DGN

USER NAME = --

DESIGNED - DJD
DRAWN - ARR

REVISED - ---
REVISED - ---

PLOT SCALE = 1" = 20'

CHECKED - DJD

REVISED - ---

PLOT DATE = 01/11

DATE - 01/11

REVISED - ---

**STATE OF ILLINOIS
DEPARTMENT OF TRANSPORTATION**

**TRAFFIC SIGNAL INTERCONNECT PLAN
FAP 68 (IL 23)/FOURTH STREET**

SCALE: 1" = 20'

SHEET NO. ___ OF ___ SHEETS STA. _____ TO STA. _____

F.A.P. RTE.	SECTION	COUNTY	TOTAL SHEETS	SHEET NO.
68	(28)N, TS & I	DEKALB	120	85

CONTRACT NO. 66983

ILLINOIS FED. AID PROJECT