

TIE SHEET

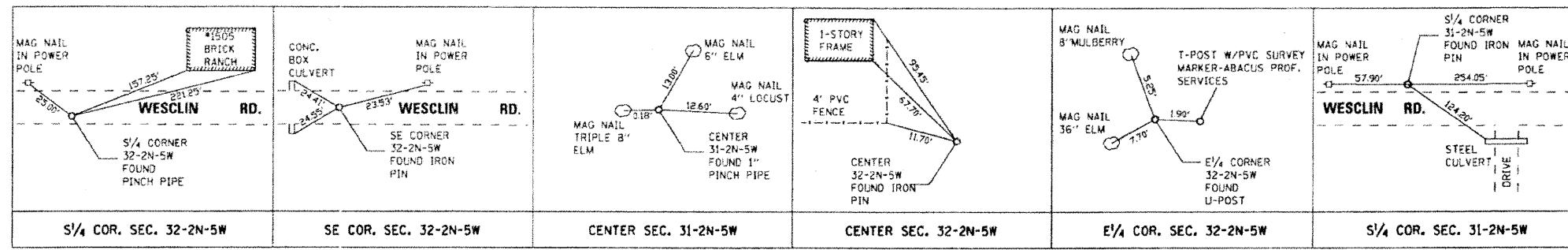

SPACE RESERVED FOR RECORDING OFFICER

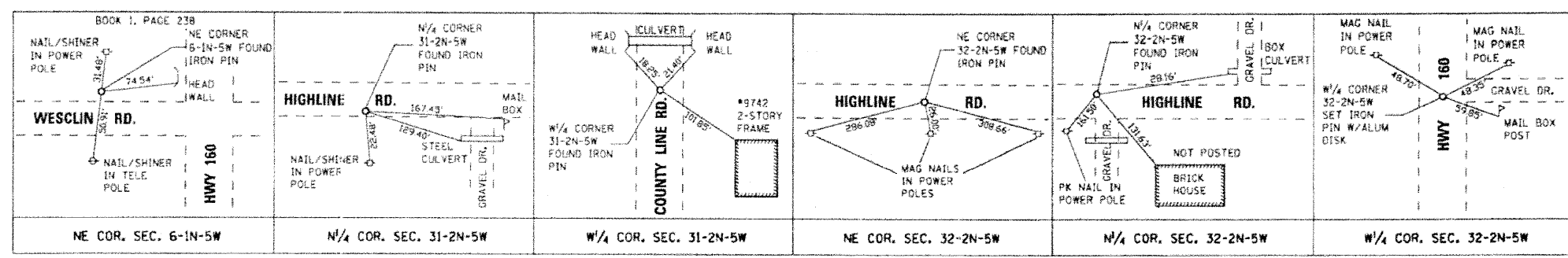

LOCATION	NORTH	EAST
NE COR 6-1N-5W	692,692.533	433,839.331
N/4 COR 31-2N-5W	697,944.537	431,265.624
W/4 COR 31-2N-5W	695,280.716	428,488.988
NE COR 32-2N-5W	698,069.189	439,281.770
N/4 COR 32-2N-5W	698,046.245	436,616.173
W/4 COR 32-2N-5W	695,314.638	433,989.979
S/4 COR 32-2N-5W	692,728.514	436,677.468
SE COR 32-2N-5W	692,749.558	439,348.150
CENTER 31-2N-5W	695,305.133	431,330.162
CENTER 32-2N-5W	695,375.809	436,651.883
E/4 COR 32-2N-5W	695,405.506	439,330.042
S/4 COR 31-2N-5W	692,690.780	431,366.824
SW COR 32-2N-5W	692,695.116	434,043.422
CL POT STA 613+00.00	695,017.567	433,995.413
CL POT STA 623+16.00	694,001.766	434,015.526
CL PC STA 624+12.60	693,905.181	434,017.438
CL PT STA 633+36.23	692,983.282	433,973.734

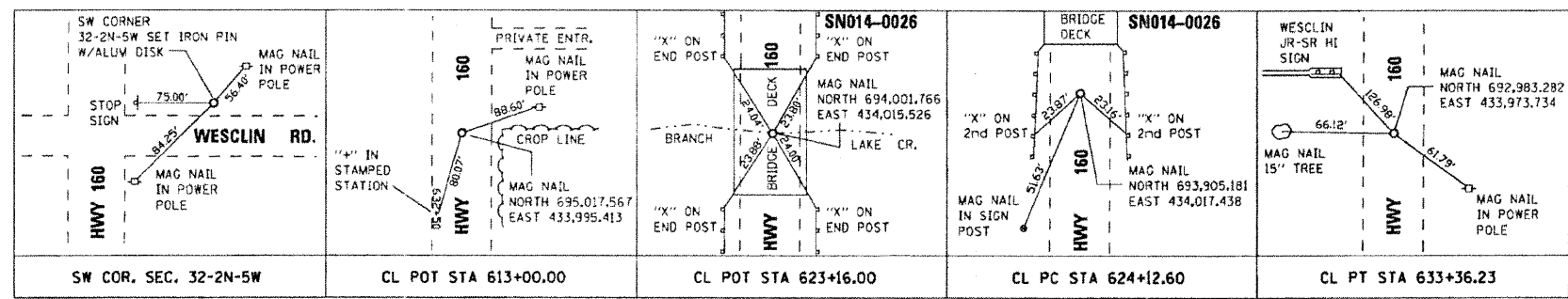

STATE OF MISSOURI)
) SS
 CITY OF ST. LOUIS)

I, RONNIE D. LOWE, AN ILLINOIS PROFESSIONAL LAND SURVEYOR, STATE THAT I HAVE SURVEYED THE PLAT OF HIGHWAY SHOWN HEREON AND THAT THIS PROFESSIONAL SERVICE CONFORMS TO THE CURRENT ILLINOIS MINIMUM STANDARDS FOR A BOUNDARY SURVEY FOR THE PROPOSED PARCEL(S) TO BE ACQUIRED BY THE STATE OF ILLINOIS, DEPARTMENT OF TRANSPORTATION, SHOWN HEREON.

DATED _____
 RONNIE D. LOWE, PLS NO. 035-003363
 LICENSE EXPIRATION DATE: 11/30/2010

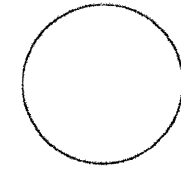

DAVID MASON & ASSOCIATES
 Engineering
 Architecture
 Surveying
 800 South Vandeventer Avenue
 St. Louis, MO 63110
 (314) 534-1930
 ILLINOIS LICENSE NO: 184-000485
 Expiration Date: April 30, 2011

ILLINOIS DEPARTMENT OF TRANSPORTATION
 PLAT OF HIGHWAYS
 FAP ROUTE 690 (IL 160)
 SECTION 481B
 CLINTON COUNTY
 JOB NO. R-98-011-09
 TIE SHEET

(NOT TO SCALE)		SHEET 6 OF 6	
ILLINOIS DEPARTMENT OF TRANSPORTATION DIVISION OF HIGHWAYS/REGION 5/DISTRICT 8 1102 EASTPORT PLAZA DRIVE COLLINGSVILLE, ILLINOIS 62234-6198			
F.A.P. RTE.	SECTION	COUNTY	TOTAL SHEETS
690	481B	CLINTON	45 16
COMPLETION DATE OF FIELD WORK PERFORMED			CONTRACT NO.
LAND SURVEY: 5/5/2009			ROW STAKING: 6/2/2009
FED. ROAD DIST. NO.		ILLINOIS FED. AID PROJECT	