

**PARTIAL INSIDE ELEVATION  
PARAPET REMOVAL & REPLACEMENT**

**MINIMUM BAR LAP**  
 #5 bar = 2'-7"  
 #8 bar = 5'-2"

\*\* Existing reinforcement in this area  
to extend 4'-6" into the removal area.

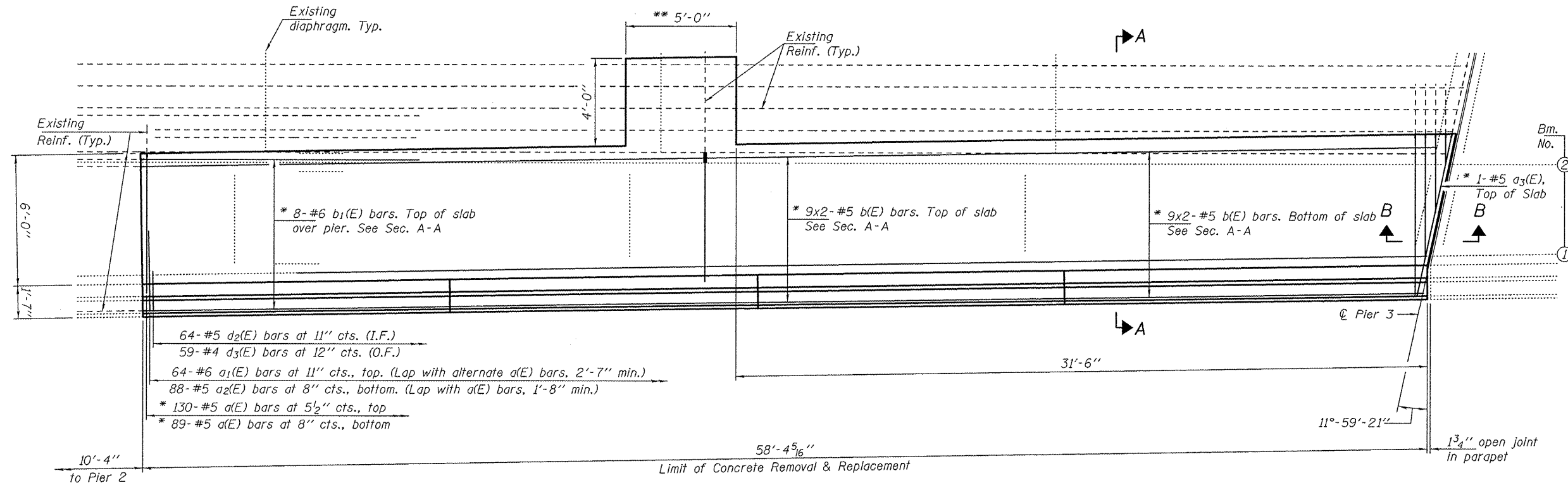

**PARTIAL PLAN  
CONCRETE REMOVAL & REPLACEMENT**

\* Attach to existing reinforcement with mechanical splicers. Existing reinforcement to extend 6" (min.) into the removal area to allow attachment of the mechanical splicers. Cut a(E) bars to fit at Pier 3.

See sheet 3 of 9 for  
Sections A-A & B-B

DESIGNED <i>ATH</i>	EXAMINED <i>Jayne F. [Signature]</i>	DATE <i>JULY 27, 2011</i>	<b>STATE OF ILLINOIS DEPARTMENT OF TRANSPORTATION</b>	<b>REPAIR DETAILS SN 060-0046</b>	F.A.I. RTE.	SECTION	COUNTY	TOTAL SHEETS	SHEET NO.	
CHECKED <i>ADY</i>	PASSED <i>[Signature]</i>				270	60-34B-1-HDF-1	MADISON	15	8	
DRAWN <i>baliva</i>					CONTRACT NO. 76F08					
CHECKED <i>ATH ADY</i>					ILLINOIS FED. AID PROJECT					