

F.A.P. RTE.	SECTION	COUNTY	TOTAL SHEETS	SHEET NO.
331	(1X-1) R-7	WILLIAMSON	79	1
FED. ROAD DIST. NO.	ILLINOIS	CONTRACT NO. 78251		

D-99-028-11

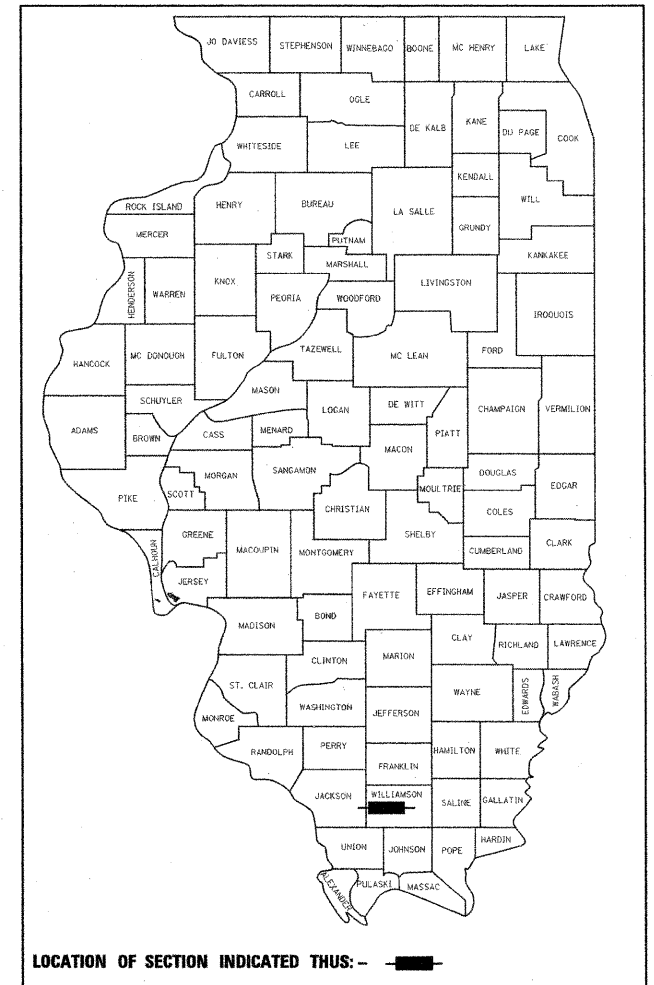

LOCATION OF SECTION INDICATED THUS: —

STATE OF ILLINOIS
DEPARTMENT OF TRANSPORTATION
DIVISION OF HIGHWAYS
PROPOSED
HIGHWAY PLANS
FAP ROUTE 331 (IL 13) FRONTAGE ROAD
SECTION (1X-1)R-7
PROJECT NHF-0331(055)
WILLIAMSON COUNTY
C-99-038-11

INDEX OF SHEETS

- 1 COVER SHEET
- 2 GENERAL NOTES, MIXTURE REQUIREMENTS AND COMMITMENTS
- 3-5 SUMMARY OF QUANTITIES
- 6 STATUS OF UTILITIES TO BE ADJUSTED
- 7-8 TYPICAL SECTIONS
- 9-10 SCHEDULES OF QUANTITIES
- 11 SITE PLAN
- 12-13 ALIGNMENT TIES AND BENCHMARKS
- 14 MAINTENANCE OF TRAFFIC CONTROL PLAN
- 15-21 PLAN AND PROFILE - FRONTAGE ROAD
- 22 PLAN AND PROFILE - MARATHON DRIVE
- 23 DRAINAGE PLAN AND PROFILE - FRONTAGE ROAD CHANNEL REALIGNMENT
- 24-27 RIGHT-OF-WAY PLANS
- 28 INTERSECTION DETAILS
- 29-33 PAVEMENT MARKING AND SIGNING PLANS
- 34-38 BOX CULVERT STRUCTURAL PLANS
- 39-42 EROSION CONTROL PLANS - FRONTAGE ROAD
- 43 EROSION CONTROL PLANS - MARATHON DRIVE
- 44 CULVERT PROFILES - FRONTAGE ROAD
- 45 MISCELLANEOUS DETAILS
- 46-51 DISTRICT HIGHWAY STANDARDS
- 52-71 CROSS SECTIONS - FRONTAGE ROAD
- 72-76 CROSS SECTIONS - MARATHON DRIVE
- 77-79 CROSS SECTIONS - FRONTAGE ROAD CHANNEL REALIGNMENT

HIGHWAY STANDARDS

- 000001-06 STANDARD SYMBOLS, ABBREVIATIONS AND PATTERNS
- 001001-02 AREAS OF REINFORCEMENT BARS
- 001006 DECIMAL OF AN INCH AND OF A FOOT
- 280001-05 TEMPORARY EROSION CONTROL SYSTEMS
- 424001-05 CURB RAMPS FOR SIDEWALKS
- 515001-03 NAME PLATE FOR BRIDGES
- 542301-03 PRECAST REINFORCED CONCRETE FLARED END SECTION
- 606001-04 CONCRETE CURB TYPE B AND COMBINATION CONCRETE CURB AND GUTTER
- 665001-02 WOVEN WIRE FENCE
- 666001-01 RIGHT OF WAY MARKERS
- 667001-01 DRAINAGE MARKERS
- 667101-01 PERMANENT SURVEY MARKERS
- 701001-02 OFF ROAD OPERATIONS, 2L, 2W, MORE THAN 15' (4.5 m) AWAY
- 701006-03 OFF ROAD OPERATIONS, 2L, 2W, 15' (4.5 m) TO 24" (600 mm) FROM EDGE OF PAVEMENT
- 701101-02 OFF-RD OPERATIONS, MULTILANE, 15' (4.5 m) TO 24" (600 mm) FROM PAVEMENT EDGE
- 701106-02 OFF-RD OPERATIONS, MULTILANE, MORE THAN 15' (4.5 m) AWAY
- 701901-01 TRAFFIC CONTROL DEVICES
- 720001-01 SIGN PANEL MOUNTING DETAILS
- 720006-02 SIGN PANEL ERECTION DETAILS
- 720011-01 METAL POSTS FOR SIGNS, MARKERS AND DELINEATORS
- 728001-01 TELESCOPING STEEL SIGN SUPPORT
- 729001-01 APPLICATIONS OF TYPES A & B METAL POSTS (FOR SIGNS & MARKERS)
- 731001-01 BASE FOR TELESCOPING STEEL SIGN SUPPORT
- 780001-02 TYPICAL PAVEMENT MARKINGS
- B.L.R. 21-8 TYPICAL APPLICATION OF TRAFFIC CONTROL DEVICES FOR CONSTRUCTION ON RURAL LOCAL HIGHWAYS

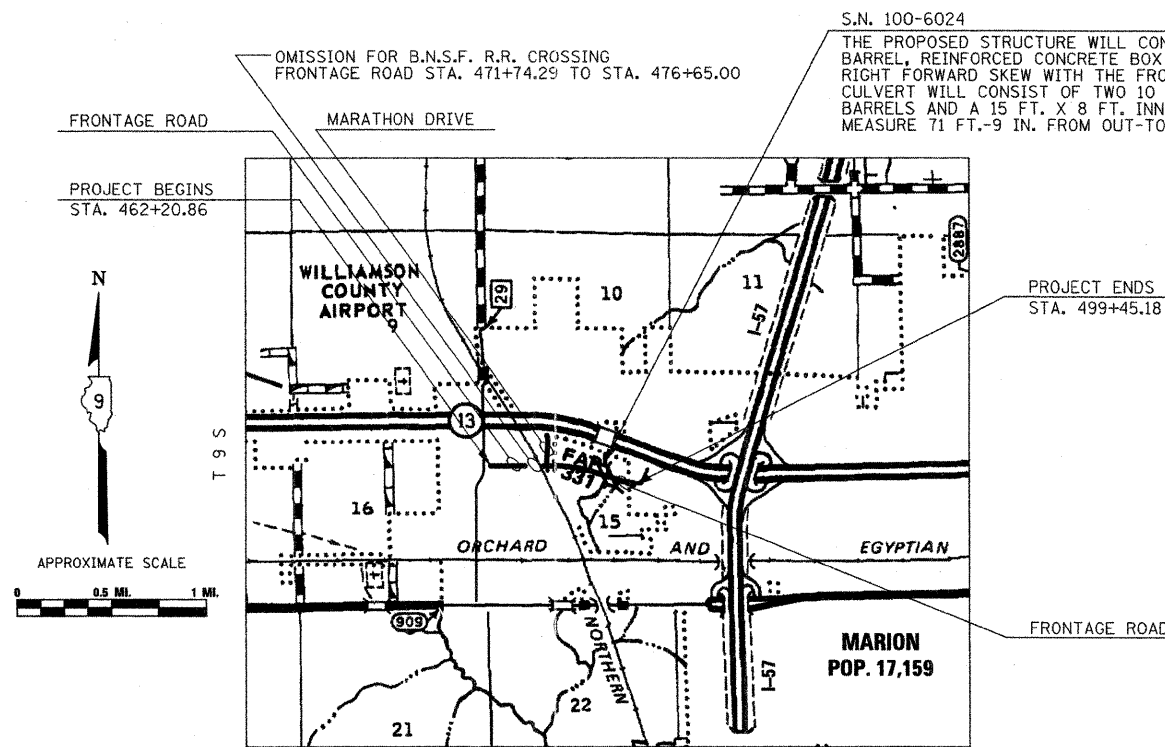

TOTAL LENGTH OF PROJECT = 4,093 FEET = 0.78 MILES
 NET LENGTH OF PROJECT = 3,234 FEET = 0.61 MILES

TRAFFIC DATA	CONSTRUCTION ADT (2014)	DESIGN ADT (2034)	% TRUCKS
MARATHON DR.	820	1,100	1.6%
FRONTAGE RD.	2,890	3,040	1.6%

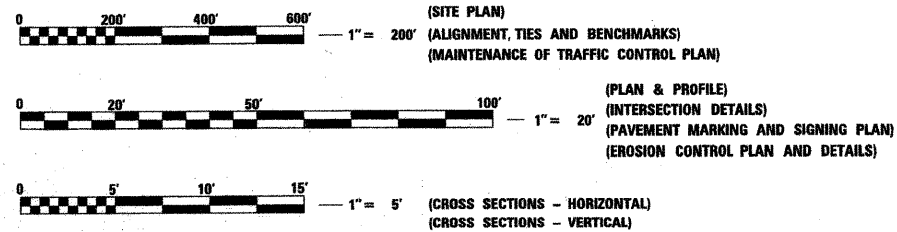

FULL SIZE PLANS HAVE BEEN PREPARED USING STANDARD ENGINEERING SCALES. REDUCED SIZED PLANS WILL NOT CONFORM TO STANDARD SCALES. IN MAKING MEASUREMENTS ON REDUCED PLANS, THE ABOVE SCALES MAY BE USED.

J.U.L.I.E.
JOINT UTILITY LOCATION INFORMATION FOR EXCAVATION
1-800-892-0123
OR 811

PROJECT ENGINEER: DAVID PICHE (618) 351-5227
CONTRACT NO. 78251

STATE OF ILLINOIS
DEPARTMENT OF TRANSPORTATION
DIVISION OF HIGHWAYS

SUBMITTED March 27, 2011
Scott E. Stitt, P.E.
 DEPUTY DIRECTOR OF HIGHWAYS, REGION ENGINEER
May 13, 2011
Scott E. Stitt, P.E.
 ACTING ENGINEER OF DESIGN AND ENVIRONMENT
May 13, 2011
Christine M. Roedel
 DIRECTOR OF HIGHWAYS, CHIEF ENGINEER

SIGNATURE: Brian M. Bond
 DATE SIGNED: 3/27/11
 LICENSE EXPIRATION DATE: 11/30/11

CMT
 CRAWFORD, MURPHY & TILLY, INC.
 CONSULTING ENGINEERS
 License No. 184-000813

PRINTED BY THE AUTHORITY
OF THE STATE OF ILLINOIS