

DATE	
BY	
SURVEYED	
PLOTTED	
NOTE BOOK	
AREAS CHECKED	
AREAS CHECKED	
NO.	

DATE	
BY	
SURVEYED	
PLOTTED	
NOTE BOOK	
AREAS CHECKED	
AREAS CHECKED	
NO.	

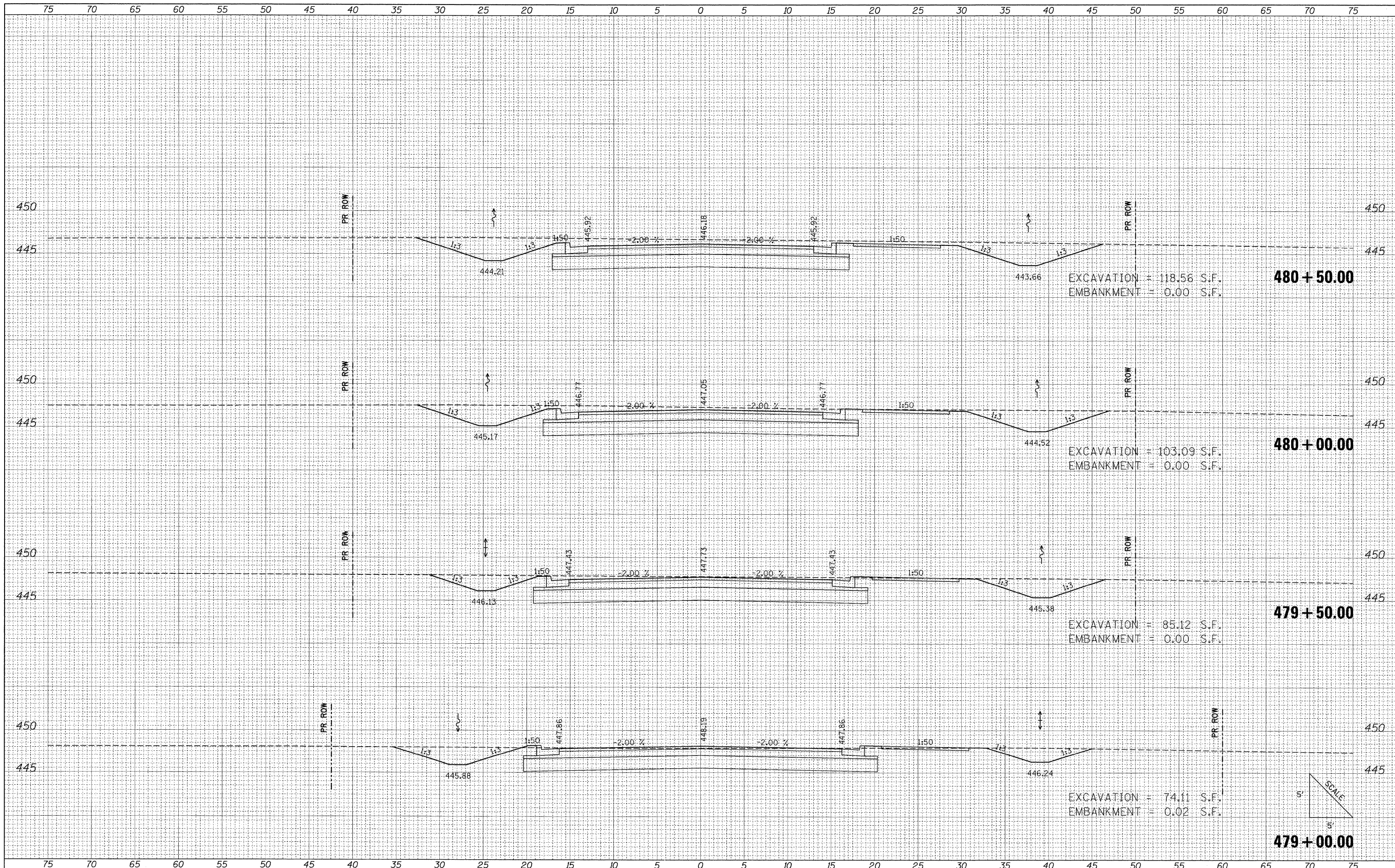

EXCAVATION = 118.56 S.F.
EMBANKMENT = 0.00 S.F.

EXCAVATION = 103.09 S.F.
EMBANKMENT = 0.00 S.F.

EXCAVATION = 85.12 S.F.
EMBANKMENT = 0.00 S.F.

EXCAVATION = 74.11 S.F.
EMBANKMENT = 0.02 S.F.

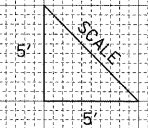

FILE NAME = I:\DOT\0906603\Draw\CADD_Sheets\Frontage Road

USER NAME = Brian Bond
Contract\0906603\Draw\Frontage.dgn
PLOT SCALE = 5.0000" / IN.
PLOT DATE = 3/17/2011

DESIGNED - BMB
DRAWN - RAH
CHECKED - SPH
DATE - 3/16/11

REVISED -
REVISED -
REVISED -
REVISED -

**STATE OF ILLINOIS
DEPARTMENT OF TRANSPORTATION**

**PROPOSED CROSS SECTIONS
FRONTAGE ROAD**

SCALE: SHEET NO. OF SHEETS STA. 479+00.00 TO STA. 480+50.00

F.A. RTE. 331	SECTION (1X-1) R-7	COUNTY WILLIAMSON	TOTAL SHEETS 79	SHEET NO. 60
CONTRACT NO. 78251				
ILLINOIS FED. AID PROJECT				