

DATE	
BY	
FINAL SURVEY	
SURVEYED	
PLOTTED	
NOTE BOOK	
REVISIONS	
AREAS CHECKED	
NO.	

DATE	
BY	
ORIGINAL SURVEY	
SURVEYED	
PLOTTED	
NOTE BOOK	
REVISIONS	
AREAS CHECKED	
NO.	

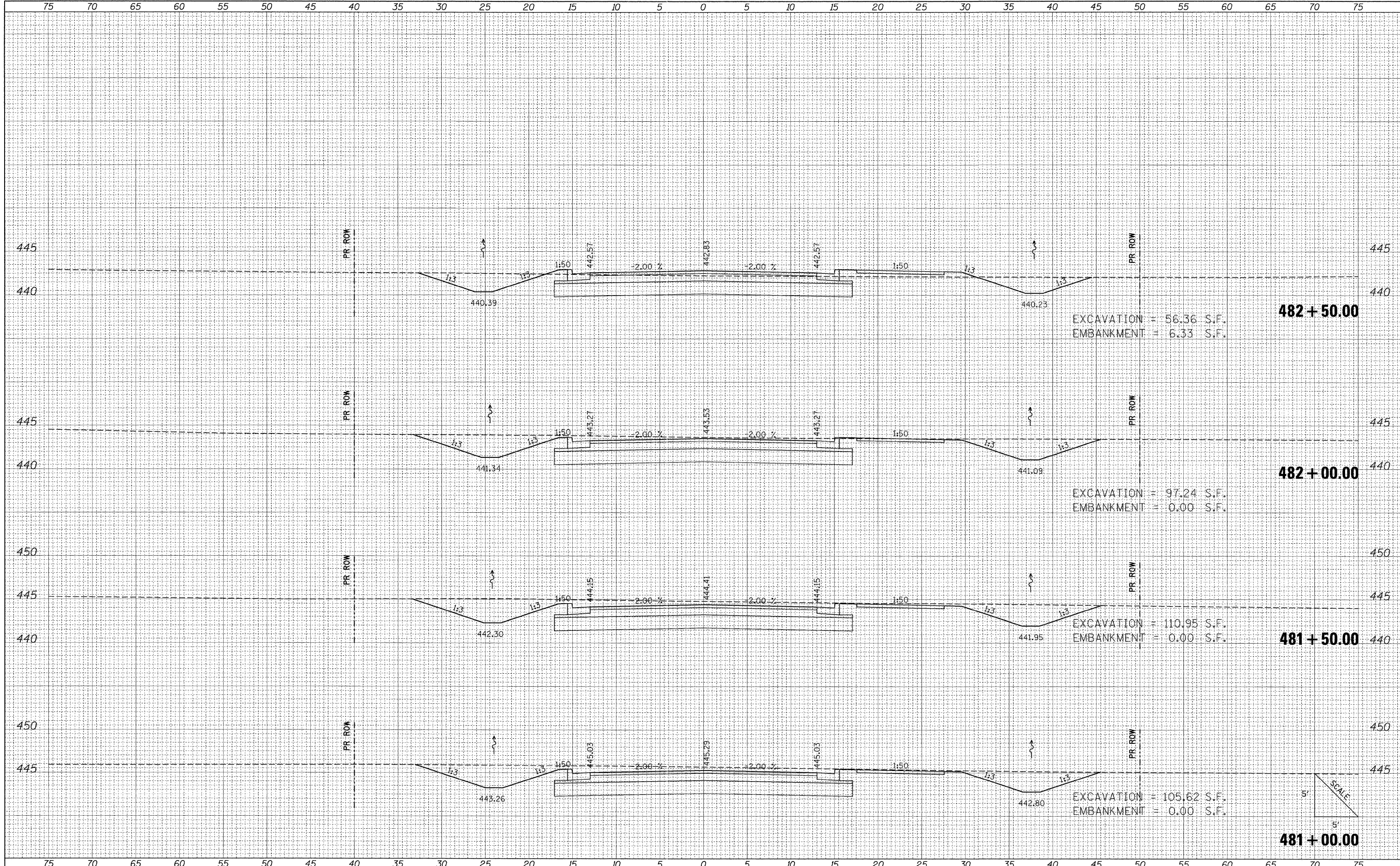

EXCAVATION = 56.36 S.F.  
EMBANKMENT = 6.33 S.F.

EXCAVATION = 97.24 S.F.  
EMBANKMENT = 0.00 S.F.

EXCAVATION = 110.95 S.F.  
EMBANKMENT = 0.00 S.F.

EXCAVATION = 105.62 S.F.  
EMBANKMENT = 0.00 S.F.

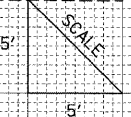

FILE NAME = I:\DOT\8\06603\Draw\CADD_Sheets\Frontage Road	USER NAME = Brian Bond	DESIGNED - BMB	REVISIONS -	<b>STATE OF ILLINOIS DEPARTMENT OF TRANSPORTATION</b>	<b>PROPOSED CROSS SECTIONS FRONTAGE ROAD</b>		F.A. RTE. 331	SECTION (IX-1) R-7	COUNTY WILLIAMSON	TOTAL SHEETS 79	SHEET NO. 61	
	Contract\09\8859\sh-x\Frontage.dgn	DRAWN - RAH	REVISIONS -		SCALE:	SHEET NO. OF SHEETS	STA. 481+00.00 TO STA. 482+50.00	CONTRACT NO. 78251				
	PLOT SCALE = 5.0000" / 1"	CHECKED - SPH	REVISIONS -		ILLINOIS FED. AID PROJECT							
	PLOT DATE = 3/16/11	DATE - 3/16/11	REVISIONS -									