

FINAL SURVEY	SURVEYED	DATE
NOTE BOOK	PLOTTED	
NO.	TEMPLATE	
	AREAS CHECKED	

ORIGINAL SURVEY	SURVEYED	DATE
NOTE BOOK	PLOTTED	
NO.	TEMPLATE	
	AREAS CHECKED	

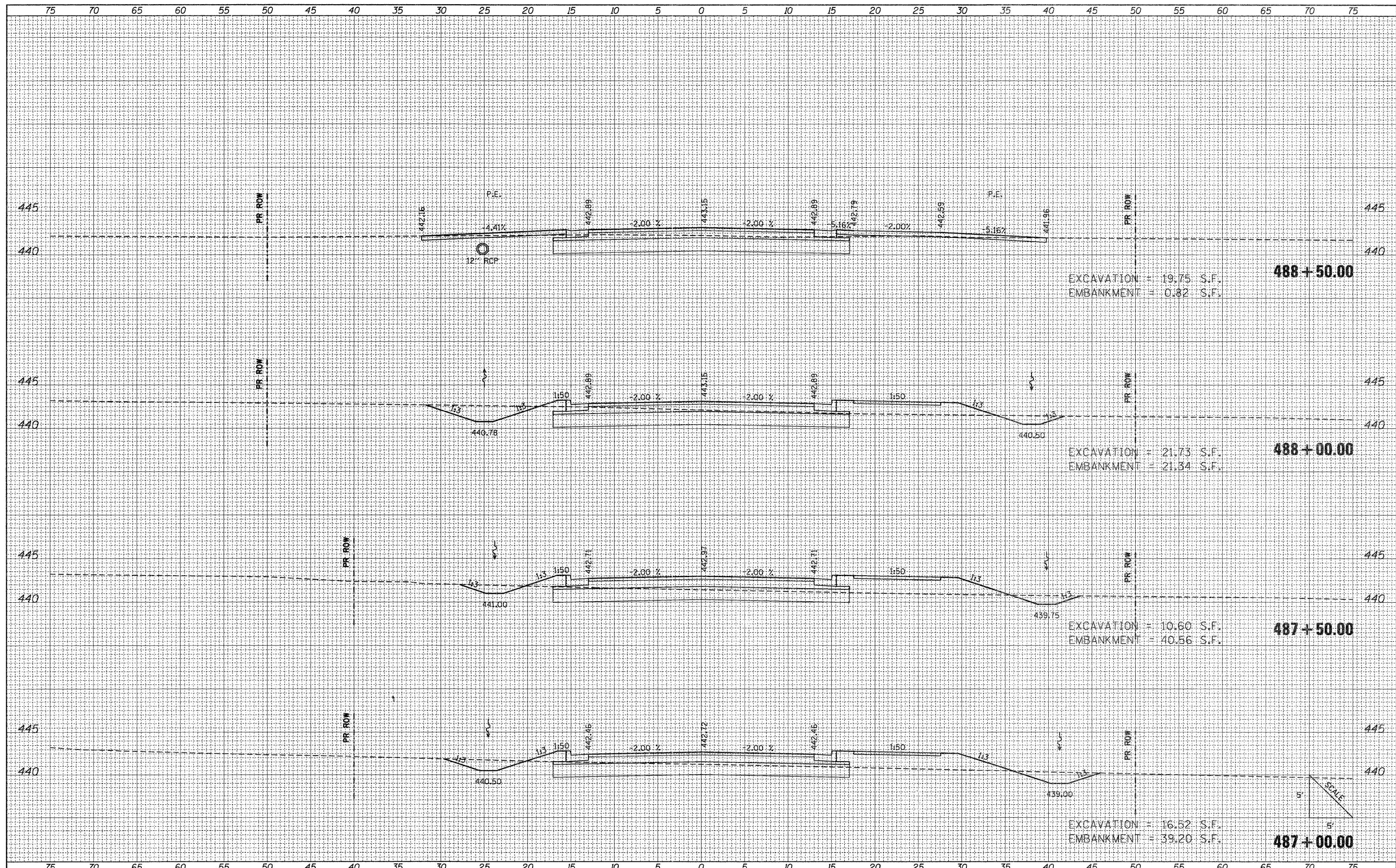

FILE NAME = L:\DOT\0986603\Draw\CADD_Sheets\Frontage Road	USER NAME = Brian Bond	DESIGNED - BMB	REVISED -	STATE OF ILLINOIS DEPARTMENT OF TRANSPORTATION	PROPOSED CROSS SECTIONS FRONTAGE ROAD				F.A. RTE. 331	SECTION (1X-1) R-7	COUNTY WILLIAMSON	TOTAL SHEETS 79	SHEET NO. 64
	Contract\0986603\Draw\CADD_Sheets\Frontage.dgn	DRAWN - RAH	REVISED -		SCALE: 1" = 20'	SHEET NO.	OF	SHEETS	STA. 487+00.00	TO STA. 488+50.00	CONTRACT NO. 78251		
	PLOT SCALE = 1/8" = 20' / IN.	CHECKED - SPH	REVISED -		ILLINOIS FED. AID PROJECT								
	PLOT DATE = 7/1/2011	DATE - 3/16/11	REVISED -										