

DATE	
BY	
SURVEYED	
PLOTTED	
NOTE BOOK	
TEMP. AT F	
AREAS CHECKED	
NO.	

DATE	
BY	
SURVEYED	
PLOTTED	
NOTE BOOK	
TEMP. AT F	
AREAS CHECKED	
NO.	

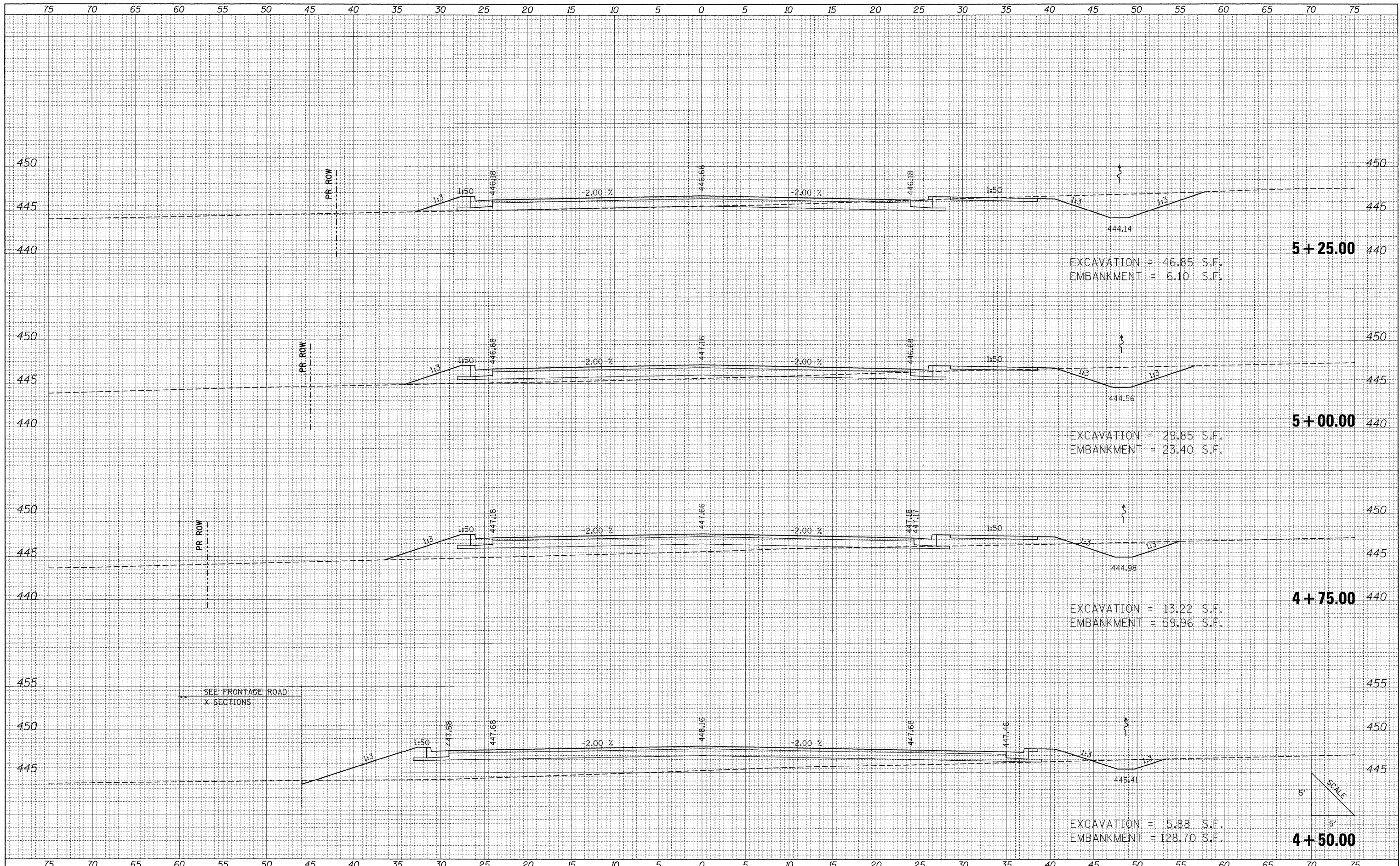

SEE FRONTAGE ROAD
X-SECTIONS

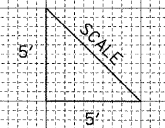

FILE NAME =	USER NAME = Brian Bond	DESIGNED - BMB	REVISED -	STATE OF ILLINOIS DEPARTMENT OF TRANSPORTATION	PROPOSED CROSS SECTIONS MARATHON DRIVE			F.A. RTE.	SECTION	COUNTY	TOTAL SHEETS	SHEET NO.			
I:\DDT\0906603\Draw\CADD_Sheets\Frontage Road	Contract\0906603\Draw\Marathon.dgn	DRAWN - RAH	REVISED -		SCALE:	SHEET NO.	OF	SHEETS	STA. 4+50.00	TO STA. 5+25.00	331	(1X-1) R-7	WILLIAMSON	79	72
	PLOT SCALE = 5.0000' / 1"	CHECKED - SPH	REVISED -												
	PLOT DATE = 3/16/2011	DATE - 3/16/11	REVISED -												
ILLINOIS FED. AID PROJECT											CONTRACT NO. 78251				