

BY	DATE
SURVEYED	
PLOTTED	
EMPAVE	
NOTE BOOK	
AREAS CHECKED	
NO.	

BY	DATE
SURVEYED	
PLOTTED	
EMPAVE	
NOTE BOOK	
AREAS CHECKED	
NO.	

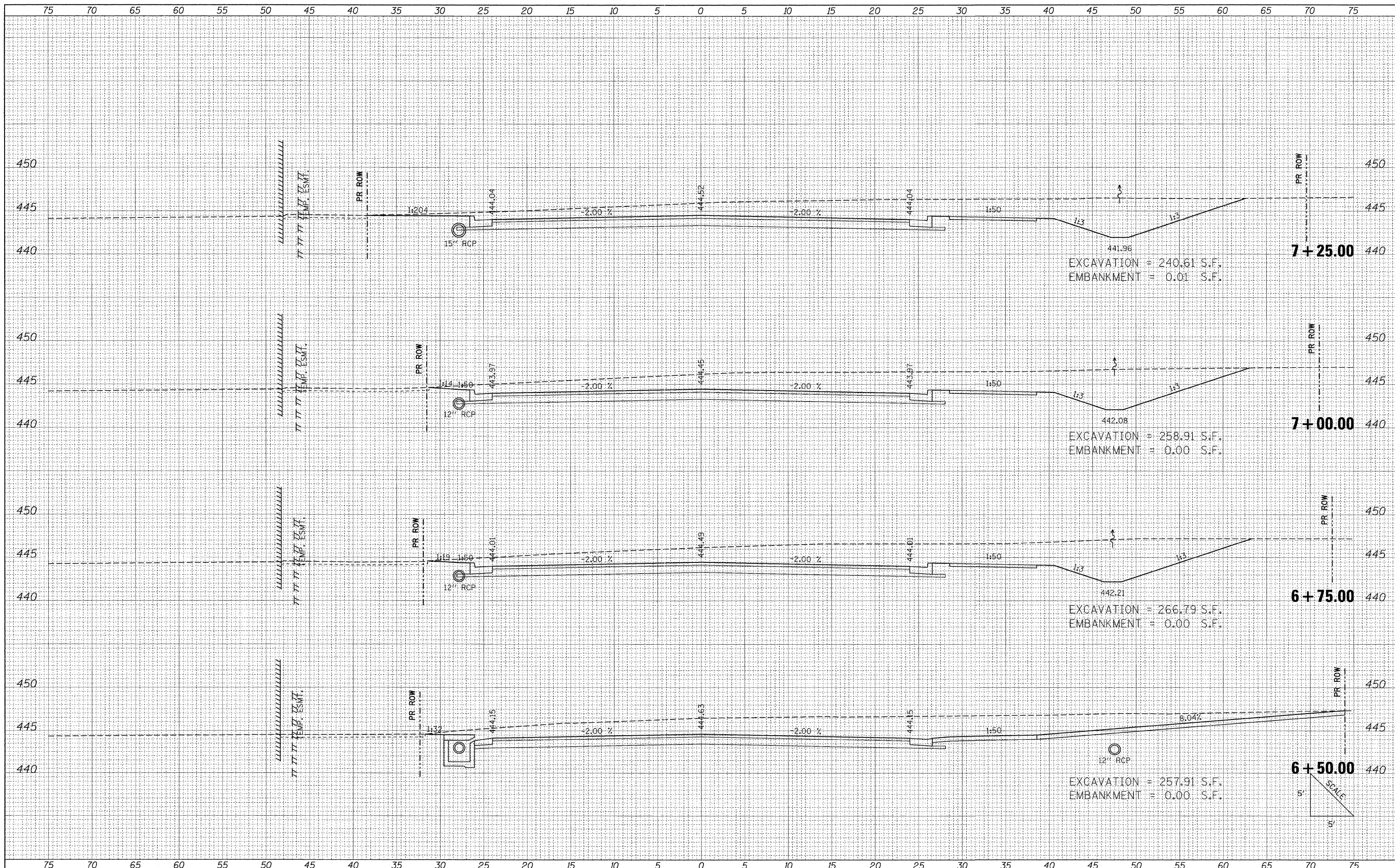

FILE NAME = I:\100T\0906503\Draw\CADD\_Sheets\Frontage Road

USER NAME = Brian Bond  
 Contract\0998859-shr-x\Marathon.dgn  
 PLOT SCALE = 5.0000" / IN.  
 PLOT DATE = 3/17/2011

DESIGNED - BMB  
 DRAWN - RAH  
 CHECKED - SPH  
 DATE - 3/16/11

REVISED -  
 REVISED -  
 REVISED -  
 REVISED -

**STATE OF ILLINOIS  
 DEPARTMENT OF TRANSPORTATION**

**PROPOSED CROSS SECTIONS  
 MARATHON DRIVE**

SCALE: SHEET NO. OF SHEETS STA. 6+50.00 TO STA. 7+25.00

F.A. RTE. 331	SECTION (1X-1) R-7	COUNTY WILLIAMSON	TOTAL SHEETS 79	SHEET NO. 74
ILLINOIS FED. AID PROJECT			CONTRACT NO. 78251	