

STATE OF ILLINOIS  
DEPARTMENT OF TRANSPORTATION

RTE.	SECTION	COUNTY	TOTAL SHEETS	SHEET NO.
*	06-00236-00-LS	ROCK ISLAND	17	1
FED. ROAD DIST. NO. 2		ILLINOIS	CONTRACT NO. 85542	
* 1ST AVE. - GREAT RIVER ROAD				

INDEX OF SHEETS

- 1 COVER SHEET
- 2 SUMMARY OF QUANTITIES
- 3 SCHEDULE OF QUANTITIES
- 4 GENERAL NOTES
- 5 DEMOLITION SHEET
- 6 PLAN SHEET
- 7-9 PROFILES AND CROSS SECTIONS
- 10 GRADING PLAN
- 11 EROSION CONTROL PLAN
- 12 LANDSCAPE PLAN
- 13-14 DETAILS
- 15-17 CITY OF MOLINE DETAILS

STANDARDS

- 280001-05 TEMPORARY EROSION CONTROL SYSTEMS
- 424001-05 CURB RAMPS FOR SIDEWALKS
- 606001-04 CONCRETE CURB TYPE B AND COMBINATION CONCRETE CURB AND GUTTER
- 701001-02 OFF-RD OPERATIONS, 2L, 2W, MORE THAN 15' AWAY
- 701006-03 OFF-RD OPERATIONS, 2L, 2W, 15' TO 24' FROM PAVEMENT EDGE
- 701301-04 LANE CLOSURE, 2L, 2W, SHORT TIME OPERATIONS
- 701501-06 URBAN LANE CLOSURE, 2L, 2W, UNDIVIDED
- 701801-04 LANE CLOSURE MULTILANE 1W OR 2W CROSSWALK OR SIDEWALK CLOSURE
- 701901-01 TRAFFIC CONTROL DEVICES
- 720001-01 SIGN PANEL MOUNTING DETAIL
- 720006-02 SIGN PANEL ERECTION DETAILS
- 720011-01 SIGN POSTS FOR SIGNS MARKERS AND DELINEATORS
- 728001-01 TELESCOPING STEEL SIGN SUPPORT
- 729001-01 APPLICATION OF TYPES A AND B POSTS

**BIR 21-8 TYPICAL APPLICATION OF TRAFFIC CONTROL DEVICES FOR CONSTRUCTION ON RURAL LOCAL HIGHWAYS**

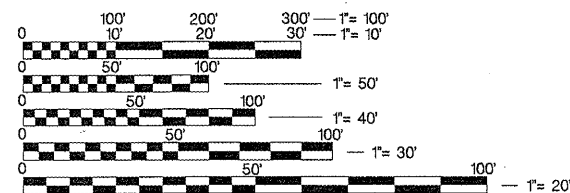

FULL SIZE PLANS HAVE BEEN PREPARED USING STANDARD ENGINEERING SCALES. REDUCED SIZED PLANS WILL NOT CONFORM TO STANDARD SCALES. IN MAKING MEASUREMENTS ON REDUCED PLANS, THE ABOVE SCALES MAY BE USED.

JULIE.  
JOINT UTILITY LOCATION INFORMATION FOR EXCAVATION  
1-800-892-0123  
OR 811

PROPOSED  
PLANS

SECTION 06-00236-00-LS  
PROJECT SBIL-IL06(016)  
JOB NO. C-92-034-07  
CITY OF MOLINE  
ROCK ISLAND COUNTY

PROJECT LOCATION

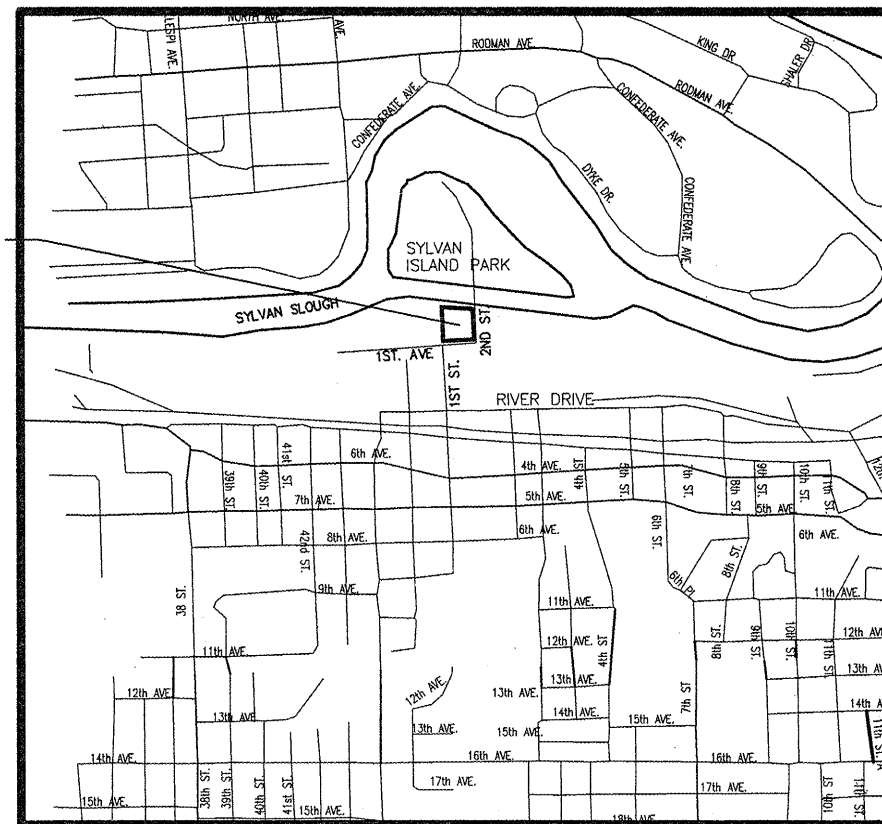

PROJECT LENGTH SITE IMPROVEMENT  
1st AVE. ADT: 80 (2031) TRUCKS: 10%  
LOCAL ROAD



LOCATION OF SECTION INDICATED THUS: - [black rectangle] -

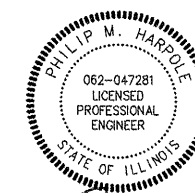

Signature *Philip M. Harpole*

Date 7-12-2011

Exp. Date 11-30-2011

ILLINOIS FIRM NO. 184-000214

STATE OF ILLINOIS DEPARTMENT OF TRANSPORTATION	
APPROVED	<i>[Signature]</i> CITY OF MOLINE, CITY ENGINEER
PASSED	<u>7-21</u> 20 <u>11</u> DISTRICT #2 ENGINEER OF LOCAL ROADS & STREETS
RELEASING FOR BID BASED ON LIMITED REVIEW	<u>7-21</u> 20 <u>11</u> DEPUTY DIRECTOR OF HIGHWAYS, REGION #2 ENGINEER

CONTRACT NO. 85542

SUMMARY OF QUANTITIES

CONTRACT NO. 85542

Code No.	Item	Units	Quantity
20100110	TREE REMOVAL (6 TO 15 UNITS DIAMETER)	UNIT	6
20101000	TEMPORARY FENCE	FOOT	119
Δ 20101350	TREE PRUNING (OVER 10 INCH DIAMETER)	EACH	3
20200100	EARTH EXCAVATION	CU YD	1278
20800150	TRENCH BACKFILL	CU YD	7
Δ 21101625	TOPSOIL FURNISH AND PLACE, 6"	SQ YD	12740
Δ 25000115	SEEDING, CLASS 1B	ACRE	1.2
Δ 25000312	SEEDING CLASS 4A	ACRE	0.9
Δ 25000324	SEEDING CLASS 5B	ACRE	0.5
Δ 25000400	NITROGEN FERTILIZER NUTRIENT	POUND	108
Δ 25000500	PHOSPHORUS FERTILIZER NUTRIENT	POUND	108
Δ 25000600	POTASSIUM FERTILIZER NUTRIENT	POUND	108
Δ 25100115	MULCH, METHOD 2	ACRE	5.2
Δ 25100630	EROSION CONTROL BLANKET	SQ YD	1070
Δ 28000250	TEMPORARY EROSION CONTROL SEEDING	POUND	290
28000400	PERIMETER EROSION BARRIER	FOOT	840
28100203	STONE RIPRAP, CLASS A2	TON	40
28100225	STONE RIPRAP, CLASS B3	TON	7
28200200	FILTER FABRIC	SQ YD	1210
35101600	AGGREGATE BASE COURSE, TYPE B 4"	SQ YD	562
35101800	AGGREGATE BASE COURSE, TYPE B 6"	SQ YD	309
* 40200800	AGGREGATE SURFACE COURSE, TYPE B	TON	183
42300300	PORTLAND CEMENT CONCRETE DRIVEWAY PAVEMENT, 7 INCH	SQ YD	260
42400200	PORTLAND CEMENT CONCRETE SIDEWALK 5 INCH	SQ FT	4599
42400800	DETECTABLE WARNINGS	SQ FT	68

\* SEE SPECIAL PROVISIONS OR DETAIL

**SHIVEHATTERY**  
ARCHITECTURE+ENGINEERING

1701 River Drive Suite 200 | Moline, Illinois 61205  
309.764.7650 | fax: 309.764.8616 | shive-hattery.com

Iowa | Illinois | Missouri | Illinois Firm Number: 184-000214

Code No.	Item	Units	Quantity
44000100	PAVEMENT REMOVAL	SQ YD	619
44000500	COMBINATION CURB AND GUTTER REMOVAL	FOOT	108
550A0050	STORM SEWERS, CLASS A, TYPE 1, 12"	FOOT	48
Δ * 56200300	WATER SERVICE LINE, 1"	FOOT	26
60107700	PIPE UNDERDRAINS 6"	FOOT	180
67100100	MOBILIZATION	LS	1
72000100	SIGN PANEL - TYPE 1	SQ FT	10
72800100	TELESCOPING STEEL SIGN SUPPORT	FOOT	50
Δ 78001100	PAINT PAVEMENT MARKING, LETTERS AND SYMBOLS	SQ FT	5
Δ 78001110	PAINT PAVEMENT MARKING LINE, 4"	FOOT	560
* Z0003850	BENCHES	EACH	4
Z0013798	CONSTRUCTION LAYOUT	LS	1
Δ * Z0020000	ELECTRICAL SYSTEM COMPLETE	LS	1
Δ * Z0056800	SANITARY SEWER 6"	FOOT	88
Δ K0012980	PERENNIAL PLANTS, ORNAMENTAL TYPE, QUART POT	UNIT	28
Δ * K1005481	SHREDDED BARK MULCH, 3"	SQ YD	720
* X0323045	STONE OUTCROPPING	SQ FT	80
* X0324775	SEDIMENT CONTROL, STABILIZED CONSTRUCTION ENTRANCE	SQ YD	110
* X0696100	PARKING BLOCKS	EACH	28
Δ * X2503110	MOWING SPECIAL	ACRE	1.4
* X7010216	TRAFFIC CONTROL AND PROTECTION SPECIAL	LS	1
Δ * XX003470	SANITARY CLEANOUT, 6"	EACH	1
* <del>XX008562</del>	PERMEABLE HOT-MIX ASPHALT PAVEMENT	TON	199
* <del>XX008564</del>	INSTALL INTERPERATIVE SIGNAGE	L SUM	1
* <del>XX008563</del>	PERMEABLE AGGREGATE SUBBASE	TON	1107

\* SEE SPECIAL PROVISIONS OR DETAIL

Δ SPECIALTY ITEMS

FILE NAME = \$FILE\$	USER NAME = \$USER\$	DESIGNED - PMH	REVISED -	<b>STATE OF ILLINOIS DEPARTMENT OF TRANSPORTATION</b>	<b>SUMMARY OF QUANTITIES</b>	F.A.U. RTE.	SECTION	COUNTY	TOTAL SHEETS	SHEET NO.	
	PLOT SCALE = \$SCALE\$	DRAWN - MAC	REVISED -			xxxx	06-00236-00-LS	ROCK ISLAND	17	2	
	PLOT DATE = \$DATE\$	CHECKED - 07-08-11	REVISED -			CONTRACT NO. 85542					
		DATE - 07-08-11	REVISED -			SCALE:	SHEET NO. 2 OF 17 SHEETS	STA.	TO STA.	FED. ROAD DIST. NO. 2	ILLINOIS

SCHEDULE OF QUANTITIES

TREE REMOVAL (6 TO 15 UNITS DIAMETER)		20100110
LOCATION	OFFSET	UNIT
STA. 54+05.80	334.51' LT	6
	TOTAL	6
TREE PRUNING (OVER 10 INCH DIAMETER)		20101350
LOCATION	OFFSET	EACH
STA. 53+42.85	104.78' LT	1
STA. 53+50.41	104.88' LT	1
STA. 53+58.28	104.64' LT	1
	TOTAL	3
TRENCH BACKFILL		20800150
LOCATION	OFFSET	CU YD
STA. 53+28 to ST. 54+13	LT	4
STA. 53+37	LT	3
	TOTAL	7
TEMPORARY FENCE		20101000
LOCATION	OFFSET	FOOT
STA. 53+45.45 TO STA. 53+59.65	LT	119
	TOTAL	119
TOPSOIL FURNISH AND PLACE, 6"		21101625
LOCATION	OFFSET	SQ YD
STA. 50+49.50 TO STA. 54+40.20	LT	12740
	TOTAL	12740
SEEDING, CLASS 1B		25000115
LOCATION	OFFSET	ACRE
STA. 50+49.00 TO STA. 54+40.40	LT	1.2
	TOTAL	1.2
SEEDING, CLASS 4A		25003312
LOCATION	OFFSET	ACRE
STA. 51+58.00 TO STA. 54+40.40	LT	0.9
	TOTAL	0.9
SEEDING, CLASS 5B		25003324
LOCATION	OFFSET	ACRE
STA. 51+58.00 TO STA. 54+40.40	LT	0.5
	TOTAL	0.5
NITROGEN FERTILIZER NUTRIENT		25000400
LOCATION	OFFSET	POUND
STA. 50+49.50 TO STA. 54+40.20	LT	108
	TOTAL	108
PHOSPHORUS FERTILIZER NUTRIENT		25000500
LOCATION	OFFSET	POUND
STA. 50+49.50 TO STA. 54+40.20	LT	108
	TOTAL	108
POTASSIUM FERTILIZER NUTRIENT		25000600
LOCATION	OFFSET	POUND
STA. 50+49.50 TO STA. 54+40.20	LT	108
	TOTAL	108

MULCH, METHOD 2		25100115
LOCATION	OFFSET	ACRE
STA. 50+49.50 TO STA. 54+40.20	LT	5.2
FOR TEMP. AND FINAL SEEDING		TOTAL
		5.2
EROSION CONTROL BLANKET		25100630
LOCATION	OFFSET	SQ YD
STA. 51+58.00 TO STA. 54+40.40	LT	1070
	TOTAL	1070
TEMPORARY EROSION CONTROL SEEDING		28000250
LOCATION	OFFSET	POUND
STA. 50+49.50 TO STA. 54+40.20	LT	290
	TOTAL	290
PERIMETER EROSION BARRIER		28000400
LOCATION	OFFSET	FOOT
STA. 50+41 TO STA. 53+84	LT	720
STA. 50+66 TO STA. 53+84	LT	72
STA. 54+02 TO STA. 54+28	LT	48
	TOTAL	840
STONE RIPRAP, CLASS A2		28100203
LOCATION	OFFSET	TON
STA. 54+01, 26' LT TO STA. 54+39, 370' LT	LT	40
	TOTAL	40
STONE RIPRAP, CLASS B3		28100225
LOCATION	OFFSET	TON
STA. 54+22, 370' LT TO STA. 54+39, 395' LT	LT	7
	TOTAL	7
FILTER FABRIC		28200200
LOCATION	OFFSET	SQ YD
STA. 51+13 TO STA. 52+91 PARKING LOT	LT	1210
	TOTAL	1210
AGGREGATE BASE COURSE, TYPE B, 4"		35101600
LOCATION	OFFSET	SQ YD
STA. 51+20.20 TO STA. 54+22.50 SIDEWALK	LT	562
	TOTAL	562
AGGREGATE BASE COURSE, TYPE B, 6"		35101800
LOCATION	OFFSET	SQ YD
STA. 50+98 TO STA. 51+52	LT	147
STA. 52+32 TO STA. 52+86	LT	117
STA. 53+17 TO STA. 53+17	LT/RT	23
STA. 53+18 TO STA. 53+37 FOR RESTROOM	LT	22
	TOTAL	309
AGGREGATE SURFACE COURSE TYPE B		40200800
LOCATION	OFFSET	TON
STA. 30+00 TO STA. 33+09	LT/RT	93
STA. 20+00 TO STA.	LT/RT	21
STA. 52+32 TO STA. 52+86	LT/RT	69
	TOTAL	183

PCC DRIVEWAY PAVEMENT, 7 INCH		42300300
LOCATION	OFFSET	SQ YD
STA. 50+98 TO STA. 51+52	LT	135
STA. 52+32 TO STA. 52+86	LT	105
STA. 53+88 TO STA. 54+00	LT/RT	20
	TOTAL	260
PORTLAND CEMENT CONCRETE SIDEWALK, 5 INCH		42400200
LOCATION	OFFSET	SQ FT
STA. 12+42 TO STA. 13+17	LT/RT	963
STA. 33+09 TO STA. 33+20	LT/RT	157
STA. 51+20 TO STA. 53+88	LT	3479
	TOTAL	4599
DETECTABLE WARNINGS		42400800
LOCATION	OFFSET	SQ FT
STA. 52+92	52' LT	18
STA. 52+92	79' LT	18
STA. 53+89.5 TO STA. 54+00	20' LT	32
	TOTAL	68
PAVEMENT REMOVAL		44000100
LOCATION	OFFSET	SQ YD
STA. 53+89 TO STA. 54+40	LT	473
STA. 54+24 TO STA. 54+41	LT	146
	TOTAL	619
COMBINATION CURB AND GUTTER REMOVAL		44000500
LOCATION	OFFSET	FOOT
STA. 50+98 TO STA. 51+52	LT	54
STA. 52+32 TO STA. 52+86	LT	54
	TOTAL	108
STORM SEWERS, CLASS A, TYPE 1, 12"		550A0050
LOCATION	OFFSET	FOOT
STA. 20+41, 34' RT TO STA. 20+36, 14' LT	LT	48
	TOTAL	48
PIPE UNDERDRAINS 6"		60107700
LOCATION	OFFSET	FOOT
STA. 50+30 TO STA. 52+50 PARKING LOT	LT	180
	TOTAL	180

SIGN PANEL - TYPE 1		72000100
LOCATION	OFFSET	SQ FT
STA. 33+08 (W1-1, SMALL STOP SIGN)	10' RT	3
STA. 13+10, (W1-1, SMALL STOP SIGN)	10' RT	3
STA. 52+92 (R7-8, HC PARKING)	61' LT	1.5
STA. 52+92 (HC FINE)	61' LT	0.5
STA. 52+92 (R7-8, HC PARKING)	70' LT	1.5
STA. 52+92 (HC FINE)	70' LT	0.5
	TOTAL	10
TELESCOPING STEEL SIGN SUPPORT		72800100
LOCATION	OFFSET	FOOT
STA. 33+08	10' RT	12.5
STA. 13+10	10' RT	12.5
STA. 52+92	61' LT	12.5
STA. 52+92	70' LT	12.5
	TOTAL	50
PAINT PAVEMENT MARKING, LETTERS & SYMBOLS		78001100
LOCATION	OFFSET	SQ FT
STA. 52+77.50	70' LT	2.5
STA. 52+77.50	61' LT	2.5
	TOTAL	5
PAINT PAVEMENT MARKING LINE, 4"		78001110
LOCATION	OFFSET	FOOT
STA. 51+29 TO 52+91	LT	560
	TOTAL	560
BENCHES		Z0003850
LOCATION	OFFSET	EACH
STA. 12+85.50	12.5' LT	1
STA. 12+91.00	22' LT	1
STA. 13+01.00	21' LT	1
STA. 13+04.00	10' LT	1
	TOTAL	4
SANITARY SEWER 6"		Z0056800
LOCATION	OFFSET	FOOT
STA. 53+28 TO STA. 54+13	50.5' LT	88
	TOTAL	88
MOWING SPECIAL		X2503110
LOCATION	ACRE	
STA. 50+49 TO STA. 53+77	1.4	
	TOTAL	1.4
PERENIAL PLANTS, ORNAMENTAL TYPE, QUART POT		K0012980
LOCATION	OFFSET	UNIT
STA. 9+80 TO STA. 10+00	RT	1.4
STA. 10+00 TO STA. 10+49	LT	4.2
STA. 12+42 TO STA. 13+12	RT	3
STA. 12+43 TO STA. 13+08	LT	3.2
STA. 29+71 TO STA. 30+32	LT	5.8
STA. 30+01 TO STA. 30+38	RT	4.9
STA. 31+22 TO STA. 31+96	LT	4
STA. 31+72 TO STA. 31+95	RT	1.5
	TOTAL	28

SHREDDED BARK MULCH, 3"		K1005481
LOCATION	OFFSET	SQ YD
STA. 9+80 TO STA. 10+00	RT	36
STA. 10+00 TO STA. 10+49	LT	108
STA. 12+42 TO STA. 13+12	RT	77
STA. 12+43 TO STA. 13+08	LT	82
STA. 29+71 TO STA. 30+32	LT	149
STA. 30+01 TO STA. 30+38	RT	126
STA. 31+22 TO STA. 31+96	LT	103
STA. 31+72 TO STA. 31+95	RT	39
	TOTAL	720



1701 River Drive Suite 200 | Moline, Illinois 61265  
309.764.7650 | fax: 309.764.8916 | shive-hattery.com  
Iowa | Illinois | Missouri | Illinois Firm Number: 184-000214

FILE NAME =	USER NAME = \$USER\$	DESIGNED - PMH	REVISED -
\$FILEL\$		DRAWN - MAC	REVISED -
	PLOT SCALE = \$SCALE\$	CHECKED - 07-08-11	REVISED -
	PLOT DATE = \$DATE\$	DATE - 07-08-11	REVISED -

STATE OF ILLINOIS  
DEPARTMENT OF TRANSPORTATION

SCHEDULE OF QUANTITIES

SCALE: SHEET NO. 3 OF 17 SHEETS STA. TO STA.

F.A.U. RTE.	SECTION	COUNTY	TOTAL SHEETS	SHEET NO.
xxxx	06-00236-00-L5	ROCK ISLAND	17	3
CONTRACT NO. 85542				
FED. ROAD DIST. NO. 2 ILLINOIS FED. AID PROJECT				

**GENERAL NOTES**

- ALL BORROW/WASTE/USE SITES MUST BE APPROVED BY THE DEPARTMENT PRIOR TO REMOVING ANY MATERIAL FROM THE PROJECT OR INITIATING ANY EARTHMOVING ACTIVITIES, INCLUDING TEMPORARY STOCKPILING OUTSIDE THE LIMITS OF CONSTRUCTION.
- MULCH ON TEMPORARY SEEDING CLASS 7 SHALL BE MULCH METHOD 2.
- THE COST OF MAKING SEWER CONNECTIONS TO EXISTING DRAINAGE STRUCTURES SHALL BE INCLUDED IN THE VARIOUS CONTRACT UNIT PRICES FOR STORM SEWER.
- VALVE BOXES SHALL BE ADJUSTED TO THE FINAL GRADE AS SHOWN ON THE PLANS. THE COST OF ADJUSTING VALVE BOXES SHALL NOT BE PAID FOR SEPARATELY BUT SHALL BE INCLUDED IN THE CONTRACT UNIT PRICE FOR THE VARIOUS ITEMS OF WORK.
- THE CONTRACTOR SHALL BE RESPONSIBLE FOR PROTECTING UTILITY PROPERTY DURING CONSTRUCTION OPERATIONS AS OUTLINED IN ARTICLE 107.31 OF THE STANDARD SPECIFICATIONS. A MINIMUM OF 48 HOURS ADVANCE NOTICE IS REQUIRED FOR NON-EMERGENCY WORK. THE JULIE NUMBER IS 800-892-0123. THE FOLLOWING LISTED UTILITIES LOCATED WITHIN THE PROJECT LIMITS OR IMMEDIATELY ADJACENT TO THE PROJECT CONSTRUCTION LIMITS ARE MEMBERS OF JULIE:

MIDAMERICAN ENERGY AT&T  
 716 17TH STREET 635 18TH STREET  
 MOLINE, IL 61265 ROCK ISLAND, IL 61201  
 ELECTRIC (309) 793-3833 (309) 793-4465  
 GAS (309) 793-3707

MEDIACOM QWEST  
 3900 26TH AVENUE 3565 UTICA RIDGE ROAD  
 MOLINE, IL 61265 BETTENDORF, IA 52722  
 (309) 743-4750 (563) 355-6402

CITY OF MOLINE SANITARY SEWER CITY OF MOLINE STORM SEWER  
 (309) 524-2341 (309) 524-2350

CITY OF MOLINE WATER MAINS  
 (309) 524-2326

- IT SHALL BE THE CONTRACTOR'S RESPONSIBILITY TO CONTACT THE MUNICIPALITY TO DETERMINE APPROVED METHODS OF UTILITY STRUCTURE ADJUSTMENT. UTILITY STRUCTURES MAY INCLUDE, BUT ARE NOT LIMITED TO, MANHOLES, WATER VALVES, HANDHOLES, ETC. ALL MATERIALS AND WORK NECESSARY TO COMPLETE ADJUSTMENTS PER MUNICIPALITY REQUIREMENTS SHALL BE CONSIDERED INCLUDED IN THE COST OF THE ASSOCIATED ADJUSTMENT PAY ITEM.
- DETECTABLE WARNING TRUNCATED DOME PANELS SHALL BE CAST IRON.
- PLANTS SHALL BE PLANTED AT LOCATIONS INDICATED ON THE PLANS. THE CONTRACTOR SHALL BE RESPONSIBLE FOR LAYOUT. THE ENGINEER WILL REVIEW PLANT LOCATIONS PRIOR TO PLANTING.

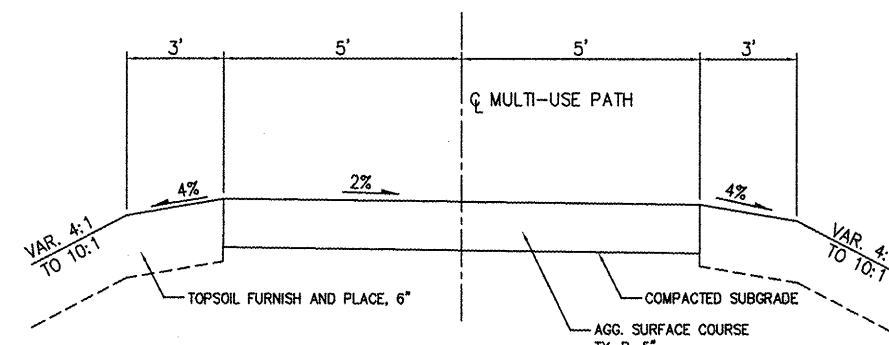

**TYPICAL SECTION MULTI-USE PATH**

STA. 30+00 - 33+10  
 STA. 10+00 - 12+42  
 STA. 20+00 - 20+85.52

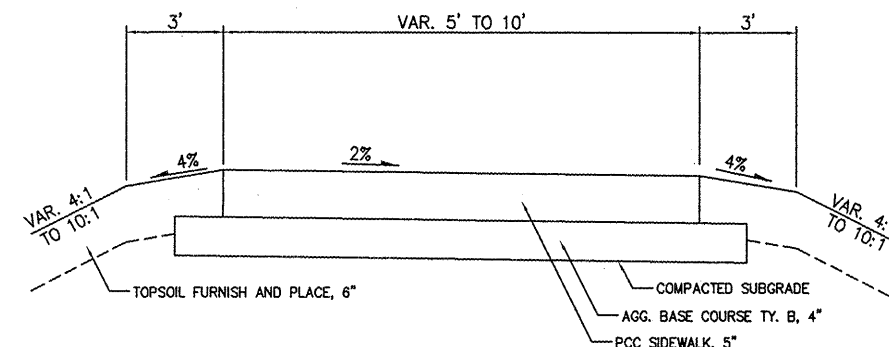

**TYPICAL SECTION PCC SIDEWALK 5'**

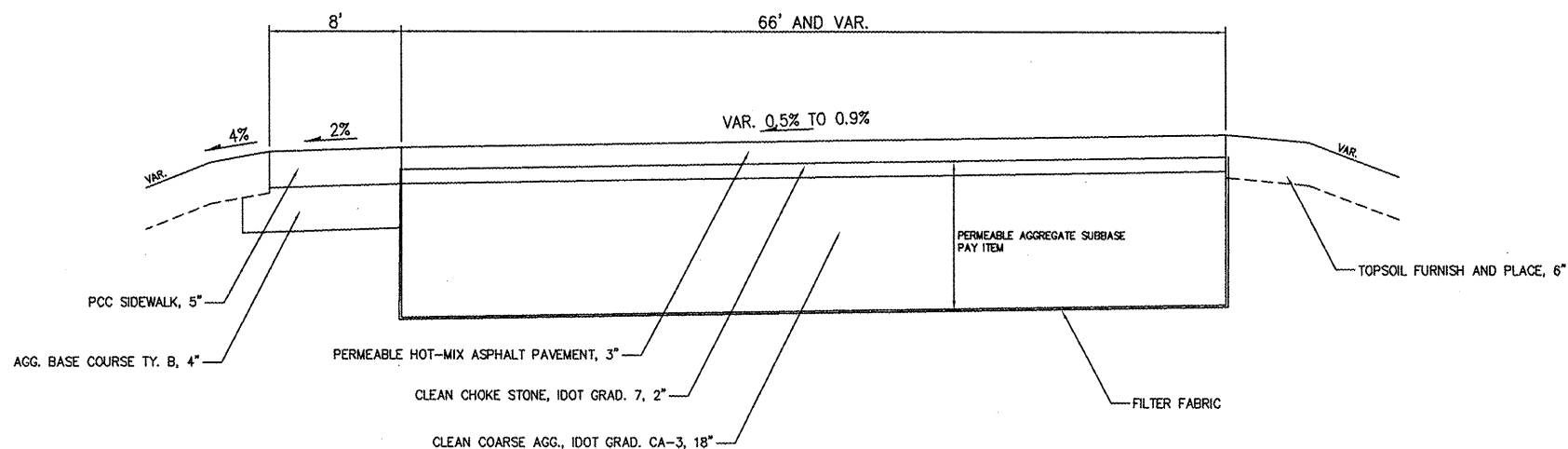

**PARKING LOT TYPICAL SECTION, FACING NORTH**

**SHIVEHATTERY**  
 ARCHITECTURE+ENGINEERING

1701 River Drive Suite 200 | Moline, Illinois 61265  
 309.764.7650 | fax: 309.764.8616 | shive-hattery.com  
 Iowa | Illinois | Missouri | Illinois Firm Number: 184-000214

STATE OF ILLINOIS  
 DEPARTMENT OF TRANSPORTATION

**GENERAL NOTES**

SCALE: SHEET NO. 4 OF 17 SHEETS STA. TO STA.

F.A.U. RTE.	SECTION	COUNTY	TOTAL SHEETS	SHEET NO.
xxxx	06-00236-00-LS	ROCK ISLAND	17	4
CONTRACT NO. 85542				
FED. ROAD DIST. NO. 2 ILLINOIS FED. AID PROJECT				

FILE NAME =	USER NAME = \$USER\$	DESIGNED - PHM	REVISED -
\$FILE\$		DRAWN - MAC	REVISED -
	PLOT SCALE = \$SCALE\$	CHECKED - 07-08-11	REVISED -
	PLOT DATE = \$DATE\$	DATE - 07-08-11	REVISED -

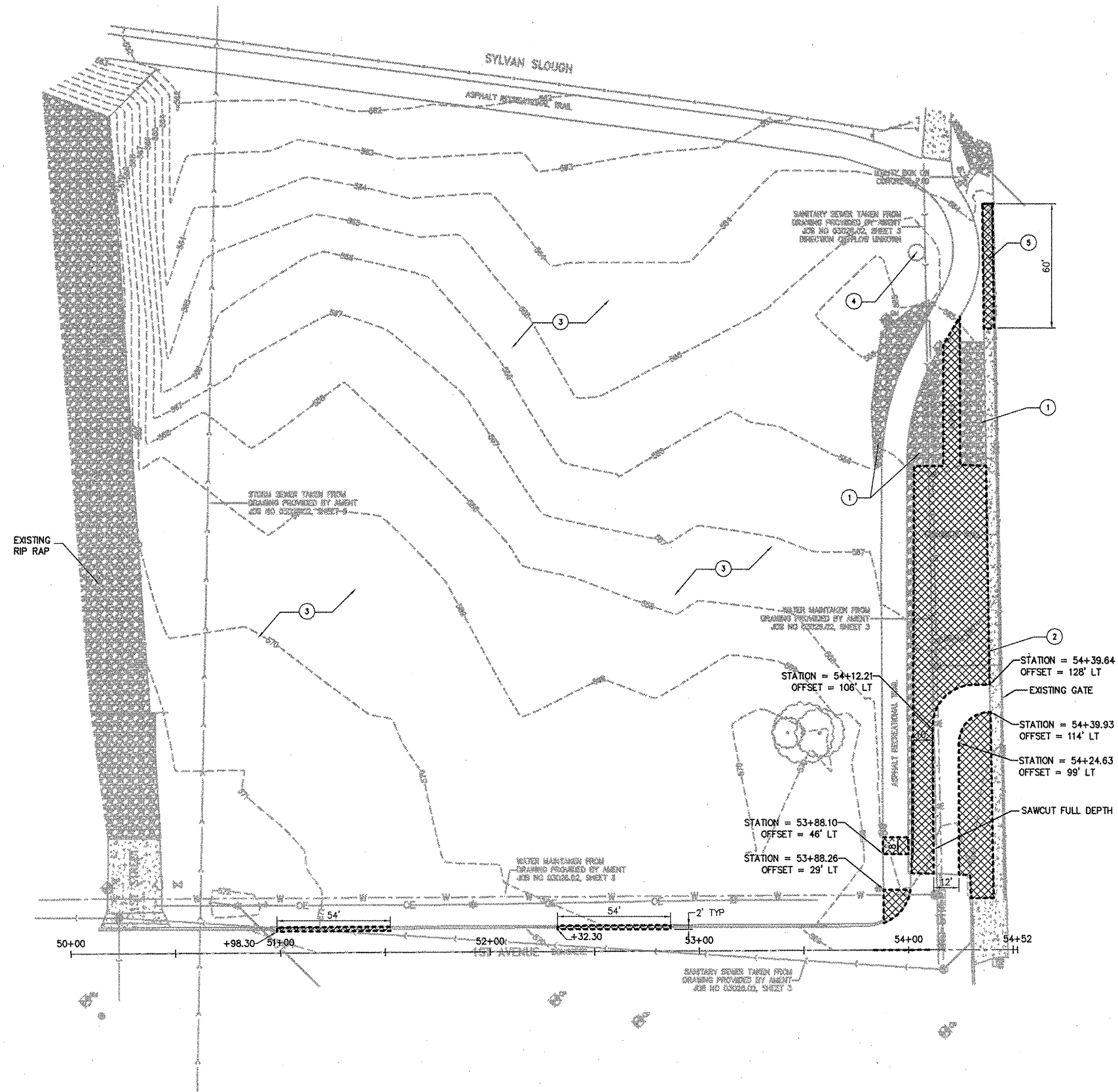
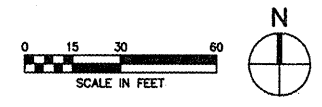

**LEGEND**

REMOVAL

**DEMOLITION NOTES:**

- ① REMOVE CRUSHED STONE (6" DEPTH)
- ② REMOVE PARKING BUMPER (18 TOTAL)
- ③ REMOVE BROKEN CONCRETE\ROCKS\BRICKS\ LARGER THAN 6"x6" ON ANY SIZE
- ④ REMOVE TREE
- ⑤ REMOVE SIDEWALK

**SHIVE-HATTERY**  
ARCHITECTURE+ENGINEERING

1701 River Drive Suite 200 | Moline, Illinois 61265  
309.764.7650 | fax: 309.764.9616 | shive-hattery.com  
Iowa | Illinois | Missouri | Illinois Firm Number: 184-000214

FILE NAME =	USER NAME = \$USER\$	DESIGNED -- PMH	REVISED --
\$FILEL\$		DRAWN -- MAC	REVISED --
	PLOT SCALE = \$SCALE\$	CHECKED -- 07-08-11	REVISED --
	PLOT DATE = \$DATE\$	DATE -- 07-08-11	REVISED --

**STATE OF ILLINOIS  
DEPARTMENT OF TRANSPORTATION**

<b>DEMOLITION PLAN</b>		
SCALE:	SHEET NO. 5 OF 17 SHEETS	STA. TO STA.

F.A.U. RTE.	SECTION	COUNTY	TOTAL SHEETS	SHEET NO.
xxxx	06-00236-00-LS	ROCK ISLAND	17	5
CONTRACT NO. 85542				
FED. ROAD DIST. NO. 2   ILLINOIS   FED. AID PROJECT				



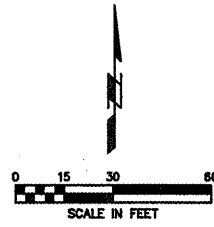

STA	NORTHING	EASTING
10+00.00	1764165.112	2195293.767
10+88.42	1764253.529	2195293.767
11+52.78	1754317.897	2195293.767
12+06.58	1764353.501	2195347.392
12+43.53	1764373.940	2195378.176
12+54.59	1764380.054	2195387.386
12+65.55	1764384.010	2195397.710
12+78.35	1764388.590	2195409.662
12+95.16	1764394.604	2195425.360
13+11.66	1764405.421	2195438.228
13+17.00	1764408.859	2195442.319

PI = 11+52.78
Δ = 56°25'05.48"
R = 120.00'
T = 89.28'
L = 118.16'
E = 16.17'
PC STA. = 10+88.42
PT STA. = 12+06.58

PI = 12+54.59
Δ = 12°37'04.05"
R = 100.00'
T = 11.05'
L = 22.02'
E = 0.609'
PC STA. = 12+43.53
PT STA. = 12+65.55

PI = 12+95.16
Δ = 19°05'05.82"
R = 100.00'
T = 16.81'
L = 33.31'
E = 1.403'
PC STA. = 12+78.35
PT STA. = 13+11.66

STA	NORTHING	EASTING
20+00.00	1764294.853	2195301.004
20+26.46	1764303.904	2195276.138
20+45.38	1764310.376	2195258.356
20+64.00	1764311.062	2195239.445
20+85.52	1764311.842	2195217.940

PI = 20+45.38
Δ = 17°55'22.14"
R = 120.00'
T = 18.923'
L = 37.54'
E = 1.48'
PC STA. = 20+26.46
PT STA. = 20+64.00

STA	NORTHING	EASTING
30+00.00	1764165.112	2195149.82
30+37.25	1764201.835	2195156.048
31+23.13	1764260.56	2195222.573
31+66.91	1764311.842	2195217.940
32+07.68	1764352.581	2195219.418
32+47.53	1764391.145	2195205.201
32+78.81	1764420.734	2195196.059
32+99.80	1764440.686	2195189.221
33+20.382	1764461.670	2195191.023

TRAIL #3 CURVE DATA	TRAIL #3 CURVE DATA	TRAIL #3 CURVE DATA	TRAIL #3 CURVE DATA
PI = 30+37.25	PI = 31+23.13	PI = 32+07.68	PI = 32+99.80
Δ = 38°41'52.31"	Δ = 53°54'03.67"	Δ = 20°59'44.15"	Δ = 23°49'09.28"
R = 106'	R = 101'	R = 220.00'	R = 100.00'
T = 37.25'	T = 51.49'	T = 40.77'	T = 21.10'
L = 71.64'	L = 95.27'	L = 80.62'	L = 41.57'
E = 6.350'	E = 12.34'	E = 3.745'	E = 2.20'
PC STA. = 30+00.00	PC STA. = 30+71.64	PC STA. = 31+66.91	PC STA. = 32+78.81
PT STA. = 30+71.64	PT STA. = 31+66.91	PT STA. = 32+36.88	PT STA. = 33+20.38

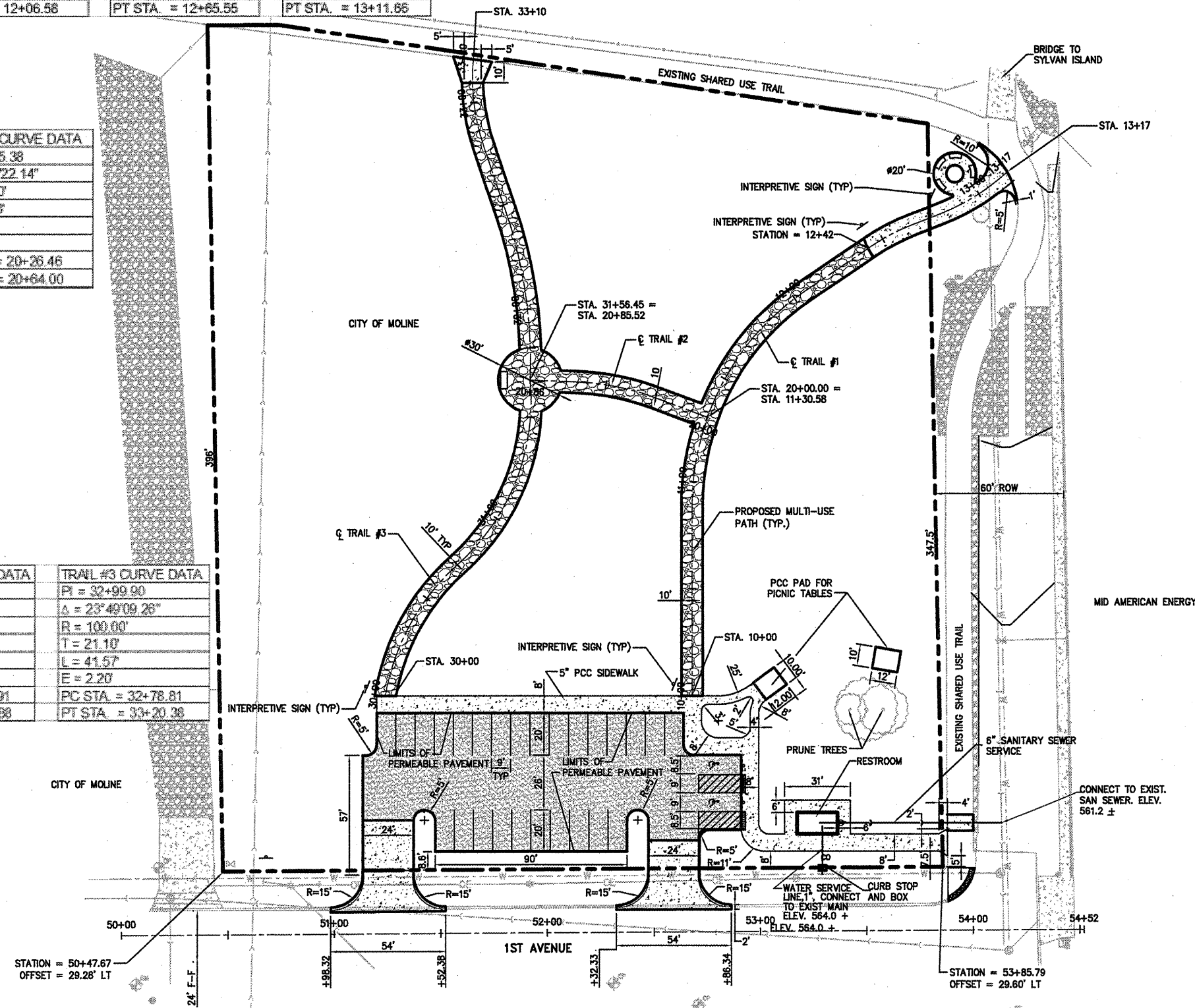

GENERAL SITE	
PLAN MARK	DESCRIPTION
(Symbol)	TREE
(Symbol)	CLEANOUT
(Symbol)	SINGLE POLE SIGN
(Symbol)	DETECTABLE WARNINGS
(Symbol)	CURB STOP
(Symbol)	CONCRETE
(Symbol)	GRAVEL
(Symbol)	WATER MAIN
(Symbol)	SANITARY SEWER

CONTROL POINT	NORTHING	EASTING	DESCRIPTION
CP1	1764343.09	2195440.97	PK NAIL
CP2	1764014.47	2195443.36	PK NAIL
CP3	1764083.74	2195043.58	PK NAIL
CP5	1764019.27	2195296.91	PK NAIL

**BENCHMARK**

BM1 - NORTH BOLT ON FIRE HYDRANT NORTHEAST NEAR CORNER OF SITE 75'± SOUTH OF BRIDGE - ELEVATION = 568.43

BM2 - NORTH RIM ON MANHOLE 30'± NORTHWEST OF MIDAMERICAN ENERGY ENTRANCE - ELEVATION = 568.39

BM3 - RAILROAD SPIKE IN SECOND POWER POLE WEST SIDE OF MAIN ENTRANCE - ELEVATION = 569.78

BM4 - EAST BOLT WITH "X" AT SOUTHWEST QUADRANT OF 1ST STREET AND 1ST AVENUE ON STEEL POWER POLE - ELEVATION = 571.29

STA.	NORTHING	EASTING
50+00	1764051.95	2195026.06
54+32	1764054.63	2195478.11

LOCATION	NORTHING	EASTING
CENTER PICNIC TABLE	8.9145	21.5894
CENTER PICNIC TABLE	8.9246	22.6250
RESTROOM	6.3446	21.5370

**SHIVE-HATTERY**  
ARCHITECTURE+ENGINEERING

1701 River Drive Suite 200 | Moline, Illinois 61265  
309.764.7650 | fax: 309.764.8616 | shive-hattery.com

Iowa | Illinois | Missouri | Illinois Firm Number: 184-000214

FILE NAME =	USER NAME = \$USER\$	DESIGNED - PMH	REVISED -
\$FILE\$		DRAWN - MAC	REVISED -
		CHECKED - 07-08-11	REVISED -
		DATE - 07-08-11	REVISED -

STATE OF ILLINOIS  
DEPARTMENT OF TRANSPORTATION

PLAN SHEET	
SCALE:	SHEET NO. 6 OF 17 SHEETS
STA.	TO STA.

F.A.U. RTE.	SECTION	COUNTY	TOTAL SHEETS	SHEET NO.
XXXX	06-00236-00-LS	ROCK ISLAND	17	6
CONTRACT NO. 85542				
FED. ROAD DIST. NO. 2   ILLINOIS   FED. AID PROJECT				

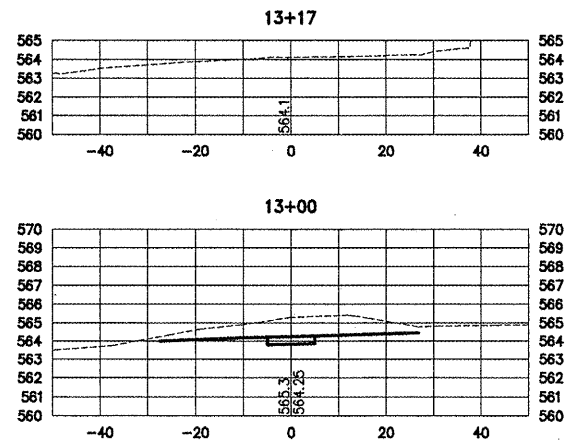
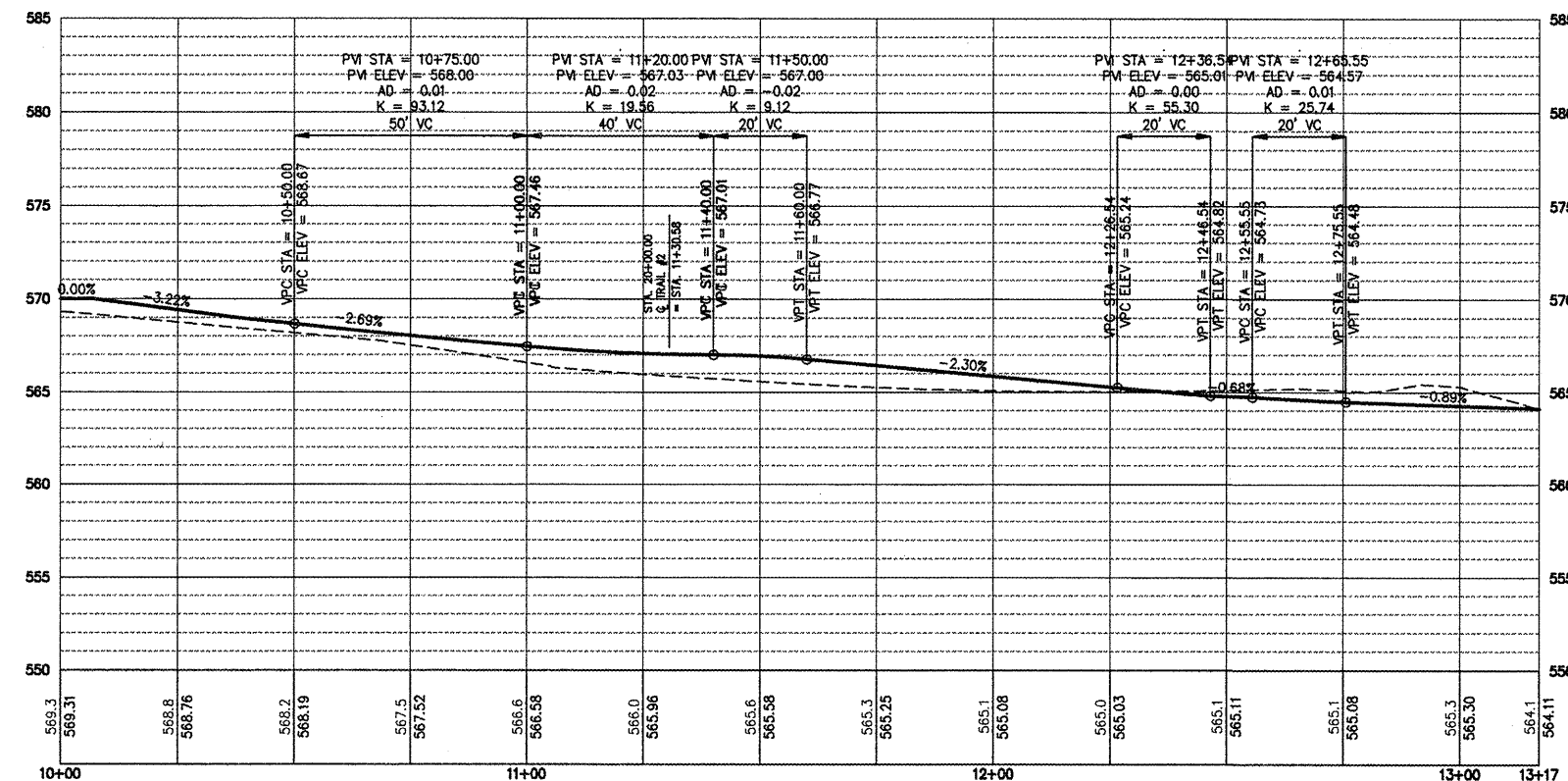
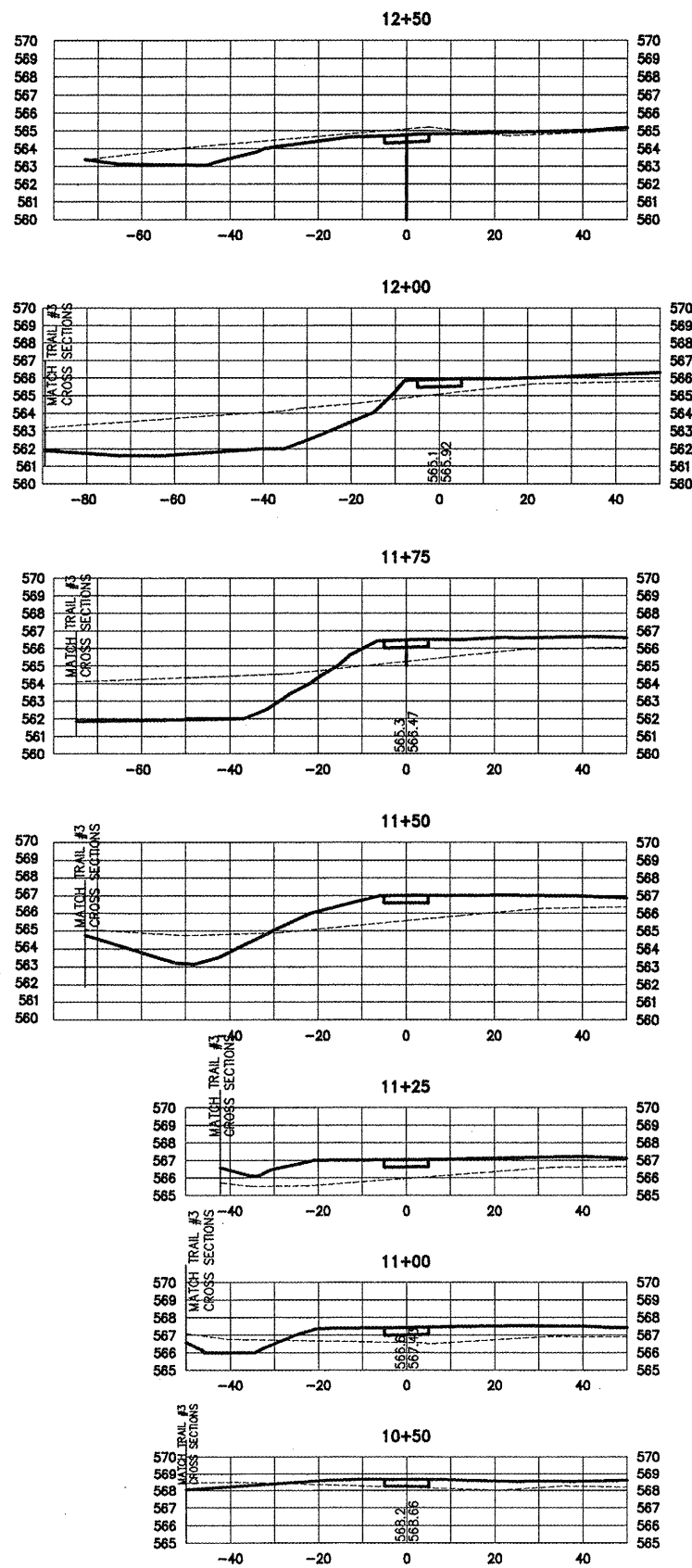

**SHIVEHATTERY**  
ARCHITECTURE+ENGINEERING  
1701 River Drive Suite 200 | Moline, Illinois 61265  
309.764.7650 | fax: 309.764.8616 | shive-hattery.com  
Iowa | Illinois | Missouri | Illinois Firm Number: 184-000214

FILE NAME =	USER NAME = \$USER\$	DESIGNED -	PMH	REVISED -
\$FILEL\$		DRAWN -	MAC	REVISED -
	PLOT SCALE = \$SCALE\$	CHECKED -	07-08-11	REVISED -
	PLOT DATE = \$DATE\$	DATE -	07-08-11	REVISED -

STATE OF ILLINOIS  
DEPARTMENT OF TRANSPORTATION

CROSS SECTIONS TRAIL #1	
SCALE:	SHEET NO. 7 OF 17 SHEETS
STA.	TO STA.

F.A.U. RTE.	SECTION	COUNTY	TOTAL SHEETS	SHEET NO.
xxxxx	06-00236-00-LS	ROCK ISLAND	17	7
CONTRACT NO. 85542				
FED. ROAD DIST. NO. 2   ILLINOIS   FED. AID PROJECT				

Profile View of Alignment - TRAIL #2

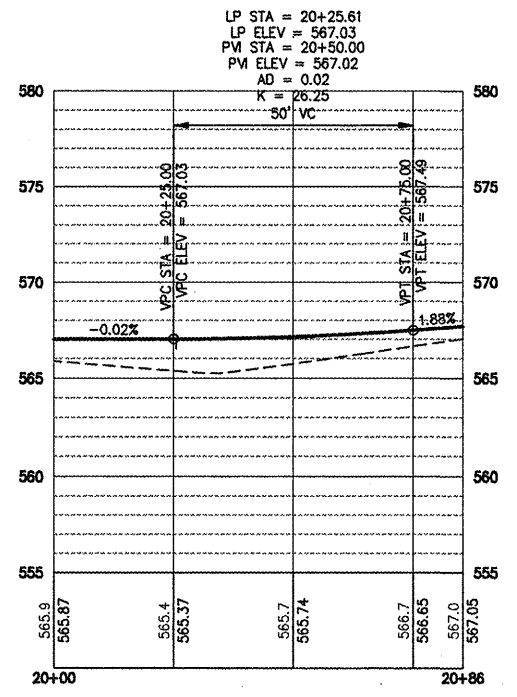
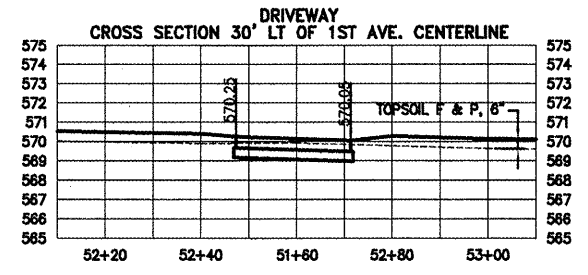
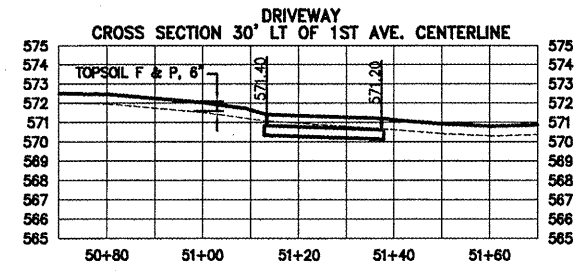
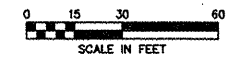

**SHIVEHATTERY**  
ARCHITECTURE+ENGINEERING

1701 River Drive Suite 200 | Moline, Illinois 61265  
309.764.7850 | fax: 309.764.8616 | shive-hattery.com  
Iowa | Illinois | Missouri | Illinois Firm Number: 184-000214

FILE NAME =	USER NAME = \$USER\$	DESIGNED -- PMH	REVISED --
\$FILEL\$		DRAWN -- MAC	REVISED --
	PLOT SCALE = \$SCALE\$	CHECKED -- 07-08-11	REVISED --
	PLOT DATE = \$DATE\$	DATE -- 07-08-11	REVISED --

STATE OF ILLINOIS  
DEPARTMENT OF TRANSPORTATION

DRIVEWAY CROSS SECTIONS, TRAIL #2 PROFILE

SCALE: SHEET NO. 8 OF 17 SHEETS STA. TO STA.

F.A.U. RTE.	SECTION	COUNTY	TOTAL SHEETS	SHEET NO.
xxxx	06-00236-00-LS	ROCK ISLAND	17	8
CONTRACT NO. 85542				
FED. ROAD DIST. NO. 2 ILLINOIS FED. AID PROJECT				



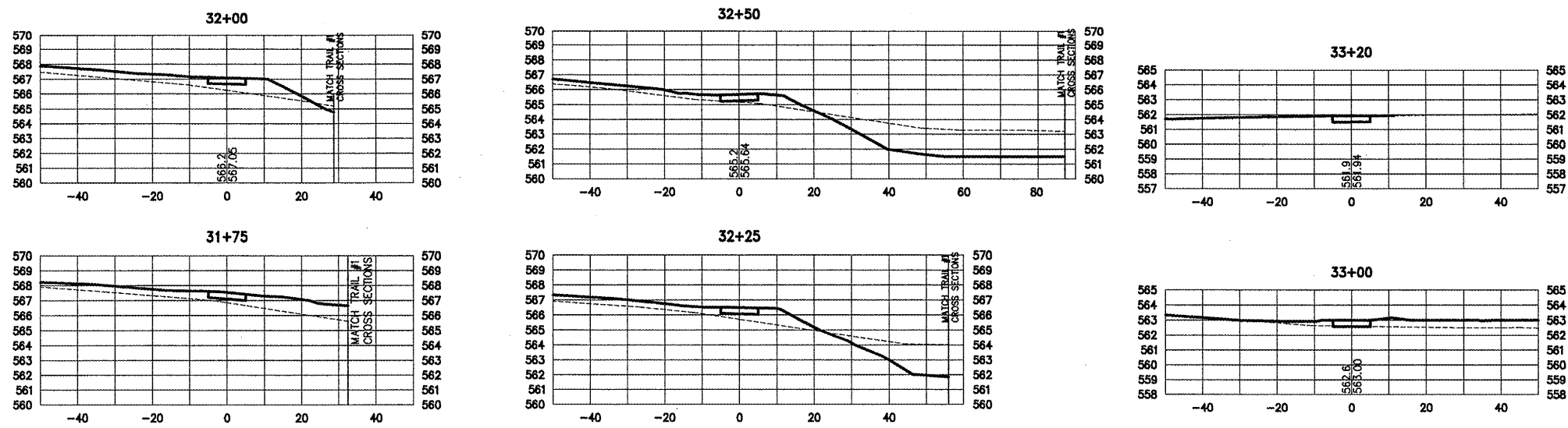
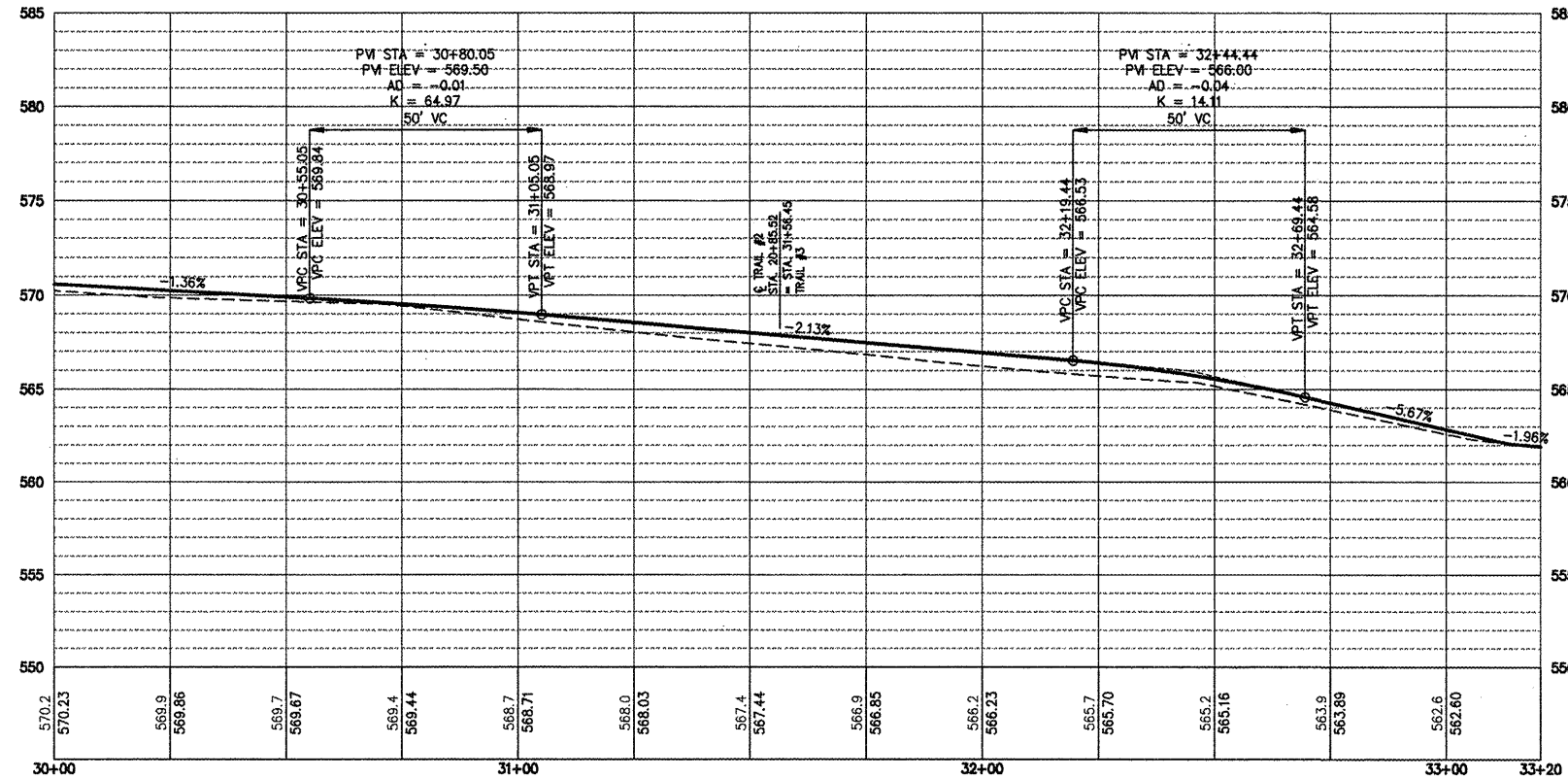
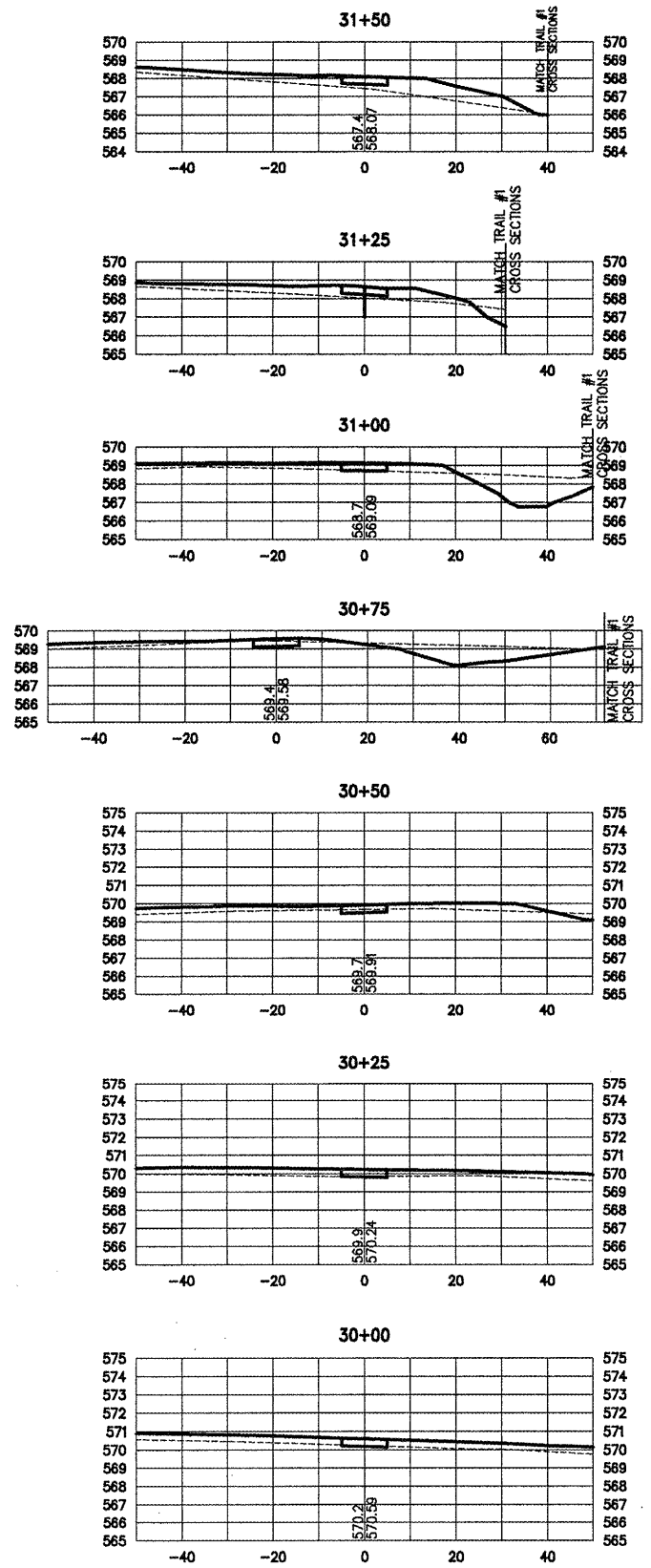
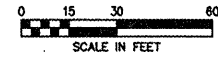

**SHIVEHATTERY**  
ARCHITECTURE+ENGINEERING

1701 River Drive Suite 200 | Moline, Illinois 61265  
309.764.7650 | fax: 309.764.8616 | shive-hattery.com  
Iowa | Illinois | Missouri | Illinois Firm Number: 184-000214

FILE NAME =	USER NAME = \$USER\$	DESIGNED - PMH	REVISED -
\$FILE\$		DRAWN - MAC	REVISED -
	PLOT SCALE = \$SCALE\$	CHECKED - 07-08-11	REVISED -
	PLOT DATE = \$DATE\$	DATE - 07-08-11	REVISED -

STATE OF ILLINOIS  
DEPARTMENT OF TRANSPORTATION

CROSS SECTIONS TRAIL #3

SCALE: SHEET NO. 9 OF 17 SHEETS STA. TO STA.

F.A.U. RTE.	SECTION	COUNTY	TOTAL SHEETS	SHEET NO.
xxxx	06-00236-00-L5	ROCK ISLAND	17	9
CONTRACT NO. 85542				
FED. ROAD DIST. NO. 2 ILLINOIS FED. AID PROJECT				

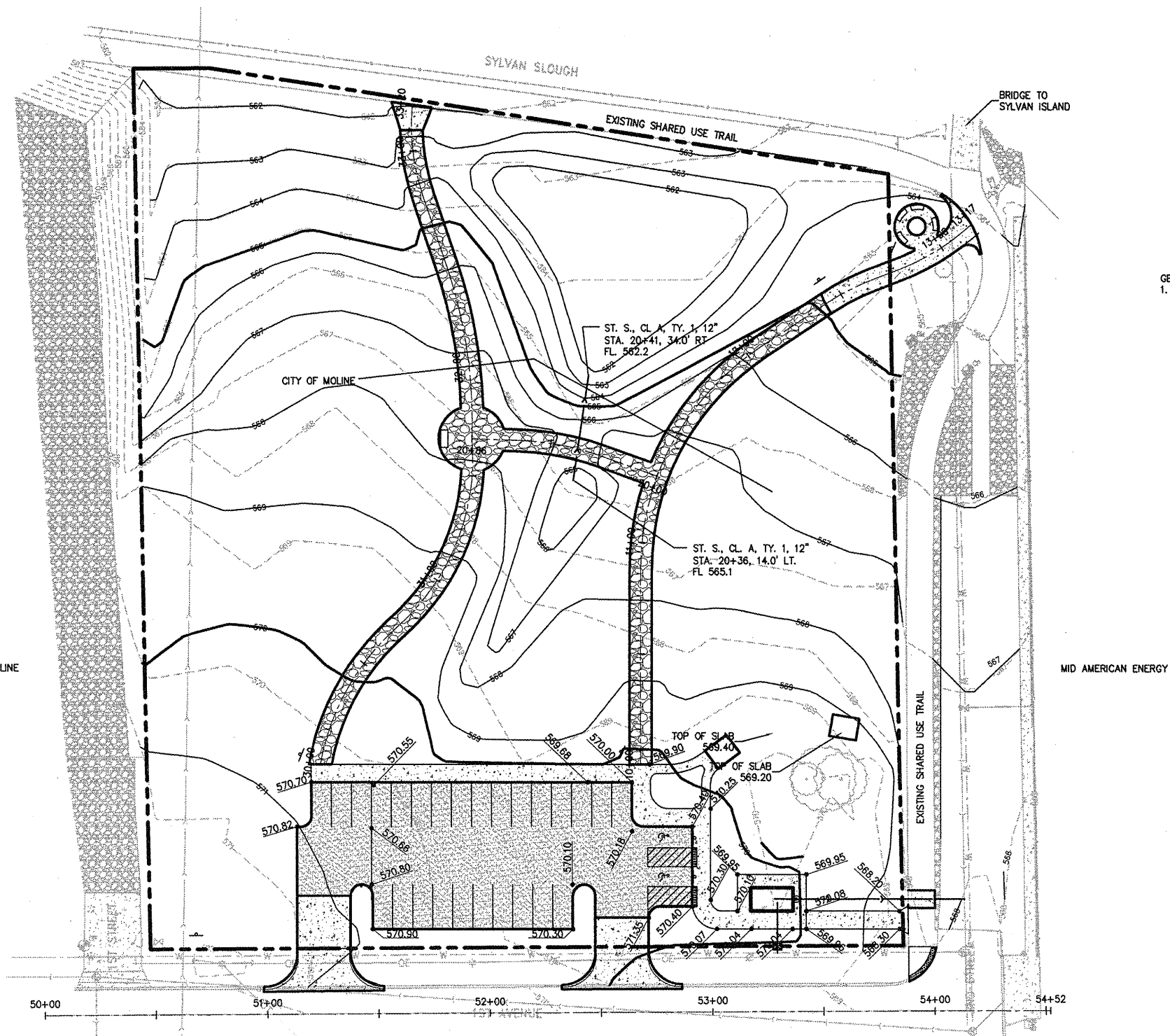
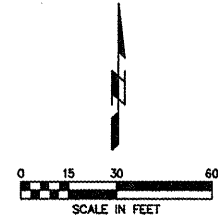

GENERAL NOTES:  
 1. 100 YEAR FLOOD ELEVATION 565 TAKEN FROM FIRM 17161C0120F,  
 APRIL 5, 2010.

**SHIVEHATTERY**  
 ARCHITECTURE+ENGINEERING

1701 River Drive Suite 200 | Moline, Illinois 61265  
 309.764.7850 | fax: 309.764.8616 | shive-hattery.com  
 Iowa | Illinois | Missouri | Illinois Firm Number: 184-000214

FILE NAME =	USER NAME = \$USER\$	DESIGNED - PMH	REVISED -
\$FILEL\$		DRAWN - MAC	REVISED -
	PLOT SCALE = \$SCALE\$	CHECKED - 07-08-11	REVISED -
	PLOT DATE = \$DATE\$	DATE - 07-08-11	REVISED -

STATE OF ILLINOIS  
 DEPARTMENT OF TRANSPORTATION

GRADING PLAN

SCALE: SHEET NO. 10 OF 17 SHEETS STA. TO STA.

F.A.U. RTE.	SECTION	COUNTY	TOTAL SHEETS	SHEET NO.
xxxx	06-00236-00-LS	ROCK ISLAND	17	10
CONTRACT NO. 85542				
FED. ROAD DIST. NO. 2   ILLINOIS   FED. AID PROJECT				

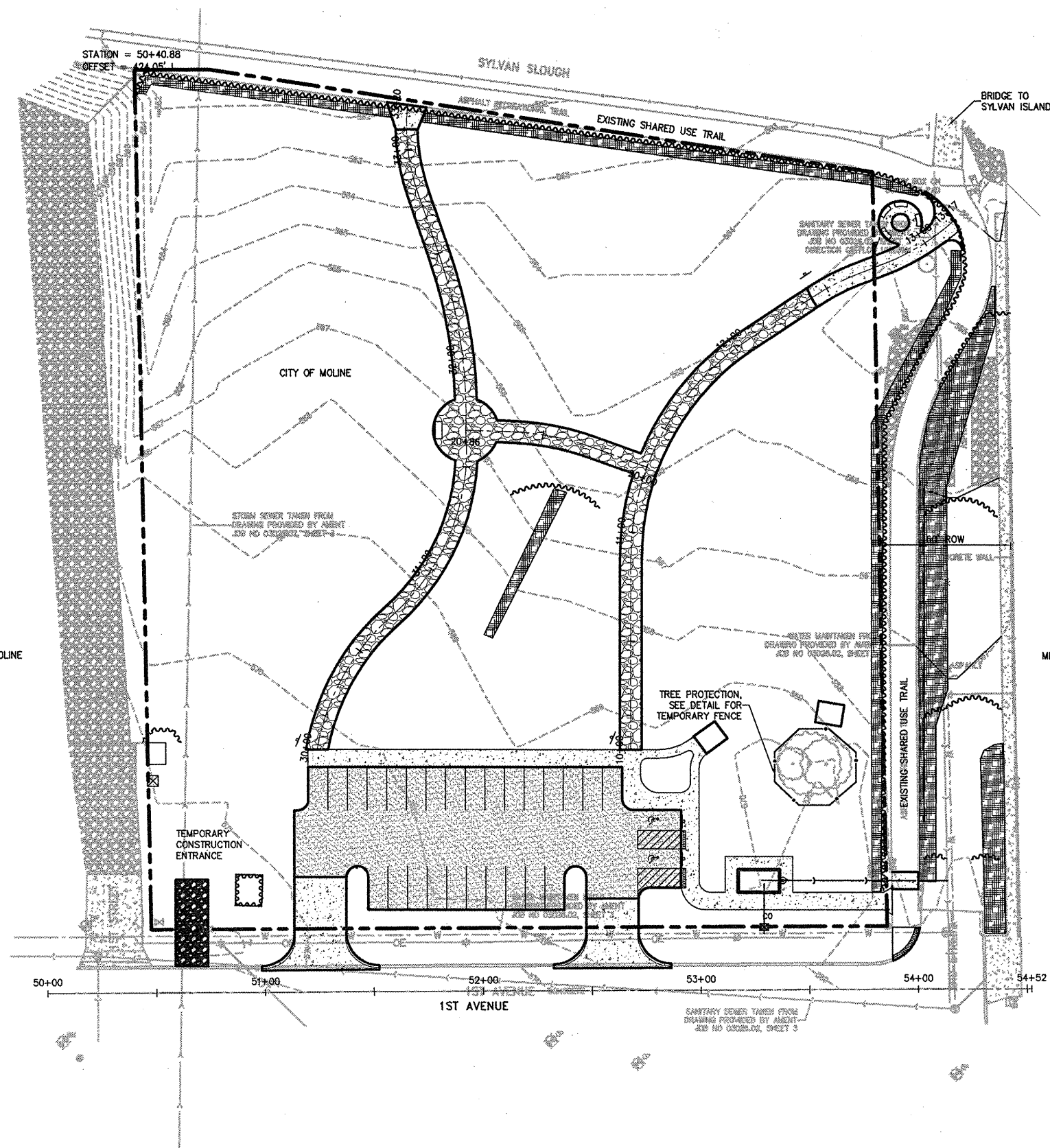
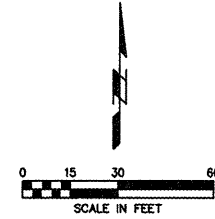

**EROSION CONTROL LEGEND:**

- SILT FENCE OR STRAW WATTLE
- TEMPORARY CONSTRUCTION ENTRANCE
- CONCRETE WASHOUT AREA
- PORTABLE RESTROOM
- MATERIALS STORAGE AREA
- EROSION CONTROL BLANKET

MID AMERICAN ENERGY

**SHIVEHATTERY**  
ARCHITECTURE+ENGINEERING

1701 River Drive Suite 200 | Moline, Illinois 61205  
309.764.7650 | fax: 309.764.8616 | shive-hattery.com

Iowa | Illinois | Missouri | Illinois Firm Number: 184-000214

STATE OF ILLINOIS  
DEPARTMENT OF TRANSPORTATION



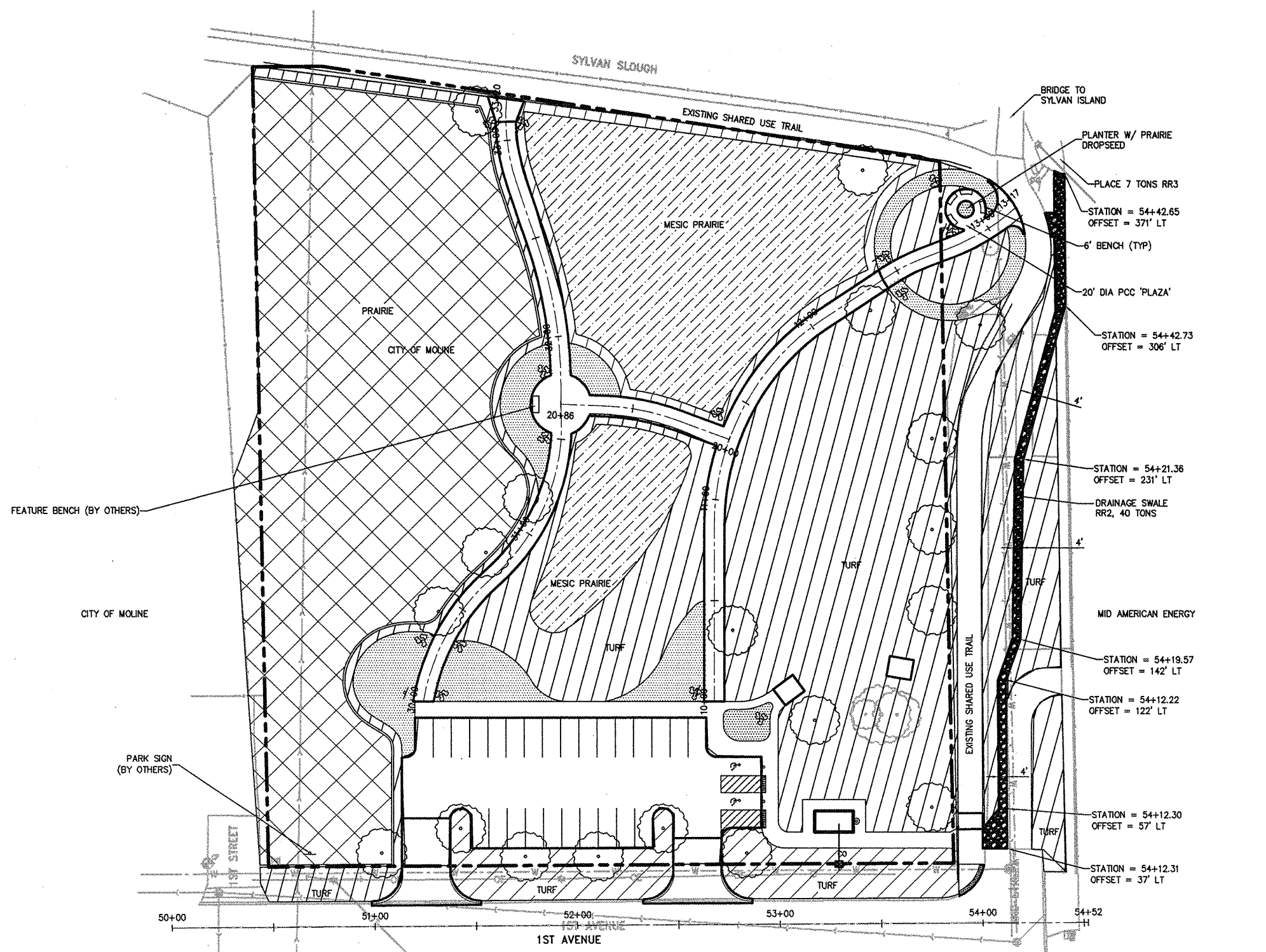
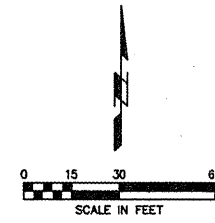

EROSION CONTROL PLAN

FILE NAME =	USER NAME = \$USER\$	DESIGNED - FMH	REVISED -
\$FILEL\$		DRAWN - MAC	REVISED -
	PLOT SCALE = \$SCALE\$	CHECKED - 07-08-11	REVISED -
	PLOT DATE = \$DATE\$	DATE - 07-08-11	REVISED -

F.A.U. RTE.	SECTION	COUNTY	TOTAL SHEETS	SHEET NO.
xxxx	06-00236-00-LS	ROCK ISLAND	17	11
CONTRACT NO. 85542				
SCALE:	SHEET NO. 11 OF 17 SHEETS	STA.	TO STA.	FED. ROAD DIST. NO. 2   ILLINOIS   FED. AID PROJECT

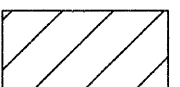

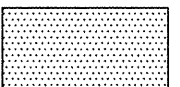
**LEGEND**

-  LOW MAINTENANCE LAWN MIX SEEDING, CLASS 1B
-  LOW PROFILE NATIVE GRASS MIX SEEDING, CLASS 4A
-  MESIC NATIVE SEED MIX SEEDING, CLASS 5B
-  PRAIRIE DROP SEED(SPOROBOLIS HETEROLEPIS) PLANTING, PERENNIAL PLANTS, ORNAMENTAL TYPE, QUART POT, 3" THICK MULCH
-  STONE OUTCROPPING, 12 LOCATIONS

**NOTE: TREES SHOWN WILL BE PLANTED BY OTHERS, NOT PART OF THIS CONTRACT**



Signature: *Sandra L. Doran*  
 Date: 07/14/11  
 Exp. Date: 08/31/13

**SHIVEHATTERY**  
 ARCHITECTURE+ENGINEERING  
 1701 River Drive Suite 200 | Moline, Illinois 61265  
 309.764.7650 | fax: 309.764.8616 | shive-hattery.com  
 Iowa | Illinois | Missouri | Illinois Firm Number: 184-000214

FILE NAME =	USER NAME = \$USER\$	DESIGNED - PMH	REVISED -
\$FILE\$		DRAWN - MAC	REVISED -
	PLOT SCALE = \$SCALE\$	CHECKED - 07-08-11	REVISED -
	PLOT DATE = \$DATE\$	DATE - 07-08-11	REVISED -

**STATE OF ILLINOIS  
 DEPARTMENT OF TRANSPORTATION**

**LANDSCAPE PLAN**

SCALE: SHEET NO. 12 OF 17 SHEETS STA. TO STA.

F.A.U. RTE.	SECTION	COUNTY	TOTAL SHEETS	SHEET NO.
xxxx	06-00236-00-LS	ROCK ISLAND	17	12
CONTRACT NO. 85542				
FED. ROAD DIST. NO. 2 ILLINOIS FED. AID PROJECT				

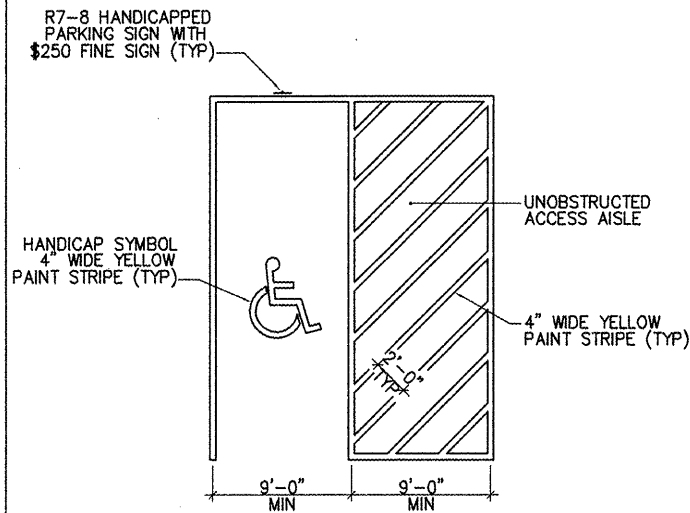

**1 HANDICAP PARKING SPACE STRIPING**  
NOT TO SCALE 02760-B-02

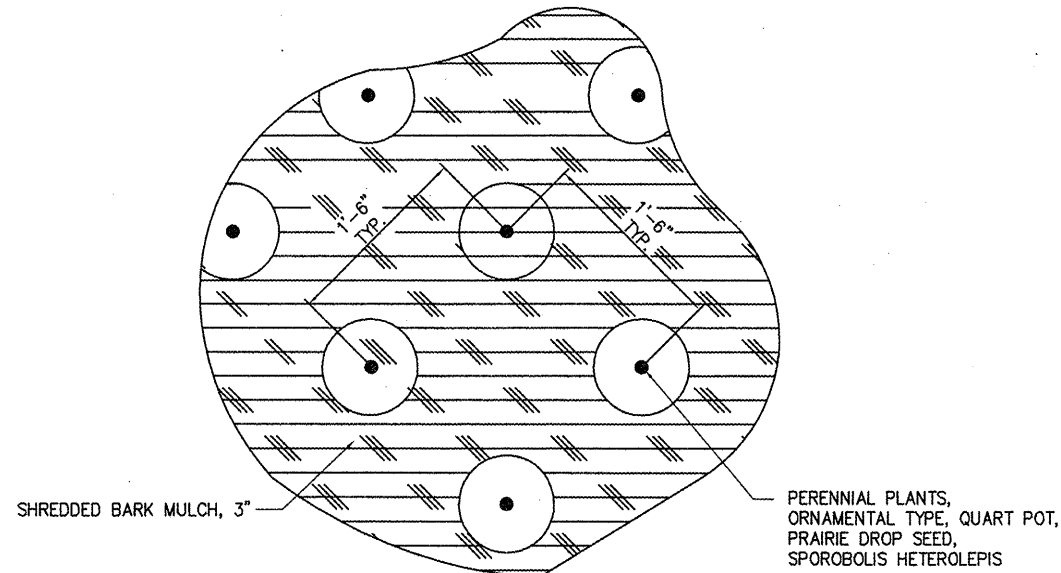

**4 PERENNIAL PLANTING DETAIL**  
NOT TO SCALE

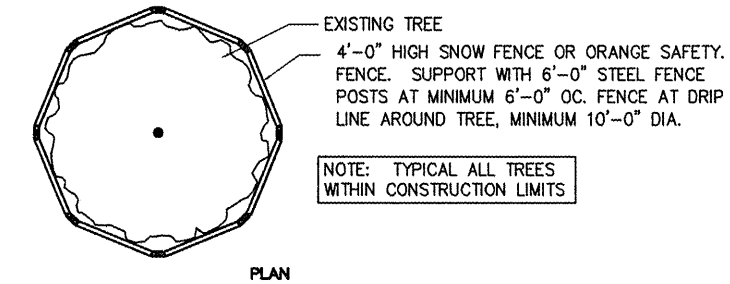
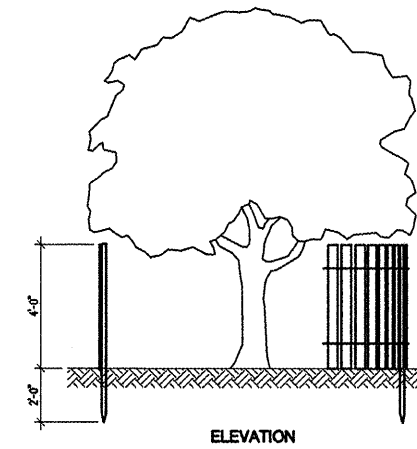

**7 TEMPORARY FENCE DETAIL**  
NOT TO SCALE

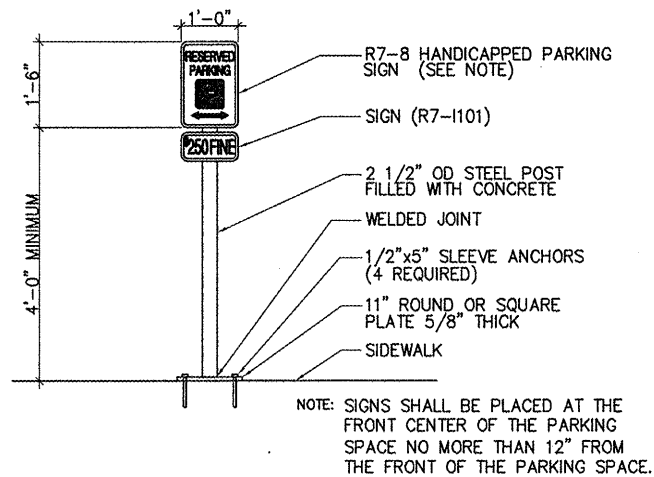

**2 HANDICAPPED PARKING SIGN**  
NOT TO SCALE 02890-B-01

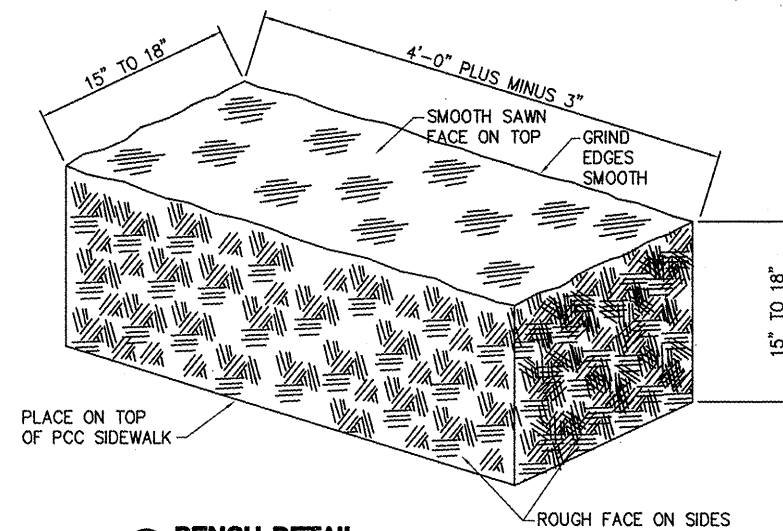

**6 BENCH DETAIL**  
NOT TO SCALE

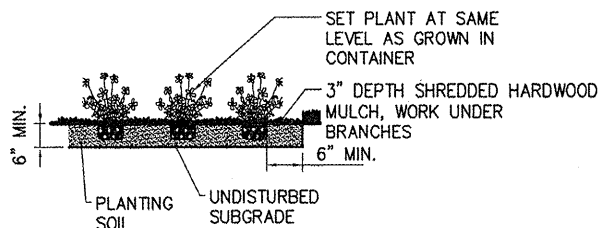

**3 PERENNIAL PLANTING**  
NOT TO SCALE ALSO SEE DETAIL 4

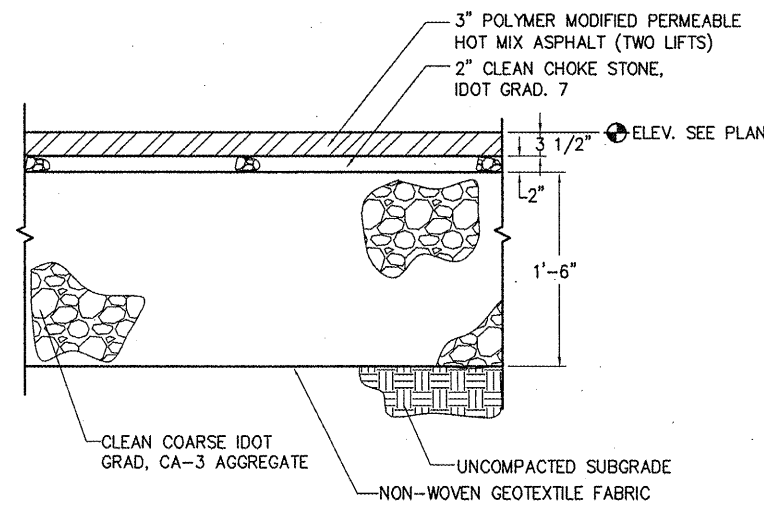

**8 PERMEABLE PAVEMENT FOR PARKING LOT**  
NOT TO SCALE

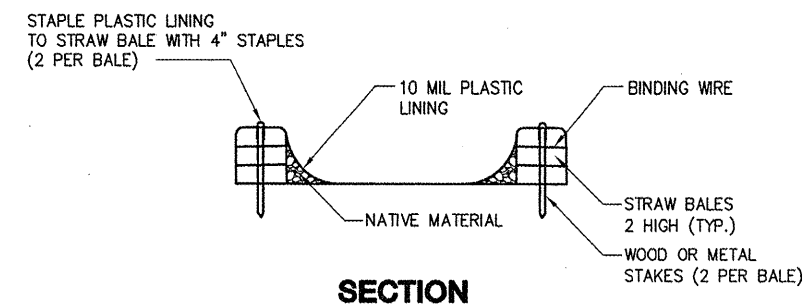

NOTES:  
1. ACTUAL LAYOUT DETERMINED IN FIELD.  
2. A CONCRETE WASHOUT SIGN SHALL BE INSTALLED WITHIN 30 FT OF THE TEMPORARY CONCRETE WASHOUT FACILITY.

**8 CONCRETE WASHOUT DETAIL**  
NOT TO SCALE

**SHIVEHATTERY**  
ARCHITECTURE+ENGINEERING

1701 River Drive Suite 200 | Moline, Illinois 61265  
309.764.7650 | fax: 309.764.9616 | shive-hattery.com  
Iowa | Illinois | Missouri | Illinois Firm Number: 184-000214

FILE NAME =	USER NAME = \$USER\$	DESIGNED - PHM	REVISED -
\$FILEL\$		DRAWN - MAC	REVISED -
	PLOT SCALE = \$SCALE\$	CHECKED - 07-08-11	REVISED -
	PLOT DATE = \$DATE\$	DATE - 07-08-11	REVISED -

STATE OF ILLINOIS  
DEPARTMENT OF TRANSPORTATION

SCALE:		SHEET NO. 13 OF 17 SHEETS		STA. TO STA.	
--------	--	---------------------------	--	--------------	--

DETAIL SHEET

F.A.U. RTE.	SECTION	COUNTY	TOTAL SHEETS	SHEET NO.
xxxx	06-00236-00-LS	ROCK ISLAND	17	13
CONTRACT NO. 85542				
FED. ROAD DIST. NO. 2 ILLINOIS FED. AID PROJECT				



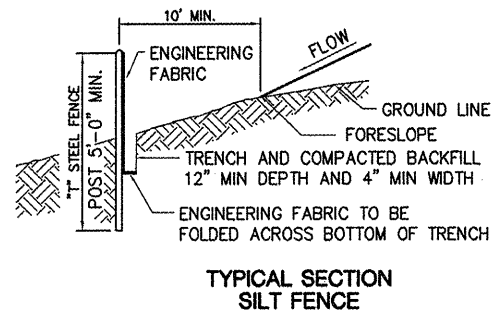

**TYPICAL SECTION SILT FENCE**

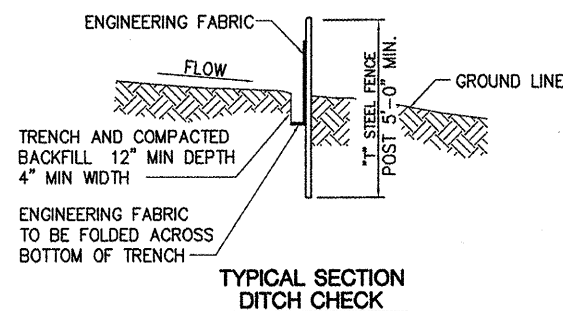

**TYPICAL SECTION DITCH CHECK**

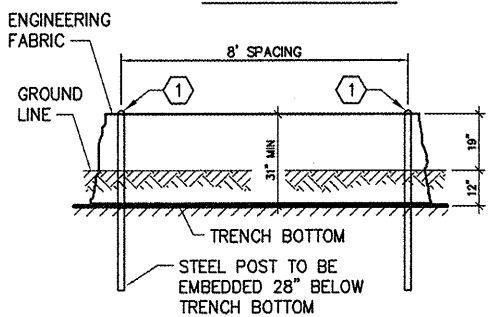

**DETAILS OF SILT FENCE**

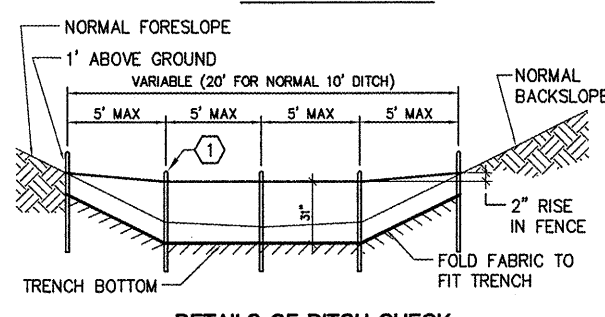

**DETAILS OF DITCH CHECK**

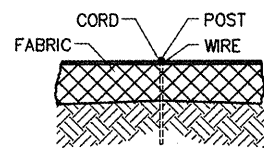

**FRONT VIEW**

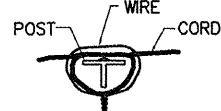

**POST TOP VIEW**

**NOTES:**

- ① SECURE TOP OF ENGINEERING FABRIC TO STEEL POST.
- ② ENGINEERING FABRIC TO BE PLACED TO BOTTOM OF TRENCH.
- ③ ENGINEERING FABRIC SHALL HAVE A MINIMUM 36" WIDTH.

NOTE: TWIST CORD AND PLACE AROUND POST, SECURE WITH WIRE.

**9 SILT FENCE DETAIL**  
NOT TO SCALE

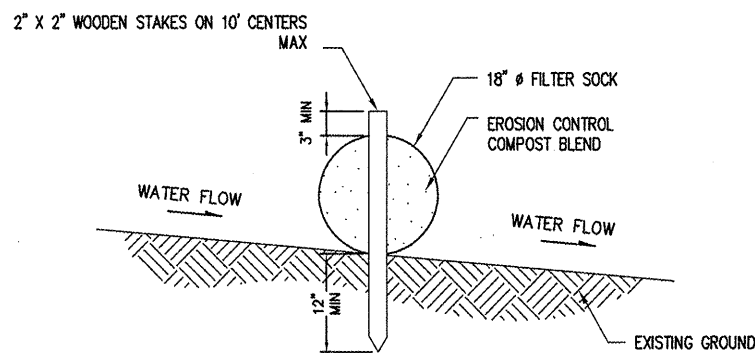

**11 STRAW WATTLE DETAIL**  
NOT TO SCALE

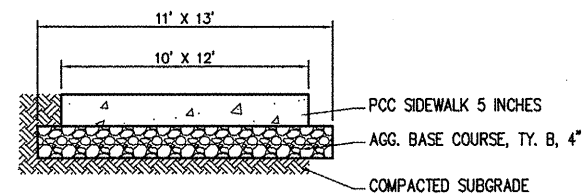

**12 PCC PAD FOR PICNIC TABLE**  
NOT TO SCALE

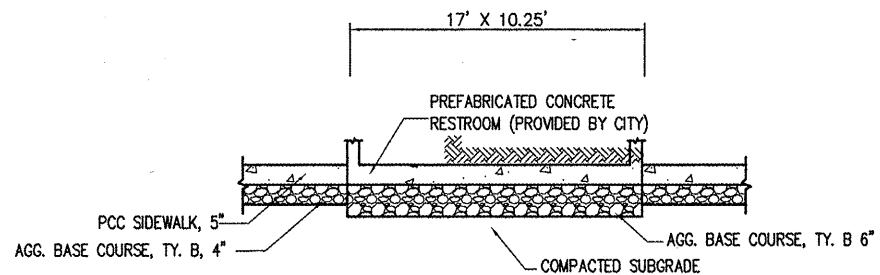

**13 AGG BASE FOR PREFABRICATED CONCRETE RESTROOM**  
NOT TO SCALE

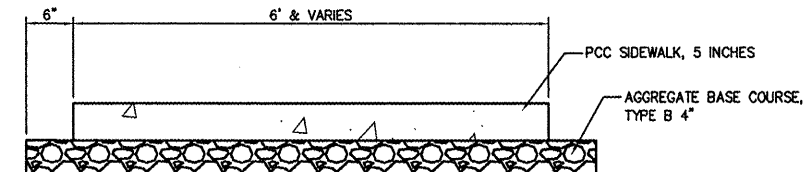

**14 TYPICAL SECTION - SIDEWALK**  
NOT TO SCALE

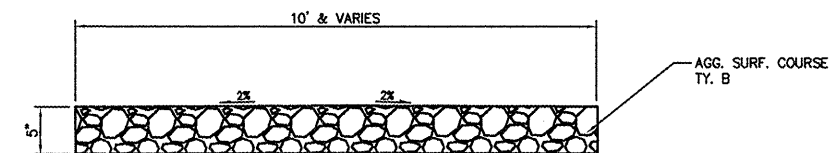

**15 TYPICAL SECTION - CRUSHED STONE PATH**  
NOT TO SCALE

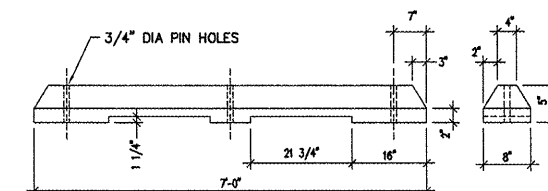

**GENERAL NOTES - PRECAST CURB**

1. DETAILS INDICATED HEREON ARE TYPICAL ONLY. ALTERNATE DESIGNS MAY BE SUBMITTED TO THE ENGINEER FOR APPROVAL. ANY ALTERNATE DESIGN APPROVED FOR USE ON CONSTRUCTION SHALL CONFORM TO THE MINIMUM REQUIREMENTS AS SHOWN. REFER TO ADDITIONAL PORTIONS OF THE PROJECT PLANS FOR COMPLETE DATA AS TO INSTALLATION, LOCATION, ETC.
2. ANY PRECAST CONCRETE CURB UNIT MEASURING LONGER THAN 6'-0" WILL REQUIRE 3 ANCHOR PINS TO HOLD CURB IN POSITION.
3. ANCHOR PINS SHALL BE 5/8" DIAMETER, 1'-6" LONG. ANCHOR PINS THAT ARE NOT BEDDED IN CONCRETE SHALL BE GALVANIZED. GROUT ANCHOR PINS MINIMUM OF 2" DEEP.
4. REINFORCING STEEL USED IN PRECAST CONCRETE CURB UNITS SHALL HAVE A MINIMUM OF 2" CLEARANCE TO THE CONCRETE SURFACES.
5. MINIMUM CONCRETE STRENGTH IS 4,000 PSI. LOCATE 3'-0" FROM EDGE OF PAVEMENT TO CENTER OF CURB. CENTER CURB IN EACH STALL.

**16 PARKING BLOCK**  
NOT TO SCALE

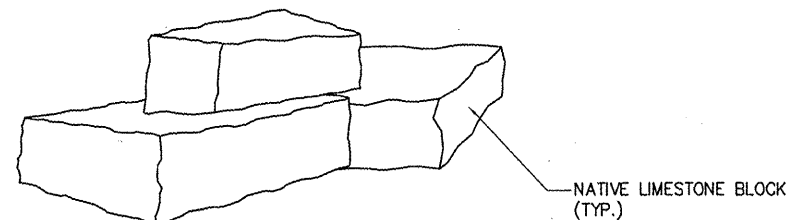

BLOCKS SHALL BE ROUGHLY 1.5' TO 2' WIDE BY 1.5' TO 2' LONG BY 8" HIGH. ARRANGE IN GROUPS OF TWO TO THREE BLOCKS WHERE INDICATED ON THE LANDSCAPE PLAN SHEET.

**10 STONE OUTCROPPING DETAIL**  
NOT TO SCALE

**SHIVEHATTERY**  
ARCHITECTURE+ENGINEERING

1701 River Drive Suite 200 | Moline, Illinois 61265  
309.764.7850 | fax: 309.764.8616 | shive-hattery.com  
Iowa | Illinois | Missouri | Illinois Firm Number: 184-000214

STATE OF ILLINOIS  
DEPARTMENT OF TRANSPORTATION

DETAILS

F.A.U. RTE.	SECTION	COUNTY	TOTAL SHEETS	SHEET NO.
xxxx	06-00236-00-LS	ROCK ISLAND	17	14
CONTRACT NO. 85542				
FED. ROAD DIST. NO. 2 ILLINOIS FED. AID PROJECT				

FILE NAME =	USER NAME = \$USER\$	DESIGNED - PHM	REVISED -
\$FILEL\$		DRAWN - MAC	REVISED -
	PLOT SCALE = \$SCALE\$	CHECKED - 07-08-11	REVISED -
	PLOT DATE = \$DATE\$	DATE - 07-08-11	REVISED -

SCALE: SHEET NO. 14 OF 17 SHEETS STA. TO STA.

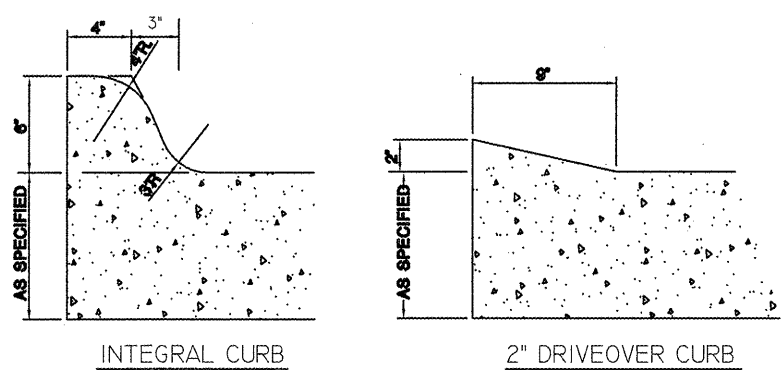

INTEGRAL CURB      2" DRIVEOVER CURB

NOTE:  
ALL HONEYCOMBED AND OR POROUS  
AREAS IN BACK OF CURB  
WILL BE CORRECTED AS DIRECTED  
BY THE ENGINEER.

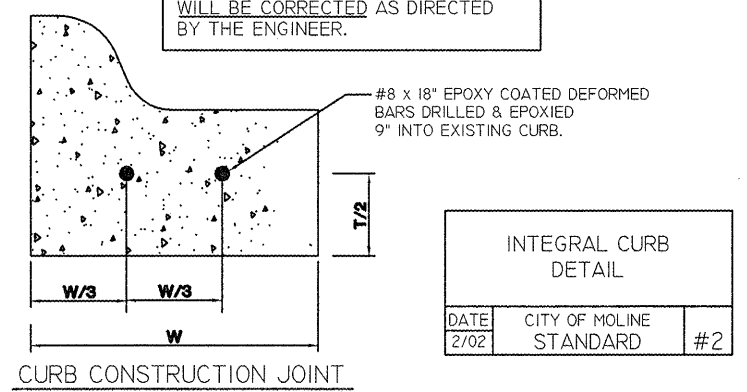

CURB CONSTRUCTION JOINT

INTEGRAL CURB DETAIL		
DATE	CITY OF MOLINE	#2
2/02	STANDARD	

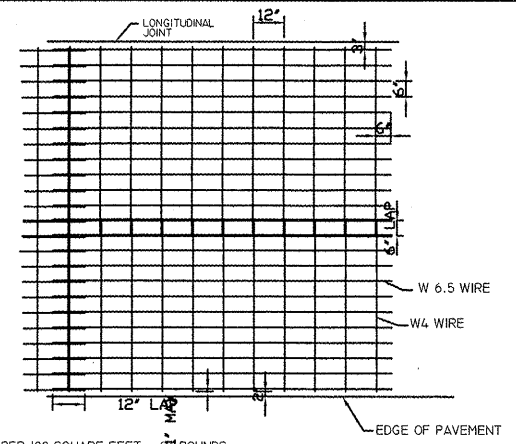

APPROXIMATE WEIGHT PER 100 SQUARE FEET = 65 POUNDS  
THE PAVEMENT FABRIC SHALL CONFORM TO THE REQUIREMENTS  
OF THE SPECIFICATIONS FOR WELDED STEEL WIRE FABRIC FOR  
CONCRETE REINFORCEMENT, AASHTO M-55

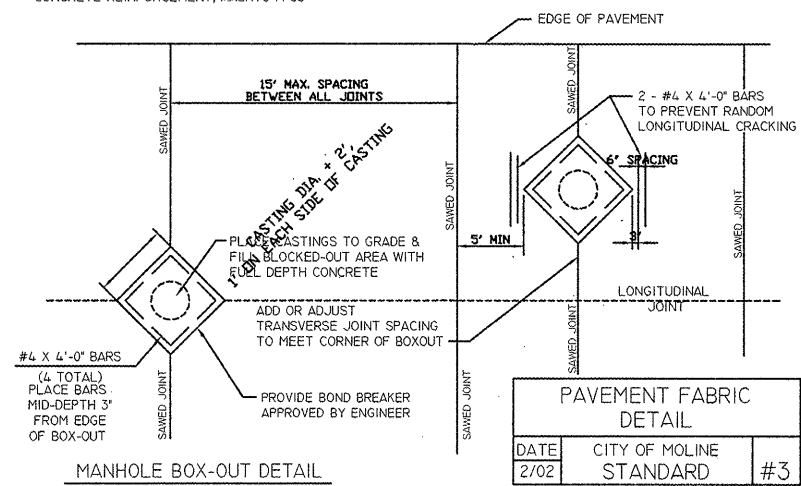

MANHOLE BOX-OUT DETAIL

PAVEMENT FABRIC DETAIL		
DATE	CITY OF MOLINE	#3
2/02	STANDARD	

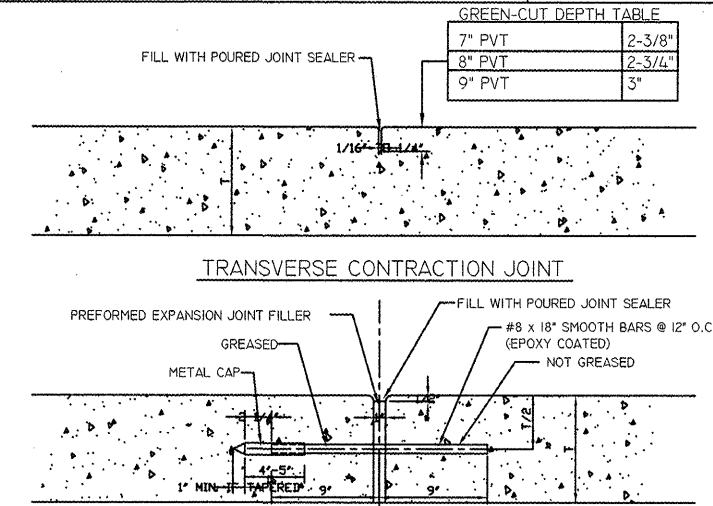

TRANSVERSE CONTRACTION JOINT

EXPANSION JOINT TEMPERATURE TABLE	
80 DEGREES +	NONE
50 - 80 DEGREES	1/2"
BELOW 50 DEGREES	1"

EXPANSION JOINT

NOTES:  
1-1/8" HOLES SHALL BE DRILLED IN PREFORMED  
EXPANSION JOINT FILLER FOR THE BARS TO BE  
PLACED. NO SLOTS OR GAPS WILL BE ALLOWED  
IN THE JOINT FILLER

SEMI-RIGID BASKET SHALL BE USED TO HOLD BARS  
PARALLEL WITH PAVEMENT SURFACE AND  
PERPENDICULAR TO JOINT

1. AFTER SAWING FLUSH JOINT WITH WATER OR AIR.
2. CLEAN BY SAND BLASTING UNTIL SURFACES ARE FREE OF SAWCUTTING FINES
3. JUST PRIOR TO INSTALLATION OF BACKER ROPE, BLOW WITH OIL AND WATER FREE COMPRESSED AIR TO ELIMINATE SAND AND WATER.

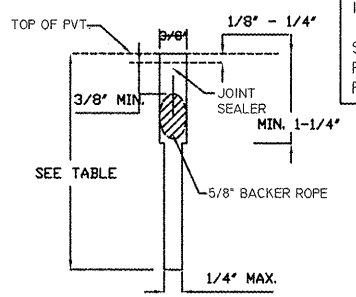

CONSTRUCTION JOINT & EXPANSION JOINT DETAIL		
DATE	CITY OF MOLINE	#5
2/02	STANDARD	

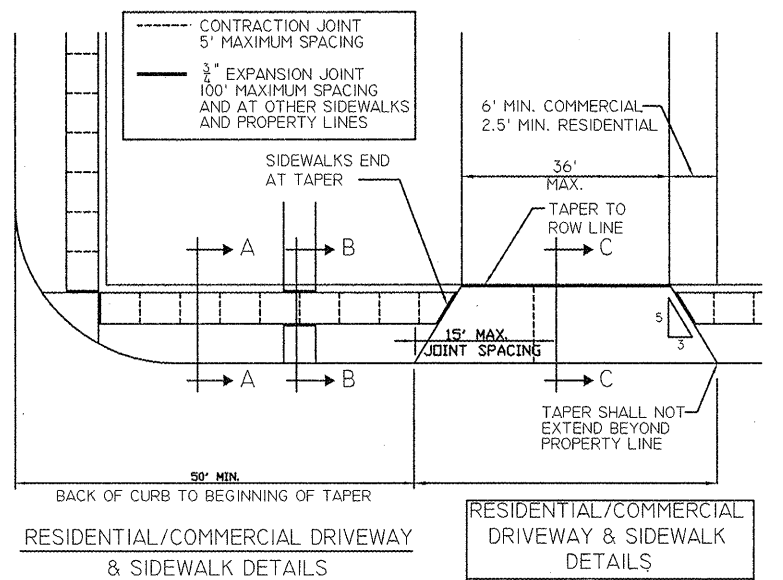

RESIDENTIAL/COMMERCIAL DRIVEWAY & SIDEWALK DETAILS

RESIDENTIAL/COMMERCIAL DRIVEWAY & SIDEWALK DETAILS		
DATE	CITY OF MOLINE	#7
5/02	STANDARD	

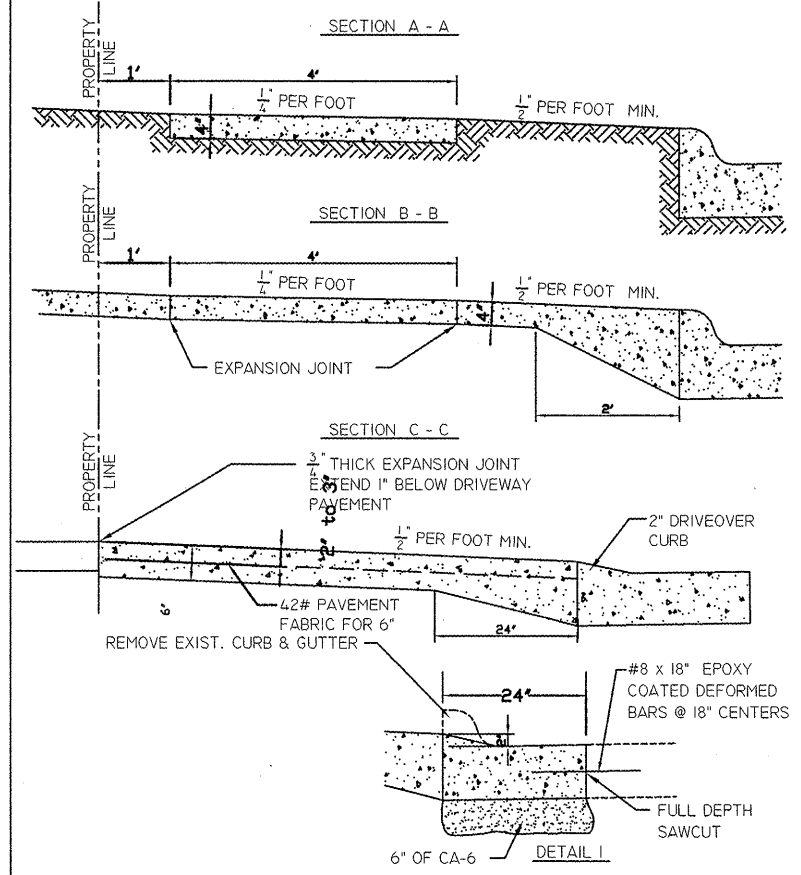

NOTE:  
CONSTRUCTION SHALL BE IN ACCORDANCE  
WITH STATE OF ILL. STANDARD SPECIFICATIONS  
NO MORE THAN ONE DRIVEWAY PER LOT  
WHERE THE STREET PAVEMENT HAS 6" CURB, THE CURB  
SHALL BE REMOVED & REPLACED AS SHOWN IN DETAIL 1  
OR C-C ALT. CURB & DWY. POURED INTEGRAL ON  
STND SHEET 7B. CURB MAY BE CUT OFF  
WITH A SAW DESIGNED FOR THIS APPLICATION.  
DRIVEWAY PAVEMENT SHALL BE 6" REINFORCED  
OR 7" PLAIN CEMENT CONCRETE.  
REINFORCING SHALL BE MESH WEIGHING  
42 LBS. PER 100 SQUARE FEET.  
ALL JOINTS AT BACK OF CURB SHALL BE SEALED  
WITH APPROVED POURED JOINT SEALER.  
WHERE THE STREET PAVEMENT HAS 4" DRIVEOVER  
CURB, THE CURB MAY REMAIN INTACT. NO MATERIAL  
WILL BE ALLOWED TO BE PLACE IN THE GUTTER.  
BARS TO BE 18" LONG, DRILLED  
AND EPOXIED 9" INTO EXISTING PAVEMENT

TYPICAL BOULEVARD SECTIONS DETAIL		
DATE	CITY OF MOLINE	#7A
2/02	STANDARD	

**SHIVEHATTERY**  
ARCHITECTURE-ENGINEERING  
1701 River Drive Suite 200 | Moline, Illinois 61295  
309.764.7650 | fax: 309.764.8616 | shive-hattery.com  
Iowa | Illinois | Missouri | Illinois Firm Number: 184-000214

FILE NAME =	USER NAME = \$USER\$	DESIGNED - PMH	REVISED -
\$FILEL\$		DRAWN - MAC	REVISED -
	PLOT SCALE = \$SCALE\$	CHECKED - 07-08-11	REVISED -
	PLOT DATE = \$DATE\$	DATE - 07-08-11	REVISED -

STATE OF ILLINOIS  
DEPARTMENT OF TRANSPORTATION

SCALE:		SHEET NO. 15 OF 17 SHEETS		STA.	TO STA.
--------	--	---------------------------	--	------	---------

DEMOLITION PLAN

F.A.U. RTE.	SECTION	COUNTY	TOTAL SHEETS	SHEET NO.
xxxx	06-00236-00-LS	ROCK ISLAND	17	15
CONTRACT NO. 85542				
FED. ROAD DIST. NO. 2   ILLINOIS   FED. AID PROJECT				

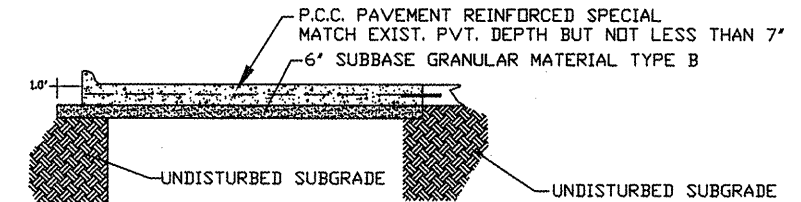
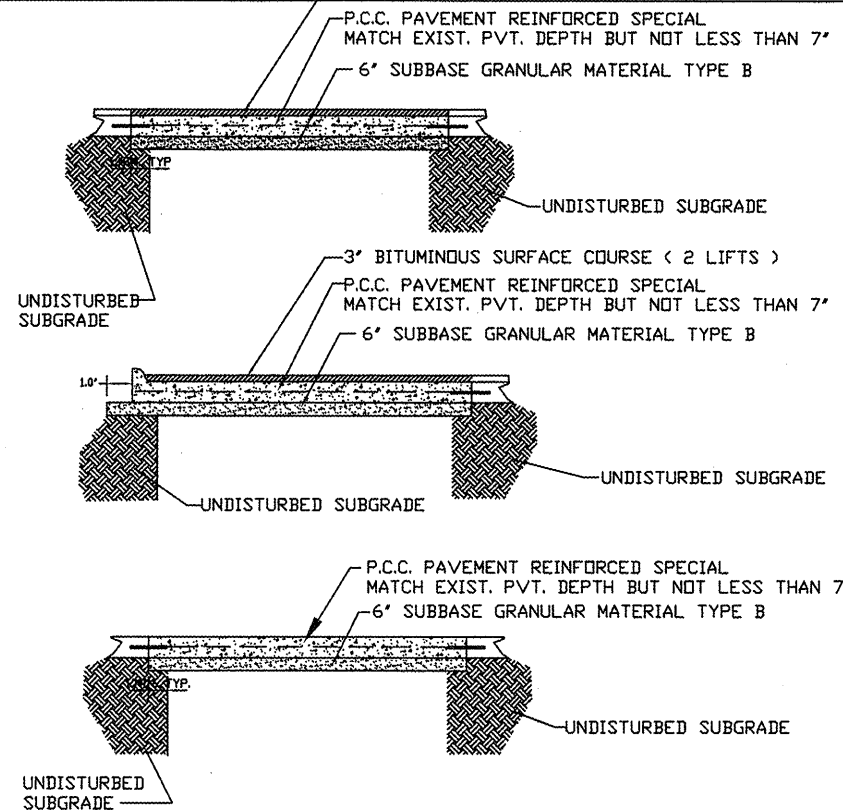

NOTE:  
BARS TO BE 1" DIA. x 18" LONG, DRILLED AND EPOXIED 9" INTO EXISTING PAVEMENT  
@ 30" O.C. LONGITUDINALLY, BOTH SIDES  
@ 18" O.C. TRANSVERSALLY, BOTH ENDS

PAVEMENT PATCHING DETAIL		
DATE	CITY OF MOLINE	8
1/03	STANDARD	

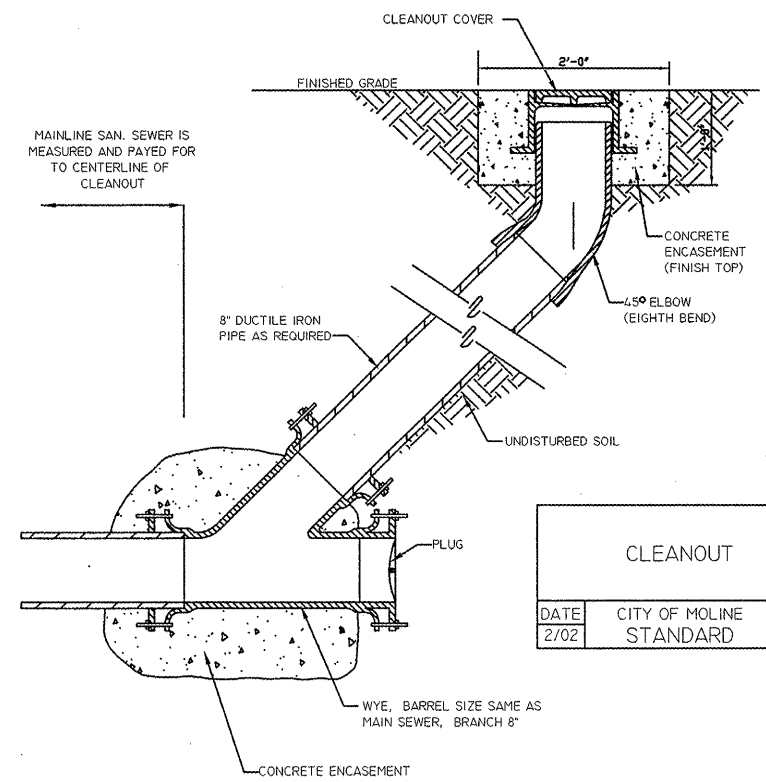

CLEANOUT		
DATE	CITY OF MOLINE	11
2/02	STANDARD	

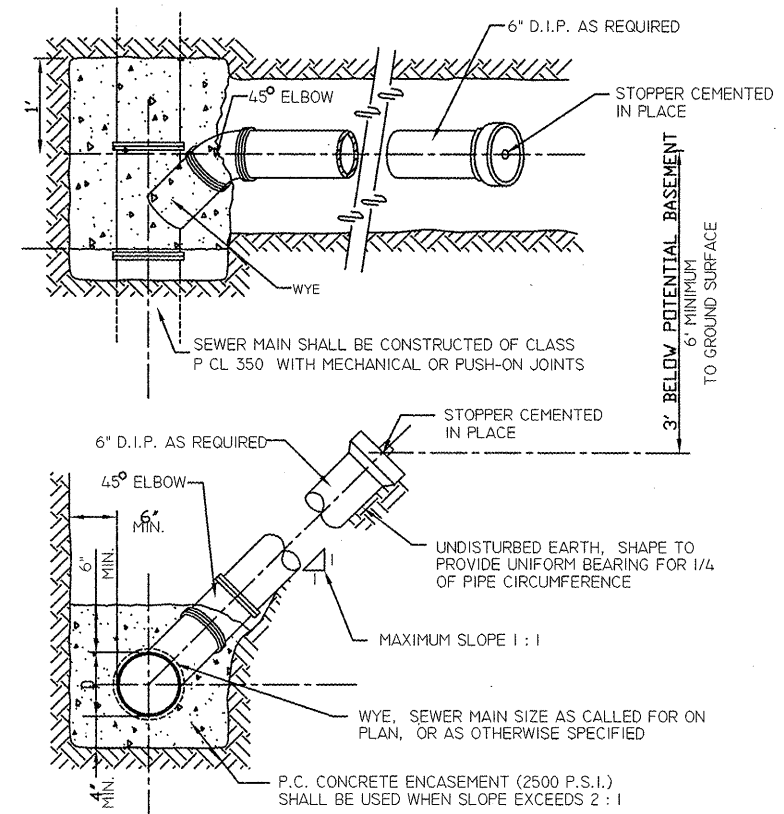

NOTE:  
RISERS TO BE CONSTRUCTED WHERE SEWER DEPTH EXCEEDS 6' BELOW POTENTIAL BASEMENT.  
ALL SERVICE SEWER IN R.O.W. SHALL BE 6" D.I.P.

TYPICAL SERVICE CONNECTION AND SEWER MAIN		
DATE	CITY OF MOLINE	12
2/02	STANDARD	

**SHIVEHATTERY**  
ARCHITECTURE+ENGINEERING  
1701 River Drive Suite 200 | Moline, Illinois 61265  
309.764.7650 | fax: 309.764.8616 | shive-hattery.com  
Iowa | Illinois | Missouri | Illinois Firm Number: 184-000214

FILE NAME =	USER NAME = \$USER\$	DESIGNED -- PMH	REVISED --
\$FILE\$		DRAWN -- MAC	REVISED --
	PLOT SCALE = \$SCALE\$	CHECKED -- 07-08-11	REVISED --
	PLOT DATE = \$DATE\$	DATE -- 07-08-11	REVISED --

STATE OF ILLINOIS  
DEPARTMENT OF TRANSPORTATION

DEMOLITION PLAN			
SCALE:	SHEET NO. 16 OF 17 SHEETS	STA.	TO STA.

F.A.U. RTE.	SECTION	COUNTY	TOTAL SHEETS	SHEET NO.
XXXX	06-00236-00-LS	ROCK ISLAND	17	16
CONTRACT NO. 85542				
FED. ROAD DIST. NO. 2 ILLINOIS FED. AID PROJECT				

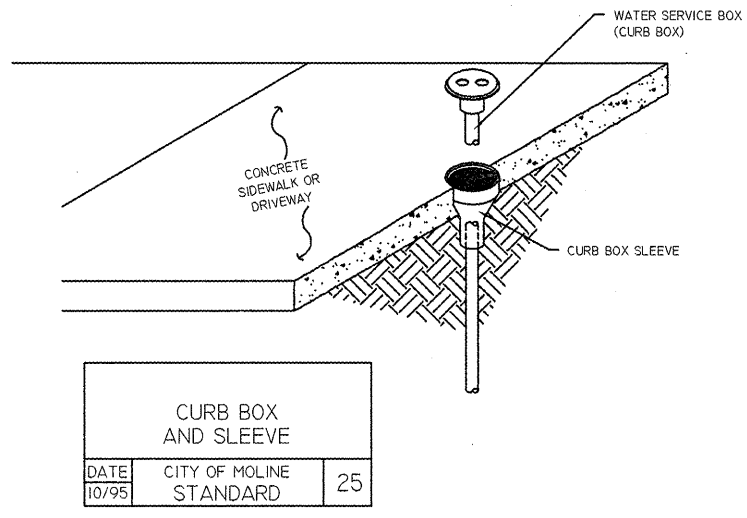
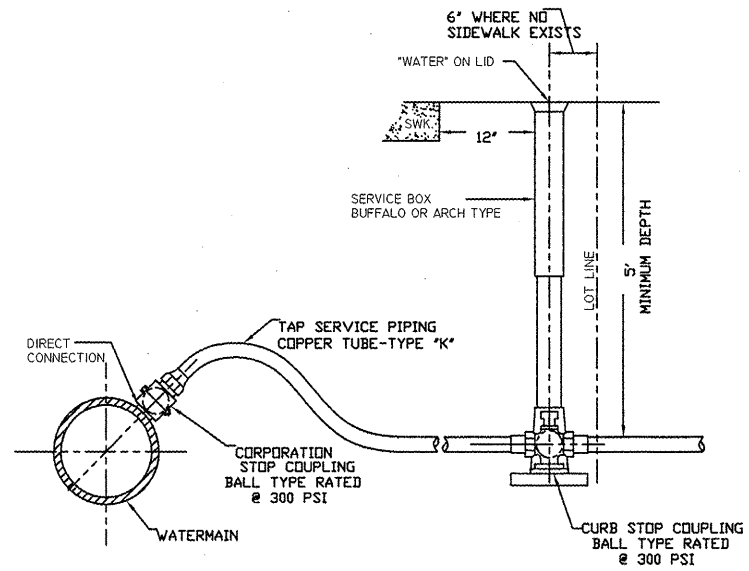
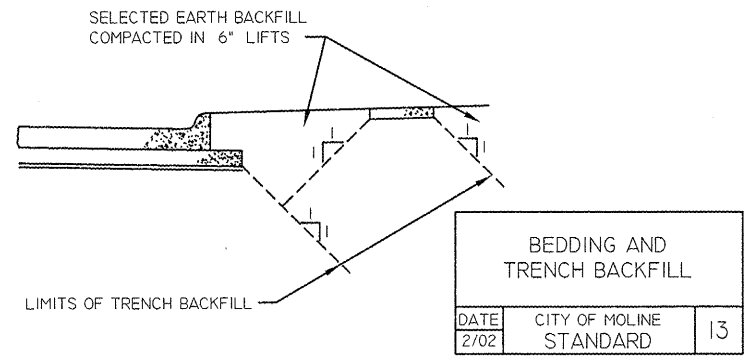
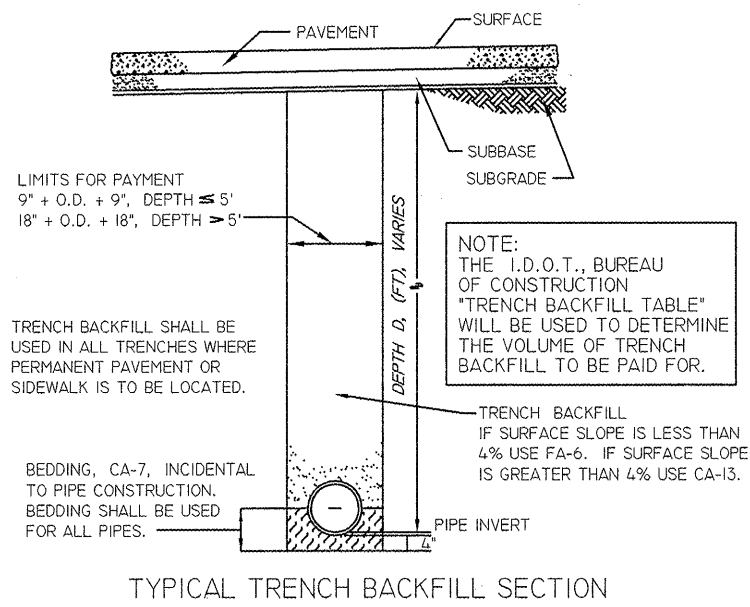

**SHIVEHATTERY**  
ARCHITECTURE+ENGINEERING

1701 River Drive Suite 200 | Moline, Illinois 61265  
309.764.7650 | fax: 309.764.9616 | shive-hattery.com  
Iowa | Illinois | Missouri | Illinois Firm Number: 184-000214

FILE NAME =	USER NAME = \$USER\$	DESIGNED -- PMH	REVISED --
\$FILE\$		DRAWN -- MAC	REVISED --
	PLOT SCALE = \$SCALE\$	CHECKED -- 07-08-11	REVISED --
	PLOT DATE = \$DATE\$	DATE -- 07-08-11	REVISED --

STATE OF ILLINOIS  
DEPARTMENT OF TRANSPORTATION

DEMOLITION PLAN

SCALE: SHEET NO. 17 OF 17 SHEETS STA. TO STA.

F.A.U. RTE.	SECTION	COUNTY	TOTAL SHEETS	SHEET NO.
xxxx	06-00236-00-LS	ROCK ISLAND	17	17
CONTRACT NO. 85542				
FED. ROAD DIST. NO. 2 ILLINOIS   FED. AID PROJECT				