

NOTE:  
CURB PAINT SHALL BE YELLOW URETHANE.  
TO BE PAID FOR AS "PAINT CURB".

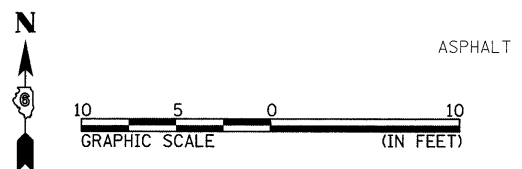
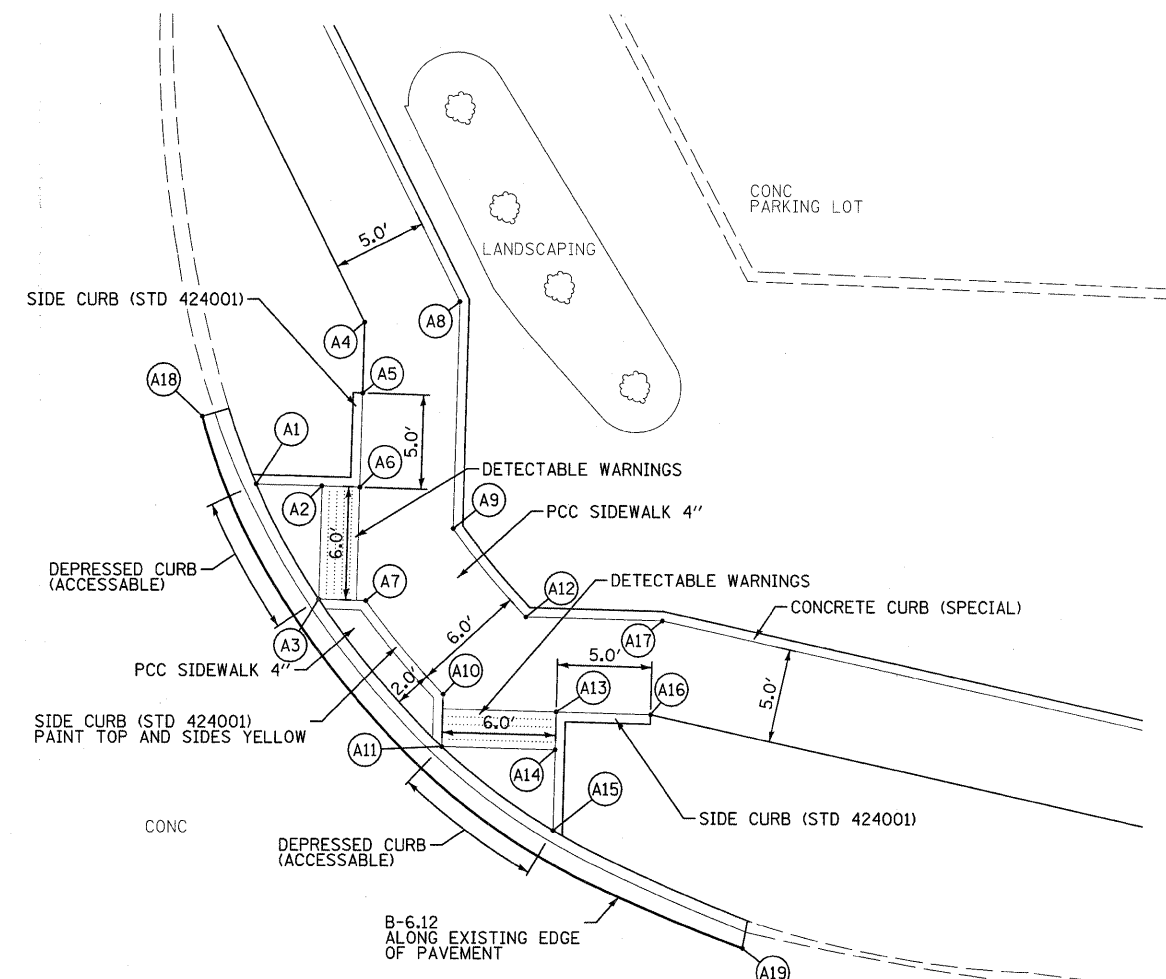
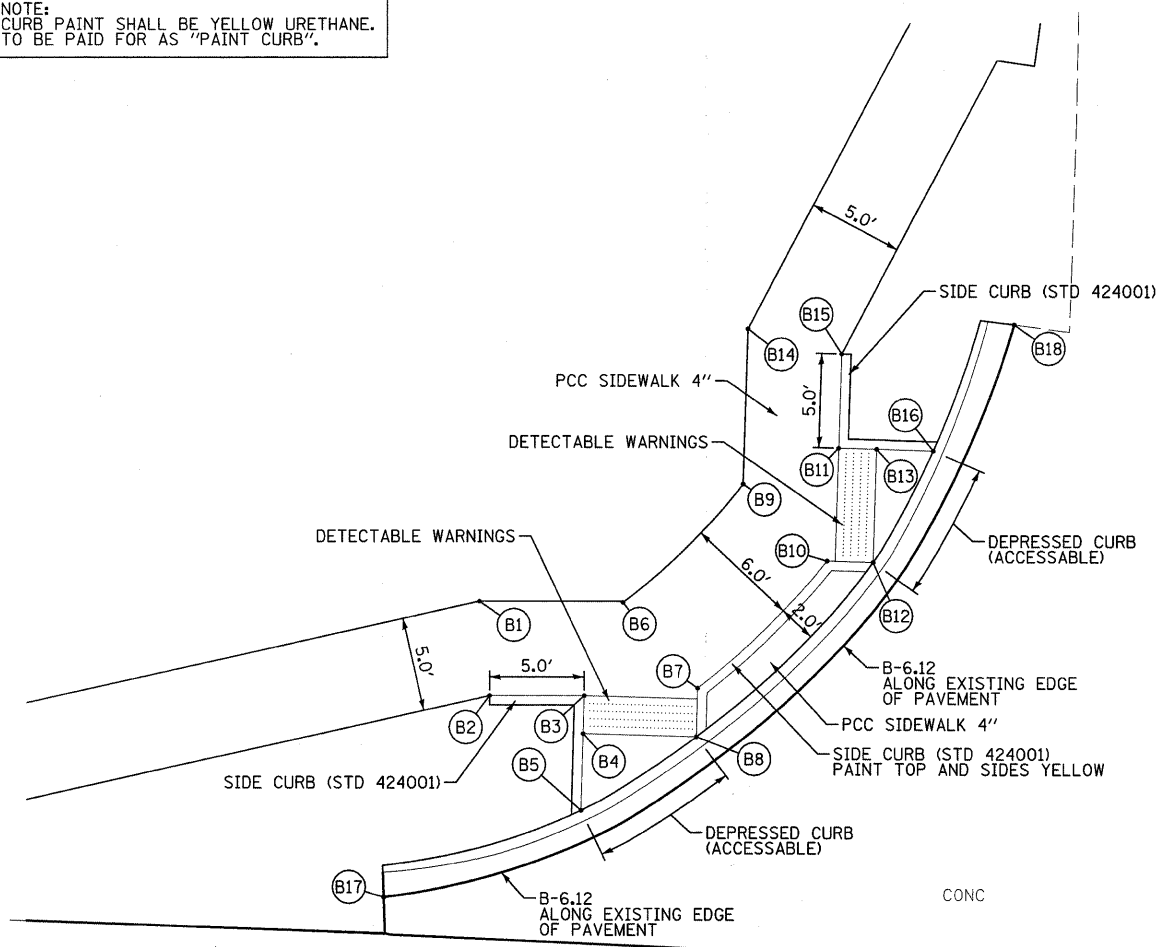

POINT	MAINE STREET			33RD STREET		
	STATION	OFFSET		STATION	OFFSET	ELEVATION
B1	109+49.33	37.34' LT		8+04.31	50.81' LT	663.23
B2	109+50.00	32.36' LT		7+99.32	50.12' LT	663.13
B3	109+55.00	32.48' LT		7+99.47	45.12' LT	662.71
B4	109+55.00	30.48' LT		7+97.47	45.11' LT	662.62
B5	109+55.00	26.43' LT		7+93.42	45.10' LT	662.45
B6	109+57.00	37.54' LT		8+04.53	43.13' LT	662.97
B7	109+61.00	33.05' LT		8+00.06	39.12' LT	662.85
B8	109+61.00	30.48' LT		7+97.49	39.11' LT	662.64
B9	109+63.13	43.93' LT		8+10.94	37.03' LT	663.20
B10	109+67.67	39.97' LT		8+07.00	32.47' LT	663.08
B11	109+68.14	45.97' LT		8+13.00	32.03' LT	663.19
B12	109+70.11	39.96' LT		8+07.00	30.04' LT	662.88
B13	109+70.14	45.96' LT		8+13.00	30.03' LT	663.10
B14	109+63.17	52.16' LT		8+19.18	37.02' LT	663.71
B15	109+68.16	50.97' LT		8+18.00	32.02' LT	663.61
B16	109+73.15	45.95' LT		8+13.00	27.02' LT	662.97
B17	109+44.68	21.54' LT		7+88.49	55.40' LT	662.15*
B18	109+77.25	52.75' LT		8+19.82	22.94' LT	663.10*

\* - MATCH EXISTING ELEVATION

POINT	MAINE STREET			33RD STREET		
	STATION	OFFSET		STATION	OFFSET	ELEVATION
A1	110+29.30	45.78' LT		8+13.00	29.20' RT	663.49
A2	110+32.78	45.77' LT		8+13.00	32.68' RT	663.66
A3	110+32.77	39.77' LT		8+07.00	32.68' RT	663.78
A4	110+34.80	54.51' LT		8+21.74	34.68' RT	664.32
A5	110+34.80	50.77' LT		8+18.00	34.68' RT	664.25
A6	110+34.78	45.77' LT		8+13.00	34.68' RT	663.83
A7	110+35.25	39.77' LT		8+07.00	35.16' RT	664.01
A8	110+39.81	55.76' LT		8+23.00	39.68' RT	664.42
A9	110+39.78	43.73' LT		8+10.97	39.68' RT	664.25
A10	110+39.50	34.92' LT		8+02.16	39.42' RT	664.47
A11	110+39.50	32.16' LT		7+99.40	39.43' RT	664.24
A12	110+43.74	39.16' LT		8+06.41	43.65' RT	664.71
A13	110+45.50	34.16' LT		8+01.41	45.42' RT	664.53
A14	110+45.50	32.16' LT		7+99.41	45.43' RT	664.36
A15	110+45.50	27.90' LT		7+95.16	45.44' RT	664.60
A16	110+50.50	34.16' LT		8+01.42	50.42' RT	664.95
A17	110+50.99	39.16' LT		8+06.43	50.90' RT	665.05
A18	110+26.34	49.30' LT		8+16.51	26.23' RT	663.37*
A19	110+55.69	21.94' LT		7+89.22	55.64' RT	665.09*

\* - MATCH EXISTING ELEVATION

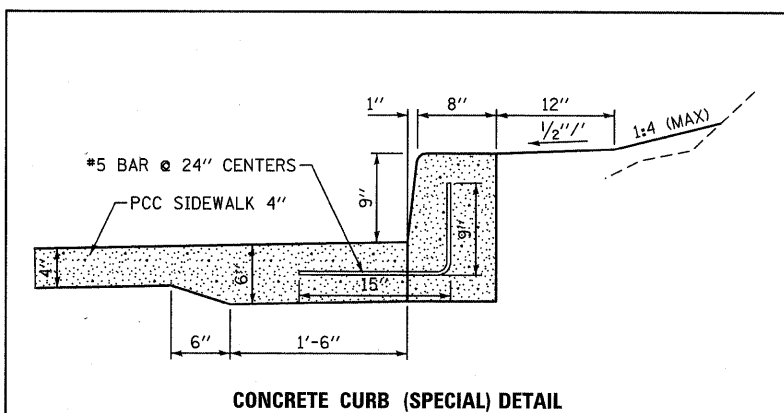

NOTE:  
COST OF ADDITIONAL SIDEWALK THICKNESS SHALL BE INCLUDED IN THE PAY ITEM FOR "PORTLAND CEMENT CONCRETE SIDEWALK 4 INCH".  
COST OF REINFORCEMENT BARS SHALL BE INCLUDED IN THE PAY ITEM FOR "CONCRETE CURB (SPECIAL)".