

GENERAL NOTES:

THE FOLLOWING TRAFFIC SIGNAL & LIGHTING EQUIPMENT ONCE REMOVED SHALL REMAIN THE PROPERTY OF THE CITY OF QUINCY AND STOCKPILED BY THE CONTRACTOR AT THE CITY HALL ANNEX, 706 MAINE STREET QUINCY.

REMOVAL OF EXISTING TRAFFIC SIGNAL EQUIPMENT:

- 2 TRAFFIC SIGNAL POST, 10' WITH SIGNAL HEADS
- 1 STEEL MAST ARM ASSEMBLY & POLE (20') WITH SIGNAL HEADS
- 1 STEEL MAST ARM ASSEMBLY & POLE (25') WITH SIGNAL HEADS
- 1 STEEL MAST ARM ASSEMBLY & POLE (30') WITH SIGNAL HEADS
- 1 POST MOUNTED CONTROLLER

REMOVAL OF EXISTING LIGHTING UNIT, SALVAGE:

- 1 LIGHT POLE, STEEL (40')

EXISTING HANDHOLES AND FOUNDATIONS SHALL BE REMOVED IN ACCORDANCE WITH THE STANDARD SPECIFICATIONS AND DISPOSED OF OFF SITE. ITEMS TO REMAIN IN PLACE AND REUSED ARE NOTED IN THE PLANS.

EXISTING CONDUIT AND WIRE THAT IS NOT IN CONFLICT WITH THE PROPOSED IMPROVEMENTS MAY BE ABANDONED UNLESS NOTED OTHERWISE. REMOVAL OF THE EXISTING CONDUIT AND/OR WIRE FROM THE ABANDONED CONDUIT WILL NOT BE PAID FOR SEPARATELY, BUT WILL BE INCLUDED IN THE COST OF THE VARIOUS REMOVAL ITEMS.

THE COST OF CONDUIT SPLICES SHALL BE INCLUDED IN THE UNIT PRICE FOR CONDUIT OF THE SIZE SPECIFIED.

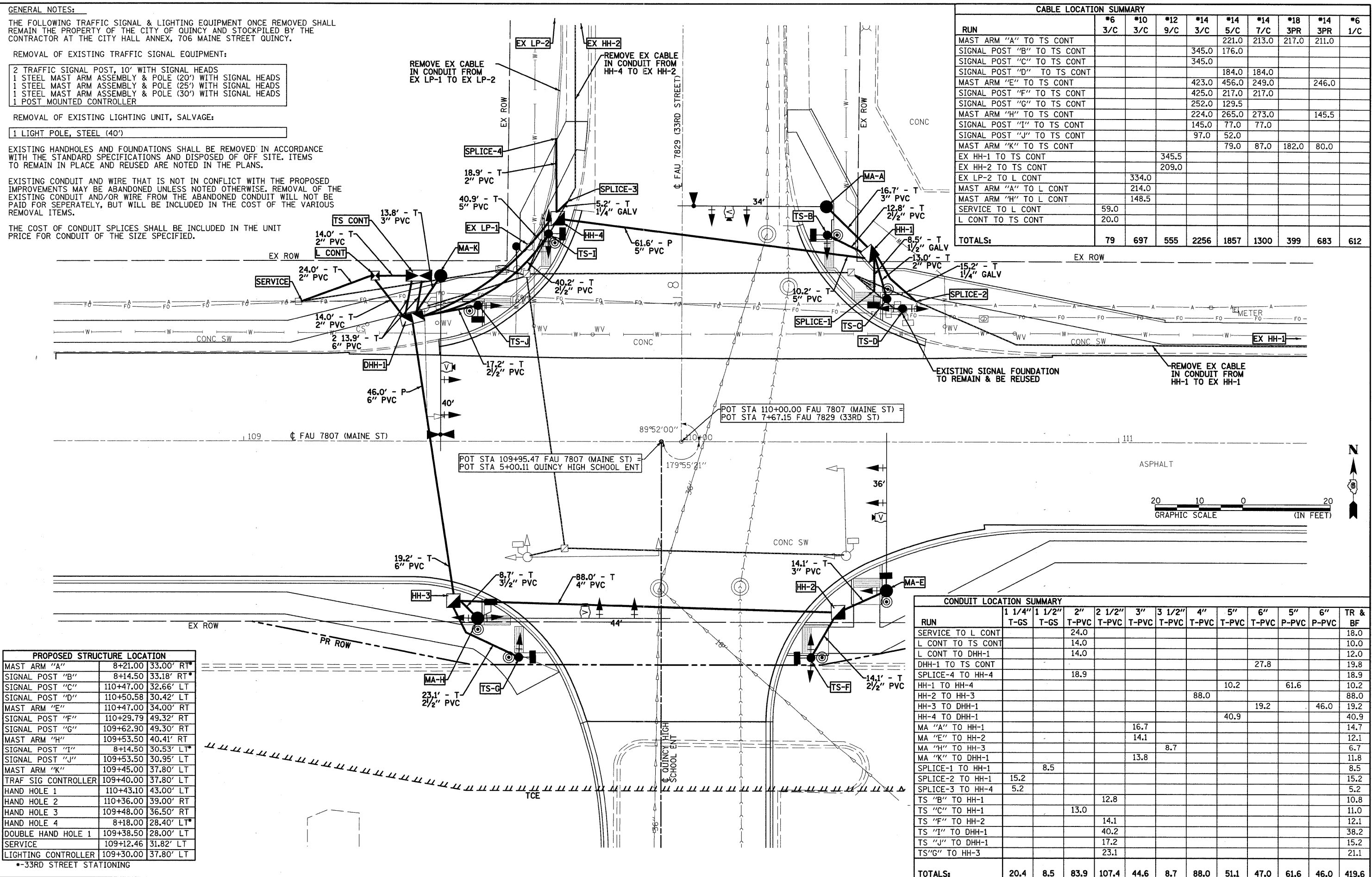

RUN	#6 3/C	#10 3/C	#12 9/C	#14 3/C	#14 5/C	#14 7/C	#18 3PR	#14 3PR	#6 1/C
MAST ARM "A" TO TS CONT				345.0	176.0	213.0	217.0	211.0	
SIGNAL POST "B" TO TS CONT				345.0					
SIGNAL POST "C" TO TS CONT					184.0	184.0			
SIGNAL POST "D" TO TS CONT					423.0	456.0	249.0	246.0	
MAST ARM "E" TO TS CONT				425.0	217.0	217.0			
SIGNAL POST "F" TO TS CONT				252.0	129.5				
SIGNAL POST "G" TO TS CONT				224.0	265.0	273.0		145.5	
MAST ARM "H" TO TS CONT				145.0	77.0	77.0			
SIGNAL POST "I" TO TS CONT				97.0	52.0				
SIGNAL POST "J" TO TS CONT									
MAST ARM "K" TO TS CONT					79.0	87.0	182.0	80.0	
EX HH-1 TO TS CONT			345.5						
EX HH-2 TO TS CONT			209.0						
EX LP-2 TO L CONT			334.0						
MAST ARM "A" TO L CONT			214.0						
MAST ARM "H" TO L CONT			148.5						
SERVICE TO L CONT	59.0								
L CONT TO TS CONT	20.0								
TOTALS:	79	697	555	2256	1857	1300	399	683	612

STRUCTURE	STATIONING	LOCATION
MAST ARM "A"	8+21.00	33.00' RT*
SIGNAL POST "B"	8+14.50	33.18' RT*
SIGNAL POST "C"	110+47.00	32.66' LT
SIGNAL POST "D"	110+50.58	30.42' LT
MAST ARM "E"	110+47.00	34.00' RT
SIGNAL POST "F"	110+29.79	49.32' RT
SIGNAL POST "G"	109+62.90	49.30' RT
MAST ARM "H"	109+53.50	40.41' RT
SIGNAL POST "I"	8+14.50	30.53' LT*
SIGNAL POST "J"	109+53.50	30.95' LT
MAST ARM "K"	109+45.00	37.80' LT
TRAF SIG CONTROLLER	109+40.00	37.80' LT
HAND HOLE 1	110+43.10	43.00' LT
HAND HOLE 2	110+36.00	39.00' RT
HAND HOLE 3	109+48.00	36.50' RT
HAND HOLE 4	8+18.00	28.40' LT*
DOUBLE HAND HOLE 1	109+38.50	28.00' LT
SERVICE	109+12.46	31.82' LT
LIGHTING CONTROLLER	109+30.00	37.80' LT

RUN	1 1/4" T-GS	1 1/2" T-GS	2" T-PVC	2 1/2" T-PVC	3" T-PVC	3 1/2" T-PVC	4" T-PVC	5" T-PVC	6" T-PVC	5" P-PVC	6" P-PVC	TR & BF
SERVICE TO L CONT			24.0									18.0
L CONT TO TS CONT			14.0									10.0
L CONT TO DHH-1			14.0									12.0
DHH-1 TO TS CONT								27.8				19.8
SPLICE-4 TO HH-4			18.9									18.9
HH-1 TO HH-4								10.2		61.6		10.2
HH-2 TO HH-3						88.0						88.0
HH-3 TO DHH-1								19.2		46.0		19.2
HH-4 TO DHH-1							40.9					40.9
MA "A" TO HH-1					16.7							14.7
MA "E" TO HH-2					14.1							12.1
MA "H" TO HH-3						8.7						6.7
MA "K" TO DHH-1					13.8							11.8
SPLICE-1 TO HH-1			8.5									8.5
SPLICE-2 TO HH-1			15.2									15.2
SPLICE-3 TO HH-4			5.2									5.2
TS "B" TO HH-1					12.8							10.8
TS "C" TO HH-1					13.0							11.0
TS "F" TO HH-2					14.1							12.1
TS "I" TO DHH-1					40.2							38.2
TS "J" TO DHH-1					17.2							15.2
TS "G" TO HH-3					23.1							21.1
TOTALS:	20.4	8.5	83.9	107.4	44.6	8.7	88.0	51.1	47.0	61.6	46.0	419.6