

STATE OF ILLINOIS  
DEPARTMENT OF TRANSPORTATION

F.A. RTE.	SECTION	COUNTY	TOTAL SHEETS	SHEET NO.
	D 1 REFLECTOR REPL 23-14	WILL	5	1
		ILLINOIS	CONTRACT NO. 46604	

INDEX OF SHEETS

1. COVER SHEET
2. GENERAL NOTES & STATE STANDARDS
3. SUMMARY OF QUANTITIES
4. RAISED REFLECTIVE PAVEMENT MARKER REPLACEMENT LOCATIONS 1
5. RAISED REFLECTIVE PAVEMENT MARKER REPLACEMENT LOCATIONS 2

PROPOSED  
HIGHWAY PLANS

VARIOUS ROUTES  
D 1 REFLECTOR REPL 23-14  
RAISED REFLECTOR REPLACEMENT  
WILL COUNTY

M-60-014-23

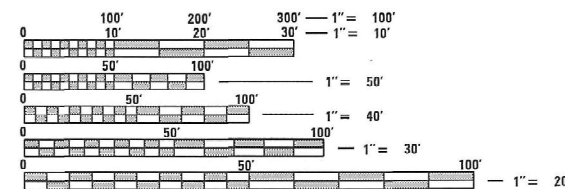
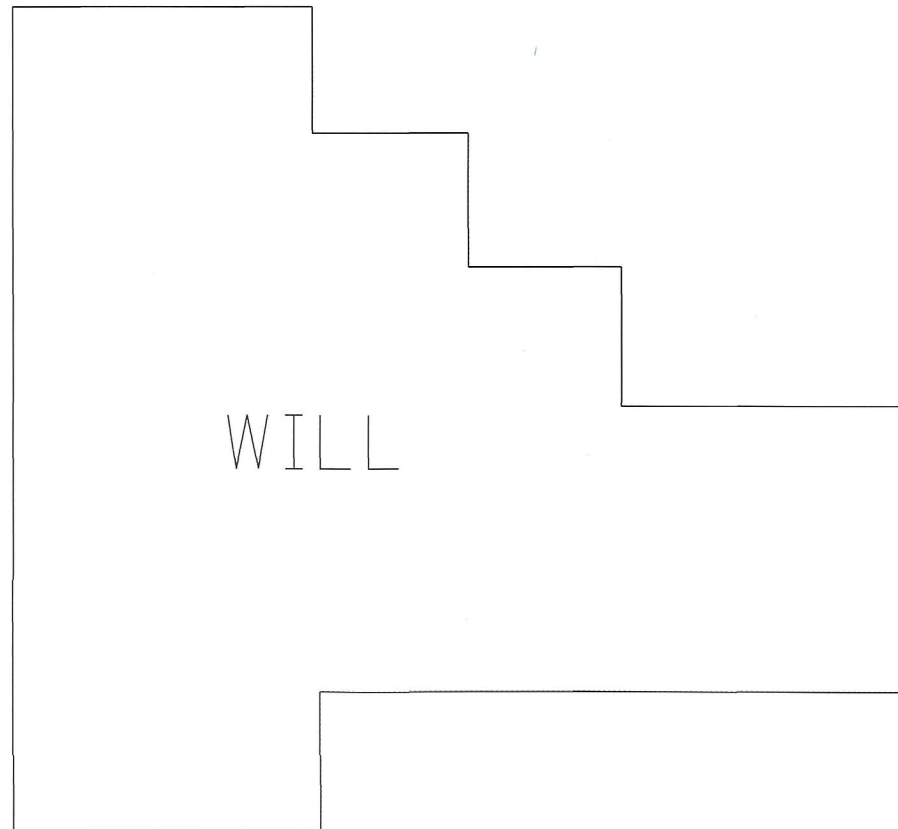
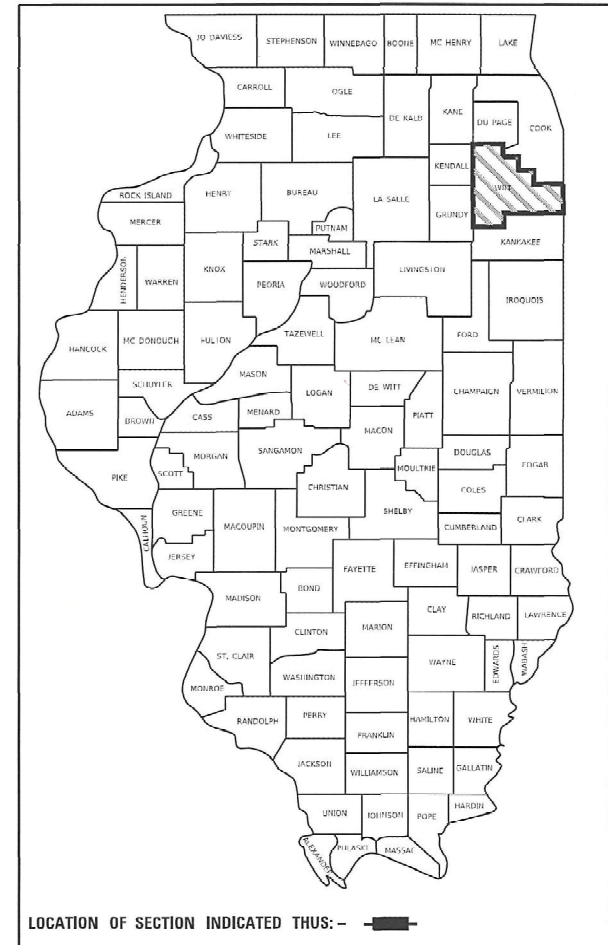

FULL SIZE PLANS HAVE BEEN PREPARED USING STANDARD ENGINEERING SCALES. REDUCED SIZED PLANS WILL NOT CONFORM TO STANDARD SCALES. IN MAKING MEASUREMENTS ON REDUCED PLANS, THE ABOVE SCALES MAY BE USED.

J.U.L.I.E.  
JOINT UTILITY LOCATION INFORMATION FOR EXCAVATORS  
1-800-892-0123  
OR 811

CONTRACT NO. 46604

STATE OF ILLINOIS  
DEPARTMENT OF TRANSPORTATION

SUBMITTED May 5, 2022  
Jose Rios REGIONAL ENGINEER

August 19, 2022  
[Signature]  
ENGINEER OF DESIGN AND ENVIRONMENT

August 19, 2022  
[Signature]  
DIRECTOR OF HIGHWAYS PROJECT IMPLEMENTATION

PRINTED BY THE AUTHORITY  
OF THE STATE OF ILLINOIS

## GENERAL NOTES

The Department may remove and not install markers in certain locations at the engineer's discretion.

The Department may install markers in certain locations that did previously have markers at the engineer's discretion.

The locations of the repair areas shall be determined by the engineer.

No material should be left on or near the roadway.

Removal of damaged materials will include loading, hauling and disposal.

## STATE STANDARDS

- 701301-04 LANE CLOSURE, 2L, 2W, SHORT TIME OPERATIONS
- 701311-03 LANE CLOSURE 2L, 2 W MOVING OPERATIONS-DAY ONLY
- 701426-09 LANE CLOSURE, MULTILANE, INTERMITTENT OR MOVING OPER., FOR SPEED  $\geq$  45 MPH
- 701427-05 LANE CLOSURE, MULTILANE, INTERMITTENT OR MOVING OPER., FOR SPEED  $\leq$  45 MPH
- 701901-08 TRAFFIC CONTROL DEVICES

MODEL: Default  
FILE NAME: S:\S\Contract\SCAD\CoverSheets for Contracts.dgn

USER NAME = GONZALEZDJR PLOT SCALE = 102.5029' / in. PLOT DATE = 5/2/2022	DESIGNED - DRAWN - CHECKED - DATE -	REVISED - REVISED - REVISED - REVISED -	<b>STATE OF ILLINOIS DEPARTMENT OF TRANSPORTATION</b>	<b>GENERAL NOTES &amp; STATE STANDARD</b>	<table border="1" style="width: 100%; border-collapse: collapse;"> <tr> <th style="font-size: small;">F.A. RTE.</th> <th style="font-size: small;">SECTION</th> <th style="font-size: small;">COUNTY</th> <th style="font-size: small;">TOTAL SHEETS</th> <th style="font-size: small;">SHEET NO.</th> </tr> <tr> <td></td> <td>D1 REFLECTOR REPL 23-14</td> <td>WILL</td> <td>5</td> <td>2</td> </tr> <tr> <td colspan="5" style="text-align: center; font-size: x-small;">CONTRACT NO. 46604</td> </tr> <tr> <td colspan="5" style="text-align: center; font-size: x-small;">ILLINOIS FED. AID PROJECT</td> </tr> </table>	F.A. RTE.	SECTION	COUNTY	TOTAL SHEETS	SHEET NO.		D1 REFLECTOR REPL 23-14	WILL	5	2	CONTRACT NO. 46604					ILLINOIS FED. AID PROJECT				
F.A. RTE.	SECTION	COUNTY	TOTAL SHEETS	SHEET NO.																					
	D1 REFLECTOR REPL 23-14	WILL	5	2																					
CONTRACT NO. 46604																									
ILLINOIS FED. AID PROJECT																									
			SCALE:	SHEET 2 OF 4 SHEETS	STA. TO STA.																				

CODE NO.	ITEM	UNIT	100% STATE URBAN 0021 QUANTITY
78100100	RAISED REFLECTIVE PAVEMENT MARKER	EACH	21,688
78100300	REPLACEMENT REFLECTOR	EACH	72,293
78300200	RAISED REFLECTIVE PAVEMENT MARKER REMOVAL	EACH	21,688

MODEL: Default  
 FILE NAME: S:\ISS\Contracts\CAD\CoverSheets for Contracts.dgn

USER NAME = GONZALEZDJR	DESIGNED -	REVISED -
	DRAWN -	REVISED -
PLOT SCALE = 103.7842" / in.	CHECKED -	REVISED -
PLOT DATE = 4/11/2022	DATE -	REVISED -

**STATE OF ILLINOIS**  
**DEPARTMENT OF TRANSPORTATION**

**SUMMARY OF QUANTITIES**

SCALE: SHEET 3 OF 5 SHEETS STA. TO STA.

F.A. RTE.	SECTION	COUNTY	TOTAL SHEETS	SHEET NO.
	D1 REFLECTOR REPL 23-14	WILL	5	3
			CONTRACT NO. 46604	
ILLINOIS FED. AID PROJECT				

DISTRICT 1 RAISED REFLECTIVE PAVEMENT MARKERS REPLACEMENT LIST

ROUTE	FROM (WEST/SOUTH LIMIT)	TO (EAST/NORTH LIMIT)	TOTAL	Y/Y	Y/O	W/O
IL-1	Kankakee County Line	Cook County Line	3,623	2,023	509	1,091
IL-7	Larkin	IL-53	573	367	70	136
IL-59	143rd St	DuPage County Line	1,473	0	6	1,467
IL-102	Kankakee County Line	IL-53	1,146	901	224	21
IL-113	Kankakee County Line	Coal City Rd	1,537	1,253	258	26
IL-126	Kendall County Line	I-55	975	627	186	162
US-6	US-30	Cook County Line	1,770	877	445	448
US-30	IL-59	Joliet City Limits	3,064	1,157	312	1,595
US-30	Kendall County Line	IL-59	1,440	750	490	200
Chicago Rd	IL-102	3.6 miles N/O IL-102	354	318	36	0
Manhattan-Monee Rd	US-52	Center Rd	807	592	211	4
IL-59	I-55	143rd St	3,230	361	328	2,541
IL-7	IL-53	Cook County Line	2,336	1,229	430	677
IL-53	Ruby St	DuPage County Line	6,190	1,730	538	3,922
IL-129	Grundy County Line	I-55	721	595	95	31
US-6	Grundy County Line	US-52	4,504	1,308	783	2,413
Blodgett Rd	Kelly	A/A Seam 420' E/O Train Trucks	171	151	20	0
Coal City Rd	Grundy County Line	IL-53	615	538	38	39
Division	Honor Farm (Prison Ent)	IL-53	130	101	29	0
New Ave	IL-171	Cook County Line	539	397	113	29
Richards	US-52	5th St	197	53	8	136
Washington St	Briggs Rd	US-30	199	152	24	23
Arsenal Rd	SE Frontage Rd	Elwood Intl Port Rd/Baseline Rd	1,841	192	611	1,038
US-30	Joliet City Limits	Cook County Line	4,118	1,601	922	1,595
US-52	US-6	US-45	2,243	1,477	559	207
IL-7	US-6	IL-7/Theodore	1,814	444	195	1,175
IL-50	Kankakee County Line	Cook County Line	6,307	2,846	23	3,438
IL-53	Grundy County Line	I-80	5,612	1,240	346	4,026

MODEL: D:\p1\11\11\11\CoverSheets for Contracts.dgn  
FILE NAME: S:\S\Contract\CAD\CoverSheets for Contracts.dgn

USER NAME = GONZALEZDJR	DESIGNED -	REVISED -
PLOT SCALE = 1/4"=1' / 1/8"=1'	DRAWN -	REVISED -
PLOT DATE = 4/11/2022	CHECKED -	REVISED -
	DATE -	REVISED -

**STATE OF ILLINOIS  
DEPARTMENT OF TRANSPORTATION**

**RAISED REFLECTIVE PAVEMENT MARKER REPLACEMENT LOCATIONS 1**

SCALE: SHEET 4 OF 5 SHEETS STA. TO STA.

F.A. RTE.	SECTION	COUNTY	TOTAL SHEETS	SHEET NO.
	D1 REFLECTOR REPL 23-14	WILL	5	4
CONTRACT NO. 46604				
ILLINOIS FED. AID PROJECT				

