

F.A.I. RTE.	SECTION	COUNTY	TOTAL SHEETS	SHEET NO.
94/90		COOK	556	50
STA.	TO STA.			
FED. ROAD DIST. NO.	ILLINOIS	FED. AID PROJECT		
62300	1818, ETC, 2324.6-1PR-8			

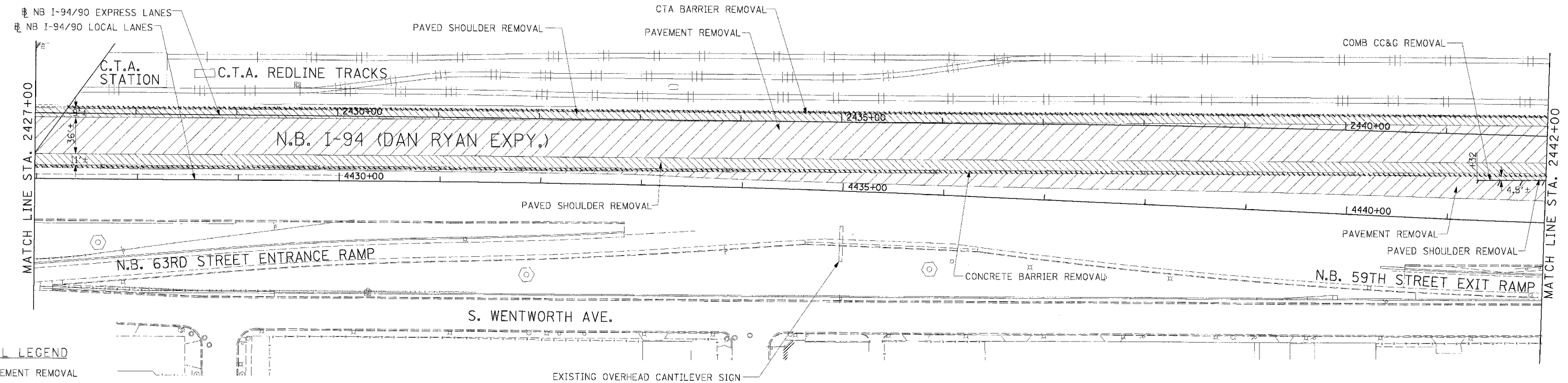

**REMOVAL LEGEND**

	PAVEMENT REMOVAL
	PAVED SHOULDER REMOVAL
	COMBINATION CURB AND GUTTER REMOVAL
	CONCRETE BARRIER OR GUARD RAIL REMOVAL

**NOTE:**  
1. THE LOCATION OF PAVEMENT CONSTRUCTED IN PREVIOUS CONTRACTS IS BASED OFF OF CONTRACT PLAN DRAWINGS. THE CONTRACTOR MUST VERIFY LIMITS OF PREVIOUS CONSTRUCTION IN THE FIELD.

**EXISTING CONDITIONS & REMOVALS**

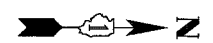
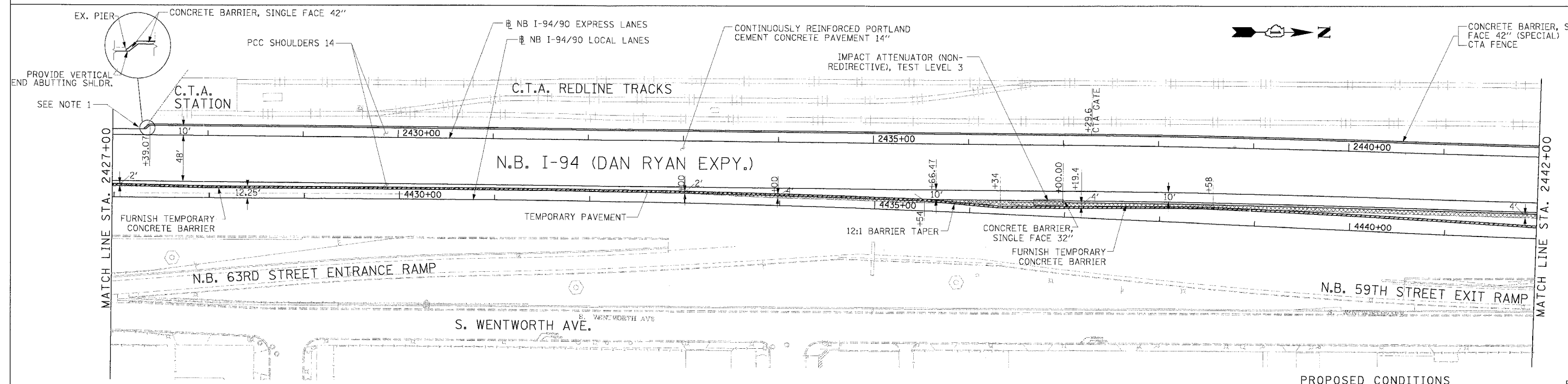

**NOTE:**  
1. BRIDGE OVER EXPRESS LANES OMITTED FOR CLARITY.

**LEGEND**

	TEMPORARY PAVEMENT (INTERSTATE)/TEMPORARY SHOULDER
	TEMPORARY CONCRETE BARRIER

**STATIONING**  
 +##.## STATION PROVIDED FROM THE NB I-90/94 EXPRESS LANES  
 (+##.##) STATION PROVIDED FROM THE NB I-90/94 LOCAL LANES  
 [+##.##] STATION PROVIDED FROM THE SLIP RAMP

REVISIONS	
NAME	DATE

ILLINOIS DEPARTMENT OF TRANSPORTATION  
 F.A.I. 94/90 (DAN RYAN EXPRESSWAY)  
 31ST STREET TO 71ST STREET  
 NB EXPRESS LANE RECONSTRUCTION  
 EXISTING AND PROPOSED PLAN  
 NORTHBOUND STA. 2427+00 TO STA. 2442+00  
 SCALE: 1"=50'  
 DATE: 7/7/05  
 DRAWN BY: TAI  
 CHECKED BY: PJM

**Edwards AND Kelcey**  
 ONE NORTH FRANKLIN  
 CHICAGO, IL 60606  
 PHONE: (312) 251-3000  
 FAX: (312) 251-3015  
 WEB: WWW.EKCORP.COM

06/24/2005 10:57:37 AM