

F.A.I. SECTION	COUNTY	TOTAL SHEET SHEETS, NO.
94/90	COOK	556 93
STA. TO STA.	ILLINOIS FED. AID PROJECT	
62300	1818, ETC, 2324.6-1PR-8	

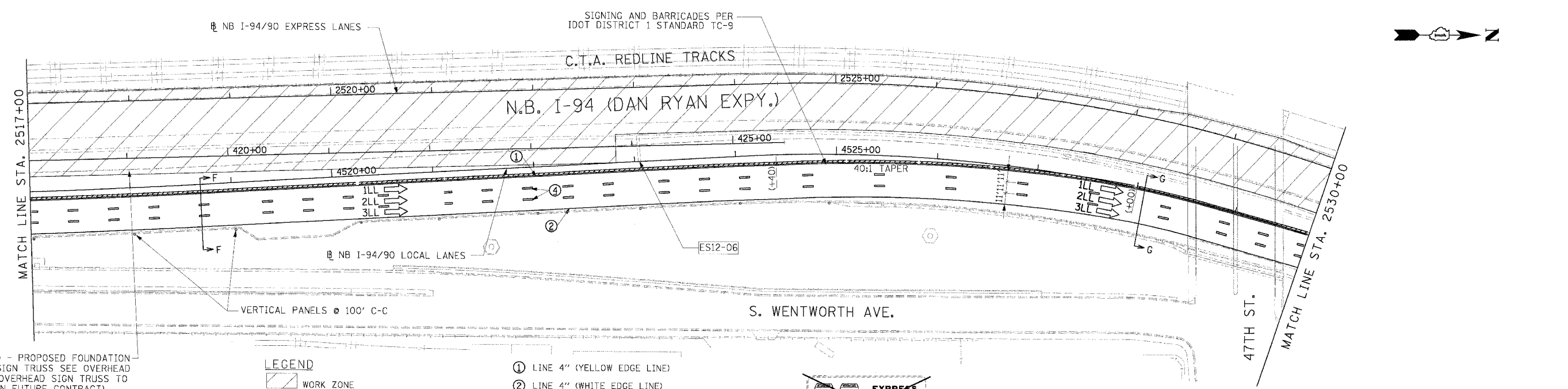
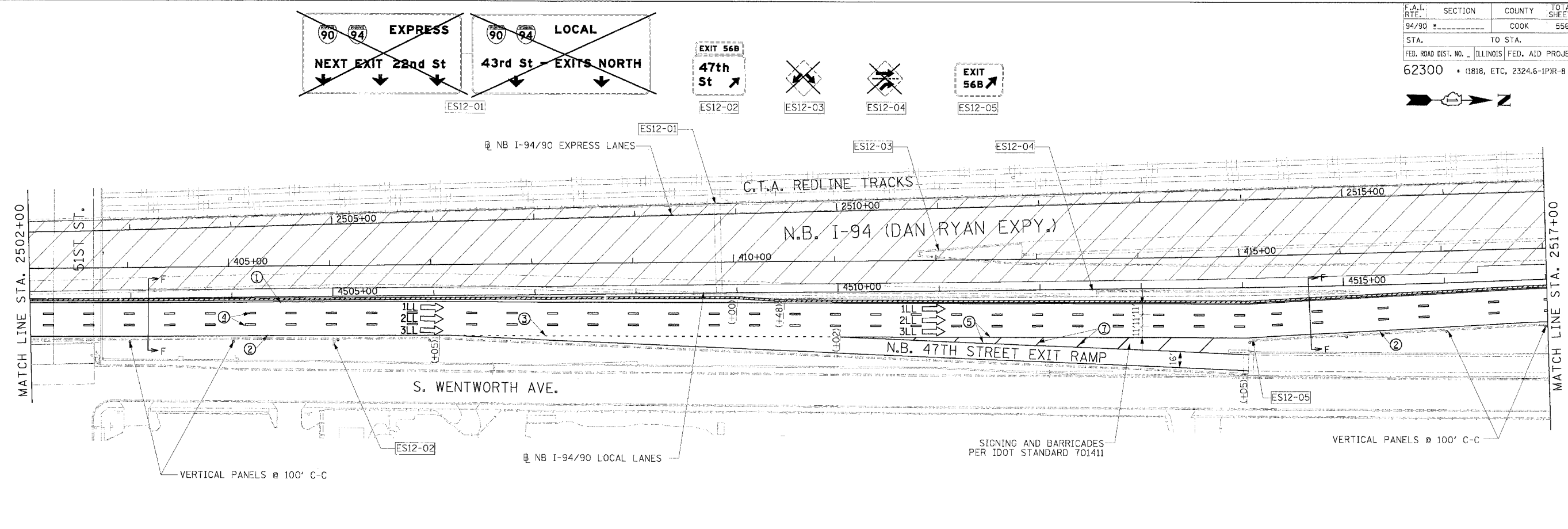

STA. 4518+40.00 - PROPOSED FOUNDATION FOR OVERHEAD SIGN TRUSS SEE OVERHEAD SIGN DETAILS (OVERHEAD SIGN TRUSS TO BE BUILT IN FUTURE CONTRACT)

**LEGEND**

- WORK ZONE
- TEMPORARY PAVEMENT
- TRAFFIC LANE & DIRECTION OF TRAFFIC
- DRUM OR BARRICADE TYPE II WITH STEADY BURN LIGHT
- IMPACT ATTENUATORS, TEMPORARY (NON-REDIRECTIVE), TEST LEVEL 3
- BARRICADE TYPE III
- TEMPORARY CONCRETE BARRIER
- EXISTING SIGN
- TEMPORARY SIGN

- ① LINE 4" (YELLOW EDGE LINE)
- ② LINE 4" (WHITE EDGE LINE)
- ③ LINE 4" (SKIP DASH, 6' SKIP - 2' DASH, WHITE)
- ④ LINE 5" (SKIP DASH, 30' SKIP - 10' DASH, WHITE)
- ⑤ LINE 8" (WHITE GORE LINE)
- ⑥ LINE 8" (SKIP DASH, 12' SKIP - 3' DASH, WHITE)
- ⑦ LINE 12" (DIAGONAL, 30' C-C)
- ⑧ LINE 12" (DIAGONAL, 500' C-C)
- ⑨ LETTERS AND SYMBOLS

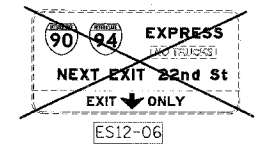

**STATIONING**  
 +\*\* STATION PROVIDED FROM THE NB I-90/94 EXPRESS LANES  
 (+\*\*) STATION PROVIDED FROM THE NB I-90/94 LOCAL LANES

**NOTE:**  
 ALL PAVEMENT MARKINGS ON THIS SHEET ARE PAVEMENT MARKING TAPE, TYPE III UNLESS OTHERWISE NOTED.

REVISIONS	
NAME	DATE

ILLINOIS DEPARTMENT OF TRANSPORTATION  
 F.A.I. 94/90 (DAN RYAN EXPRESSWAY)  
 31ST STREET TO 71ST STREET  
 NB EXPRESS LANE RECONSTRUCTION  
 MAINTENANCE OF TRAFFIC PLAN  
 NORTHBOUND STA. 2502+00 TO STA. 2530+00  
 STAGE 1  
 SCALE: 1"=50'  
 DATE: 7/7/05  
 DRAWN BY: TAI  
 CHECKED BY: PJM

**Edwards AND Kelcey**  
 ONE NORTH FRANKLIN  
 CHICAGO, IL 60606  
 PHONE: (312) 251-3000  
 FAX: (312) 251-3015  
 WEB: WWW.EDKORP.COM

ES-xx EXISTING SIGN  
 TS-xx TEMPORARY SIGN

MOT-13  
 06/24/2005 10:54:35 PM