

| | | | | |
|---------------------|----------------------------|------------------|--------------|-----------|
| F.A.I. | SECTION | COUNTY | TOTAL SHEETS | SHEET NO. |
| 94/90 * | | COOK | 556 | 103 |
| STA. | TO STA. | | | |
| FED. ROAD DIST. NO. | ILLINOIS | FED. AID PROJECT | | |
| 62300 | *(1818, ETC, 2324.6-1P1R-8 | | | |

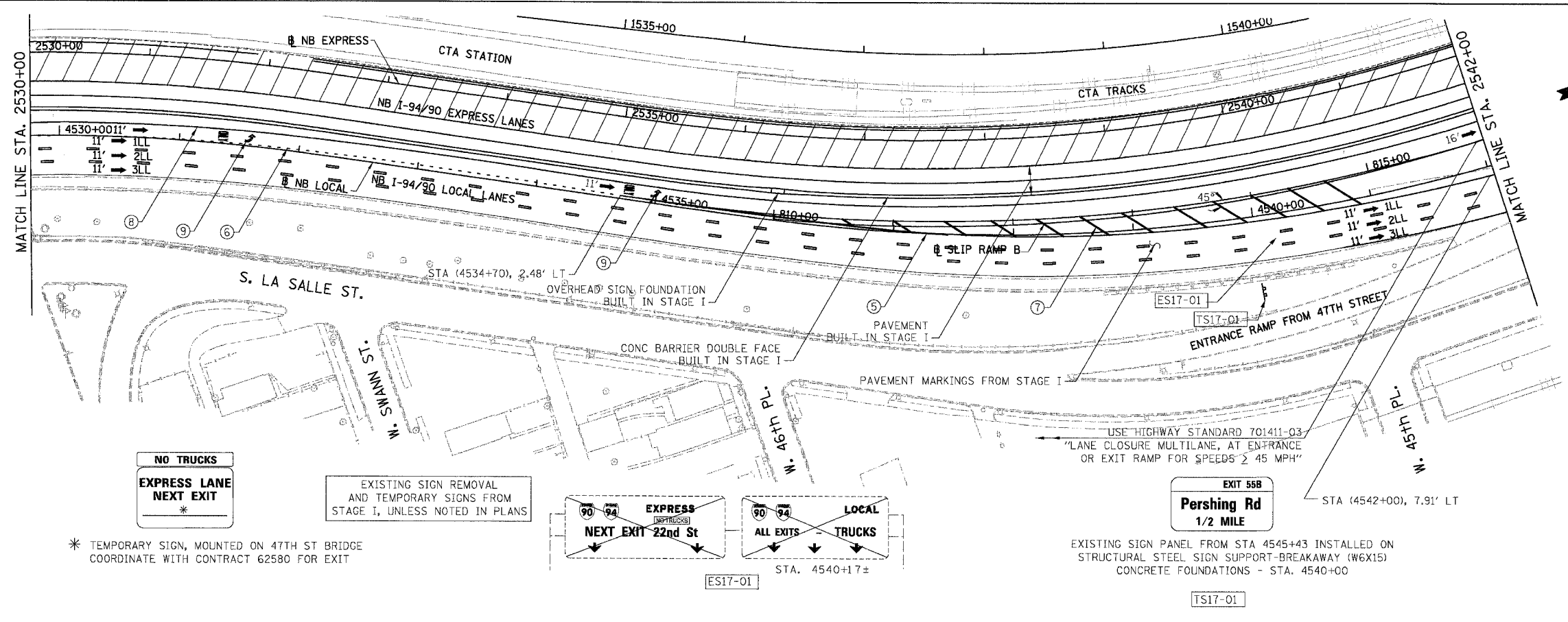

NO TRUCKS
EXPRESS LANE
NEXT EXIT
*

EXISTING SIGN REMOVAL
AND TEMPORARY SIGNS FROM
STAGE I, UNLESS NOTED IN PLANS

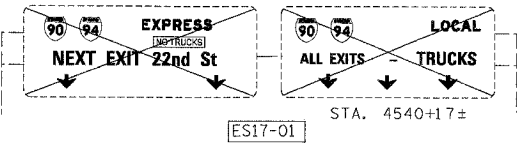

EXIT 55B
Pershing Rd
1/2 MILE

EXISTING SIGN PANEL FROM STA 4545+43 INSTALLED ON
STRUCTURAL STEEL SIGN SUPPORT-BREAKAWAY (W6X15)
CONCRETE FOUNDATIONS - STA. 4540+00

* TEMPORARY SIGN, MOUNTED ON 47TH ST BRIDGE
COORDINATE WITH CONTRACT 62580 FOR EXIT

- LEGEND**
- WORK ZONE
 - TEMPORARY PAVEMENT
 - ILL TRAFFIC LANE & DIRECTION OF TRAFFIC
 - DRUM OR BARRICADE TYPE II WITH STEADY BURN LIGHT
 - IMPACT ATTENUATORS, TEMPORARY (NON-REDIRECTIVE), TEST LEVEL 3
 - BARRICADE TYPE III
 - TEMPORARY CONCRETE BARRIER
 - ① LINE 4" (YELLOW EDGE LINE)
 - ② LINE 4" (WHITE EDGE LINE)
 - ③ LINE 4" (SKIP DASH, 6' SKIP - 2' DASH, WHITE)
 - ④ LINE 5" (SKIP DASH, 30' SKIP - 10' DASH, WHITE)
 - ⑤ LINE 8" (WHITE GORE LINE)
 - ⑥ LINE 8" (SKIP DASH, 12' SKIP - 3' DASH, WHITE)
 - ⑦ LINE 12" (DIAGONAL, 500' C-C)
 - ⑧ LINE 12" (DIAGONAL, 500' C-C)
 - ⑨ LETTERS AND SYMBOLS
 - ESx-xx EXISTING SIGNS
 - TSx-xx TEMPORARY SIGNS

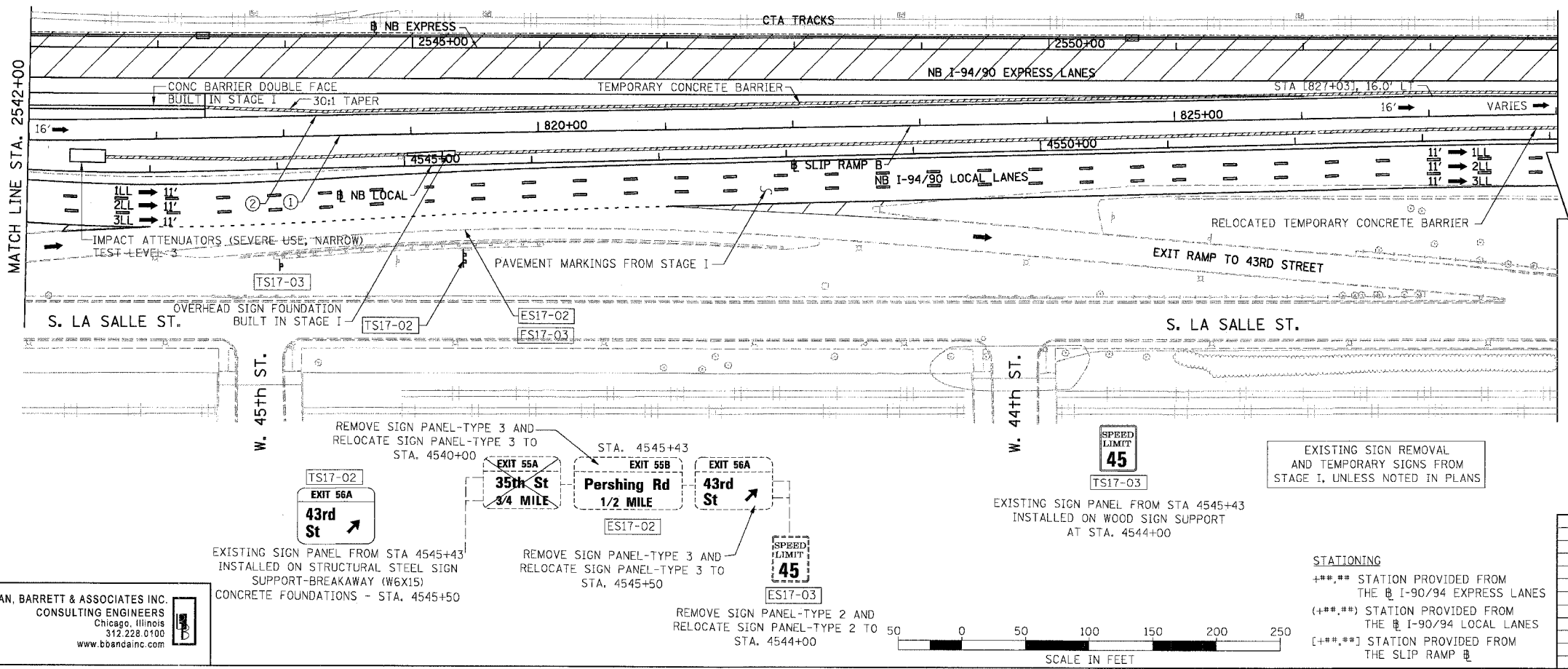

EXIT 56A
43rd St

EXISTING SIGN PANEL FROM STA 4545+43
INSTALLED ON STRUCTURAL STEEL SIGN
SUPPORT-BREAKAWAY (W6X15)
CONCRETE FOUNDATIONS - STA. 4545+50

EXIT 55A
35th St
3/4 MILE

REMOVE SIGN PANEL-TYPE 3 AND
RELOCATE SIGN PANEL-TYPE 3 TO
STA. 4540+00

EXIT 55B
Pershing Rd
1/2 MILE

REMOVE SIGN PANEL-TYPE 3 AND
RELOCATE SIGN PANEL-TYPE 3 TO
STA. 4545+50

EXIT 56A
43rd St

REMOVE SIGN PANEL-TYPE 2 AND
RELOCATE SIGN PANEL-TYPE 2 TO
STA. 4544+00

SPEED LIMIT
45

EXISTING SIGN PANEL FROM STA 4545+43
INSTALLED ON WOOD SIGN SUPPORT
AT STA. 4544+00

EXISTING SIGN REMOVAL
AND TEMPORARY SIGNS FROM
STAGE I, UNLESS NOTED IN PLANS

NOTE:
ALL PAVEMENT MARKINGS ON THIS SHEET WILL BE
PAVEMENT MARKING TAPE, TYPE III, UNLESS
OTHERWISE NOTED.

BOWMAN, BARRETT & ASSOCIATES INC.
CONSULTING ENGINEERS
Chicago, Illinois
312.228.0100
www.bbainc.com

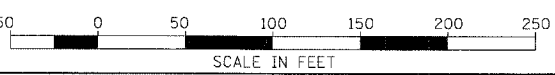

STATIONING
+**.** STATION PROVIDED FROM
THE I-90/94 EXPRESS LANES
(+**.** STATION PROVIDED FROM
THE I-90/94 LOCAL LANES
[+**.**] STATION PROVIDED FROM
THE SLIP RAMP

| REVISIONS | |
|-----------|------|
| NAME | DATE |
| | |
| | |
| | |
| | |
| | |

ILLINOIS DEPARTMENT OF TRANSPORTATION
F.A.I. 94/90 (DAN RYAN EXPRESSWAY)
31ST STREET TO 71ST STREET
NB EXPRESS LANE RECONSTRUCTION
MAINTENANCE OF TRAFFIC PLAN STAGE 2
NORTHBOUND STA. 2530+00 TO STA. 2554+00
SCALE: 1"=50'
DATE: 07/07/05
DRAWN BY: RA
CHECKED BY: RS

MOT-23 2/27/05 9:27:09 PM