

F.A.I. SECTION	COUNTY	TOTAL SHEETS	SHEET NO.
94/90	COOK	556	257
STA. TO STA.	FED. ROAD DIST. NO. ILLINOIS FED. AID PROJECT		
62300	• (1818, ETC, 2324.6-IPR-B		

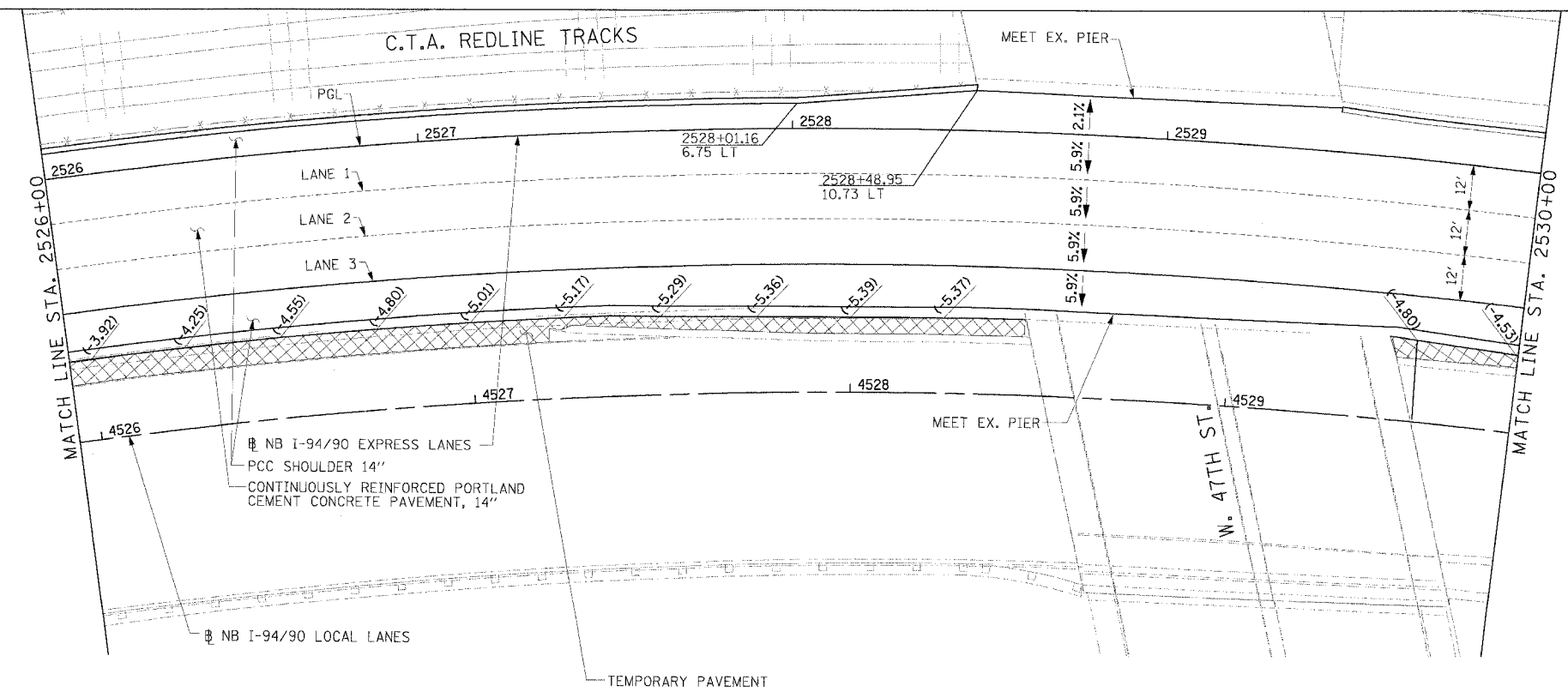
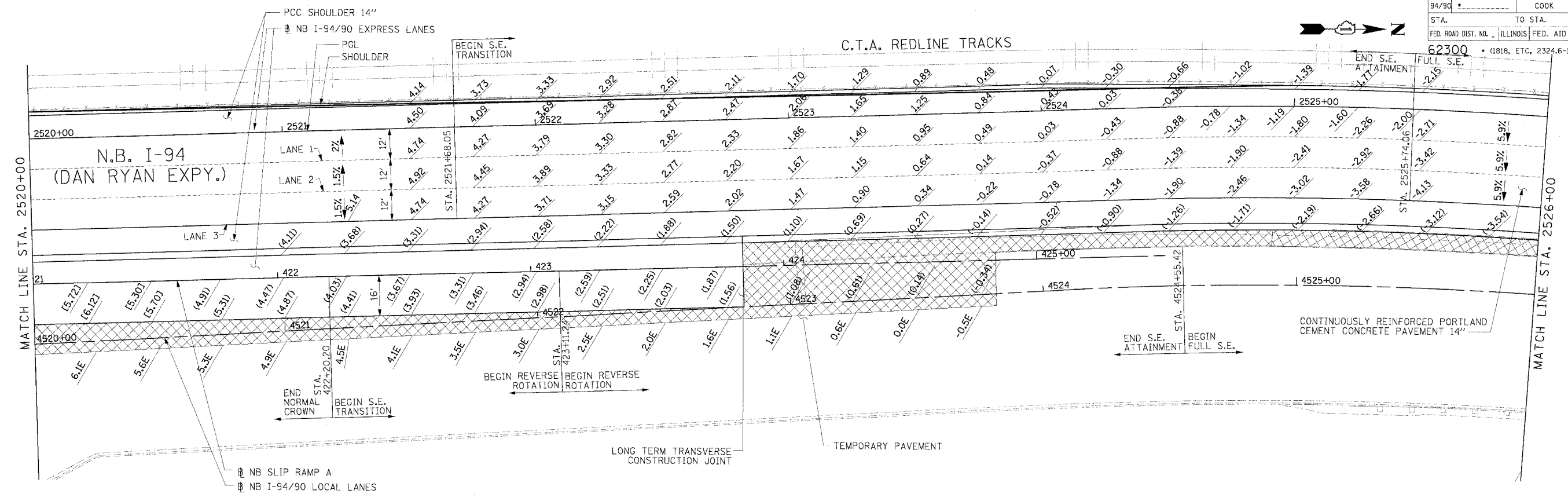

**LEGEND**

- ### ELEVATION STATIONED OFF OF SB I-94/90 EXPRESS LANES
- (###) ELEVATION STATIONED OFF OF SB I-94/90 LOCAL LANES
- [###] ELEVATION STATIONED OFF OF SLIP RAMP ALIGNMENT

**NOTE:**

1. PAVEMENT ELEVATIONS ALONG RAMPS, GORES AND IN AREAS OF SUPERELEVATION TRANSITION ARE PROVIDED AT 25' INTERVALS. FOR ALL OTHER ELEVATIONS, REFER TO PROFILE AND TYPICAL SECTIONS.

**Edwards AND Kelcey**  
 ONE NORTH FRANKLIN  
 CHICAGO, IL 60606  
 PHONE: (312) 251-3000  
 FAX: (312) 251-3015  
 WEB: WWW.EKCORP.COM

REVISIONS	
NAME	DATE

ILLINOIS DEPARTMENT OF TRANSPORTATION  
 F.A.I. 94/90 (DAN RYAN EXPRESSWAY)  
 31ST STREET TO 71ST STREET  
 NB EXPRESS LANE RECONSTRUCTION  
 PAVEMENT JOINTING AND ELEVATION PLAN  
 NORTHBOUND STA. 2520+00 TO STA. 2530+00  
 SCALE: 0' 10' 20' 30' 40'  
 DATE: 7/7/05  
 DRAWN BY: TAI  
 CHECKED BY: PJM

JT-14

06/24/2005 12:56:56 PM  
 P:\0300\9035\Con\4815\ADDV\48140425.dwg