

F.A.I. RTE.	SECTION	COUNTY	TOTAL SHEETS	SHEET NO.
94/90		COOK	556	47
STA.	TO STA.			
FED. ROAD DIST. NO.	ILLINOIS	FED. AID PROJECT		
62300	N918, ETC. 2324.6-1PR-8			

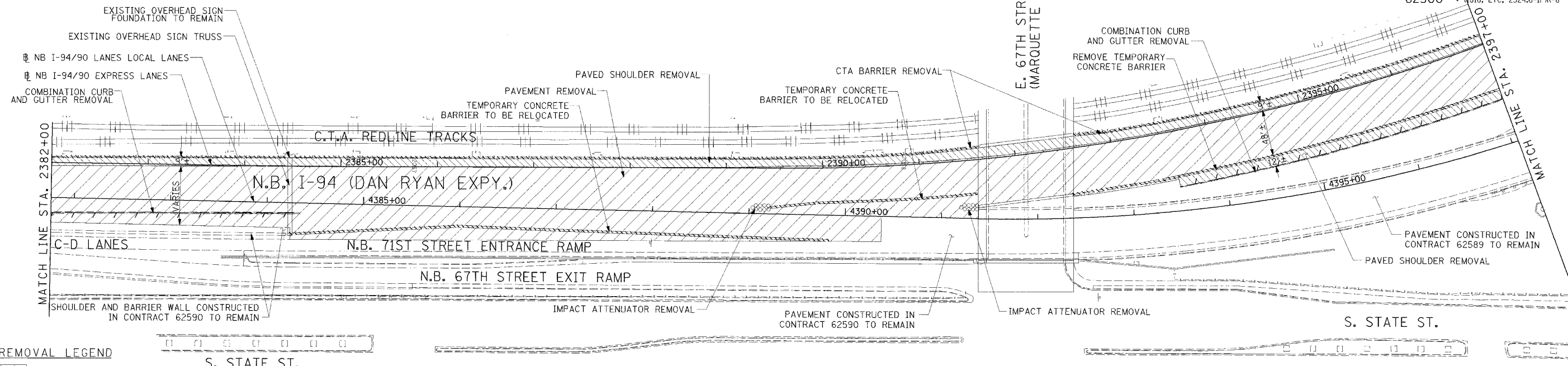

- REMOVAL LEGEND**
- PAVEMENT REMOVAL
 - PAVED SHOULDER REMOVAL
 - COMBINATION CURB AND GUTTER REMOVAL
 - CONCRETE BARRIER OR GUARD RAIL REMOVAL

NOTE:
 1. THE LOCATION OF PAVEMENT CONSTRUCTED IN PREVIOUS CONTRACTS IS BASED OFF OF CONTRACT PLAN DRAWINGS. THE CONTRACTOR MUST VERIFY LIMITS OF PREVIOUS CONSTRUCTION IN THE FIELD.

EXISTING CONDITIONS & REMOVALS

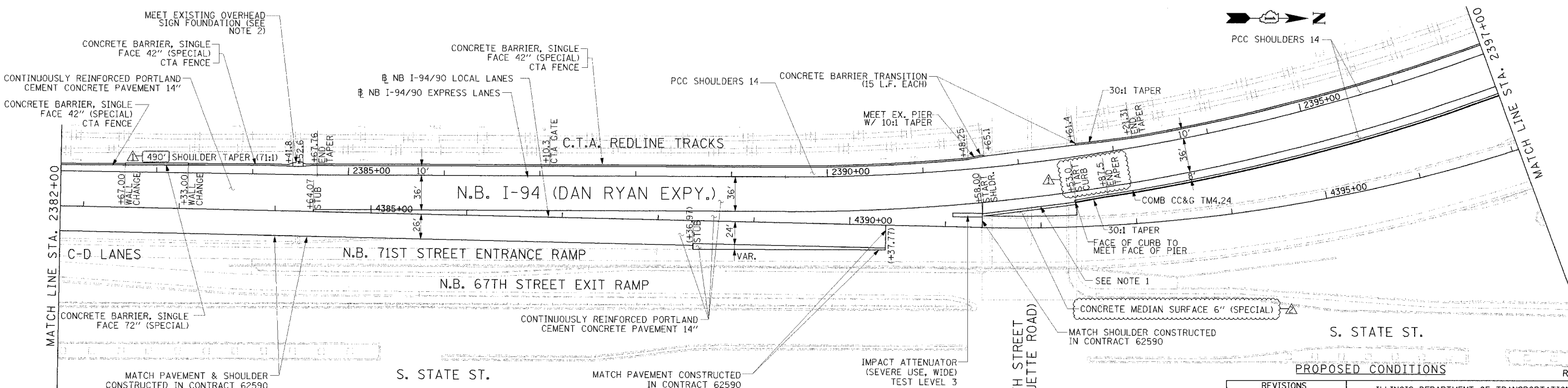

- NOTES:**
- BRIDGE OVER EXPRESS LANES OMITTED FOR CLARITY.
 - TAPER FACE OF BARRIER TOWARDS TRAFFIC AT A 30:1 RATE AND AWAY FROM TRAFFIC AT A 10:1 RATE TO MEET EXISTING FOUNDATION BARRIER FACE. ON THE C.T.A. SIDE, TAPER BACK OF WALL AT A 3:1 RATE TO MEET BACK OF FOUNDATION. WIDENING OF WALL IS PAID FOR AS CONCRETE BARRIER TRANSITION (9 LF).

- STATIONING**
- +++.** STATION PROVIDED FROM THE NB I-90/94 EXPRESS LANES
 - (+**.**) STATION PROVIDED FROM THE NB I-90/94 LOCAL LANES
 - [+**.**] STATION PROVIDED FROM THE SLIP RAMP

- LEGEND**
- TEMPORARY PAVEMENT (INTERSTATE)/TEMPORARY SHOULDER
 - TEMPORARY CONCRETE BARRIER

REVISIONS	
NAME	DATE
ADDENDUM 1	8/12/05
ADDENDUM 2	9/16/05

ILLINOIS DEPARTMENT OF TRANSPORTATION
 F.A.I. 94/90 (DAN RYAN EXPRESSWAY)
 31ST STREET TO 71ST STREET
 NB EXPRESS LANE RECONSTRUCTION
 EXISTING AND PROPOSED PLAN
 NORTHBOUND STA. 2382+00 TO STA. 2397+00

SCALE: 1"=50'
 DATE: 7/1/05

DRAWN BY: TAI
 CHECKED BY: PJM



A:\030019\035\Con 14815\CADD\14994\40022.dwg 09/14/2005 08:32:22 PM