

F.A.I.	SECTION	COUNTY	TOTAL SHEETS	SHEET NO.
94/90	*	COOK	556	83
STA.	TO STA.			
62300	*1818, ETC, 2324.6-1P1R-8			
FED. ROAD DIST. NO.	ILLINOIS	FED. AID PROJECT		

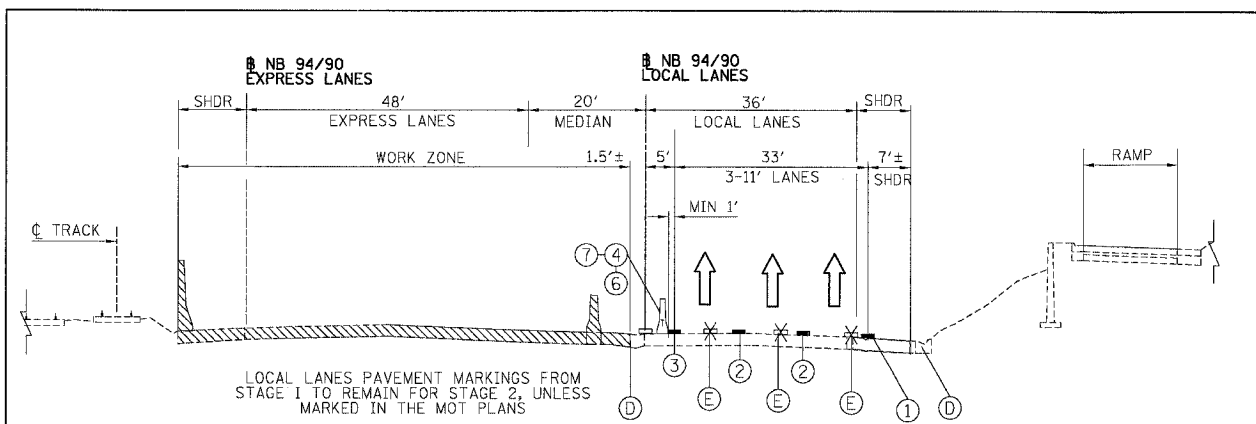

**SECTION - 43RD STREET TO 31ST STREET - STAGE 1**  
STAGE 1 - STA 2555+00 - 2537+99

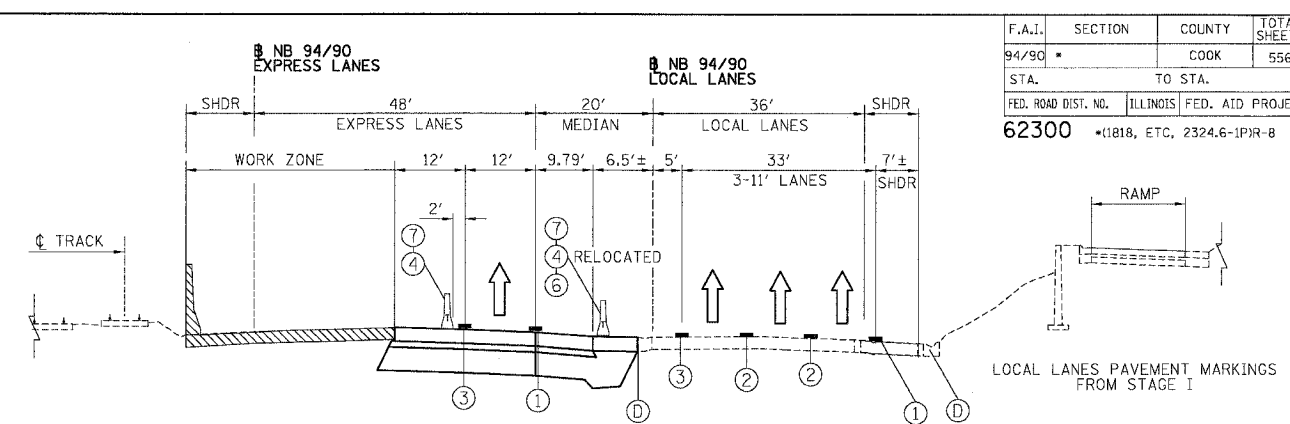

**SECTION - 43RD STREET TO 31ST STREET - STAGE 2**  
STAGE 1 - STA 2555+00 - 2537+99

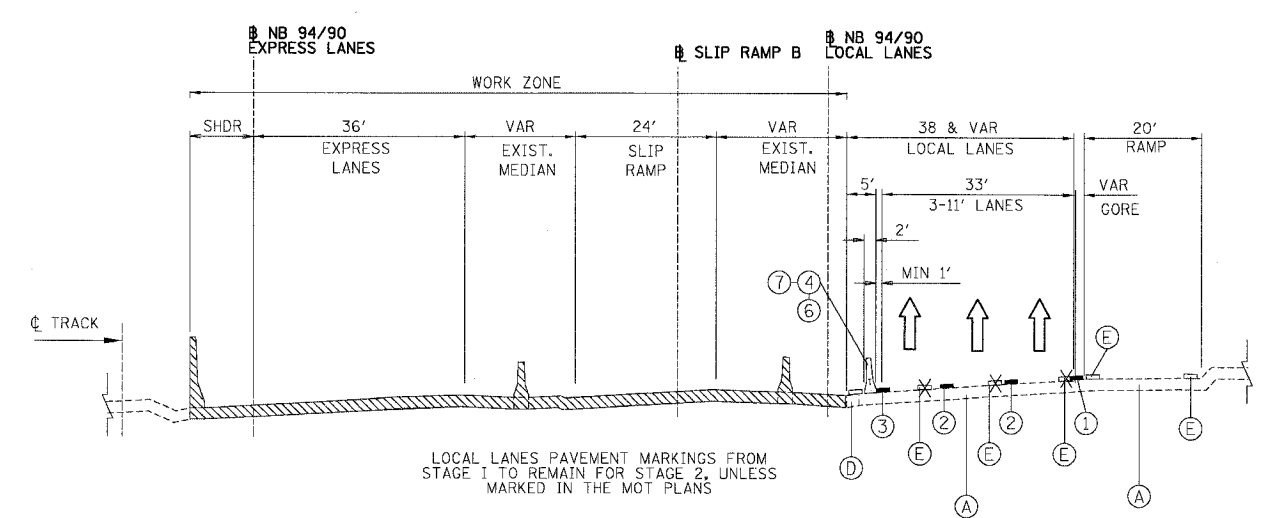

**SECTION - 47TH STREET TO 43RD STREET - STAGE 1**  
STAGE 1 - STA 2530+00 - 2555+00

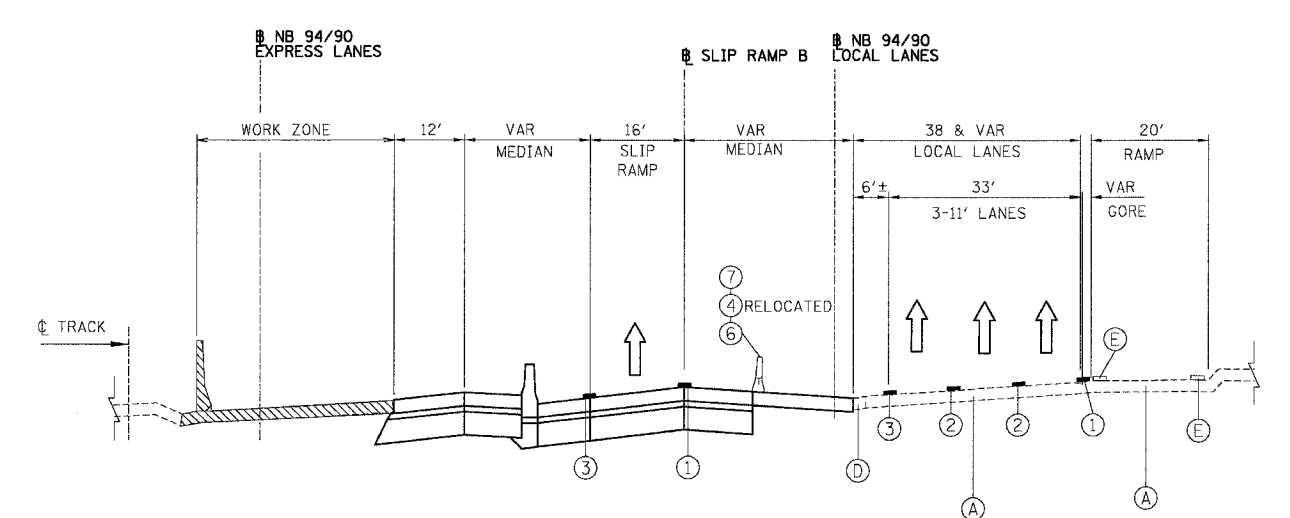

**SECTION - 47TH STREET TO 43RD STREET - STAGE 2**  
STAGE 1 - STA 2530+00 - 2555+00

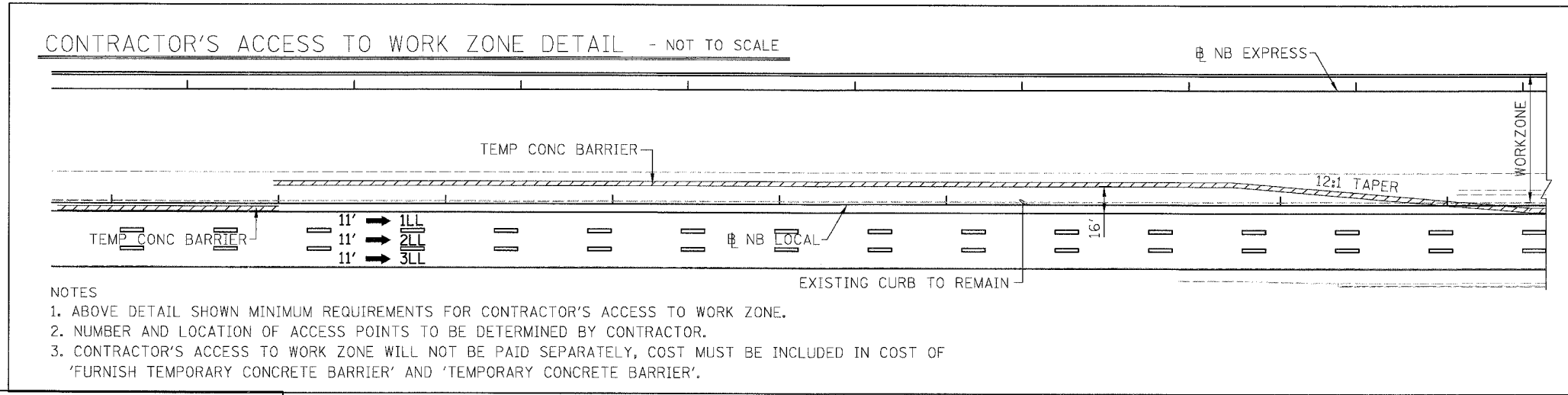

- PROPOSED LEGEND**
- ① PAVEMENT MARKING - LINE 4" (WHITE)
  - ② PAVEMENT MARKING - LINE 5" (WHITE, SKIP DASH)
  - ③ PAVEMENT MARKING - LINE 4" (YELLOW)
  - ④ TEMPORARY CONCRETE BARRIER
  - ⑤ TEMPORARY PAVEMENT
  - ⑥ TEMPORARY PAVEMENT MARKING - LINE 6"
  - ⑦ MONODIRECTIONAL PRISMATIC BARRIER REFLECTOR
  - ⑧ VERTICAL PANEL WITH STEADY BURN LIGHT
- EXISTING LEGEND**
- (A) PAVEMENT
  - (B) SHOULDER
  - (C) BARRIER WALL
  - (D) CURB & GUTTER
  - (E) PAVEMENT MARKING

- NOTES**
- ABOVE DETAIL SHOWN MINIMUM REQUIREMENTS FOR CONTRACTOR'S ACCESS TO WORK ZONE.
  - NUMBER AND LOCATION OF ACCESS POINTS TO BE DETERMINED BY CONTRACTOR.
  - CONTRACTOR'S ACCESS TO WORK ZONE WILL NOT BE PAID SEPARATELY, COST MUST BE INCLUDED IN COST OF 'FURNISH TEMPORARY CONCRETE BARRIER' AND 'TEMPORARY CONCRETE BARRIER'.

REVISIONS	
NAME	DATE

MOT-3

ILLINOIS DEPARTMENT OF TRANSPORTATION  
F.A.I. 94/90 (DAN RYAN EXPRESSWAY)  
31ST STREET TO 71ST STREET  
NB EXPRESS LANE RECONSTRUCTION  
MAINTENANCE OF TRAFFIC PLAN  
TYPICAL SECTION

SCALE: =NTS  
DATE: 07/07/05

DRAWN BY: RA  
CHECKED BY: RS

BOWMAN, BARRETT & ASSOCIATES INC.  
CONSULTING ENGINEERS  
Chicago, Illinois  
312.228.0100  
www.bbainc.com

6/24/2005 11:04:47 AM