

F.A.I. RTE.	SECTION	COUNTY	TOTAL SHEETS	SHEET NO.
94/90		COOK	556	102
STA.	TO STA.		FED. AID PROJECT	
62300	(1818, ETC, 2324.6-1PIR-B			

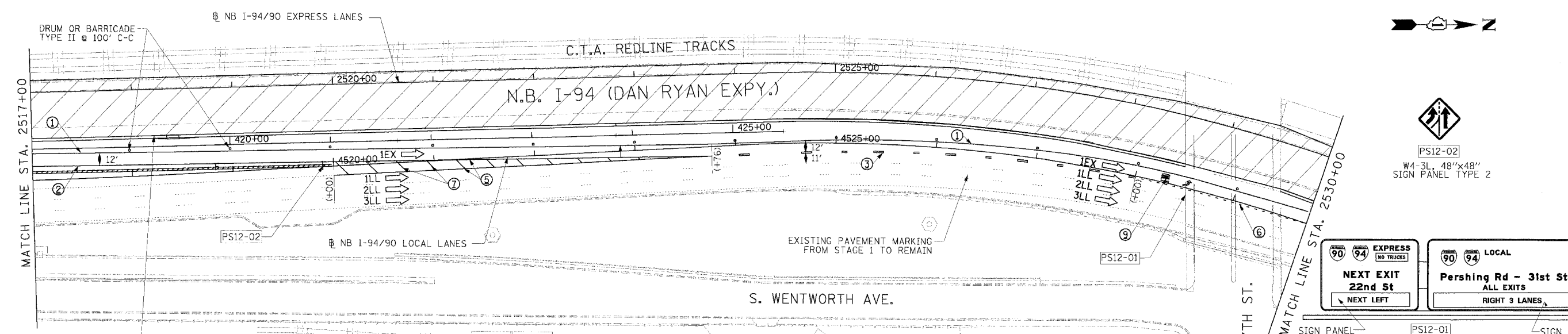
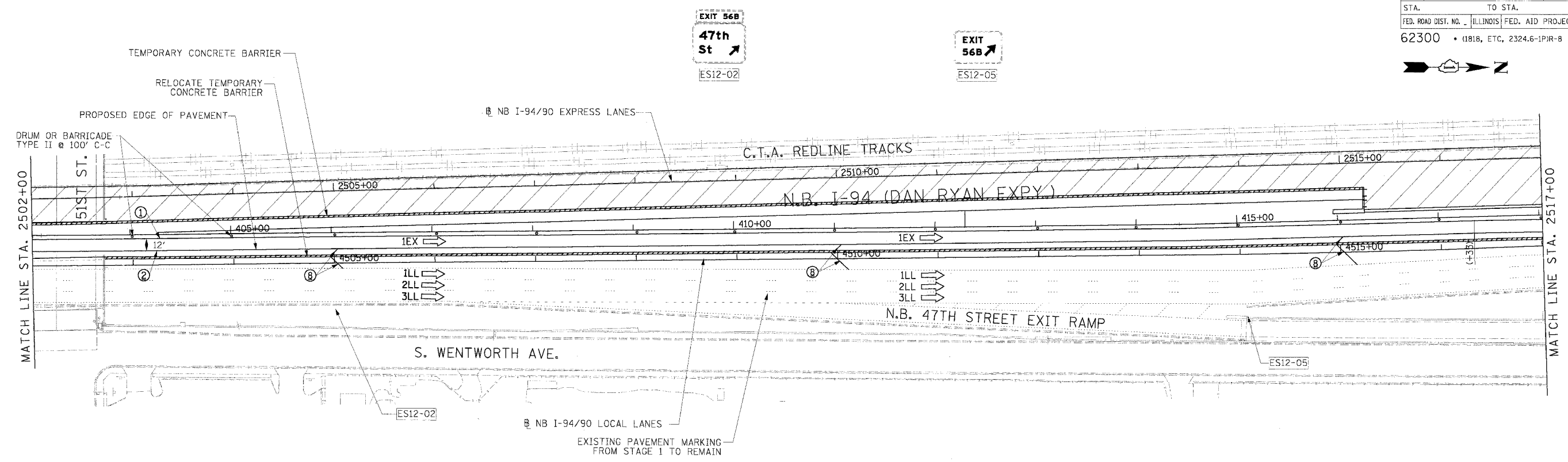

STA. 4518+40.00 - PROPOSED FOUNDATION FOR OVERHEAD SIGN TRUSS SEE OVERHEAD SIGN DETAILS (OVERHEAD SIGN TRUSS TO BE BUILT IN FUTURE CONTRACT)

- LEGEND**
- WORK ZONE
 - TEMPORARY PAVEMENT
 - TRAFFIC LANE & DIRECTION OF TRAFFIC
 - DRUM OR BARRICADE TYPE-II WITH STEADY BURN LIGHT
 - IMPACT ATTENUATORS, TEMPORARY (NON-REDIRECTIVE), TEST LEVEL 3
 - BARRICADE TYPE III
 - TEMPORARY CONCRETE BARRIER
 - EXISTING SIGN
 - TEMPORARY SIGN

- ① LINE 4" (YELLOW EDGE LINE)
- ② LINE 4" (WHITE EDGE LINE)
- ③ LINE 4" (SKIP DASH, 6' SKIP - 2' DASH, WHITE)
- ④ LINE 5" (SKIP DASH, 30' SKIP - 10' DASH, WHITE)
- ⑤ LINE 8" (WHITE GORE LINE)
- ⑥ LINE 8" (SKIP DASH, 12' SKIP - 3' DASH, WHITE)
- ⑦ LINE 12" (DIAGONAL, 30' C-C)
- ⑧ LINE 12" (DIAGONAL, 500' C-C)
- ⑨ LETTERS AND SYMBOLS

STATIONING
 +** STATION PROVIDED FROM THE NB I-90/94 EXPRESS LANES
 (+***) STATION PROVIDED FROM THE NB I-90/94 LOCAL LANES

NOTE:
 ALL PAVEMENT MARKINGS ON THIS SHEET ARE PAVEMENT MARKING TAPE, TYPE III UNLESS OTHERWISE NOTED.

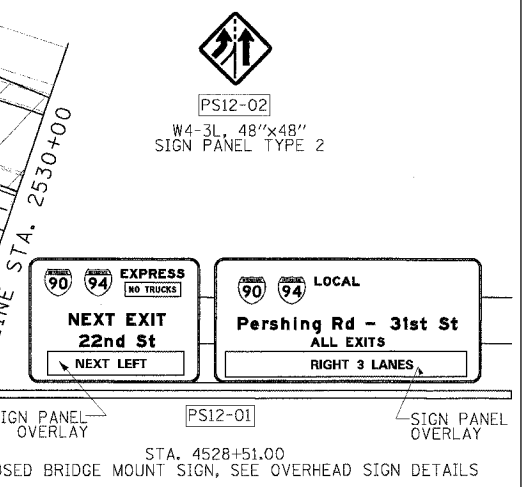

Edwards AND Kelcey
 ONE NORTH FRANKLIN CHICAGO, IL 60606
 PHONE: (312) 251-3000 FAX: (312) 251-3015 WEB: WWW.EKCORP.COM

REVISIONS	
NAME	DATE

ILLINOIS DEPARTMENT OF TRANSPORTATION
 F.A.I. 94/90 (DAN RYAN EXPRESSWAY)
 31ST STREET TO 71ST STREET
 NB EXPRESS LANE RECONSTRUCTION
 MAINTENANCE OF TRAFFIC PLAN
 NORTHBOUND STA. 2502+00 TO STA. 2530+00
 STAGE 2
 SCALE: 0" = 50' 1" = 50'
 DATE: 7/7/05 DRAWN BY: TAI CHECKED BY: PJM

PA03009035/Con 1818/CAAD/VP/10/10/05 12:39:22 PM