

F.A.I. RTE.	SECTION	COUNTY	TOTAL SHEETS	SHEET NO.
94/90		COOK	556	271
FED. ROAD DIST. NO. ILLINOIS FED. AID PROJECT				
62300 • (1818, ETC, 2324.6-1P1R-8				

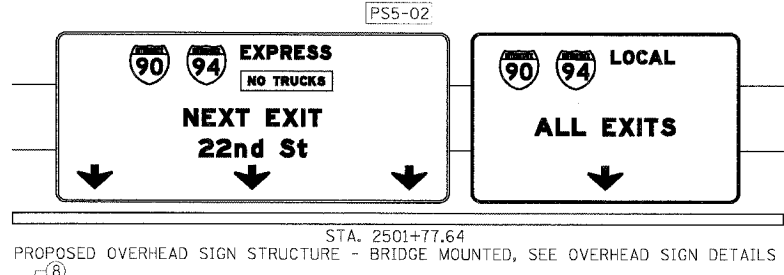

- LEGEND**
- ① LINE 4" (YELLOW EDGE LINE)
 - ② LINE 4" (WHITE EDGE LINE)
 - ③ LINE 4" (SKIP DASH, 6' SKIP - 2' DASH, WHITE)
 - ④ LINE 5" (SKIP DASH, 30' SKIP - 10' DASH, WHITE)
 - ⑤ LINE 8" (WHITE GORE LINE)
 - ⑥ LINE 8" (SKIP DASH, 12' SKIP - 3' DASH, WHITE)
 - ⑦ LINE 12" (DIAGONAL, 30' C-C)
 - ⑧ LINE 12" (DIAGONAL, 500' C-C)
 - ⑨ LETTERS AND SYMBOLS
- ESx-xx EXISTING SIGN
 TSx-xx TEMPORARY SIGN
 PSx-xx PROPOSED SIGN

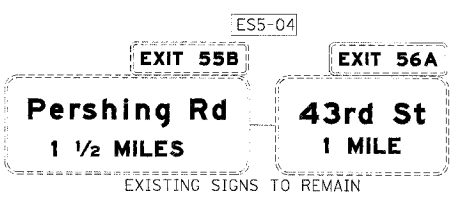
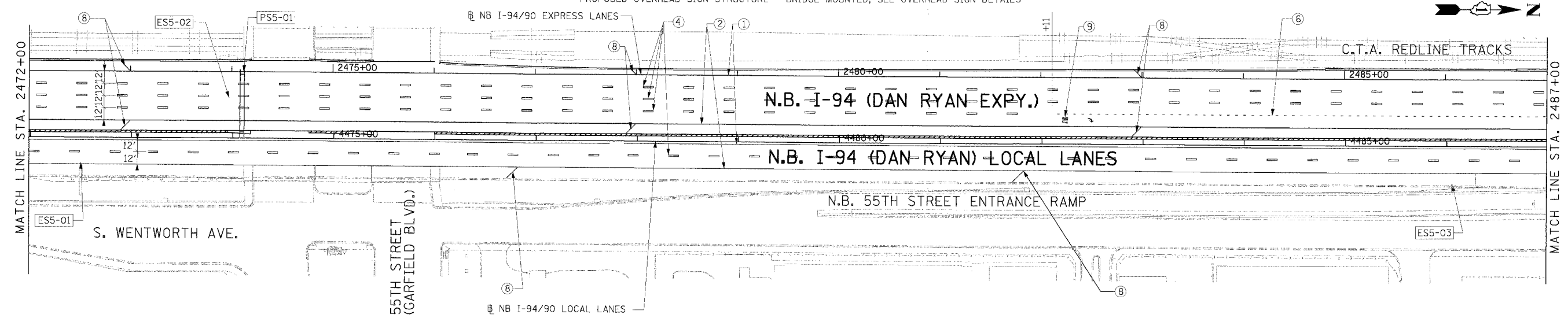
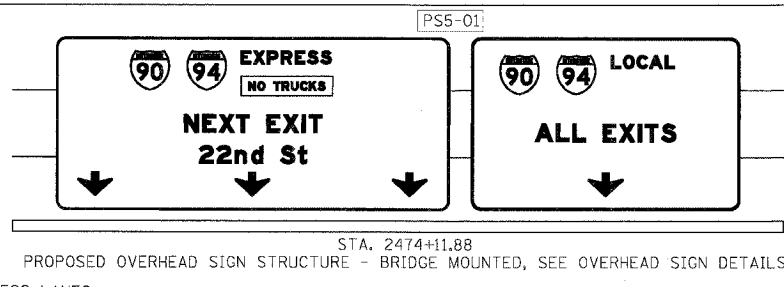
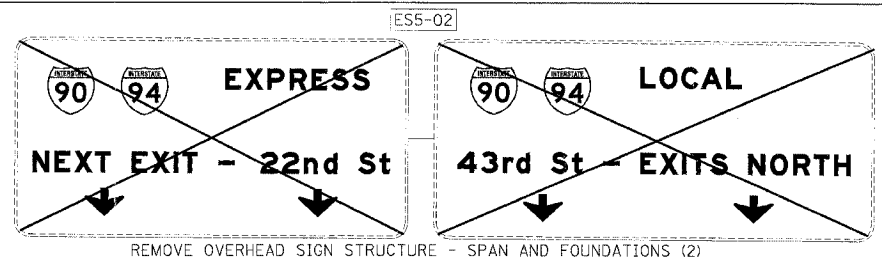
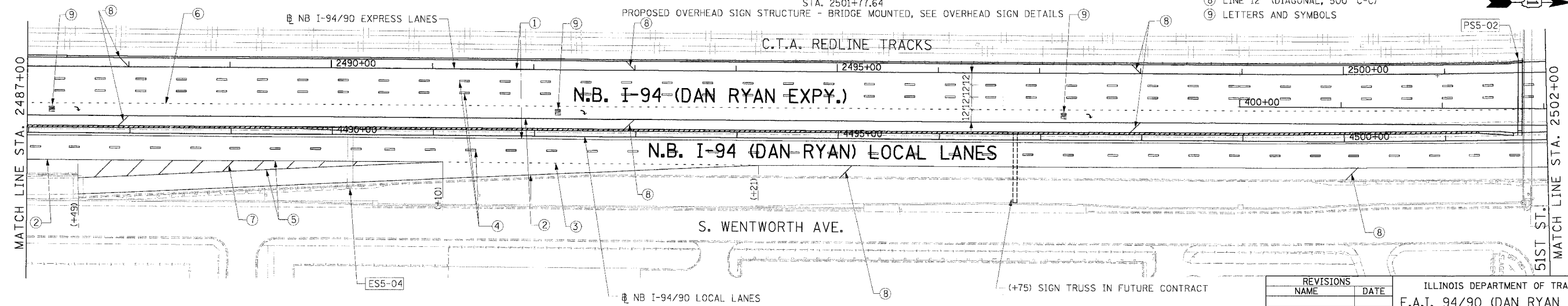

Edwards AND Kelcey
 ONE NORTH FRANKLIN
 CHICAGO, IL 60606
 PHONE: (312) 251-3000
 FAX: (312) 251-3015
 WEB: WWW.EKCORP.COM

NOTE:
 ALL PAVEMENT MARKINGS ON THIS SHEET ARE EPOXY PAVEMENT MARKING UNLESS OTHERWISE NOTED.

STATIONING
 +** STATION PROVIDED FROM THE NB I-90/94 EXPRESS LANES
 (+**) STATION PROVIDED FROM THE NB I-90/94 LOCAL LANES

REVISIONS	
NAME	DATE

ILLINOIS DEPARTMENT OF TRANSPORTATION
 F.A.I. 94/90 (DAN RYAN EXPRESSWAY)
 31ST STREET TO 71ST STREET
 NB EXPRESS LANE RECONSTRUCTION
 AND SIGNING PLAN
 NORTHBOUND STA. 2472+00 TO STA. 2502+00
 SCALE: 1"=50'
 DATE: 7/1/05 DRAWN BY: TAI
 CHECKED BY: PJM

D:\03001503\5\Con\14815\CAD\Drawings\940527.dwg 06/24/2005 12:59:57 PM