

F.A.I. RTE.	SECTION	COUNTY	TOTAL SHEETS	SHEET NO.
94/90		COOK	556	335
STA. 1518+00		TO STA. 1529+50		
FED. ROAD DIST. NO.	ILLINOIS	FED. AID PROJECT		
62300		• (1818, ETC, 2324.6-1P)R-8		

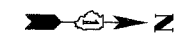

NO PROPOSED WORK  
ON THIS SHEET

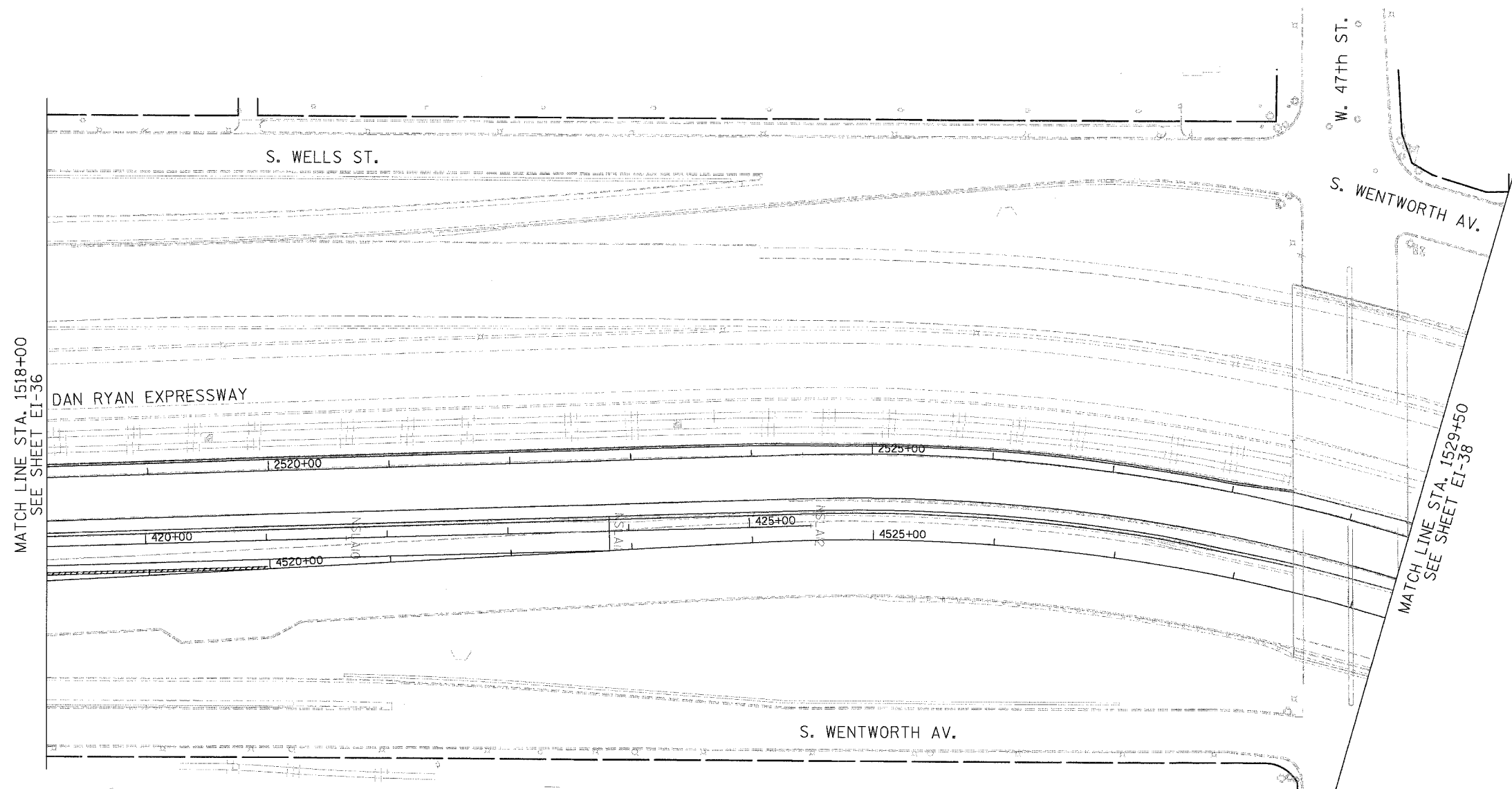

MATCH LINE STA. 1518+00  
SEE SHEET EI-36

MATCH LINE STA. 1529+50  
SEE SHEET EI-38

- NOTES:
1. SEE DRAWING EI-100 AND EI-101 FOR ELECTRICAL SYSTEMS AND ABBREVIATIONS.
  2. UNLESS OTHERWISE STATED, ALL NOTED CABLE TO BE FURNISHED AND INSTALLED UNDER ANOTHER CONTRACT.
  3. TRENCHED CONDUITS INSTALLED IN PARALLEL ARE TO BE INSTALLED IN COMMON TRENCH.
  4. THIS SHEET ONLY DEPICTS INSTALLATION OF DETECTION/RAMP METER ELEMENTS. REFER TO SHEETS FOR OTHER SUBSYSTEMS FOR ADDITIONAL ELEMENTS IN THE AREA SHOWN.
  5. DETECTOR LOOPS INSTALLED BY OTHERS.
  6. REFER TO HANDHOLE DETAILS. SEE DRAWING DT-29.

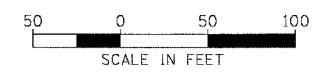

EI-37

**Edwards  
AND  
Kelcey**  
ONE NORTH FRANKLIN  
CHICAGO, IL 60606  
PHONE: (312) 251-3000  
FAX: (312) 251-3015  
WEB: WWW.EKCORP.COM

REVISIONS	
NAME	DATE

ILLINOIS DEPARTMENT OF TRANSPORTATION  
F.A.I. 94/90 (DAN RYAN EXPRESSWAY)  
31ST STREET TO 71ST STREET  
NB EXPRESS LANE RECONSTRUCTION  
ELECTRICAL INFRASTRUCTURE PLAN  
NORTHBOUND STA 1518+00 TO 1529+50

SCALE: 1"=50'  
DATE: 7/7/05

DRAWN BY: CJH  
CHECKED BY: M.JL

06/24/2005 09:46:13 PM