

F.A.I. R/F:	SECTION	COUNTY	TOTAL SHEETS	SHEET NO.
94/90		COOK	598	52
STA.	TO STA.			
FED. ROAD DIST. NO.	ILLINOIS FED. AID PROJECT			
62302	(1818, ETC, 2324.6-1P)R-9			

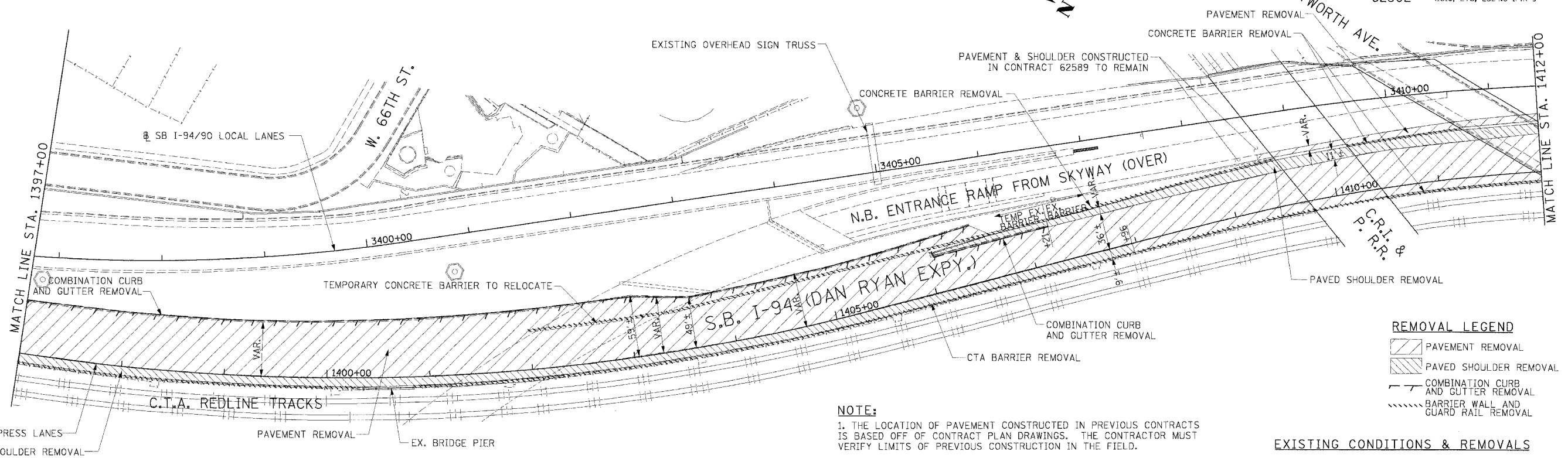

NOTE:
1. THE LOCATION OF PAVEMENT CONSTRUCTED IN PREVIOUS CONTRACTS IS BASED OFF OF CONTRACT PLAN DRAWINGS. THE CONTRACTOR MUST VERIFY LIMITS OF PREVIOUS CONSTRUCTION IN THE FIELD.

EXISTING CONDITIONS & REMOVALS

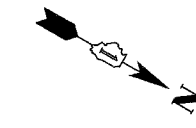
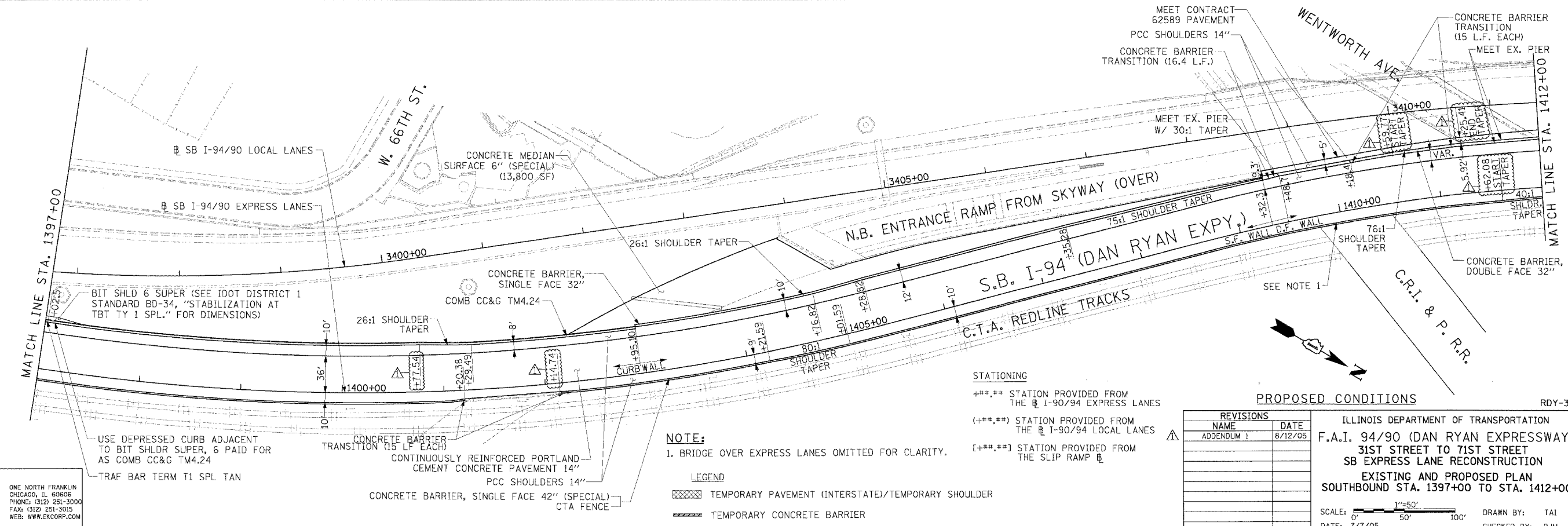

NOTE:
1. BRIDGE OVER EXPRESS LANES OMITTED FOR CLARITY.

LEGEND
 TEMPORARY PAVEMENT (INTERSTATE)/TEMPORARY SHOULDER
 TEMPORARY CONCRETE BARRIER

STATIONING
 +**.** STATION PROVIDED FROM THE SB I-90/94 EXPRESS LANES
 (+**.** STATION PROVIDED FROM THE SB I-90/94 LOCAL LANES
 [+**.** STATION PROVIDED FROM THE SLIP RAMP

REVISIONS	
NAME	DATE
ADDENDUM 1	8/12/05

ILLINOIS DEPARTMENT OF TRANSPORTATION
 F.A.I. 94/90 (DAN RYAN EXPRESSWAY)
 31ST STREET TO 71ST STREET
 SB EXPRESS LANE RECONSTRUCTION
 EXISTING AND PROPOSED PLAN
 SOUTHBOUND STA. 1397+00 TO STA. 1412+00
 SCALE: 1"=50'
 DATE: 7/7/05
 DRAWN BY: TAI
 CHECKED BY: PJM

Edwards and Kelcey
 ONE NORTH FRANKLIN
 CHICAGO, IL 60606
 PHONE: (312) 251-3000
 FAX: (312) 251-3015
 WEB: WWW.EKCORP.COM

08/10/2005 02:29:00 PM