

F.A.I. RTE.	SECTION	COUNTY	TOTAL SHEETS	SHEET NO.
94/90		COOK	598	58
STA.	TO STA.			
62302	ILLINOIS FED. AID PROJECT			
1818, ETC, 2324.6-1PR-9				

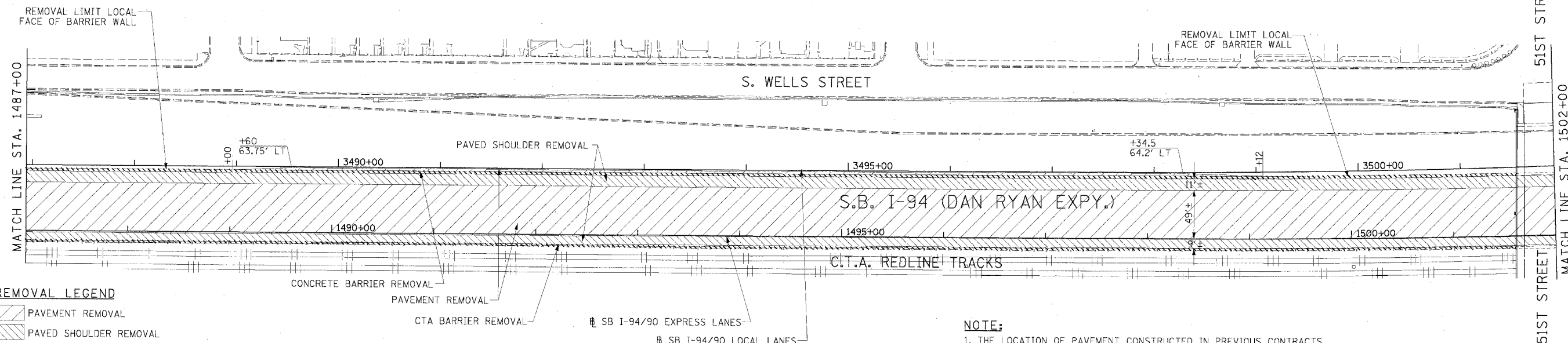

REMOVAL LEGEND

	PAVEMENT REMOVAL
	PAVED SHOULDER REMOVAL
	COMBINATION CURB AND GUTTER REMOVAL
	CONCRETE BARRIER OR GUARD RAIL REMOVAL

NOTE:
1. THE LOCATION OF PAVEMENT CONSTRUCTED IN PREVIOUS CONTRACTS IS BASED OFF OF CONTRACT PLAN DRAWINGS. THE CONTRACTOR MUST VERIFY LIMITS OF PREVIOUS CONSTRUCTION IN THE FIELD.

EXISTING CONDITIONS & REMOVALS

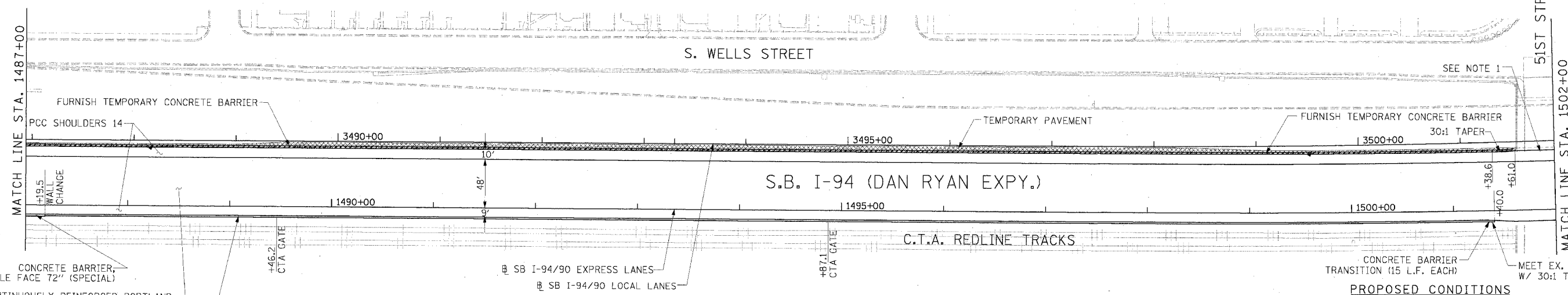

CONCRETE BARRIER, SINGLE FACE 72" (SPECIAL)
CONTINUOUSLY REINFORCED PORTLAND CEMENT CONCRETE PAVEMENT 14"
CONCRETE BARRIER, SINGLE FACE 42" (SPECIAL)
CTA FENCE

NOTE:
1. BRIDGE OVER EXPRESS LANES OMITTED FOR CLARITY.

LEGEND

	TEMPORARY PAVEMENT (INTERSTATE)/TEMPORARY SHOULDER
	TEMPORARY CONCRETE BARRIER

STATIONING
 [###,##] STATION PROVIDED FROM THE [] I-90/94 EXPRESS LANES
 ([###,##]) STATION PROVIDED FROM THE [] I-90/94 LOCAL LANES
 [###,##] STATION PROVIDED FROM THE SLIP RAMP []

REVISIONS	
NAME	DATE

ILLINOIS DEPARTMENT OF TRANSPORTATION
 F.A.I. 94/90 (DAN RYAN EXPRESSWAY)
 31ST STREET TO 71ST STREET
 SB EXPRESS LANE RECONSTRUCTION
 EXISTING AND PROPOSED PLAN
 SOUTHBOUND STA. 1487+00 TO STA. 1502+00
 SCALE: 1"=50'
 DATE: 7/1/05
 DRAWN BY: TAI
 CHECKED BY: PJM

Edwards AND Kelcey
 ONE NORTH FRANKLIN
 CHICAGO, IL 60606
 PHONE: (312) 251-3000
 FAX: (312) 251-3015
 WEB: WWW.EKCORP.COM

06/24/2005 09:26:06 AM