

F.A.I. SHEETS	SECTION	COUNTY	TOTAL SHEETS	SHEET NO.
94/90		COOK	598	270
STA.	TO STA.			
FED. ROAD DIST. NO.	ILLINOIS FED. AID PROJECT			
62302	(181B, ETC. 2324.6-1P1R-9			

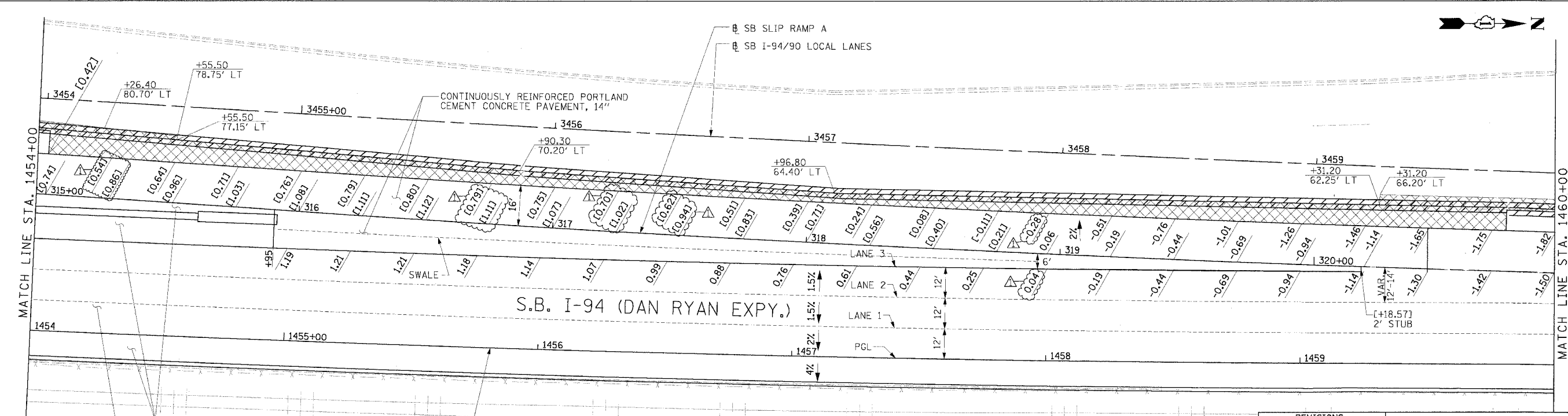
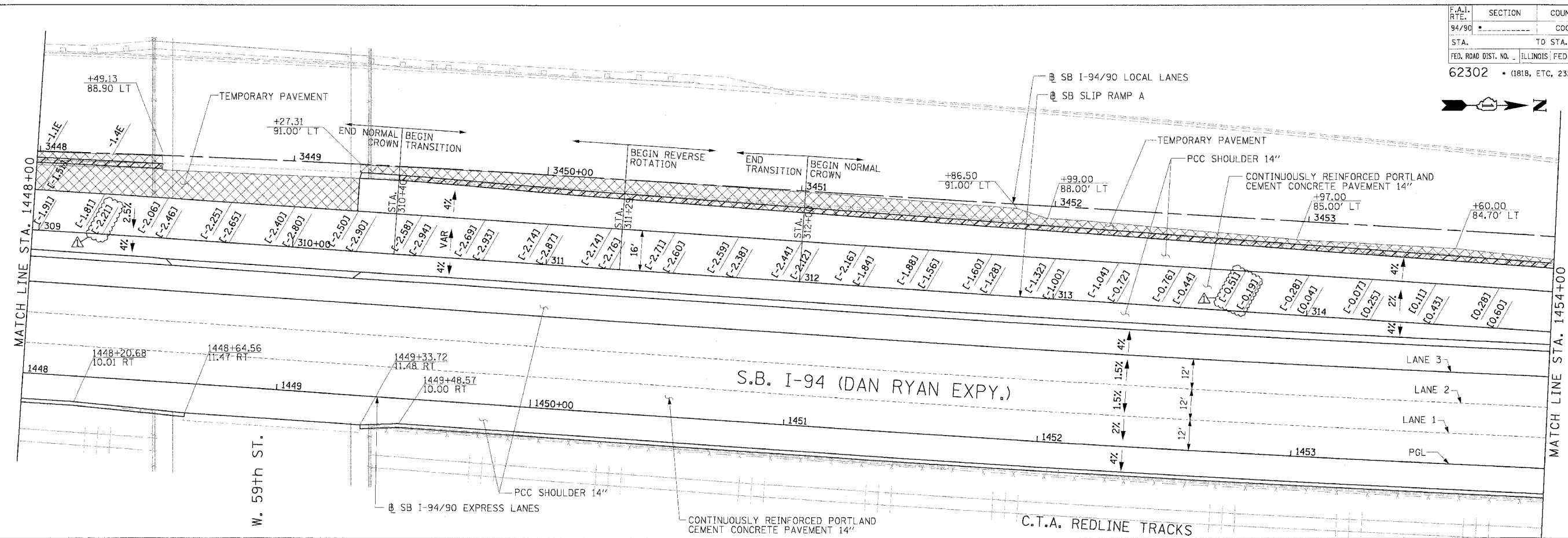

**Edwards  
AND Kelcey**  
ONE NORTH FRANKLIN  
CHICAGO, IL 60606  
PHONE: (312) 251-3000  
FAX: (312) 251-3015  
WEB: WWW.EDKCORP.COM

**LEGEND**  
 [\*\*\*] ELEVATION STATIONED OFF OF SB I-94/90 EXPRESS LANES  
 [\*\*\*] ELEVATION STATIONED OFF OF SB I-94/90 LOCAL LANES  
 [\*\*\*] ELEVATION STATIONED OFF OF SLIP RAMP ALIGNMENT

**NOTE:**  
 1. PAVEMENT ELEVATIONS ALONG RAMPS, GOES AND IN AREAS OF SUPERELEVATION TRANSITION ARE PROVIDED AT 25' INTERVALS. FOR ALL OTHER ELEVATIONS, REFER TO PROFILE AND TYPICAL SECTIONS.

REVISIONS		
NAME	DATE	
ADDENDUM 1	8/12/05	

ILLINOIS DEPARTMENT OF TRANSPORTATION  
 F.A.I. 94/90 (DAN RYAN EXPRESSWAY)  
 31ST STREET TO 71ST STREET  
 SB EXPRESS LANE RECONSTRUCTION  
 PAVEMENT JOINTING AND ELEVATION PLAN  
 SOUTHBOUND STA. 1448+00 TO STA. 1460+00  
 SCALE: 1"=20'  
 DATE: 7/1/05  
 DRAWN BY: TAI  
 CHECKED BY: PJM

08/10/2005 02:57:04 PM