

F.A.I. RTE.	SECTION	COUNTY	TOTAL SHEETS	SHEET NO.
94/90		COOK	598	272
STA.	TO STA.			
FED. ROAD DIST. NO.	ILLINOIS FED. AID PROJECT			
62302	1818, ETC. 2324.6-1P/R-9			

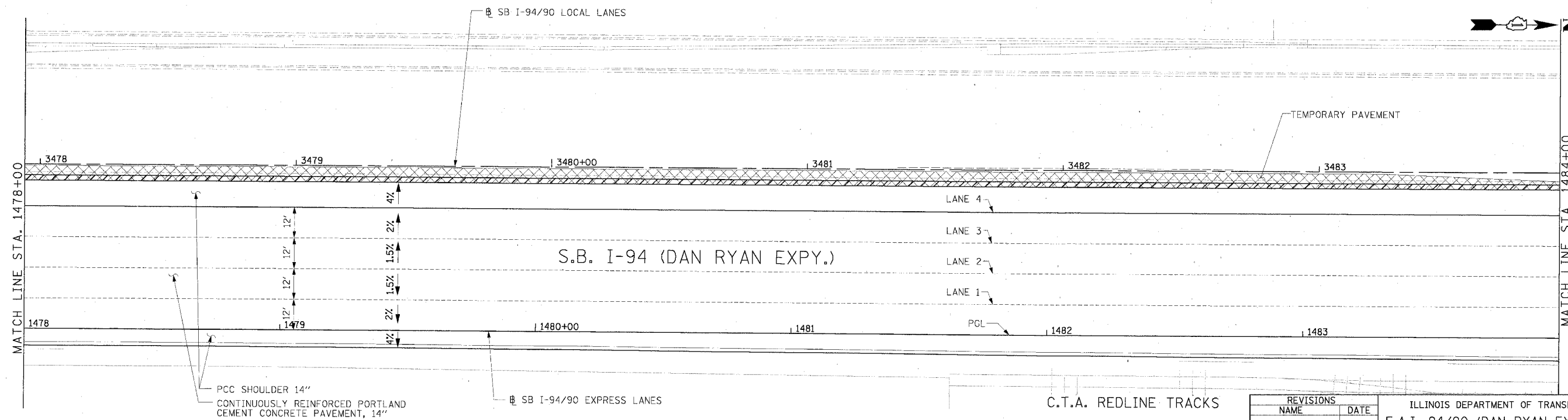
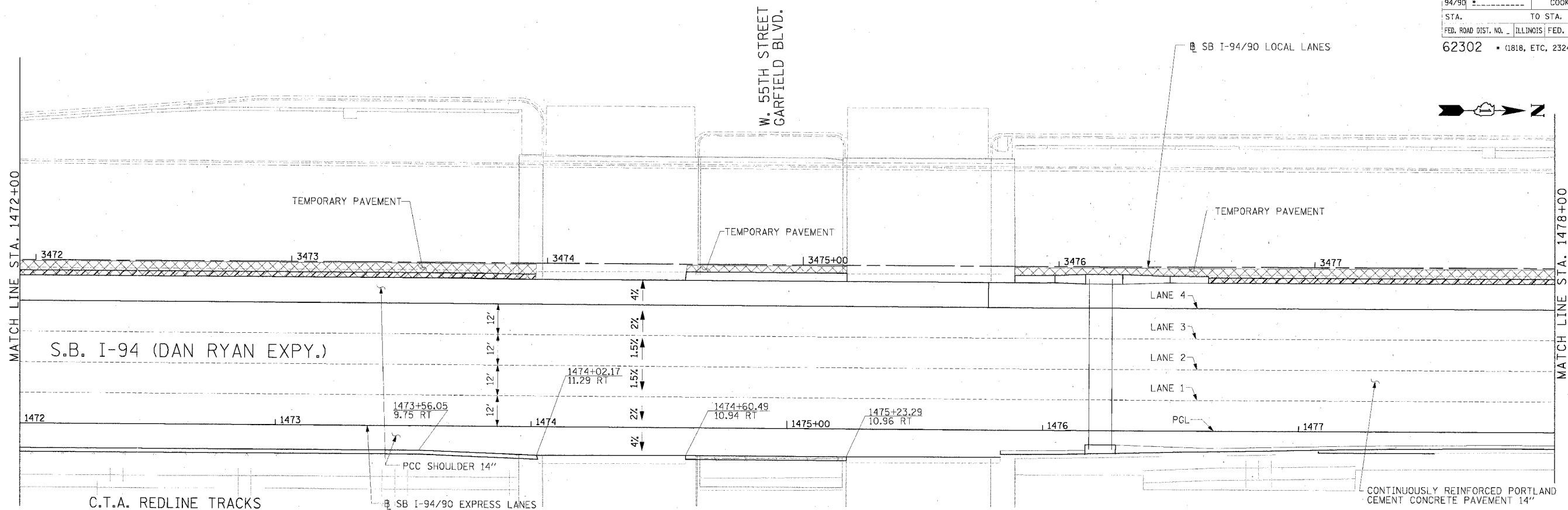

**Edwards AND Kelcey**  
 ONE NORTH FRANKLIN  
 CHICAGO, IL 60606  
 PHONE: (312) 251-3000  
 FAX: (312) 251-3015  
 WEB: WWW.EKCORP.COM

**LEGEND**  
 #,### ELEVATION STATIONED OFF OF SB I-94/90 EXPRESS LANES  
 (#,###) ELEVATION STATIONED OFF OF SB I-94/90 LOCAL LANES  
 [#,###] ELEVATION STATIONED OFF OF SLIP RAMP ALIGNMENT

**NOTE:**  
 1. PAVEMENT ELEVATIONS ALONG RAMPS, GORES AND IN AREAS OF SUPERELEVATION TRANSITION ARE PROVIDED AT 25' INTERVALS. FOR ALL OTHER ELEVATIONS, REFER TO PROFILE AND TYPICAL SECTIONS.

REVISIONS	
NAME	DATE

ILLINOIS DEPARTMENT OF TRANSPORTATION  
 F.A.I. 94/90 (DAN RYAN EXPRESSWAY)  
 31ST STREET TO 71ST STREET  
 SB EXPRESS LANE RECONSTRUCTION  
 PAVEMENT JOINTING AND ELEVATION PLAN  
 SOUTHBOUND STA. 1472+00 TO STA. 1484+00  
 SCALE: 0" 10' 20' 30' 40'  
 DATE: 7/7/05  
 DRAWN BY: TAI  
 CHECKED BY: PJM

P:\030019255\Corr 1818\CADD\NSV\1501026.dwg JT-10 05/24/2005 10:00:36 AM