

- LEGEND**
- ① LINE 4" (YELLOW EDGE LINE)
 - ② LINE 4" (WHITE EDGE LINE)
 - ③ LINE 4" (SKIP DASH, 6' SKIP - 2' DASH, WHITE)
 - ④ LINE 5" (SKIP DASH, 30' SKIP - 10' DASH, WHITE)
 - ⑤ LINE 8" (WHITE GORE LINE)
 - ⑥ LINE 8" (SKIP DASH, 12' SKIP - 3' DASH, WHITE)
 - ⑦ LINE 12" (DIAGONAL, 30' C-C)
 - ⑧ LINE 12" (DIAGONAL, 500' C-C)
 - ⑨ LETTERS AND SYMBOLS

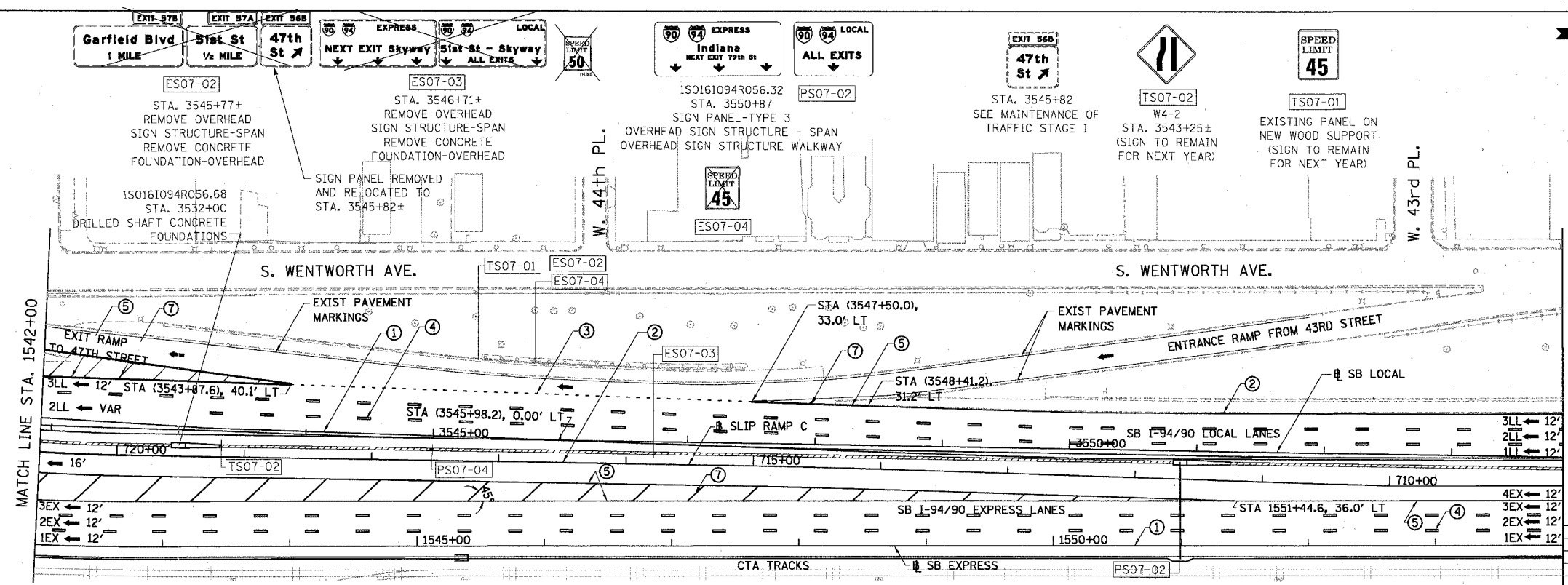

- ESx-xx EXISTING SIGNS
- TSx-xx TEMPORARY SIGNS
- PSx-xx PROPOSED SIGNS

STATIONING

- +++** STATION PROVIDED FROM THE SB I-90/94 EXPRESS LANES
- (+++**) STATION PROVIDED FROM THE SB I-90/94 LOCAL LANES
- [+++**] STATION PROVIDED FROM THE SLIP RAMP

NOTE:
ALL PAVEMENT MARKINGS ON THIS SHEET WILL BE EPOXY PAVEMENT MARKING, UNLESS OTHERWISE NOTED. PMK-7

REVISIONS NAME	DATE

ILLINOIS DEPARTMENT OF TRANSPORTATION
 F.A.I. 94/90 (DAN RYAN EXPRESSWAY)
 SB EXPRESS LANE RECONSTRUCTION
 PAVEMENT MARKING AND SIGNING PLAN
 SOUTHBOUND STA. 1530+00 TO STA. 1554+00
 SCALE: 1"=50'
 DATE: 07/07/05
 DRAWN BY: RA
 CHECKED BY: RS

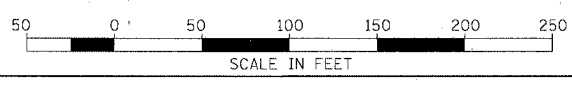

BOWMAN, BARRETT & ASSOCIATES INC.
 CONSULTING ENGINEERS
 Chicago, Illinois
 312.228.0100
 www.bbsandainc.com

11:55:00 AM 07/15/05 SHEETS 66015C/PC/02/05
 3:46:36 PM 5/24/2005