

F.A.I. RTE.	SECTION	COUNTY	TOTAL SHEETS	SHEET NO.
90/94		COOK	598	416
STA.	TO STA.		FED. AID PROJECT	
			• (1818, ETC, 2324.6-10R-9	
			62302	

BILL OF MATERIAL FOR ONE TRANSITION

Bar	No.	Size	Length	Shape
d1(E)	17	#4	6'-5"	
d6(E)	50	#4	6'-0"	
h6(E)	112	#4	1'-9"	
h7(E)	8	#4	29'-0"	
h8(E)	16	#4	21'-5"	
Item		Unit	Quantity	
Reinforcement Bars, Epoxy Coated		Pound	788	
Concrete Superstructure		Cu. Yd.	18.0	
Protective Coat		Sq. Yd.	57	
Concrete Removal		Cu. Yd.	1.1	

LEGEND:

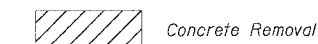

NOTES:

1. Drilling and grouting of #4 h2(E) and h6(E) bars shall be in accordance with Section 584 of the Standard Specifications.
2. The cost of drilling holes, furnishing and placing Epoxy Grout and setting h2(E) and h6(E) bars shall be included in the cost per cubic yard for Concrete Superstructure.
3. Exposed existing reinforcement bars shall remain in place and be blast cleaned to gray metal. Reinforcement bars that have been cut or have lost 25% or more of their original cross sectional area shall be supplemented by new epoxy coated reinforcement bars.
4. The cost of supplementing and cleaning existing reinforcement bars shall be included in the cost per cubic yard for Concrete Removal.
5. For Refaced Barrier Wall Details see Sheets B2 and B3.
6. For locations of Transition, see Roadway Plans.

Sheet B8 of 18

REVISIONS	
NAME	DATE
MJP	8-12-05

ILLINOIS DEPARTMENT OF TRANSPORTATION
F.A.I. 90/94 (DAN RYAN EXPRESSWAY)
71ST STREET TO 31ST STREET (SB EXPRESS LANES)
EXISTING BARRIER WALL MODIFICATIONS
AT CTA STATIONS
PROPOSED T/S SHOULDER BELOW EXISTING
REFACED BARRIER TO PIER
TRANSITION DETAILS (TAPER)
SCALE: None DRAWN BY: CHD
DATE: July 7, 2005 CHECKED BY: RDP

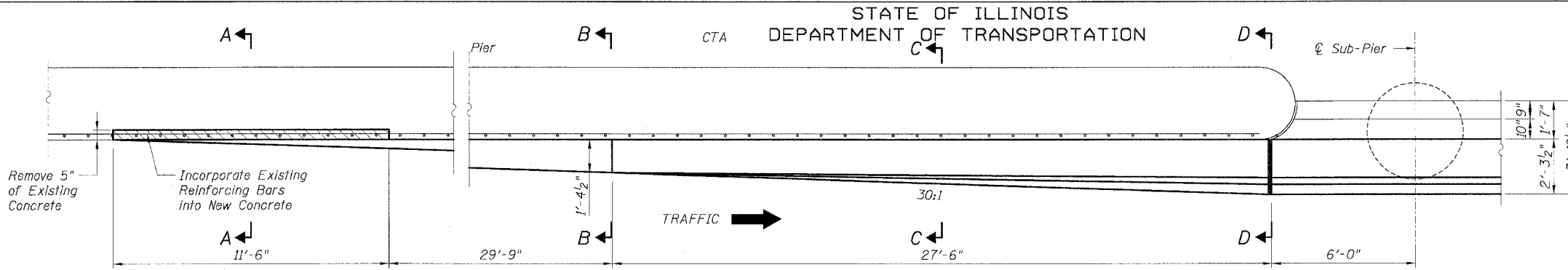

PLAN

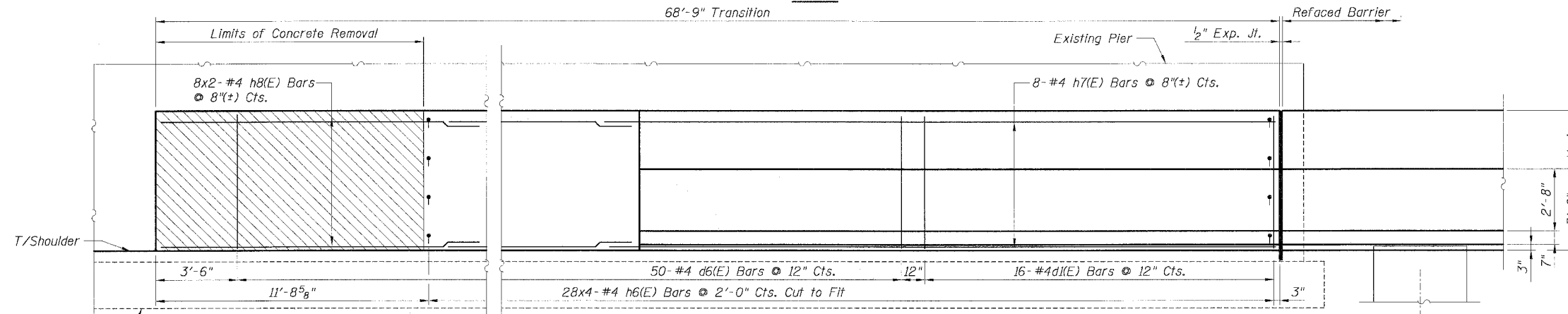

ELEVATION

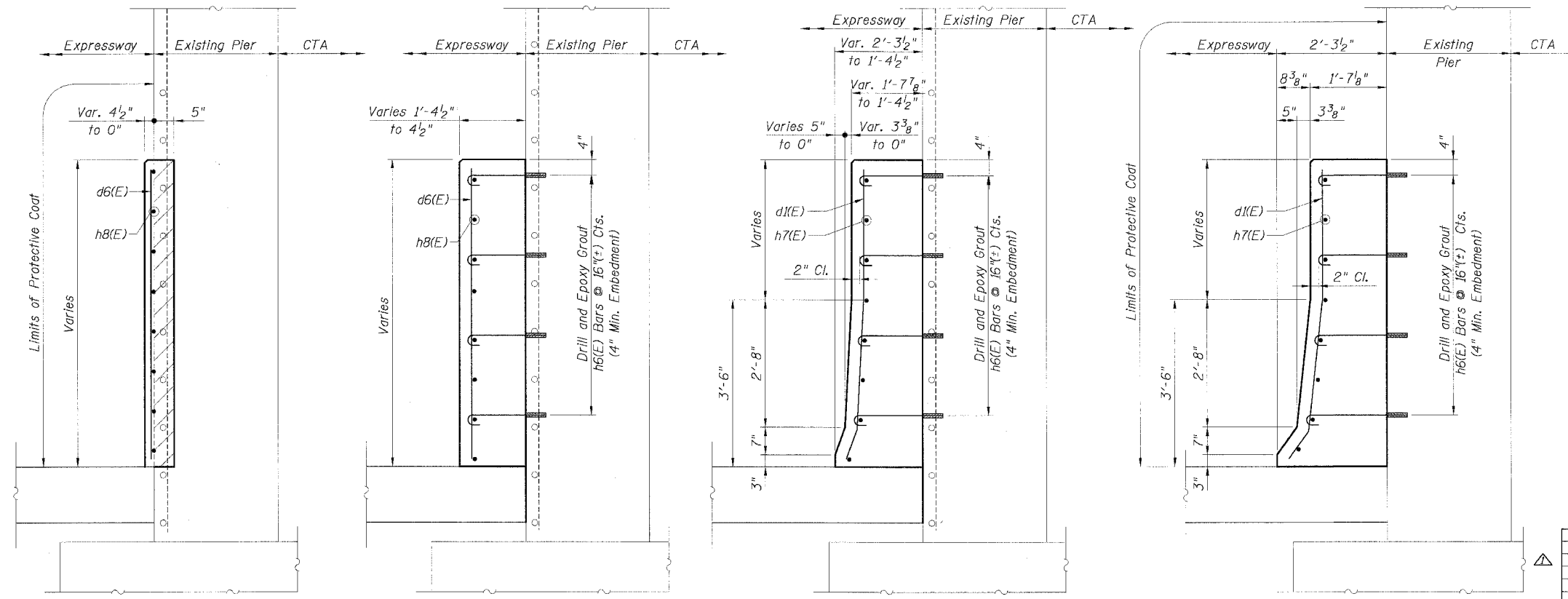

SECTION A-A

SECTION B-B

SECTION C-C

SECTION D-D

CTE | AECOM