

11-04-2016 LETTING ITEM 064

STATE OF ILLINOIS
DEPARTMENT OF TRANSPORTATION

F.A.S. RTE.	SECTION	COUNTY	TOTAL SHEETS	SHEET NO.
2796		**	19	1
		ILLINOIS	CONTRACT NO. 74749	

* DT HMA SAFETY SHLD 2017-2
** FAYETTE & EFFINGHAM

D-97-012-16

FOR INDEX OF SHEETS, SEE SHEET NO. 2

PROPOSED HIGHWAY PLANS

FAS ROUTE 2796 (US 40 & IL 128)
SECTION D7 HMA SAFETY SHLD 2017-2
PROJECT ACHSIP-2796(102)
HMA SAFETY SHOULDER
FAYETTE & EFFINGHAM COUNTY

C-97-041-16

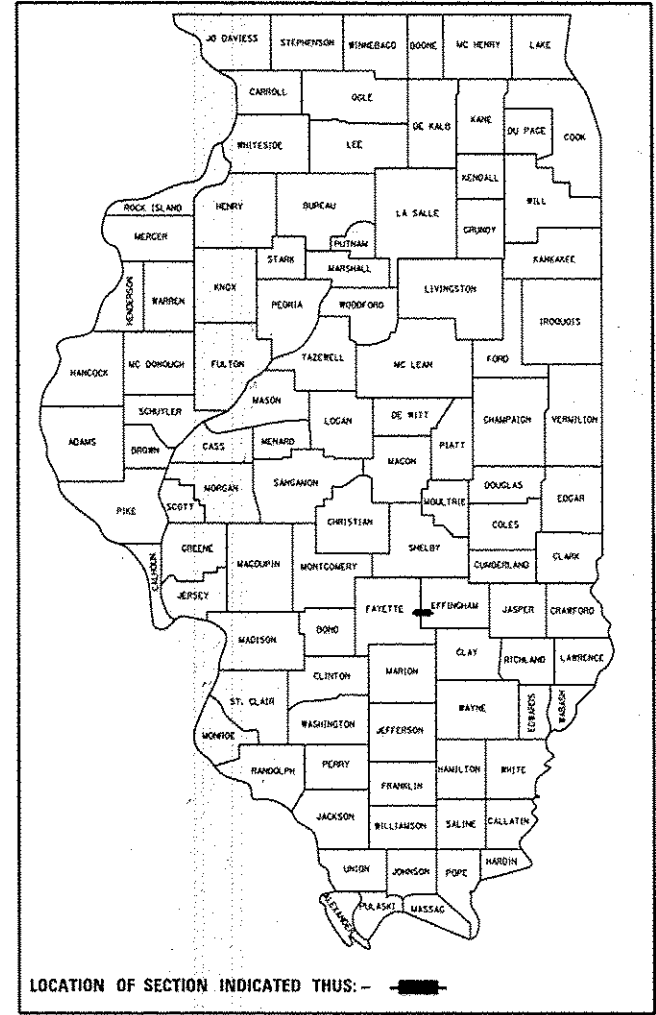

STRUCTURE OMISSION

STA. 1463 + 33 TO STA. 1464 + 04

ADT = 3,935 (2015)

PROJECT BEGINS:
STA. 1249 + 22

PROJECT ENDS:
STA. 1549 + 37

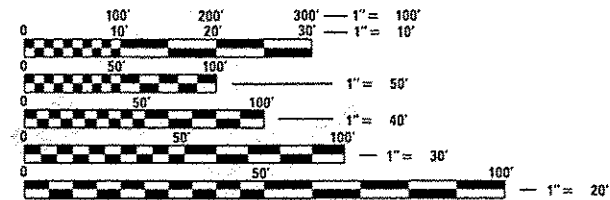
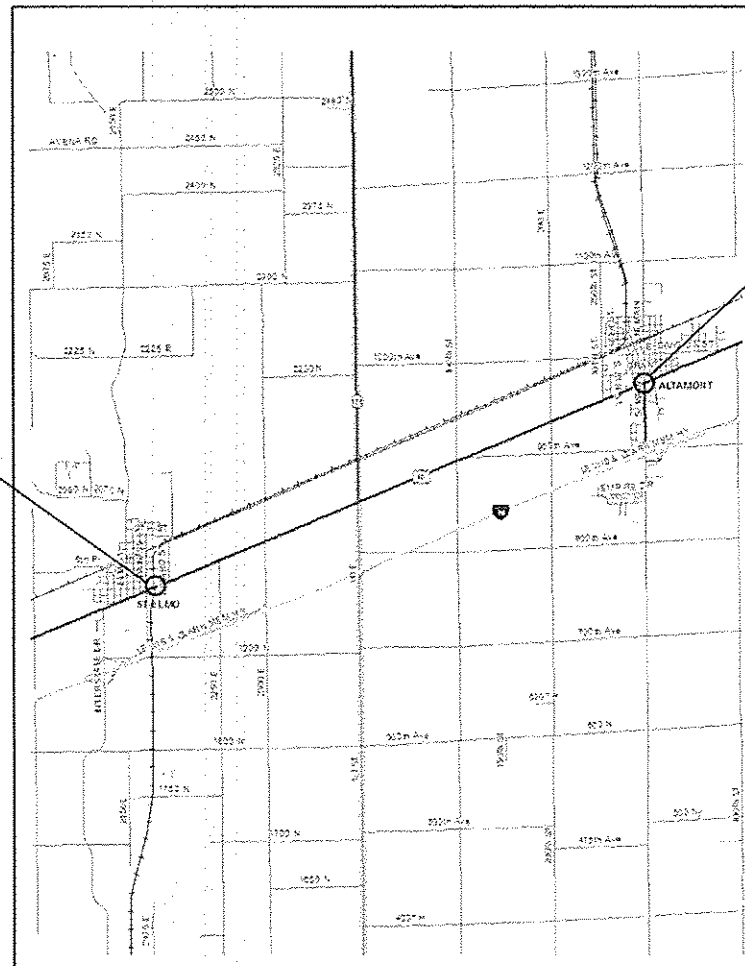

FULL SIZE PLANS HAVE BEEN PREPARED USING STANDARD ENGINEERING SCALES. REDUCED SIZED PLANS WILL NOT CONFORM TO STANDARD SCALES. IN MAKING MEASUREMENTS ON REDUCED PLANS, THE ABOVE SCALES MAY BE USED.

J.U.L.I.E.
JOINT UTILITY LOCATION INFORMATION FOR EXCAVATION
1-800-892-0123
OR 811

PROJECT ENGINEER: TOM RONAN
PROJECT MANAGER: JASON MYERS
PHONE: (217) 342-8314
CONTRACT NO. 74749

GROSS LENGTH = 30,015 FT. = 5.68 MILE
NET LENGTH = 29,944 FT. = 5.67 MILE

STATE OF ILLINOIS
DEPARTMENT OF TRANSPORTATION

SUBMITTED August 9, 2016
Jeffrey M. Southwood
REGIONAL ENGINEER

Sept 30, 2016
McLennan M. Adams, PE
ENGINEER OF DESIGN AND ENVIRONMENT

Sept 30, 2016
Michelle [Signature]
DIRECTOR OF PROGRAM DEVELOPMENT

PRINTED BY THE AUTHORITY
OF THE STATE OF ILLINOIS

INDEX OF SHEETS

SHEET NO.	ITEM
1	COVER SHEET
2	INDEX OF SHEETS & GENERAL NOTES
3	SUMMARY OF QUANTITIES
4	TYPICAL SECTIONS
5	SCHEDULE
6-15	PLAN SHEETS
16-19	PAVEMENT MARKING AND RAISED REFLECTIVE PAVEMENT MARKERS

THE FOLLOWING STANDARDS ARE A PART OF THESE PLANS AND ARE INCLUDED AFTER SHEET NO. 19:

000001-06	STANDARD SYMBOLS, ABBREVIATIONS AND PATTERNS
001006	DECIMAL OF AN INCH AND A FOOT
482001-02	HMA SHOULDER ADJACENT TO FLEXIBLE PAVEMENT
642006	SHOULDER RUMBLE STRIPS, 8 IN.
701011-04	OFF-ROAD MOVING OPERATIONS, 2L, 2W, DAY ONLY
701301-04	LANE CLOSURE, 2L, 2W, SHORT TIME OPERATIONS
701311-03	LANE CLOSURE 2L, 2W, MOVING OPERATIONS - DAY ONLY
701326-04	LANE CLOSURE, 2L, 2W, PAVEMENT WIDENING, FOR SPEEDS >= 45 MPH
701901-05	TRAFFIC CONTROL DEVICES

GENERAL NOTES

THIS SECTION SHALL BE CONSTRUCTED IN ACCORDANCE WITH THE PLANS. THE STANDARD SPECIFICATIONS FOR ROAD AND BRIDGE CONSTRUCTION, ADOPTED APRIL 1, 2016; THE "SUPPLEMENTAL SPECIFICATIONS AND RECURRING SPECIAL PROVISIONS" INDICATED ON THE CHECK SHEET, AND "THE SPECIAL PROVISIONS" INCLUDED IN THE PROPOSAL.

THE WORK INCLUDED IN THIS SECTION CONSISTS OF PLACING HMA SAFETY SHOULDERS, AGGREGATE WEDGE SHOULDERS, RUMBLE STRIPS, PAVEMENT MARKING, AND ANY OTHER WORK NECESSARY TO COMPLETE THIS SECTION.

THE CONTRACTOR SHALL PROVIDE INTERNET ACCESS TO THE HOT-MIX ASPHALT PLANT QUALITY CONTROL LAB SO THAT HOT-MIX ASPHALT PLANT REPORTS CAN BE E-MAILED TO THE DISTRICT HEADQUARTERS. THIS WORK SHALL BE INCLUDED IN THE COST OF HOT-MIX ASPHALT ITEMS.

THE MATERIAL EXCAVATED FOR THE CONSTRUCTION OF THE HMA SHOULDERS SHALL BE REMOVED FROM THE PROJECT ACCORDING TO ARTICLE 202.03 OF THE STANDARD SPECIFICATIONS. THE REMOVAL OF THE EXCAVATED MATERIAL SHALL BE INCLUDED IN THE CONTRACT UNIT PRICE PER UNIT FOR EXCAVATING AND GRADING EXISTING SHOULDER.

HMA SHOULDERS SHALL BE OMITTED FROM LOCATIONS WHERE HMA SHOULDERS OR BASE COURSE WIDENING ALREADY EXISTS. HOWEVER, RUMBLE STRIPS SHALL BE CONSTRUCTED AT THESE LOCATIONS.

OMIT RUMBLE STRIPS IN THE CITY LIMITS OF ST. ELMO AND ALTAMONT. OMIT RUMBLE STRIPS ON ALL SIDEROADS, PRIVATE, AND COMMERCIAL ENTRANCES AT RADIUS RETURNS. OMIT RUMBLE STRIPS AT MAILBOX TURNOUTS 60' BOTH SIDES OF THE MAILBOX OR AS DETERMINED BY THE ENGINEER. THESE OMISSIONS WILL NOT BE MEASURED FOR PAYMENT.

OMIT HOT-MIX ASPHALT SHOULDERS, 8" ON ALL HMA AND PCC SIDEROADS, ENTRANCES, AND CONCRETE GUTTER LOCATIONS

THE TOTAL QUANTITY OF PAINT PAVEMENT MARKING - LINE 4" CONSISTS OF 58,632 FEET OF WHITE AND 7,504 FEET OF YELLOW.

THE FOLLOWING MIXTURE REQUIREMENTS ARE APPLICABLE TO THIS PROJECT:

MIXTURE USE:	HMA SHOULDERS, 8" (BOTTOM 6" LIFT)
APPLICATION:	HOT-MIX ASPHALT SHOULDERS
PG GRADE:	PG 64-22
DESIGN AIR VOIDS:	4.0% @ NDESIGN = 30
MIXTURE COMPOSITION:	IL-19.0L
FRICTION AGGREGATE:	N/A

MIXTURE USE:	HMA SHOULDERS, 8" (TOP 2" LIFT)
APPLICATION:	HOT-MIX ASPHALT SHOULDERS
PG GRADE:	PG 64-22
DESIGN AIR VOIDS:	4.0% @ NDESIGN = 30
MIXTURE COMPOSITION:	IL-9.5L
FRICTION AGGREGATE:	N/A

THE FOLLOWING APPLICATION RATES HAVE BEEN USED TO CALCULATE PLAN QUANTITIES:

AGGREGATE WEDGE SHOULDERS	2.05 TONS/CU YD
---------------------------	-----------------

FILE NAME	USER NAME	DESIGNED	REVISED	STATE OF ILLINOIS DEPARTMENT OF TRANSPORTATION	INDEX OF SHEETS & GENERAL NOTES	F.A.S. RTE.	SECTION	COUNTY	TOTAL SHEETS	SHEET NO.
g:\11\084E810INTEG.illinois.gov\IDOT\Documents\IDOT Offices\District 7\Projects\74749\Drawings\084E810\0774749-shl-gennote.dwg	steffennk	DESIGNED -	REVISED -			2796	*	**	19	2
Default		CHECKED -	REVISED -		SCALE: N/A					
		DATE -	REVISED -		SHEET 1 OF 1 SHEETS					CONTRACT NO. 74749
										ILLINOIS FED. AID PROJECT

** FAYETTE & EFFINGHAM

805 2 30A

90% FEDERAL
10% STATE

SUMMARY OF QUANTITIES				CONSTRUCTION TYPE CODE	
CODE NO	ITEM	UNIT	TOTAL QUANTITIES	FAYETTE COUNTY	EFFINGHAM COUNTY
				0021	0021
20200600	EXCAVATING AND GRADING EXISTING SHOULDER	UNIT	579	250	329
48102100	AGGREGATE WEDGE SHOULDER, TYPE B	TON	2198	948	1250
48203029	HOT-MIX ASPHALT SHOULDERS, 8"	SQ YD	19297	8327	10970
64200108	SHOULDER RUMBLE STRIPS, 8 INCH	FOOT	45083	20044	25039
67100100	MOBILIZATION	LSUM	1	0.4	0.6
70100500	TRAFFIC CONTROL AND PROTECTION, STANDARD 701326	LSUM	1	0.4	0.6
70103815	TRAFFIC CONTROL SURVEILLANCE	CAL DA	18	7	11
* 78001110	PAINT PAVEMENT MARKING - LINE 4"	FOOT	66136	28406	37730
X4404260	PAVED SHOULDER REMOVAL (SPECIAL)	SQ YD	6432	2776	3656
X7015005	CHANGEABLE MESSAGE SIGN	CAL DA	28	14	14
Z0048665	RAILROAD PROTECTIVE LIABILITY INSURANCE	LSUM	1	1	

* SPECIALTY ITEM

** FAYETTE & EFFINGHAM

TYPICAL CROSS SECTIONS

STA. 1249+22 TO STA. 1463+33
 STA. 1463+33 TO STA. 1464+04 STR OMISSION
 STA. 1464+04 TO STA. 1549+37

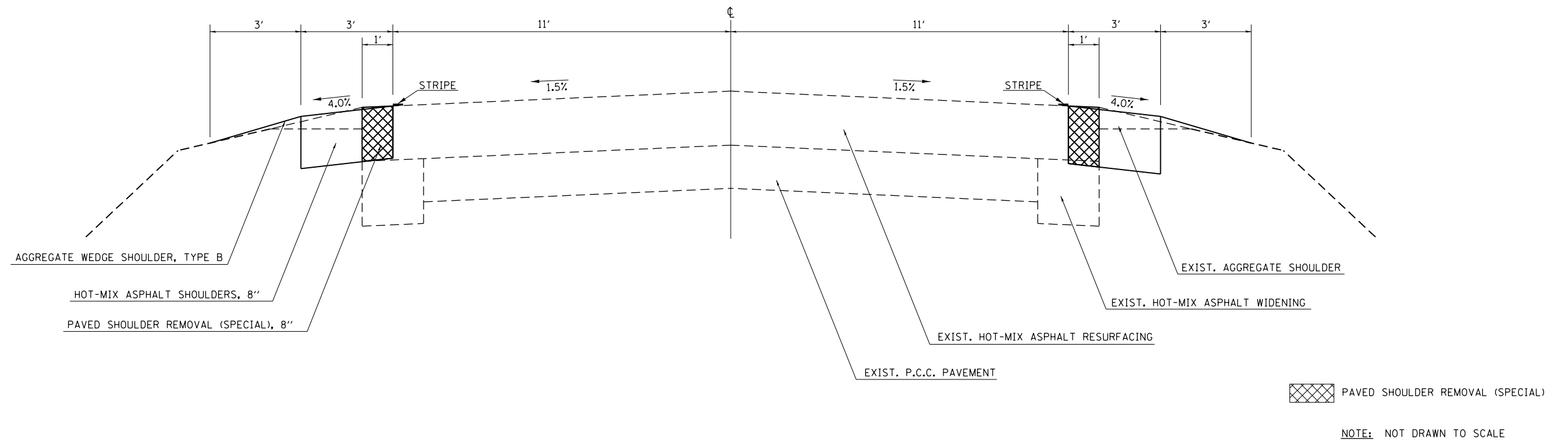

FILE NAME =	USER NAME = steffenmk	DESIGNED -	REVISED -
pw:\IL\084EBIDINTEG.illinois.gov\PIWIDOT\Documents\DOT Offices\District 7\Projects\7479\Drawings\CAD\Sheets\0774749-sht-typical.dwg		DRAWN -	REVISED -
Default	PLOT SCALE = 100.0000' / 1in.	CHECKED -	REVISED -
	PLOT DATE = 8/9/2016	DATE -	REVISED -

**STATE OF ILLINOIS
 DEPARTMENT OF TRANSPORTATION**

TYPICAL SECTIONS			
SCALE: N/A	SHEET 1	OF 1 SHEETS	STA. TO STA.

F.A.S. RTE.	SECTION	COUNTY	TOTAL SHEETS	SHEET NO.
2796	.	**	19	4
• D7 HMA SAFETY SHLD 2017-2			CONTRACT NO. 74749	
ILLINOIS FED. AID PROJECT				

** FAYETTE & EFFINGHAM

SHOULDER SCHEDULE			LENGTH	SIDE	EXCAVATING & GRADING EXISTING SHOULDER	PAVED SHOULDER REMOVAL (SPECIAL)	HOT-MIX ASPHALT SHOULDERS, 8"	SHOULDER RUMBLE STRIPS, 8"	AGGREGATE WEDGE SHOULDER, TYPE B
STATION	TO	STATION	FOOT	-	UNIT	SO YD	SO YD	FOOT	TON
FAYETTE COUNTY									
1249+22	TO	1376+16.7	12695	RT	124.8	1386.6	4159.9	9708.0	473.8
1249+22	TO	1376+16.7	12695	LT	125.0	1389.1	4167.3	10336.0	474.6
FAYETTE TOTALS:			-	-	249.8	2775.7	8327.2	20044.0	948.4
EFFINGHAM COUNTY									
1376+16.7	TO	1463+33	8716	RT	82.7	918.7	2756.1	8242.0	313.9
1463+33	TO	1464+04	71	RT	STR OMISSION				
1464+04	TO	1547+93	8389	RT	81.6	906.2	2718.7	4514.0	309.6
1376+16.7	TO	1463+33	8716	LT	84.6	940.6	2821.7	7784.0	321.4
1463+33	TO	1464+04	71	LT	STR OMISSION				
1464+04	TO	1549+37	8533	LT	80.2	891.1	2673.3	4499.0	304.5
EFFINGHAM TOTALS:			-	-	329.1	3656.6	10969.8	25039.0	1249.4
PROJECT TOTALS:			59886	-	579	6432	19297	45083	2198

PAVEMENT MARKING SCHEDULE				PAINT PAVEMENT MARKING - LINE 4"
STATION	TO	STATION	FOOT	
FAYETTE COUNTY				
1249+22	TO	1376+16.7	28406.4	
EFFINGHAM COUNTY				
1376+16.7	TO	1549+37	37729.4	
TOTAL =			66136	

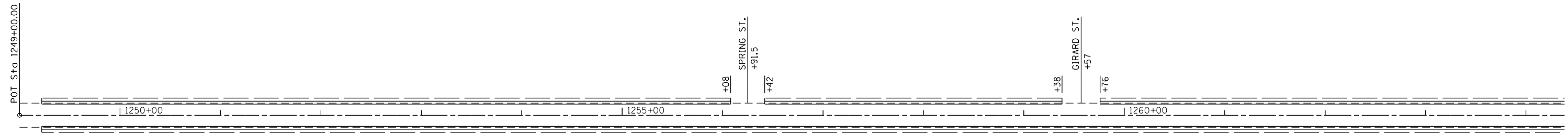

NOTE: SHOULDER OMISSIONS ARE NOT SHOWN FOR CE'S AND PE'S.



NOTE: SHOULDER OMISSIONS ARE NOT SHOWN FOR CE'S AND PE'S.

FILE NAME =	USER NAME = steffenmk	DESIGNED -	REVISED -
p:\11084EBIDINTEG\illinois.gov\PWIDOT\Documents\IDOT Offices\District 7\Projects\74749\Drawings\CAD\Drawings\1274749-sht-plan.dgn		DRAWN -	REVISED -
Default	PLOT SCALE = 100.0000' / in.	CHECKED -	REVISED -
	PLOT DATE = 8/9/2016	DATE -	REVISED -

**STATE OF ILLINOIS
DEPARTMENT OF TRANSPORTATION**

PLAN SHEETS

SCALE: 50 SHEET 1 OF 10 SHEETS STA. 1249+00 TO STA. 1279+00

F.A.S. RTE.	SECTION	COUNTY	TOTAL SHEETS	SHEET NO.
2796	.	**	19	6
• D7 HMA SAFETY SHLD 2017-2			CONTRACT NO. 74749	
ILLINOIS FED. AID PROJECT				

•• FAYETTE & EFFINGHAM

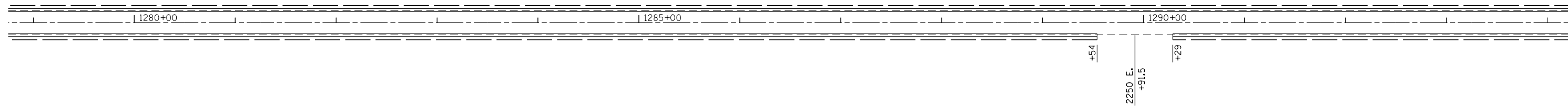

NOTE: SHOULDER OMISSIONS ARE NOT SHOWN FOR CE'S AND PE'S.



NOTE: SHOULDER OMISSIONS ARE NOT SHOWN FOR CE'S AND PE'S.

FILE NAME =	USER NAME = steffenmk	DESIGNED -	REVISED -
p:\11\084EBIDINTEG\illinois.gov\PWIDOT\Documents\IDOT Offices\District 7\Projects\74749\CAD\Drawings\74749-1309+00.dwg		DRAWN -	REVISED -
Default	PLOT SCALE = 100.0000' / 1in.	CHECKED -	REVISED -
	PLOT DATE = 8/9/2016	DATE -	REVISED -

**STATE OF ILLINOIS
DEPARTMENT OF TRANSPORTATION**

PLAN SHEETS

SCALE: 50 SHEET 2 OF 10 SHEETS STA. 1279+00 TO STA. 1309+00

F.A.S. RTE.	SECTION	COUNTY	TOTAL SHEETS	SHEET NO.
2796	.	**	19	7
• D7 HMA SAFETY SHLD 2017-2			CONTRACT NO. 74749	
ILLINOIS FED. AID PROJECT				

** FAYETTE & EFFINGHAM

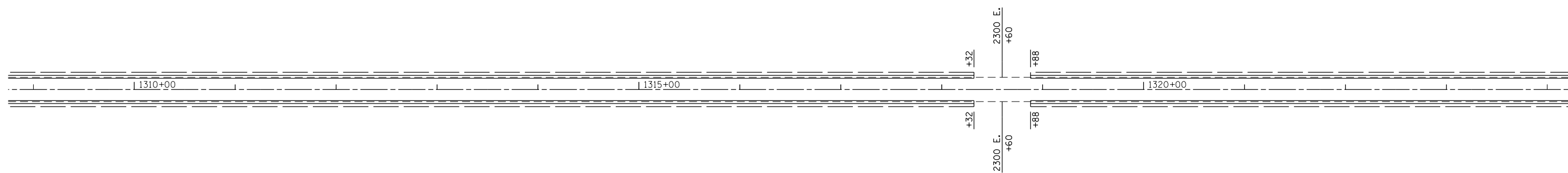

NOTE: SHOULDER OMISSIONS ARE NOT SHOWN FOR CE'S AND PE'S.



NOTE: SHOULDER OMISSIONS ARE NOT SHOWN FOR CE'S AND PE'S.

FILE NAME =	USER NAME = steffenmk	DESIGNED -	REVISED -
p:\11\084EBIDINTEG.illinois.gov\PWIDOT\Documents\IDOT Offices\District 7\Projects\74749\Drawings\CAD\Drawings\74749-sht-plan.dgn		DRAWN -	REVISED -
Default	PLOT SCALE = 100.0000' / in.	CHECKED -	REVISED -
	PLOT DATE = 8/9/2016	DATE -	REVISED -

**STATE OF ILLINOIS
DEPARTMENT OF TRANSPORTATION**

PLAN SHEETS

SCALE: 50 SHEET 3 OF 10 SHEETS STA. 1309+00 TO STA. 1339+00

		•• FAYETTE & EFFINGHAM	
F.A.S. RTE.	SECTION	COUNTY	TOTAL SHEETS
2796	•	••	19
• D7 HMA SAFETY SHLD 2017-2		CONTRACT NO. 74749	
ILLINOIS FED. AID PROJECT			

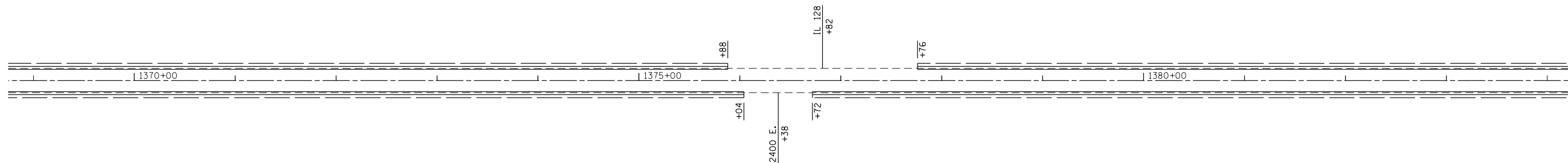

NOTE: SHOULDER OMISSIONS ARE NOT SHOWN FOR CE'S AND PE'S.



NOTE: SHOULDER OMISSIONS ARE NOT SHOWN FOR CE'S AND PE'S.

FILE NAME =	USER NAME = steffenmk	DESIGNED -	REVISED -
p:\11\084EBIDINTEG.illinois.gov\PIWIDOT\Documents\IDOT Offices\District 7\Projects\74749\Drawings\CAD\Sheets\0774749-sht-plan.dgn		CHECKED -	REVISED -
Default	PLOT SCALE = 100.0000' / in.	DATE -	REVISED -
	PLOT DATE = 8/9/2016		

**STATE OF ILLINOIS
DEPARTMENT OF TRANSPORTATION**

PLAN SHEETS

SCALE: 50 SHEET 5 OF 10 SHEETS STA. 1369+00 TO STA. 1399+00

F.A.S. RTE.	SECTION	COUNTY	TOTAL SHEETS	SHEET NO.
2796	.	**	19	10
• D7 HMA SAFETY SHLD 2017-2			CONTRACT NO. 74749	
ILLINOIS FED. AID PROJECT				

** FAYETTE & EFFINGHAM



NOTE: SHOULDER OMISSIONS ARE NOT SHOWN FOR CE'S AND PE'S.



NOTE: SHOULDER OMISSIONS ARE NOT SHOWN FOR CE'S AND PE'S.

FILE NAME =	USER NAME = steffenmk	DESIGNED -	REVISED -
p:\11\084EBIDINTEG.illinois.gov\PWIDOT\Documents\IDOT Offices\District 7\Projects\7479\Drawings\CAD\Drawings\7479-sht-plan.dgn		CHECKED -	REVISED -
Default	PLOT DATE = 8/9/2016	DATE -	REVISED -

**STATE OF ILLINOIS
DEPARTMENT OF TRANSPORTATION**

PLAN SHEETS

SCALE: 50 SHEET 6 OF 10 SHEETS STA. 1399+00 TO STA. 1429+00

F.A.S. RTE.	SECTION	COUNTY	TOTAL SHEETS	SHEET NO.
2796	.	**	19	11
• D7 HMA SAFETY SHLD 2017-2			CONTRACT NO. 74749	
ILLINOIS FED. AID PROJECT				

** FAYETTE & EFFINGHAM

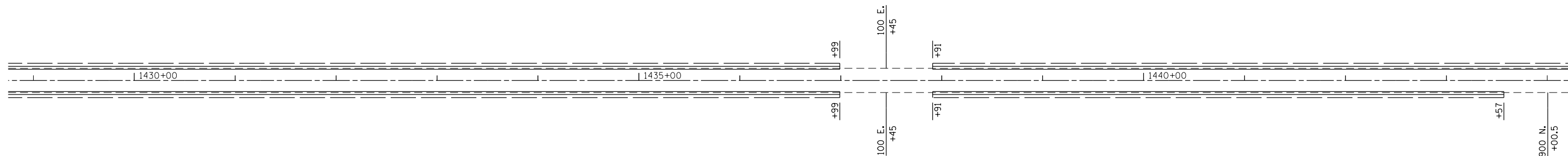

NOTE: SHOULDER OMISSIONS ARE NOT SHOWN FOR CE'S AND PE'S.

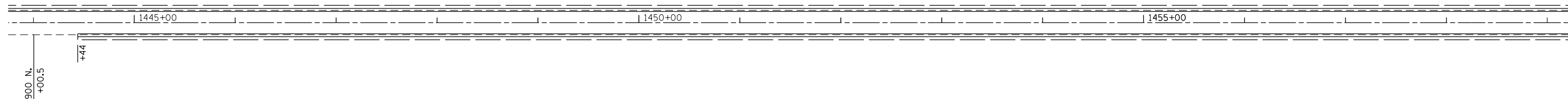

NOTE: SHOULDER OMISSIONS ARE NOT SHOWN FOR CE'S AND PE'S.

FILE NAME =	USER NAME = steffenmk	DESIGNED -	REVISED -
p:\11\084EBIDINTEG.illinois.gov\PIWIDOT\Documents\IDOT Offices\District 7\Projects\7479\Drawings\CAD\Sheets\0774749-sht-plan.dgn		DRAWN -	REVISED -
Default	PLOT SCALE = 100.0000' / in.	CHECKED -	REVISED -
	PLOT DATE = 8/9/2016	DATE -	REVISED -

**STATE OF ILLINOIS
DEPARTMENT OF TRANSPORTATION**

PLAN SHEETS

SCALE: 50 SHEET 7 OF 10 SHEETS STA. 1429+00 TO STA. 1459+00

F.A.S. RTE.	SECTION	COUNTY	TOTAL SHEETS	SHEET NO.
2796	.	**	19	12
• D7 HMA SAFETY SHLD 2017-2			CONTRACT NO. 74749	
ILLINOIS FED. AID PROJECT				

** FAYETTE & EFFINGHAM

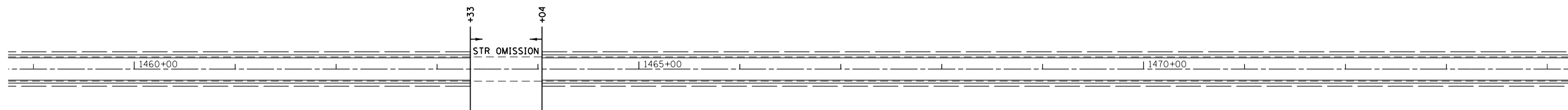

NOTE: SHOULDER OMISSIONS ARE NOT SHOWN FOR CE'S AND PE'S.

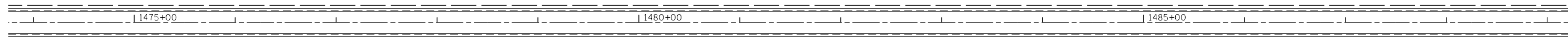

NOTE: SHOULDER OMISSIONS ARE NOT SHOWN FOR CE'S AND PE'S.

FILE NAME =	USER NAME = steffenmk	DESIGNED -	REVISED -
p:\11\084EBIDINTEG\illinois.gov\PWIDOT\Documents\IDOT Offices\District 7\Projects\74749\Drawings\CAD\Sheets\0774749-sht-plan.dgn		DRAWN -	REVISED -
Default	PLOT SCALE = 100.0000' / in.	CHECKED -	REVISED -
	PLOT DATE = 8/9/2016	DATE -	REVISED -

**STATE OF ILLINOIS
DEPARTMENT OF TRANSPORTATION**

PLAN SHEETS

SCALE: 50 SHEET 8 OF 10 SHEETS STA. 1459+00 TO STA. 1489+00

F.A.S. RTE.	SECTION	COUNTY	TOTAL SHEETS	SHEET NO.
2796	.	**	19	13
• D7 HMA SAFETY SHLD 2017-2			CONTRACT NO. 74749	
ILLINOIS FED. AID PROJECT				

** FAYETTE & EFFINGHAM

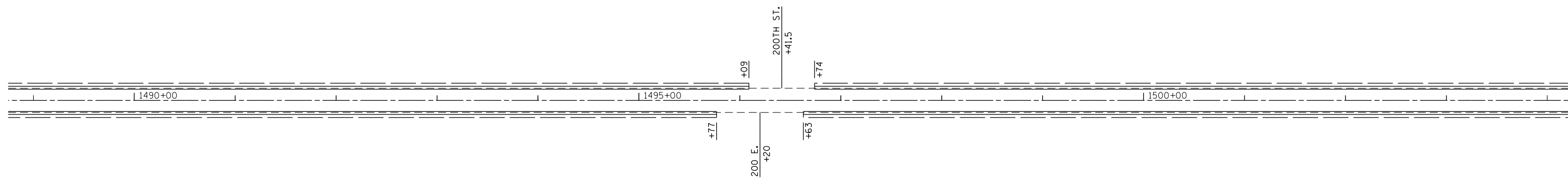

NOTE: SHOULDER OMISSIONS ARE NOT SHOWN FOR CE'S AND PE'S.



NOTE: SHOULDER OMISSIONS ARE NOT SHOWN FOR CE'S AND PE'S.

FILE NAME =	USER NAME = steffenmk	DESIGNED -	REVISED -
p:\11\084EBIDINTEG.illinois.gov\PIWIDOT\Documents\IDOT Offices\District 7\Projects\7479\Drawings\CAD\Sheets\0774749-sht-plan.dgn		CHECKED -	REVISED -
Default	PLOT DATE = 8/9/2016	DATE -	REVISED -

**STATE OF ILLINOIS
DEPARTMENT OF TRANSPORTATION**

PLAN SHEETS

SCALE: 50 SHEET 9 OF 10 SHEETS STA. 1489+00 TO STA. 1519+00

F.A.S. RTE.	SECTION	COUNTY	TOTAL SHEETS	SHEET NO.
2796	.	**	19	14
• D7 HMA SAFETY SHLD 2017-2			CONTRACT NO. 74749	
ILLINOIS FED. AID PROJECT				

** FAYETTE & EFFINGHAM

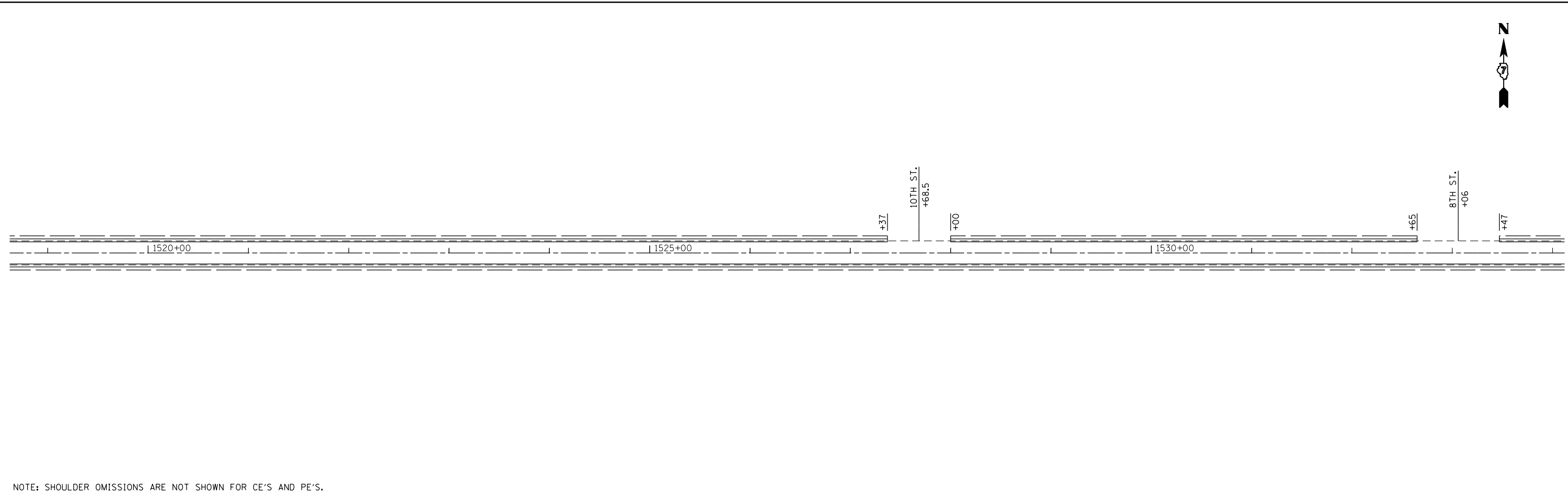

NOTE: SHOULDER OMISSIONS ARE NOT SHOWN FOR CE'S AND PE'S.

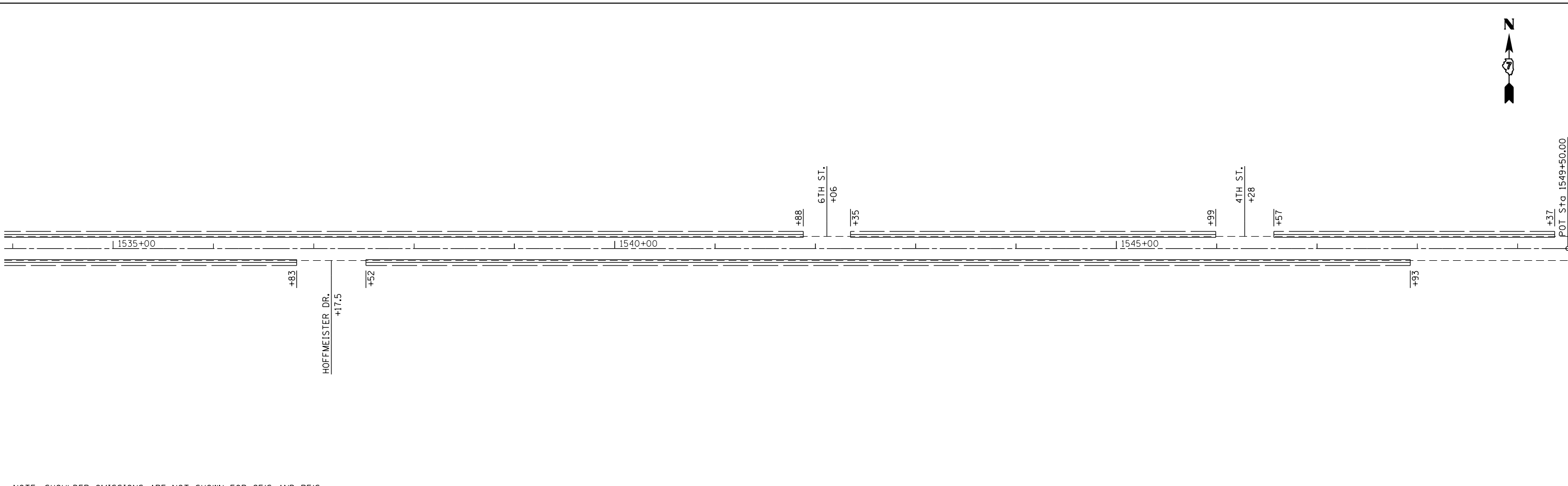

NOTE: SHOULDER OMISSIONS ARE NOT SHOWN FOR CE'S AND PE'S.

FILE NAME =	USER NAME = steffenmk	DESIGNED -	REVISED -
pw:\IL\084EBIDINTEG.illinois.gov\PIWIDOT\Documents\IDOT Offices\District 7\Projects\7479\Drawings\CAD\Sheets\0774749-sht-plan.dgn		DRAWN -	REVISED -
Default	PLOT SCALE = 100.0000' / in.	CHECKED -	REVISED -
	PLOT DATE = 8/9/2016	DATE -	REVISED -

**STATE OF ILLINOIS
DEPARTMENT OF TRANSPORTATION**

PLAN SHEETS

SCALE: 50 SHEET 10 OF 10 SHEETS STA. 1519+00 TO STA. 1549+50

F.A.S. R.E.	SECTION	COUNTY	TOTAL SHEETS	SHEET NO.
2796	.	**	19	15
• D7 HMA SAFETY SHLD 2017-2			CONTRACT NO. 74749	
ILLINOIS FED. AID PROJECT				

** FAYETTE & EFFINGHAM

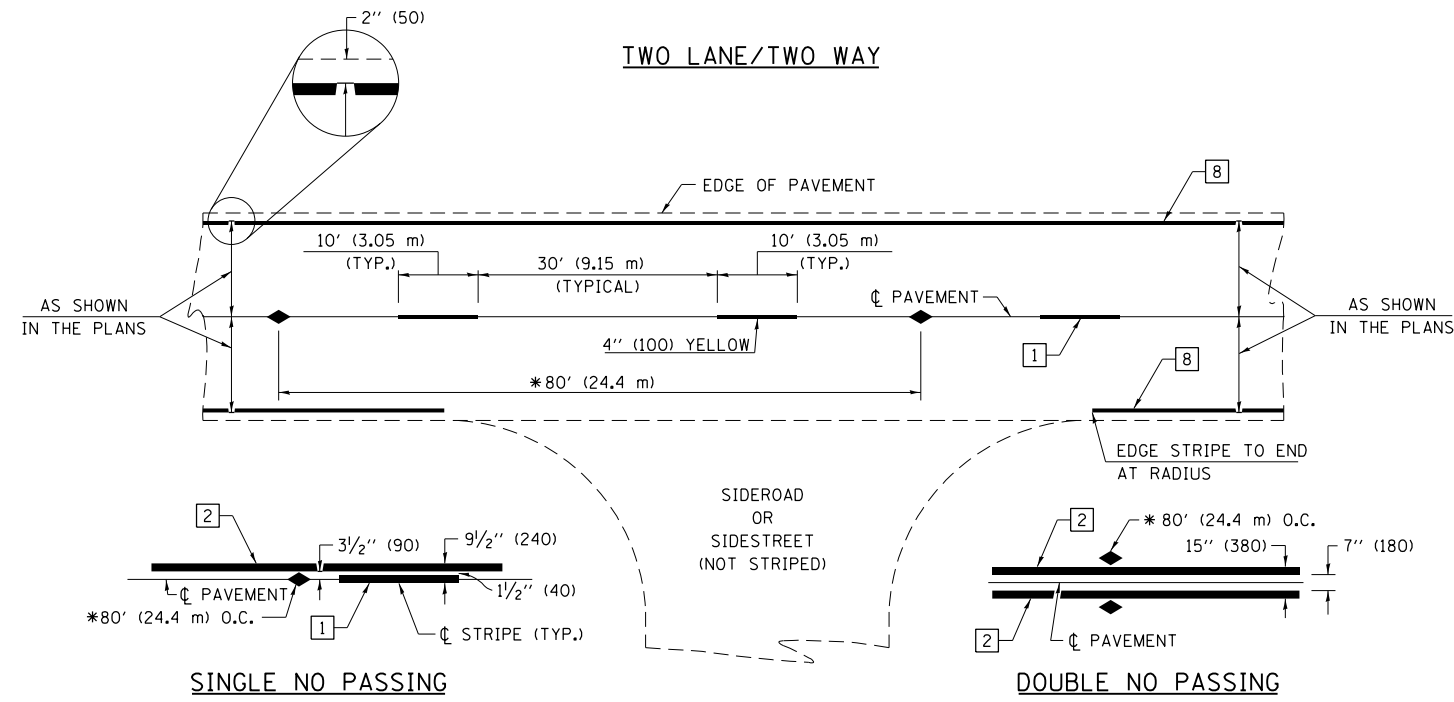

* REDUCE TO 40' (12.2 m) O.C. ON CURVES WITH POSTED OR ADVISORY SPEEDS OF 45 mph (70 km/h) OR LESS.

PAVEMENT MARKING LEGEND

- 1 4" (100) SKIP-DASH (YELLOW)
- 2 4" (100) SOLID (YELLOW)
- 3 12" (300) DIAGONAL (YELLOW)
- 4 4" (100) DOUBLE YELLOW (NARROW)
- 5 12" (300) SOLID WHITE
- 6 RESERVED
- 7 6" (150) SKIP-DASH (WHITE)
- 8 4" (100) SOLID (WHITE)
- 9 12" (300) DIAGONAL (WHITE)
- 10 6" (150) SOLID (WHITE)
- 11 24" (600) STOP BAR (WHITE)
- 12 8" (200) SOLID (WHITE)
- 13 4" (100) PARKING WHITE

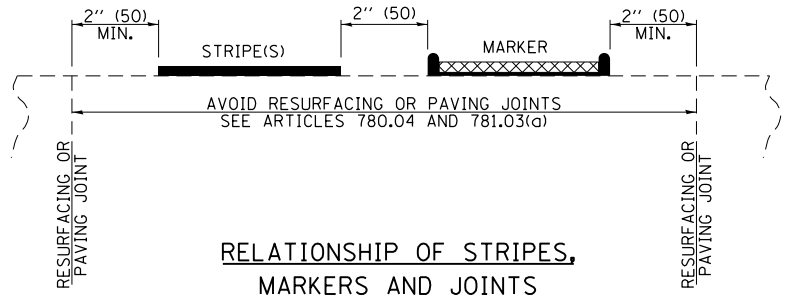

RELATIONSHIP OF STRIPES, MARKERS AND JOINTS

TYPICAL PAVEMENT MARKERS LEGEND

- ◆ TWO-WAY AMBER MARKER
- ▶ ONE-WAY AMBER MARKER
- ▷ ONE-WAY CRYSTAL MARKER

RAISED REFLECTIVE PAVEMENT MARKERS

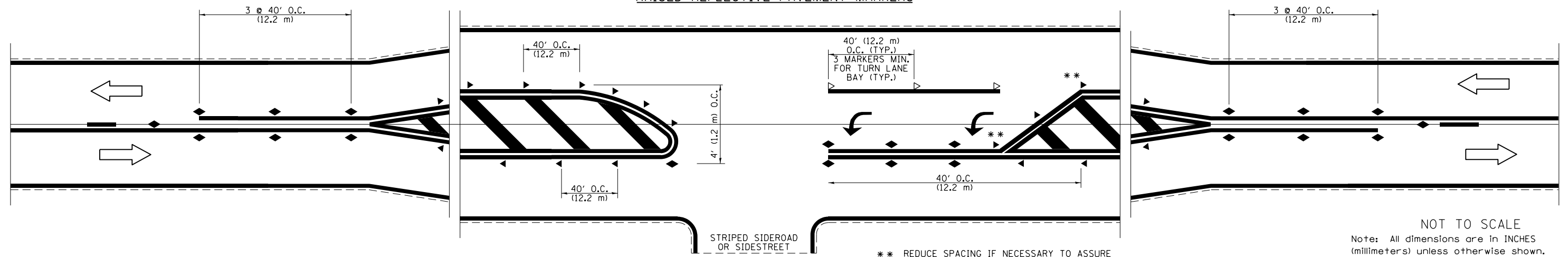

NOT TO SCALE
Note: All dimensions are in INCHES (millimeters) unless otherwise shown.

FILE NAME =	USER NAME = steffenmk	DESIGNED -	REVISED -
pw:\IL\084EBIDINTEG.illinois.gov\PIWIDOT\Documents\IDOT Offices\District 7\Projects\7479\Drawings\CABsheets\0774749-shd-details.dgn		CHECKED -	REVISED -
	PLOT SCALE = 2.0000' / in.	DATE -	REVISED -
	PLOT DATE = 8/9/2016		

**STATE OF ILLINOIS
DEPARTMENT OF TRANSPORTATION**

**PAVEMENT MARKING AND RAISED REFLECTIVE PAVEMENT MARKERS
(RURAL & URBAN APPLICATIONS)**

SCALE: N/A SHEET NO. 1 OF 4 SHEETS STA. TO STA.

DISTRICT 7 DETAIL NO. 78000001				
F.A.S. RTE.	SECTION	COUNTY	TOTAL SHEETS	SHEET NO.
2796	.	**	19	16
• D7 HMA SAFETY SHLD 2017-2			CONTRACT NO. 74749	
ILLINOIS FED. AID PROJECT				

•• FAYETTE & EFFINGHAM

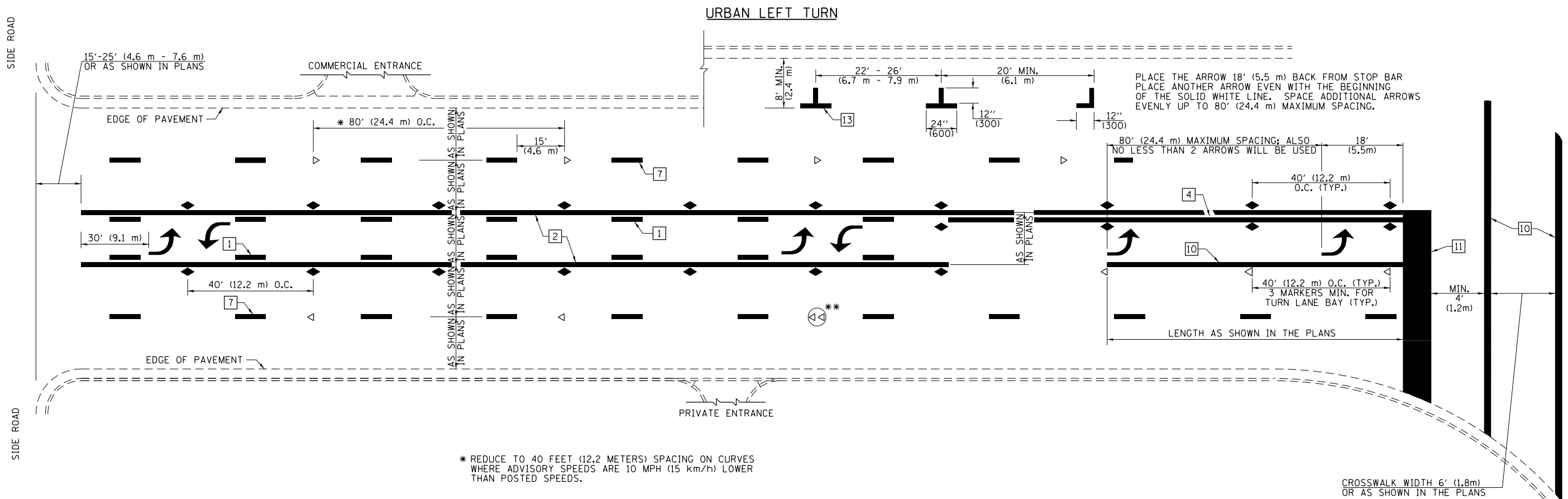

PLACE THE ARROW 18' (5.5 m) BACK FROM STOP BAR
 PLACE ANOTHER ARROW EVEN WITH THE BEGINNING
 OF THE SOLID WHITE LINE. SPACE ADDITIONAL ARROWS
 EVENLY UP TO 80' (24.4 m) MAXIMUM SPACING.

* REDUCE TO 40 FEET (12.2 METERS) SPACING ON CURVES
 WHERE ADVISORY SPEEDS ARE 10 MPH (15 km/h) LOWER
 THAN POSTED SPEEDS.

** DOUBLE LANE LINE MARKERS SHALL BE SPECIFIED
 AND SPACED AS SHOWN IN HIGHWAY STANDARD
 781001 FOR MULTI-LANE DIVIDED AND UNDIVIDED
 HIGHWAYS.

PAVEMENT MARKING LEGEND

- 1 4" (100) SKIP-DASH (YELLOW)
- 2 4" (100) SOLID (YELLOW)
- 3 12" (300) DIAGONAL (YELLOW)
- 4 4" (100) DOUBLE YELLOW (NARROW)
- 5 12" (300) SOLID WHITE
- 6 RESERVED
- 7 6" (150) SKIP-DASH (WHITE)
- 8 4" (100) SOLID (WHITE)
- 9 12" (300) DIAGONAL (WHITE)
- 10 6" (150) SOLID (WHITE)
- 11 24" (600) STOP BAR (WHITE)
- 12 8" (200) SOLID (WHITE)
- 13 4" (100) PARKING WHITE

GENERAL NOTES

1. TURN ARROW PAIRS SHALL BE PLACED AT 250' (75 m) INTERVALS AND SHALL BE EVENLY SPACED BETWEEN BOTH ENDS OF THE BIDIRECTIONAL LEFT TURN LANE. USE A MINIMUM OF TWO PAIRS PER BLOCK.
2. THE SOLID YELLOW PAVEMENT MARKINGS [2] SHOULD GENERALLY START OR END NEAR THE RADIUS POINT OF EACH STREET RETURN EXCEPT WHERE ONE OR BOTH ENDS WOULD INCLUDE STOP BARS.
3. THE SKIP-DASH PAVEMENT MARKINGS [1] OR [7] SHOULD BE CENTERED BETWEEN BOTH ENDS OF EACH CITY BLOCK AND SHALL BE PLACED SO THEY LINE UP ACROSS FROM EACH OTHER.
4. USE LARGE ARROW SIZE FOR BOTH RURAL AND URBAN LOCATIONS. (SEE LAST PAGE OF SECTION 780x FOR SYMBOLS TABLE)
5. LANE LINE EXTENSIONS SHALL BE THE SAME COLOR AND WIDTH AS THE LANE LINE BEING EXTENDED.

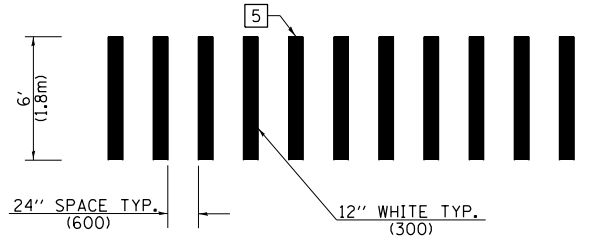

**CROSSWALK DETAIL
 (DECATUR CITY LIMITS ONLY)**

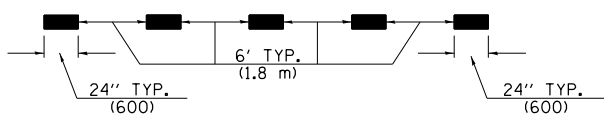

LANE LINE EXTENSIONS

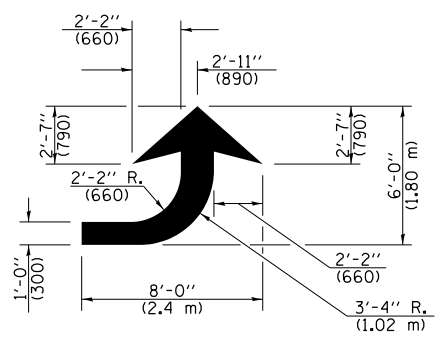

LEFT ARROW

REVERSE FOR RIGHT ARROW
 AREA = 15.6 SQ. FT. (1.47 m²)
 (WHITE)

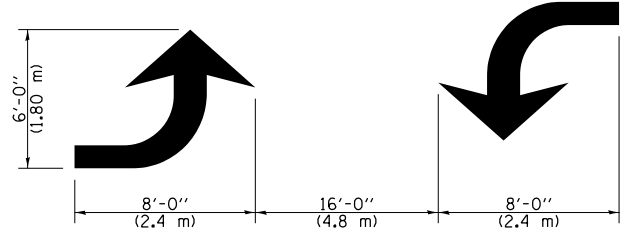

**TYPICAL DOUBLE
 TURN ARROWS (WHITE)**

NOT TO SCALE

Note: All dimensions are in INCHES
 (millimeters) unless otherwise shown.

FILE NAME =	USER NAME = steffenmk	DESIGNED -	REVISED -
pw:\11\084EBIDINTEG\11\illinois.gov\PWIDOT\Documents\DOT Offices\District 7\Projects\747474\Drawings\CABsheets\0774749-sht-details.dwg		CHECKED -	REVISED -
		DATE -	REVISED -

**STATE OF ILLINOIS
 DEPARTMENT OF TRANSPORTATION**

**PAVEMENT MARKING AND RAISED REFLECTIVE PAVEMENT MARKERS
 (RURAL & URBAN APPLICATIONS)**

SCALE: N/A SHEET NO. 2 OF 4 SHEETS STA. TO STA.

DISTRICT 7 DETAIL NO. 78000001				
F.A.S. RTE.	SECTION	COUNTY	TOTAL SHEETS	SHEET NO.
2796	.	**	19	17
• D7 HMA SAFETY SHLD 2017-2			CONTRACT NO. 74749	
ILLINOIS FED. AID PROJECT				

•• FAYETTE & EFFINGHAM

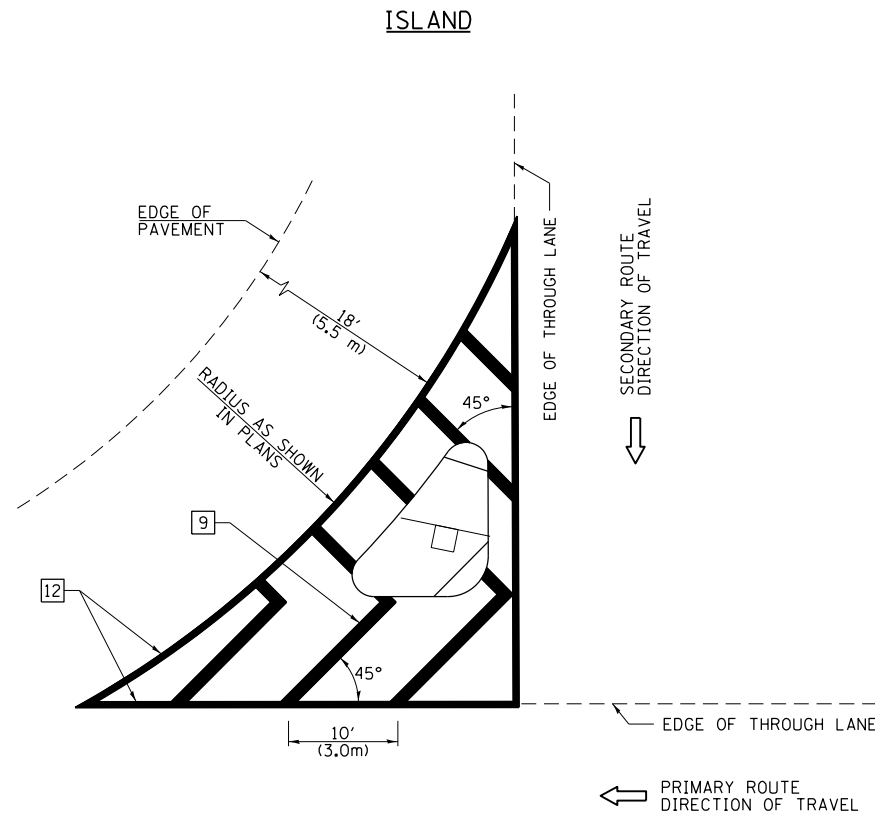

GENERAL NOTES

1. RAISED AND CORRUGATED MEDIANS SHALL BE OUTLINED WITH [2] IF PRESENT.
2. SOME OF THE INFORMATION INCLUDED WITH THIS DETAIL MAY NOT BE APPLICABLE TO THIS IMPROVEMENT.
3. PAVEMENT MARKINGS ARE TO BE EXTENDED THROUGH OMISSIONS WHEN APPLICABLE.
4. FINAL PAVEMENT MARKINGS SHALL BE IN PLACE PRIOR TO PLACING ANY RAISED REFLECTIVE PAVEMENT MARKERS.
5. THE FOLLOWING CRITERIA SHALL BE USED FOR SELECTING THE DIAGONAL PAVEMENT MARKING SPACING:

< 30 MPH (< 50 km/h)	15' (4.5 m)
30-45 MPH (50-75 km/h)	20' (6.0 m)
> 45 MPH (> 75 km/h)	30' (9.0 m)

PAVEMENT MARKING LEGEND

- [1] 4" (100) SKIP-DASH (YELLOW)
- [2] 4" (100) SOLID (YELLOW)
- [3] 12" (300) DIAGONAL (YELLOW)
- [4] 4" (100) DOUBLE YELLOW (NARROW)
- [5] 12" (300) SOLID WHITE
- [6] RESERVED
- [7] 6" (150) SKIP-DASH (WHITE)
- [8] 4" (100) SOLID (WHITE)
- [9] 12" (300) DIAGONAL (WHITE)
- [10] 6" (150) SOLID (WHITE)
- [11] 24" (600) STOP BAR (WHITE)
- [12] 8" (200) SOLID (WHITE)
- [13] 4" (100) PARKING WHITE

RURAL LEFT TURN STRIPING

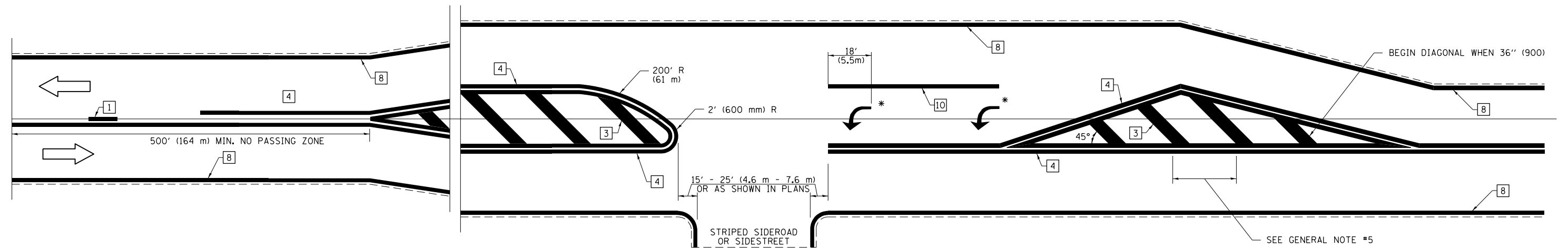

* PLACE AN ARROW 18' (5.5 m) BACK FROM STOP BAR. PLACE ANOTHER ARROW EVEN WITH THE BEGINNING OF THE SOLID WHITE LINE. SPACE ADDITIONAL ARROWS EVENLY UP TO 80' (24.4 m) MAXIMUM SPACING. USE MINIMUM OF 2 ARROWS.

SEE GENERAL NOTE #5

NOT TO SCALE

Note: All dimensions are in INCHES (millimeters) unless otherwise shown.

DISTRICT 7 DETAIL NO. 7800001

FILE NAME =	USER NAME = steffenmk	DESIGNED -	REVISED -
pw:\IL\084EBIDINTEG\illinois.gov\PWIDOT\Documents\IDOT Offices\District 7\Projects\7479\Drawings\CABsheets\0774749-sht-details.dwg		DRAWN -	REVISED -
	PLOT SCALE = 2.0000" / in.	CHECKED -	REVISED -
	PLOT DATE = 8/9/2016	DATE -	REVISED -

**STATE OF ILLINOIS
DEPARTMENT OF TRANSPORTATION**

**PAVEMENT MARKING AND RAISED REFLECTIVE PAVEMENT MARKERS
(RURAL & URBAN APPLICATIONS)**

SCALE: N/A SHEET NO. 3 OF 4 SHEETS STA. TO STA.

F.A.S. RTE.	SECTION	COUNTY	TOTAL SHEETS	SHEET NO.
2796	.	..	19	18
• D7 HMA SAFETY SHLD 2017-2			CONTRACT NO. 74749	
ILLINOIS FED. AID PROJECT				

•• FAYETTE & EFFINGHAM

PAVEMENT MARKINGS AT RAILROAD-HIGHWAY GRADE CROSSING

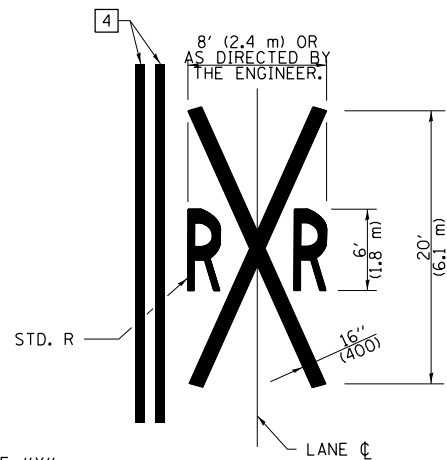
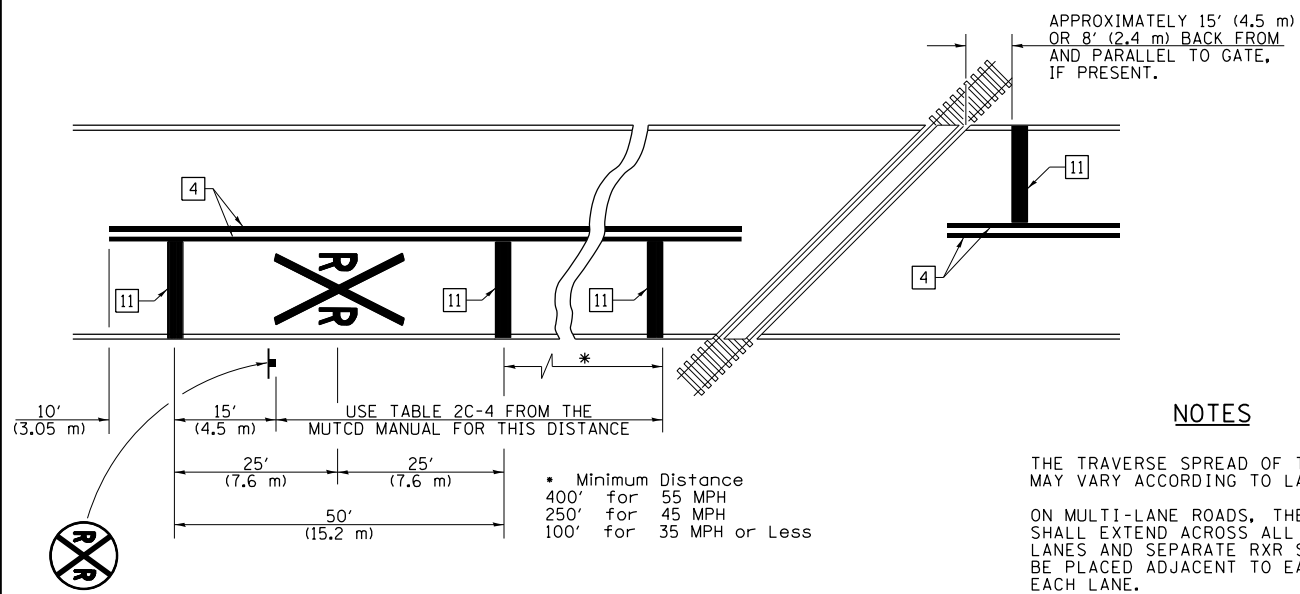

NOTES

THE TRAVERSE SPREAD OF THE "X" MAY VARY ACCORDING TO LANE WIDTH.

ON MULTI-LANE ROADS, THE STOP LINES SHALL EXTEND ACROSS ALL APPROACH LANES AND SEPARATE RXR SYMBOLS SHALL BE PLACED ADJACENT TO EACH OTHER IN EACH LANE.

WHEN THE PAVEMENT MARKING SYMBOL IS USED, A PORTION OF THE SYMBOL SHOULD BE LOCATED DIRECTLY ADJACENT TO THE ADVANCE WARNING SIGN (W10-1) AS PLACED BY TABLE II-1, CONDITION B OF THE MUTCD.

PAVEMENT MARKING LEGEND

- 1 4" (100) SKIP-DASH (YELLOW)
- 2 4" (100) SOLID (YELLOW)
- 3 12" (300) DIAGONAL (YELLOW)
- 4 4" (100) DOUBLE YELLOW (NARROW)
- 5 12" (300) SOLID WHITE
- 6 RESERVED
- 7 6" (150) SKIP-DASH (WHITE)
- 8 4" (100) SOLID (WHITE)
- 9 12" (300) DIAGONAL (WHITE)
- 10 6" (150) SOLID (WHITE)
- 11 24" (600) STOP BAR (WHITE)
- 12 8" (200) SOLID (WHITE)
- 13 4" (100) PARKING WHITE

RAILROAD CROSSING WITH INTERCONNECT ONLY

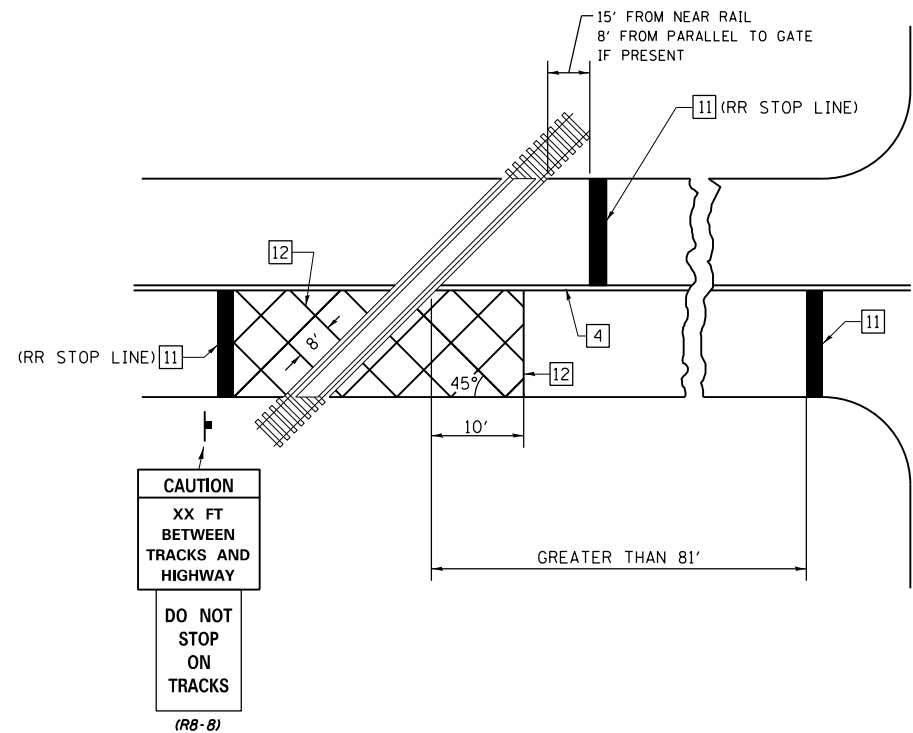

RAILROAD CROSSING WITH INTERCONNECT AND PRE-SIGNALS

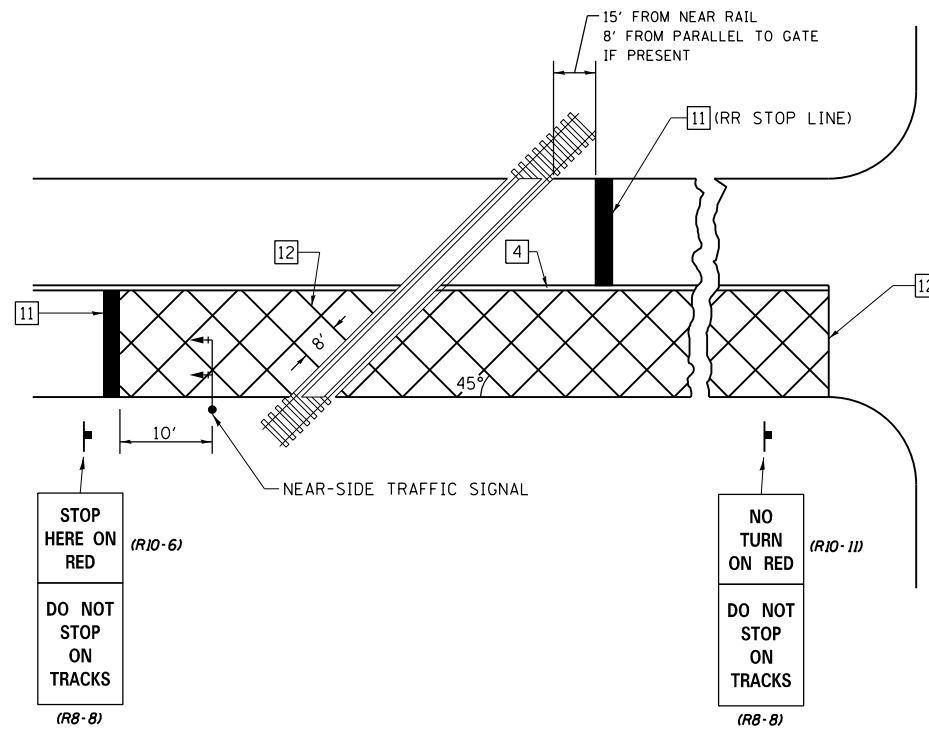

GENERAL NOTES

- SUPPLEMENTAL PAVEMENT MARKINGS TO BE INSTALLED ONLY ON APPROACHES TO INTERSECTIONS CONTROLLED BY TRAFFIC SIGNALS WHICH ARE INTERCONNECTED WITH THE RAILROAD WARNING SIGNALS.
- EXTEND PAVEMENT MARKINGS TO THE INTERSECTION ONLY WHERE NEAR-SIDE TRAFFIC SIGNALS ARE USED.

SUPPLEMENTAL PAVEMENT MARKING TREATMENT FOR RAILROAD-HIGHWAY GRADE CROSSING

NOT TO SCALE

Note: All dimensions are in INCHES (millimeters) unless otherwise shown.

FILE NAME =	USER NAME = steffenmk	DESIGNED -	REVISED -
pw:\11\084EBIDINTEG.illinois.gov\PIWIDOT\Documents\IDOT Offices\District 7\Projects\7479\Drawings\CABsheets\0774749-sht-details.dwg		CHECKED -	REVISED -
		DATE -	REVISED -
PLOT SCALE = 2.0000' / in.			
PLOT DATE = 8/9/2016			

STATE OF ILLINOIS
DEPARTMENT OF TRANSPORTATION

PAVEMENT MARKING AND RAISED REFLECTIVE PAVEMENT MARKERS
(RURAL & URBAN APPLICATIONS)

SCALE: N/A SHEET NO. 4 OF 4 SHEETS STA. TO STA.

DISTRICT 7 DETAIL NO. 7800001

F.A.S. RTE.	SECTION	COUNTY	TOTAL SHEETS	SHEET NO.
2796	.	**	19	19
• D7 HMA SAFETY SHLD 2017-2			CONTRACT NO. 74749	
ILLINOIS FED. AID PROJECT				

•• FAYETTE & EFFINGHAM