

F.A.P. RTE.	SECTION	COUNTY	TOTAL SHEETS	SHEET NO.
303	134(B&B-2)R-1	LAKE	137	35
STA. 26+090 TO STA. 26+272				
FED. ROAD DIST. NO. 1		ILLINOIS	FED. AID PROJECT	
CONTRACT NO. 62037				







MAJOR WORK STAGE III:

- PAVE TO PROVIDE DESIGN PROFILE AND SUPERELEVATION ADJUSTMENTS.

NOTES:

- LOCATIONS OF TRAFFIC CONTROL SHALL BE IN ACCORDANCE WITH HIGHWAY STANDARD 701306. WORK SHALL NOT BEGIN UNTIL ALL TRAFFIC CONTROL DEVICES ARE IN PLACE AND APPROVED BY THE ENGINEER.
- THE CONTRACTOR SHALL MAINTAIN ACCESS TO PRIVATE AND COMMERCIAL ENTRANCES AND SIDESTREETS.

SYMBOLS

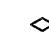
-  DRUM WITH STEADY BURNING MONODIRECTIONAL LIGHT. DRUMS ON TANGENT SHALL BE AT 15m CENTERS. DRUMS ON TAPER AND ON RADIUS RETURNS SHALL BE AT 7.6m CENTERS.
-  WORK AREA
-  DOUBLE VERTICAL PANEL
-  TYPE III BARRICADE WITH 2 FLASHING MONODIRECTIONAL LIGHTS EACH
-  SIGN
-  TEMPORARY CONCRETE BARRIER
-  IMPACT ATTENUATORS
-  CRYSTAL, BIDIRECTIONAL BARRIER WALL/GUARDRAIL MARKER

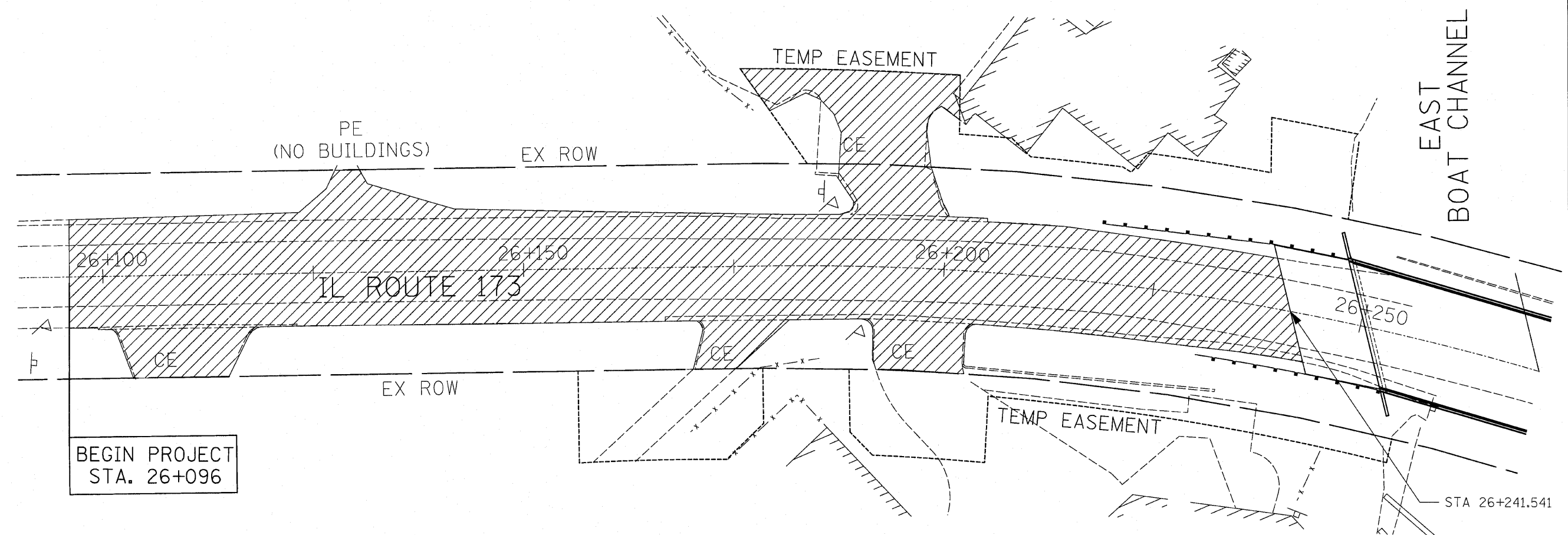
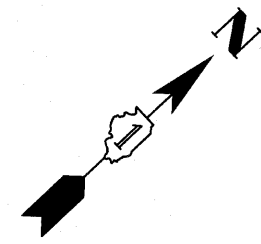

3116TRAFFEA3.DGN

REVISIONS		ILLINOIS DEPARTMENT OF TRANSPORTATION IL ROUTE 173 OVER EAST BOAT CHANNEL MAINTENANCE OF TRAFFIC STAGE III EAST BOAT CHANNEL
NAME	DATE	



SCALE: 1:250
DRAWN BY CLG
CHECKED BY JJD
DATE 3-8-10