

F.A.P. RTE.	SECTION	COUNTY	TOTAL SHEETS	SHEET NO.
303	134(B&B-2)R-1	LAKE	137	43
STA. 26+090 TO STA. 26+272				
FED. ROAD DIST. NO. 1		ILLINOIS	FED. AID PROJECT	
CONTRACT NO. 62037				

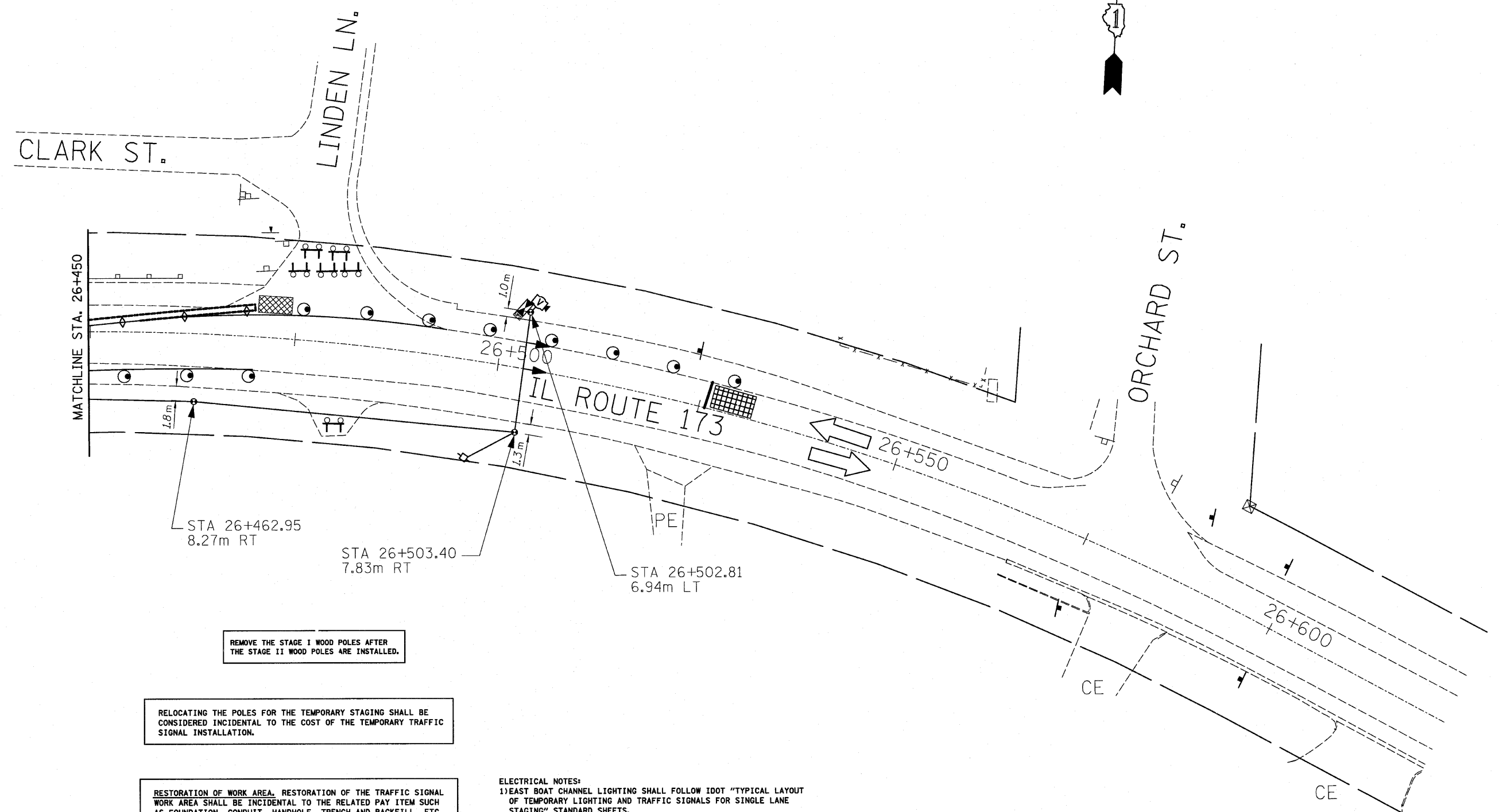

REMOVE THE STAGE I WOOD POLES AFTER THE STAGE II WOOD POLES ARE INSTALLED.

RELOCATING THE POLES FOR THE TEMPORARY STAGING SHALL BE CONSIDERED INCIDENTAL TO THE COST OF THE TEMPORARY TRAFFIC SIGNAL INSTALLATION.

RESTORATION OF WORK AREA. RESTORATION OF THE TRAFFIC SIGNAL WORK AREA SHALL BE INCIDENTAL TO THE RELATED PAY ITEM SUCH AS FOUNDATION, CONDUIT, HANDHOLE, TRENCH AND BACKFILL, ETC., AND NO EXTRA COMPENSATION SHALL BE ALLOWED. ALL ROADWAY SURFACES SUCH AS SHOULDERS, MEDIANS, SIDEWALKS, PAVEMENT, ETC. SHALL BE REPLACED IN KIND. ALL DAMAGE TO MOWED LAWNS SHALL BE REPLACED WITH AN APPROVED SOD, AND ALL DAMAGE TO UNMOWED FIELDS SHALL BE SEEDING IN ACCORDANCE WITH STANDARD SPECIFICATIONS 252 AND 250 RESPECTIVELY.

- ELECTRICAL NOTES:**
- 1) EAST BOAT CHANNEL LIGHTING SHALL FOLLOW IDOT "TYPICAL LAYOUT OF TEMPORARY LIGHTING AND TRAFFIC SIGNALS FOR SINGLE LANE STAGING" STANDARD SHEETS.
 - 2) WEST BOAT CHANNEL LIGHTING SHALL FOLLOW IDOT "TYPICAL LAYOUT OF TEMPORARY LIGHTING AND TRAFFIC SIGNALS FOR SINGLE LANE STAGING" STANDARD SHEETS, EXCEPT FOR POLE LOCATIONS.
 - 3) BOTH EAST AND WEST BOAT CHANNELS SHALL BE PAID AT THE CONTRACT SUM PRICE TEMPORARY LIGHTING FOR SINGLE LANE STAGING.

REVISIONS	
NAME	DATE

ILLINOIS DEPARTMENT OF TRANSPORTATION
 IL ROUTE 173 OVER EAST BOAT CHANNEL
TEMPORARY TRAFFIC SIGNAL INSTALLATION
STAGE II - SHEET 3 OF 3

SCALE: 1:250
 DRAWN BY CLG
 CHECKED BY JJD

DATE 3-8-10



3116TRAFFEA2.DGN