

F.A.P. RTE.	SECTION	COUNTY	TOTAL SHEETS	SHEET NO.
303	134(B&B-2)R-1	LAKE	137	48
STA. 26+050		TO STA. 26+400		
FED. ROAD DIST. NO.	ILLINOIS FED. AID PROJECT			

CONTRACT NO. 62037

LEGEND:

- ⊠ POWER POLE
- ⊠ LIGHT POLE

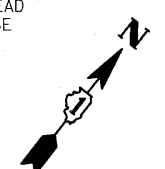
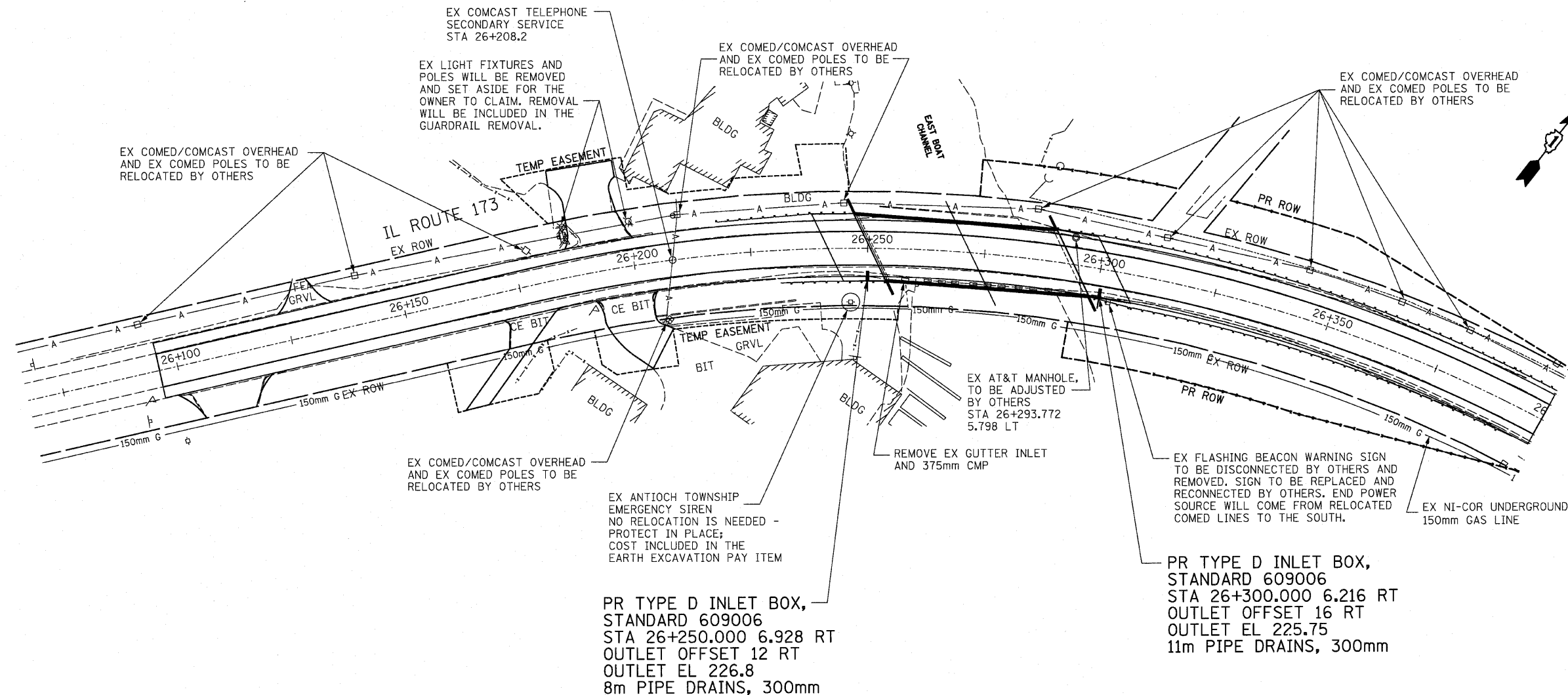

NOTE:

EXISTING AT&T FIBER OPTIC FACILITIES ON NORTH SIDE OF BRIDGE IN CONDUITS TO BE RELOCATED VIA DIRECTIONAL DRILLING OUTSIDE THE AREA OF THE PROPOSED BRIDGE PRIOR TO CONSTRUCTION BY OTHERS.

ABANDONED AT&T UTILITY CONDUITS ON NORTH SIDE OF BRIDGE TO BE REMOVED AND PAID FOR UNDER "REMOVAL OF EXISTING STRUCTURES" PAY ITEM.

PR TYPE D INLET BOX,
STANDARD 609006
STA 26+250.000 6.928 RT
OUTLET OFFSET 12 RT
OUTLET EL 226.8
8m PIPE DRAINS, 300mm

PR TYPE D INLET BOX,
STANDARD 609006
STA 26+300.000 6.216 RT
OUTLET OFFSET 16 RT
OUTLET EL 225.75
11m PIPE DRAINS, 300mm

REVISIONS	
NAME	DATE

ILLINOIS DEPARTMENT OF TRANSPORTATION
IL ROUTE 173 OVER EAST BOAT CHANNEL
EXISTING AND PROPOSED DRAINAGE AND UTILITIES

SCALE: 1:500
DRAWN BY: CLG
CHECKED BY: JJD

DATE: 3-8-10



SURGECAST UTILITY