

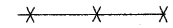





GENERAL EROSION CONTROL NOTES:

1. EROSION AND SEDIMENT CONTROL ON THE NORTH SIDE OF IL ROUTE 173 WILL OCCUR DURING NORTH SIDE CONSTRUCTION AND ON THE SOUTH SIDE DURING SOUTH SIDE CONSTRUCTION.
2. THE CONTRACTOR WILL BE REQUIRED TO SUBMIT CERTIFICATION STATEMENT (NPDES ATTACHMENT 6), FULL COMPLIANCE WITH ALL TERMS OF THE 404 AND NPDES PERMIT MUST BE STRICTLY ADHERED TO.
3. EROSION AND SEDIMENT MEASURES MUST BE IN PLACE PRIOR TO START OF WORK.
4. CONTRACTOR MUST MAINTAIN EROSION AND SEDIMENT CONTROL MEASURES.
5. PLACEMENT OF TEMPORARY EROSION CONTROL SEEDING OVER ALL ERODABLE AND BARE AREAS MUST BE EVERY SEVEN DAYS.
6. TEMPORARY FENCE WILL BE PROVIDED AND MAINTAINED BY CONTRACTOR FOR WETLAND BOUNDARY PROTECTION.
7. DRAINAGE STRUCTURE INLET FILTERS WILL BE PROVIDED AND MAINTAINED BY THE CONTRACTOR FOR ALL EXISTING DRAINAGE STRUCTURES WITHIN THE PROJECT LIMITS.
8. ROLLED EXCELSIOR WILL BE USED AS THE TEMPORARY DITCH CHECK. A HEIGHT OF 0.3m WAS USED TO CALCULATE THE DITCH CHECK LOCATIONS. IF THE HEIGHT VAR.ES FROM THIS, THE DITCH CHECK LOCATIONS WILL HAVE TO BE REEVALUATED.
9. PROTECTIVE SHIELD USED DURING DEMOLITION IS SHOWN ON THE BRIDGE PLANS.
10. A 404 PERMIT AND NPDES PERMIT ARE REQUIRED FOR THIS PROJECT.
11. LAKE MARIE (0712000610) IS 303D-LISTED FOR TOTAL SUSPENDED SOLIDS. NPDES REQUIRES EROSION AND SEDIMENT CONTROL DESIGN FOR THE 25 YEAR - 24 HOUR STORM.
12. ANY IN-STREAM WORK MUST BE APPROVED BY THE ARMY CORP OF ENGINEERS IN WRITING BEFORE THAT WORK CAN BE STARTED.

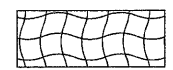
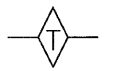
EROSION CONTROL LEGEND

-  TEMPORARY FENCE
-  PERIMETER EROSION BARRIER
-  TEMPORARY EROSION CONTROL SEEDING AND EROSION CONTROL BLANKET
-  TEMPORARY DITCH CHECK
-  FLOW DIRECTION
-  EXISTING WETLAND AREA
-  WATERS OF THE UNITED STATES TEMPORARY IMPACT AREA

F.A.P. RTE.	SECTION	COUNTY	TOTAL SHEETS	SHEET NO.
303	134(B&B-2)R-1	LAKE	137	52
STA. 25+000 TO STA. 25+150				
FED. ROAD DIST. NO. 1 ILLINOIS FED. AID PROJECT				
CONTRACT NO. 62037				

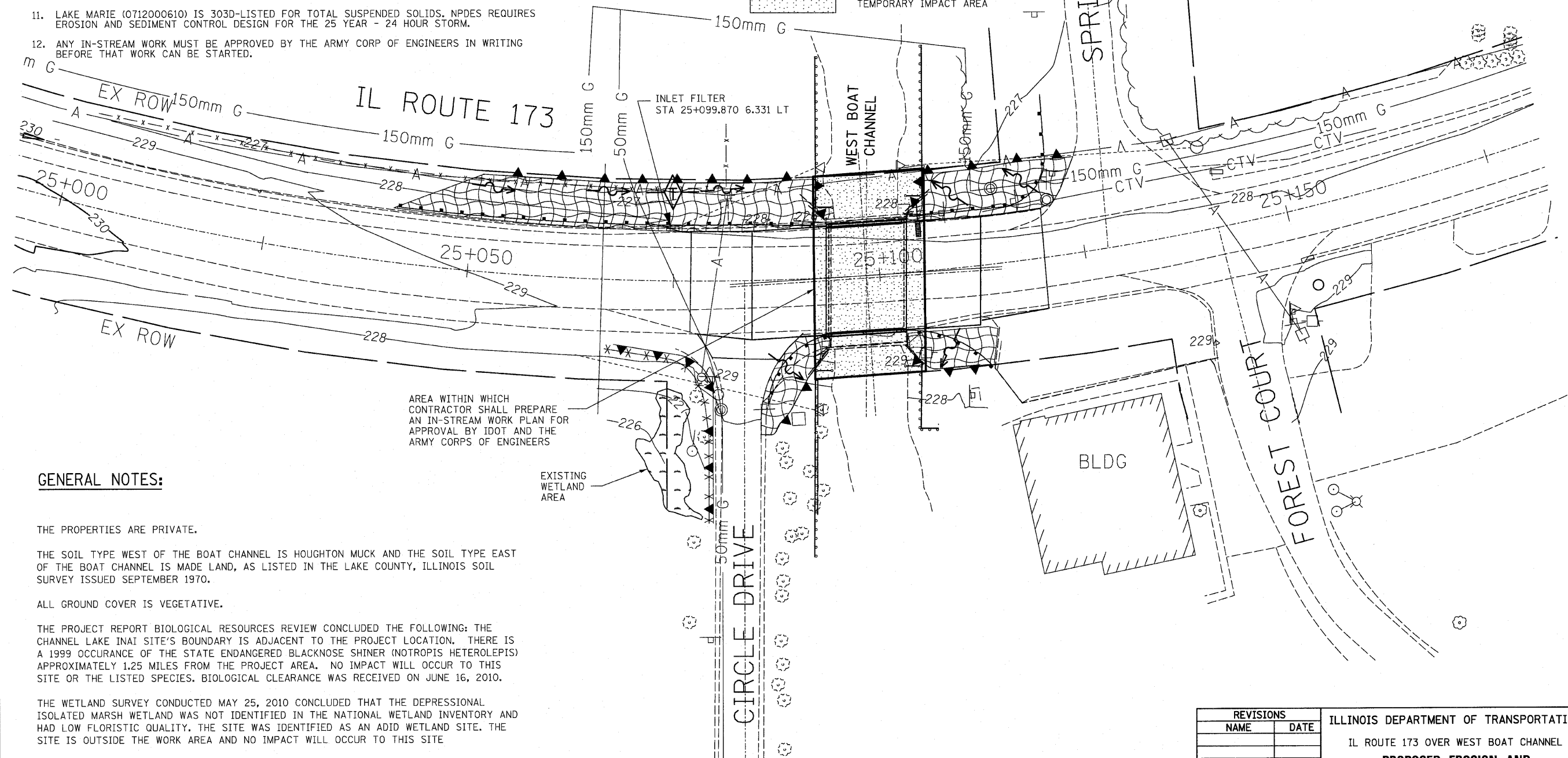

GENERAL NOTES:

THE PROPERTIES ARE PRIVATE.

THE SOIL TYPE WEST OF THE BOAT CHANNEL IS HOUGHTON MUCK AND THE SOIL TYPE EAST OF THE BOAT CHANNEL IS MADE LAND, AS LISTED IN THE LAKE COUNTY, ILLINOIS SOIL SURVEY ISSUED SEPTEMBER 1970.

ALL GROUND COVER IS VEGETATIVE.

THE PROJECT REPORT BIOLOGICAL RESOURCES REVIEW CONCLUDED THE FOLLOWING: THE CHANNEL LAKE INAI SITE'S BOUNDARY IS ADJACENT TO THE PROJECT LOCATION. THERE IS A 1999 OCCURRENCE OF THE STATE ENDANGERED BLACKNOSE SHINER (NOTROPIS HETEROLEPIS) APPROXIMATELY 1.25 MILES FROM THE PROJECT AREA. NO IMPACT WILL OCCUR TO THIS SITE OR THE LISTED SPECIES. BIOLOGICAL CLEARANCE WAS RECEIVED ON JUNE 16, 2010.

THE WETLAND SURVEY CONDUCTED MAY 25, 2010 CONCLUDED THAT THE DEPRESSIONAL ISOLATED MARSH WETLAND WAS NOT IDENTIFIED IN THE NATIONAL WETLAND INVENTORY AND HAD LOW FLORISTIC QUALITY. THE SITE WAS IDENTIFIED AS AN ADIUD WETLAND SITE. THE SITE IS OUTSIDE THE WORK AREA AND NO IMPACT WILL OCCUR TO THIS SITE

THE PROJECT REPORT CULTURAL RESOURCE REVIEW CONCLUDED THAT NO CULTURAL RESOURCE SURVEY IS REQUIRED FOR THIS PROJECT. CULTURAL CLEARANCE WAS RECEIVED ON NOVEMBER 16, 2009.

AREA WITHIN WHICH CONTRACTOR SHALL PREPARE AN IN-STREAM WORK PLAN FOR APPROVAL BY IDOT AND THE ARMY CORPS OF ENGINEERS

EXISTING WETLAND AREA

REVISIONS	
NAME	DATE

ILLINOIS DEPARTMENT OF TRANSPORTATION	
IL ROUTE 173 OVER WEST BOAT CHANNEL	
PROPOSED EROSION AND SEDIMENT CONTROL	
SCALE: 1:250	DRAWN BY: CLG
DATE: 3-8-10	CHECKED BY: JJD



3117EROSION.DGN