

F.A.P. RTE.	SECTION	COUNTY	TOTAL SHEETS	SHEET NO.
303	134(B&B-2)R-1	LAKE	137	59
STA. 26+400 TO STA. 26+650				
FED. ROAD DIST. NO. 1 ILLINOIS FED. AID PROJECT				

CONTRACT NO. 62037

NOTES:

1. RAISED REFLECTIVE PAVEMENT MARKERS ON BRIDGE SHOULD BE RAISED REFLECTIVE PAVEMENT MARKER (BRIDGE), TWO-WAY AMBER, 12m O.C.
2. ALL PAVEMENT MARKINGS ON THE PC CONCRETE BRIDGE SHALL BE POLYUREA PAVEMENT MARKING TYPE I.

PAVEMENT MARKING LEGEND

- 1 THERMOPLASTIC PAVEMENT MARKING, SOLID DOUBLE YELLOW (100mm)
 - 2 THERMOPLASTIC PAVEMENT MARKING, SOLID WHITE (100mm)
 - 3 POLYUREA PAVEMENT MARKING TYPE I, SOLID DOUBLE YELLOW (100mm)
 - 4 POLYUREA PAVEMENT MARKING TYPE I, SOLID WHITE (100mm)
- ◆ RAISED REFLECTIVE PAVEMENT MARKERS, TWO-WAY AMBER MARKER, 12m O.C.

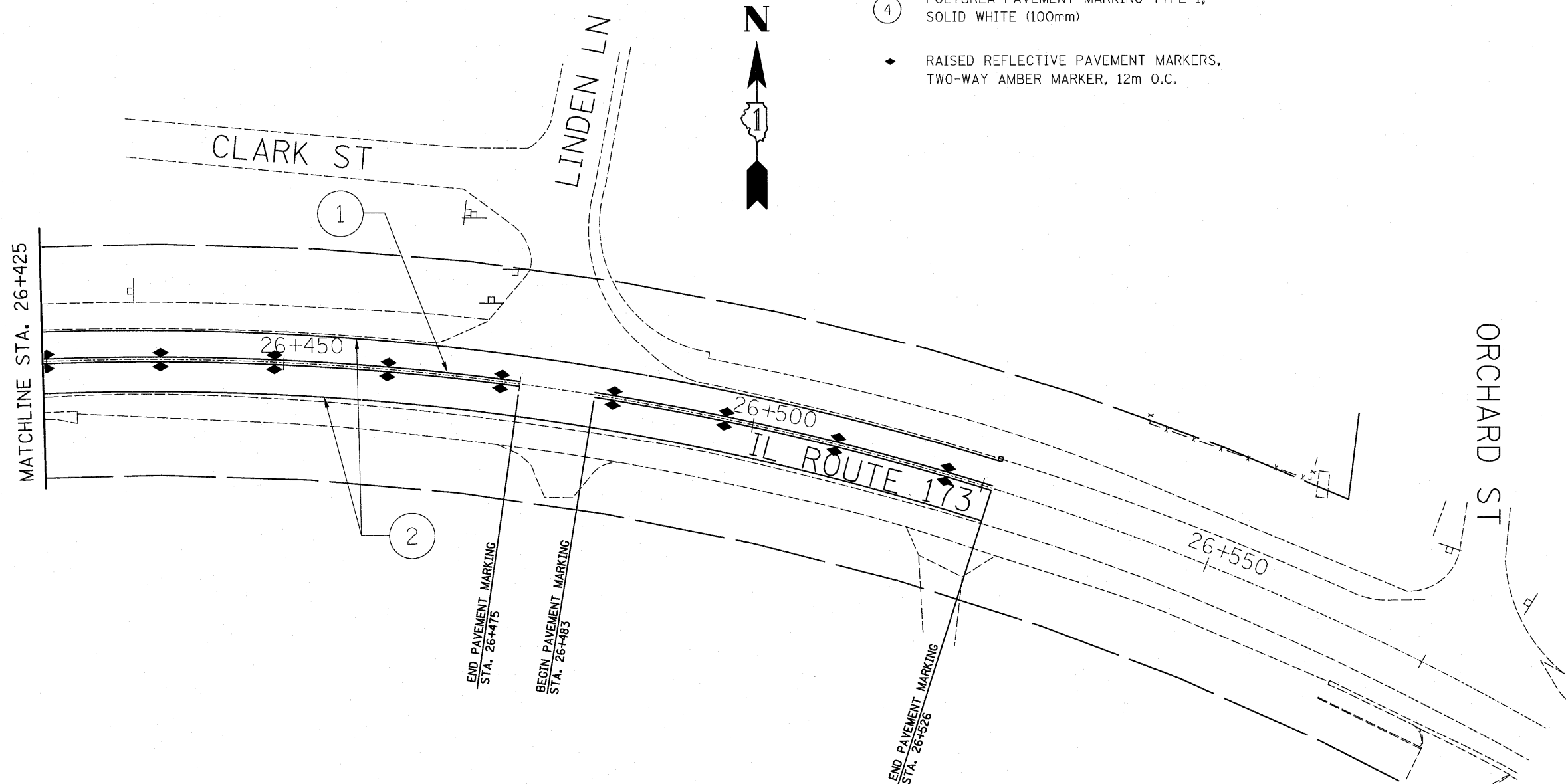

REVISIONS	
NAME	DATE

ILLINOIS DEPARTMENT OF TRANSPORTATION
 IL ROUTE 173 OVER EAST BOAT CHANNEL
PAVEMENT MARKINGS

SCALE: 1:250
 DRAWN BY CLG
 CHECKED BY JJD
 DATE 3-8-10