

STATE OF ILLINOIS
DEPARTMENT OF TRANSPORTATION

ROUTE NO.	SECTION	COUNTY	TOTAL SHEETS	SHEET NO.
FAP 303 IL. 173	134(B&B-2)R-1	LAKE	137	69
FED. ROAD DIST. NO. 7	ILLINOIS	FED. AID PROJECT		

SHEET NO. 6
17 SHEETS

NORTH FACE OF CURB

Location	Station	Offset (m)	Theoretical Grade Elevations
W. End East Appr. Slab	25+103.774	-6.099	227.868
E	25+106.834	-6.031	227.849
F	25+109.892	-5.934	227.833
E. End East Appr. Slab	25+112.947	-5.807	227.819

NORTH EDGE OF NORTH LANE

Location	Station	Offset (m)	Theoretical Grade Elevations
W. End East Appr. Slab	25+103.558	-3.600	228.077
E	25+106.599	-3.600	228.053
F	25+109.642	-3.600	228.029
E. End East Appr. Slab	25+112.689	-3.600	228.005

CL IL. RTE. 173 AND P.G.L.

Location	Station	Offset (m)	Theoretical Grade Elevations
W. End East Appr. Slab	25+103.253	0.000	228.378
E	25+106.258	0.000	228.354
F	25+109.265	0.000	228.331
E. End East Appr. Slab	25+112.276	0.000	228.307

CL STRUCTURE and STAGE CONSTRUCTION LINE

Location	Station	Offset (m)	Theoretical Grade Elevations
W. End East Appr. Slab	25+103.225	0.338	228.378
E	25+106.220	0.400	228.354
F	25+109.215	0.491	228.331
E. End East Appr. Slab	25+112.207	0.611	228.307

SOUTH EDGE OF SOUTH LANE

Location	Station	Offset (m)	Theoretical Grade Elevations
W. End East Appr. Slab	25+102.955	3.600	228.679
E	25+105.925	3.600	228.656
F	25+108.897	3.600	228.632
E. End East Appr. Slab	25+111.872	3.600	228.609

SOUTH FACE OF CURB

Location	Station	Offset (m)	Theoretical Grade Elevations
W. End East Appr. Slab	25+102.697	6.776	228.945
E	25+105.632	6.832	228.926
F	25+108.565	6.917	228.910
E. End East Appr. Slab	25+111.497	7.031	228.896

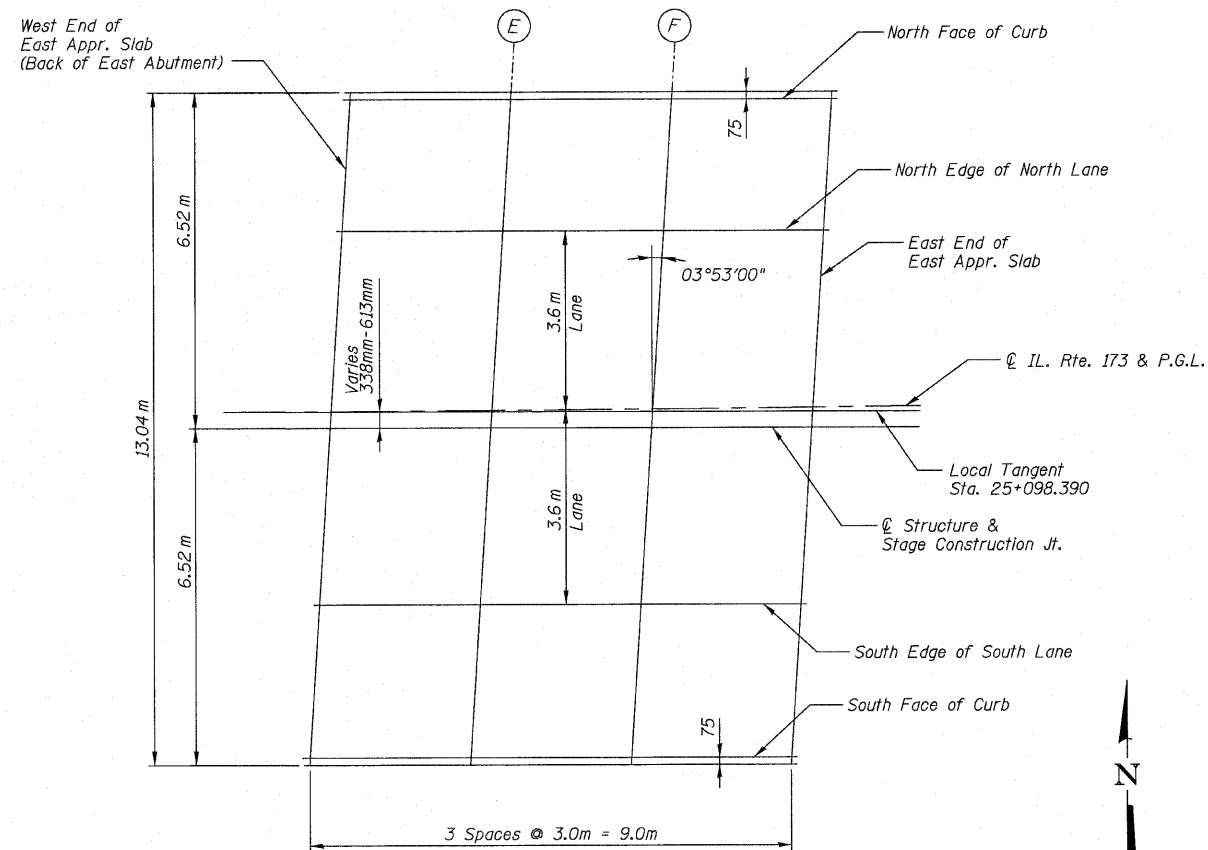

PLAN
East Approach Slab

DESIGNED	PAT2
CHECKED	RCJ/JRF
DRAWN	RDS
CHECKED	PAT2



NOTE

All dimensions are in millimeters (mm) except as noted.

**TOP OF EAST APPROACH
SLAB ELEVATIONS
FAP 303 IL. ROUTE 173
OVER WEST BOAT CHANNEL
SECTION 134(B&B-2)R-1
LAKE COUNTY
STATION 25+098.390
STRUCTURE NO. 049-0055**