

TEMPORARY EROSION CONTROL SEEDING WILL BE PLACED AS DIRECTED BY THE ENGINEER.

NOTES:

- ① TEMPORARY EROSION CONTROL SEEDING TO BE PROVIDED AT ALL ERODABLE BARE EARTH AREAS, REFER TO SPECIAL PROVISIONS.
- ② NPDES PERMIT IS REQUIRED FOR THE PROJECT.
- ③ THE CONTRACTOR SHALL PROVIDE & MAINTAIN INLET PROTECTION AT ALL PROPOSED DRAINAGE STRUCTURES AND AT OTHER LOCATIONS DIRECTED BY THE ENGINEER AND/OR SHOWN ON THE PLANS. INLET PROTECTION SHALL BE PLACED IMMEDIATELY AFTER THE AREA INVOLVED HAS BEEN DISTURBED.
- ④ ALL EROSION CONTROL MEASURES SHALL BE IN ACCORDANCE WITH THE REQUIREMENTS OF THE STANDARD SPECIFICATIONS AND THE APPLICABLE STATE STANDARDS FOR THE ENTIRE DURATION OF THE CONTRACT OR UNTIL SUCH A TIME AS DIRECTED BY THE ENGINEER.
- ⑤ THE PERIMETER EROSION BARRIER SHALL BE INSTALLED AT THE LOCATIONS SHOWN ON THE PLANS OR AS DIRECTED BY THE ENGINEER.

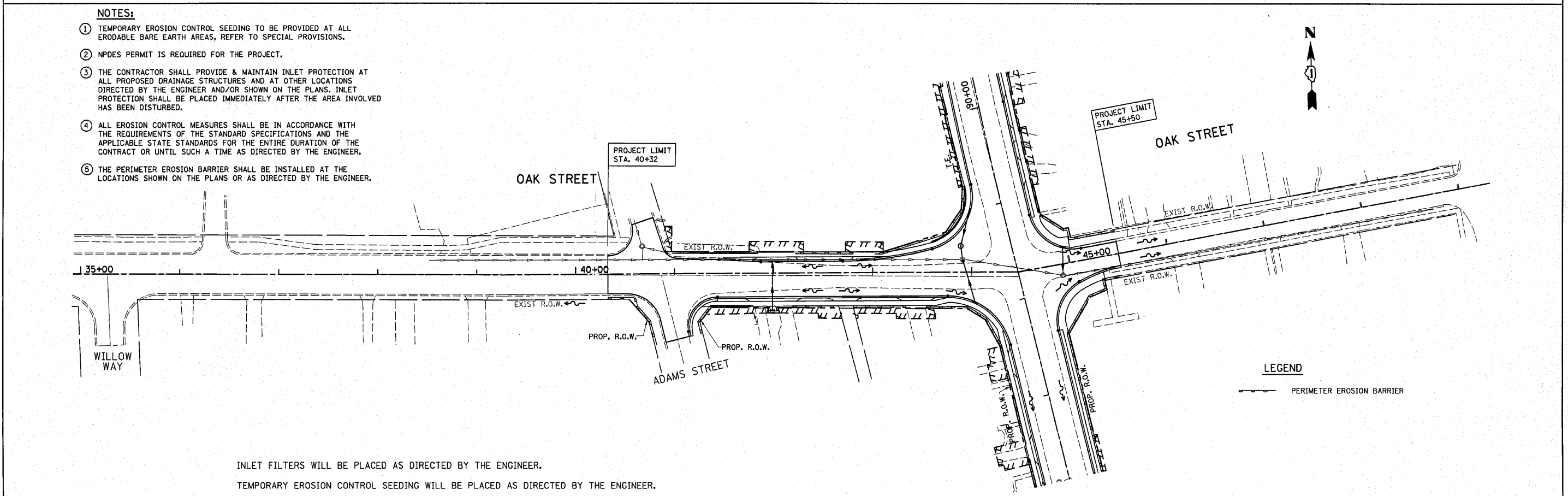

INLET FILTERS WILL BE PLACED AS DIRECTED BY THE ENGINEER.
 TEMPORARY EROSION CONTROL SEEDING WILL BE PLACED AS DIRECTED BY THE ENGINEER.

FILE NAME =	USER NAME = qureshiya	DESIGNED -	REVISED -	STATE OF ILLINOIS DEPARTMENT OF TRANSPORTATION	IL. RTE. 31 @ OAK ST. EROSION CONTROL PLAN			F.A.U. RTE.	SECTION	COUNTY	TOTAL SHEETS	SHEET NO.
c:\pw_work\PW\DOT\QURESHIYA\111275\PI10	603-shr-eros.dgn	DRAWN -	REVISED -					3887	A-R-N-1	KANE	77	20
	PLLOT SCALE = 50.000' / IN.	CHECKED -	REVISED -					CONTRACT NO. 62914				
	PLLOT DATE = 4/6/2010	DATE -	REVISED -					ILLINOIS FED. AID PROJECT				
					SCALE: 1"=50'	SHEET NO.	OF	SHEETS	STA.	TO STA.		