

EXISTING INTERSECTION AND PROPOSED SAMPLING (SYSTEM) DETECTORS (SEE INTERCONNECT PLANS)

PROPOSED INTERCONNECT TO IL. RTE. 31 AT OAK ST.

RESTORATION OF WORK AREA, RESTORATION OF THE TRAFFIC SIGNAL WORK AREA SHALL BE INCLUDED IN THE RELATED PAY ITEMS SUCH AS FOUNDATION, CONDUIT, HANDHOLE, TRENCH AND BACKFILL, ETC. ALL ROADWAY SURFACES SUCH AS SHOULDERS, MEDIANS, SIDEWALKS, PAVEMENT, ETC. SHALL BE REPLACED IN KIND. ALL DAMAGE TO MOWED LAWNS SHALL BE REPLACED WITH AN APPROVED SOD AND ALL DAMAGE TO UNMOWED FIELDS SHALL BE SEEDED. RESTORATION OF THE WORK AREA SHALL BE INCIDENTAL TO THE CONTRACT WITHOUT ANY EXTRA COMPENSATION ALLOWED TO THE CONTRACTOR.

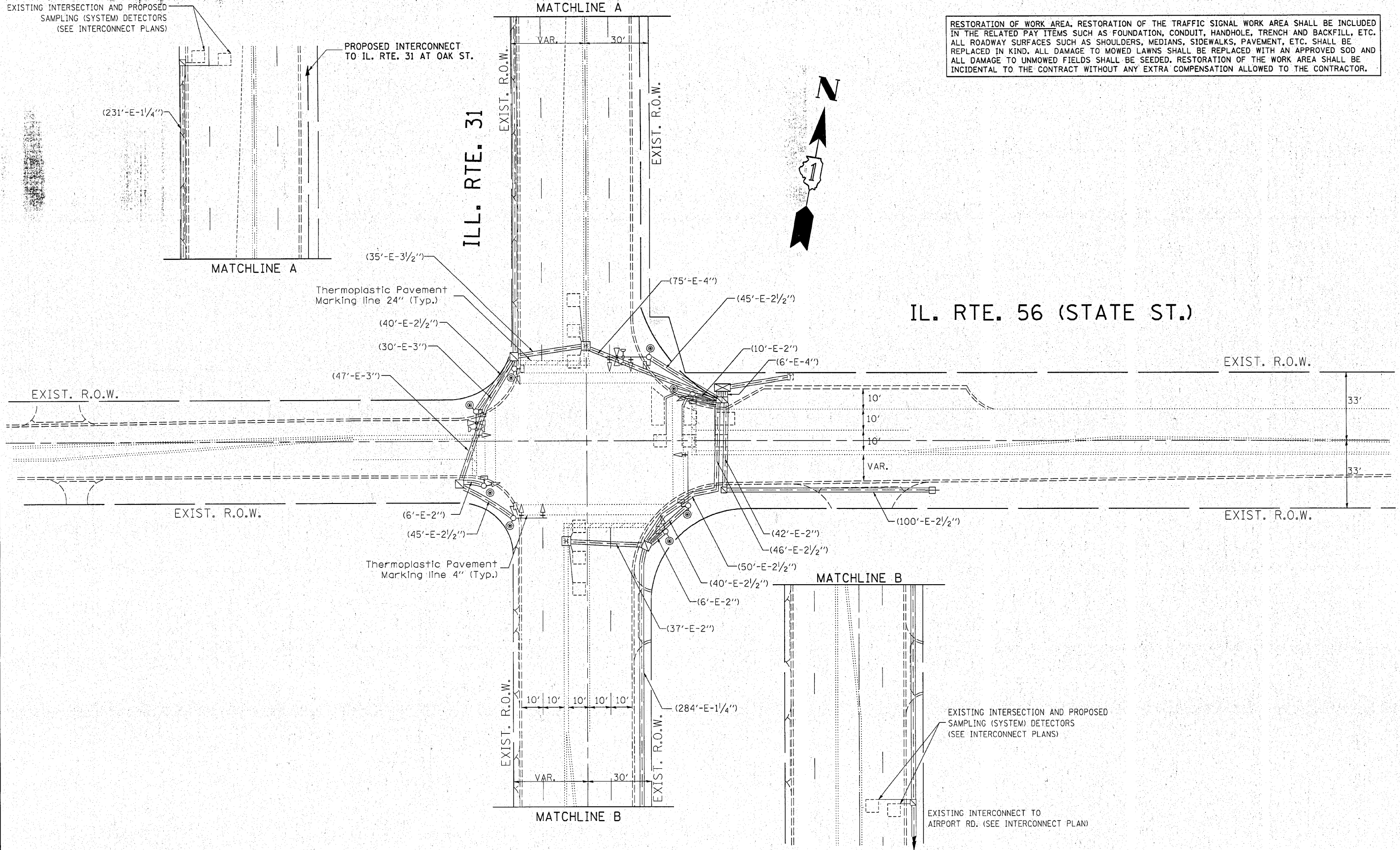

FILE NAME =	USER NAME = karthaxaybc	DESIGNED -	REVISED -	STATE OF ILLINOIS DEPARTMENT OF TRANSPORTATION	TRAFFIC SIGNAL INSTALLATION IL. RTE. 31 AT IL. RTE. 56 (STATE ST.)			F.A.U. RTE.	SECTION	COUNTY	TOTAL SHEETS	SHEET NO.
ct:\pw_work\PI\DOT\KANTHAPHIXAYBC\0117884\TS.dgn		DRAWN -	REVISED -					3887	A-R-N-1	KANE	77	40
PLOT SCALE = 21.0000' / IN.		CHECKED -	REVISED -					CONTRACT NO. 62914				
PLOT DATE = 2/10/2010		DATE -	REVISED -					SCALE:	SHEET NO. OF SHEETS	STA. TO STA.	FED. ROAD DIST. NO.	ILLINOIS FED. AID PROJECT