

DATE	
BY	
REVISIONS	
NO.	
DESCRIPTION	
DATE	
BY	
REVISIONS	
NO.	
DESCRIPTION	
DATE	
BY	
REVISIONS	
NO.	
DESCRIPTION	
DATE	
BY	
REVISIONS	
NO.	
DESCRIPTION	
DATE	
BY	
REVISIONS	
NO.	
DESCRIPTION	
DATE	
BY	
REVISIONS	
NO.	
DESCRIPTION	
DATE	
BY	
REVISIONS	
NO.	
DESCRIPTION	

DATE	
BY	
REVISIONS	
NO.	
DESCRIPTION	
DATE	
BY	
REVISIONS	
NO.	
DESCRIPTION	
DATE	
BY	
REVISIONS	
NO.	
DESCRIPTION	
DATE	
BY	
REVISIONS	
NO.	
DESCRIPTION	
DATE	
BY	
REVISIONS	
NO.	
DESCRIPTION	
DATE	
BY	
REVISIONS	
NO.	
DESCRIPTION	

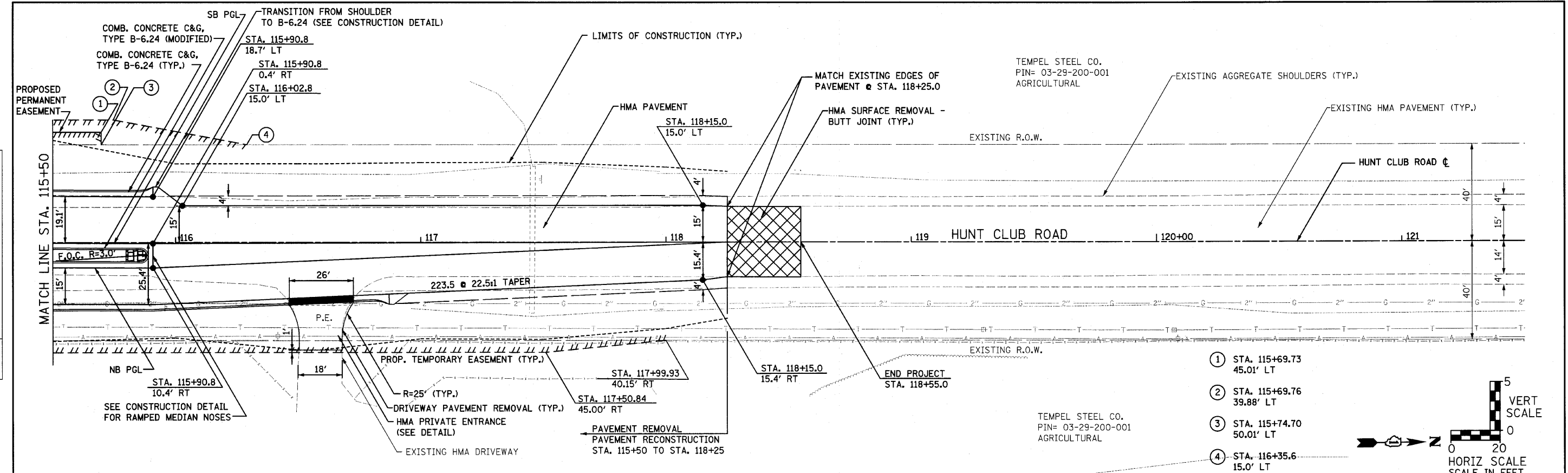

- ① STA. 115+69.73
45.01' LT
- ② STA. 115+69.76
39.88' LT
- ③ STA. 115+74.70
50.01' LT
- ④ STA. 116+35.6
15.0' LT

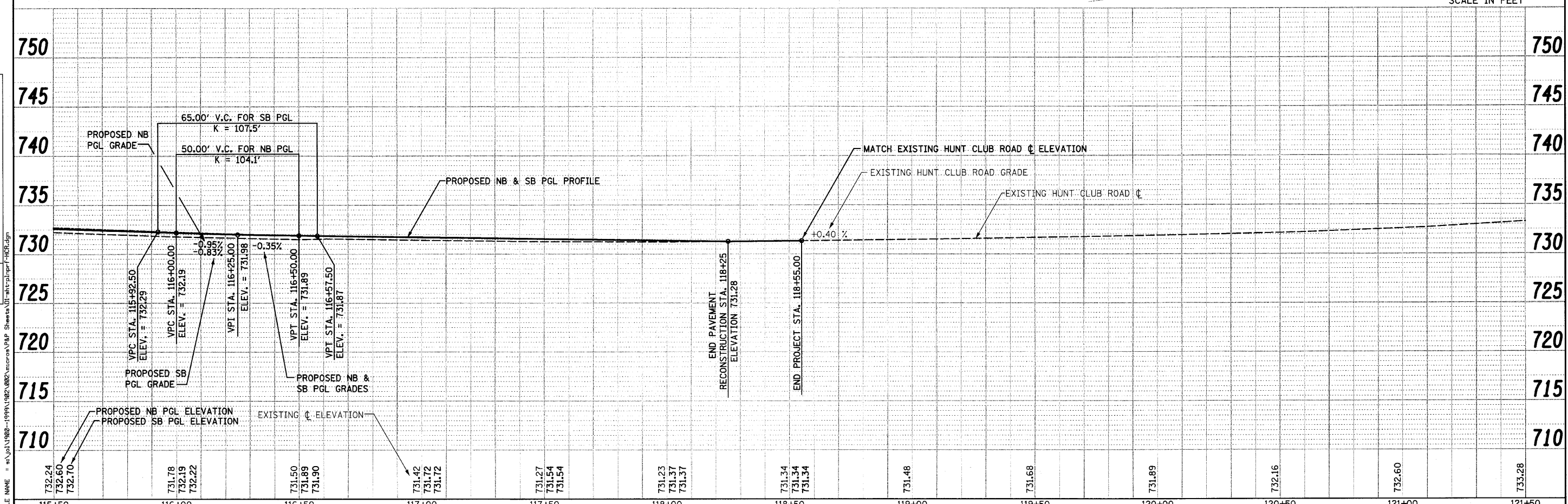
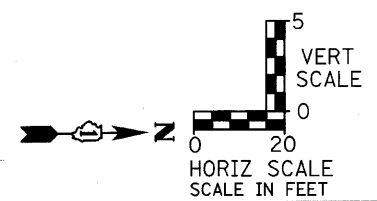

115+50	116+00	116+50	117+00	117+50	118+00	118+50	119+00	119+50	120+00	120+50	121+00	121+50													
732.24	732.60	732.70	731.78	732.19	732.22	731.50	731.89	731.90	731.42	731.72	731.72	731.27	731.54	731.54	731.23	731.37	731.37	731.34	731.34	731.48	731.68	731.89	732.16	732.60	733.28

1170 SOUTH HOUBOLT ROAD
JOLIET, ILLINOIS 60431
(815) 744-4200

DESIGNED -	MAG	REVISIONS -	
CHECKED -	RKK	REVISIONS -	
DRAWN -	VLF	REVISIONS -	
CHECKED -	RKK	REVISIONS -	

STATE OF ILLINOIS
DEPARTMENT OF TRANSPORTATION

HUNT CLUB ROAD PLAN AND PROFILE
SCALE: AS SHOWN SHEET NO. OF SHEETS STA. 115+50 TO STA. 121+50

F.A. RTE.	SECTION	COUNTY	TOTAL SHEETS	SHEET NO.
2661	02-00076-13-CH	LAKE	177	43
CONTRACT NO. 63457				